

WEATHER

TODAY'S UV INDEX

10 a.m. noon 2 p.m. 4 p.m.

6 10 10 6

The higher the AccuWeather.com UV Index™ number, the greater the need for eye and skin protection. 0-2: Low, 3-5: Moderate, 6-7: High, 8-10: Very High, 11+: Extreme.

FIVE-DAY FORECAST FOR GAINESVILLE

Today

88°
63°

Nice with sunshine
Chance of rain: 5%
Winds: ENE 6-12 mph

Friday

89°
66°

Sun, some clouds
Chance of rain: 25%
Winds: ENE 6-12 mph

Saturday

88°
67°

A t-storm in spots
Chance of rain: 45%
Winds: ENE 6-12 mph

Sunday

89°
68°

A p.m. t-storm
Chance of rain: 55%
Winds: E 6-12 mph

Monday

90°
68°

A thunderstorm
Chance of rain: 60%
Winds: E 4-8 mph

SUN AND MOON

Sunrise today 6:30 a.m.

Sunset tonight 8:22 p.m.

Moonrise today 3:56 p.m.

Moonsset today 3:19 a.m.

Full

Last

New

First

June 2

June 9

June 16

June 24

REGIONAL FORECAST

AccuWeather.com

Shown is today's weather. Temperatures are today's highs and tonight's lows.

FLOIDA FORECAST

	Today	Tomorrow
City	Hi/Low	Hi/Low
Apalachicola	88/71/t	88/70/t
Cape Canaveral	83/72/pc	84/74/pc
Crescent Beach	83/70/s	83/73/pc
Crystal River	89/65/s	89/69/s
Daytona Beach	83/70/pc	83/72/pc
Fernandina Bch.	85/64/pc	85/69/s
Ft. Lauderdale	85/75/pc	86/76/pc
Fort Myers	91/69/s	90/71/pc
Ft. Walton Bch.	85/70/t	86/69/t
Jacksonville	85/64/pc	85/67/s
Key West	86/78/pc	87/78/pc

Lakeland	88/67/pc	88/70/t
Melbourne	84/72/pc	84/73/pc
Miami	87/75/pc	88/76/pc
Orlando	88/69/pc	88/72/t
Panama City	86/70/t	87/69/t
Pensacola	85/70/t	85/69/t
Perry	90/65/pc	90/67/s
St. Petersburg	89/69/s	89/72/t
Sarasota	89/68/s	89/71/t
Tallahassee	91/68/t	92/69/t
Tampa	90/70/s	89/72/t
Vero Beach	85/71/pc	86/72/pc
W. Palm Beach	85/74/pc	86/75/pc

YESTERDAY'S ALMANAC

GAINESVILLE

Measured at Gainesville Regional Airport through 5 p.m. yesterday.

Temperature

High/low temperature 90°/71°

Normal high/low 89°/66°

Record high 100° in 1953

Record low 49° in 1979

Precipitation

24 hours through 5 p.m. yest. 0.01"

Record rainfall 2.18" in 1963

Monthly rainfall

2015	2014	2013	Nrml	Rcnd	Year
Jan.	3.24	5.20	0.33	3.31	9.01 1994
Feb.	2.02	4.37	1.64	3.20	11.58 1998
March	1.17	5.50	0.98	4.33	11.13 1996
April	3.22	2.63	3.48	2.67	7.42 1997
May	2.54	2.84	4.57	2.48	9.25 1959
June	4.53	6.26	7.12	16.34	2012
July	6.79	16.65	6.07	16.65	2013
Aug.	5.21	2.80	6.39	15.84	1985
Sept.	7.28	3.20	4.42	16.45	2004
Oct.	1.55	0.08	2.88	7.98	1993
Nov.	2.47	3.31	2.06	4.51	1987
Dec.	3.38	3.79	2.48	9.60	1997
Year	12.19	51.75	47.09	47.41	67.52 1964

OCALA

Measured at Ocala through 5 p.m. yesterday.

Temperature

High/low temperature 94°/71°

Normal high/low 91°/66°

Record high 102° in 1962

Record low 45° in 1979

Precipitation

24 hours through 5 p.m. yest. 0.00"

Record rainfall 1.30" in 1970

Monthly rainfall

2015	2014	2013	Nrml	Rcnd	Year
Jan.	5.02	4.66	0.29	3.20	9.12 1994
Feb.	1.83	4.42	1.61	3.26	11.31 1998
March	1.46	4.56	0.65	4.56	11.86 1959
April	2.60	3.53	4.13	2.40	16.37 1982
May	1.56	2.82	2.35	2.92	13.05 1976
June	7.78	8.47	7.42	15.98	1974
July	7.26	9.38	6.92	13.57	1964
Aug.	6.01	9.43	6.32	15.17	1949
Sept.	10.65	5.02	6.08	20.70	2004
Oct.	1.06	1.93	3.03	9.53	1958
Nov.	6.23	3.41	2.12	7.01	1980
Dec.	3.96	3.94	2.57	9.45	1997
Year	12.47	62.94	50.61	50.80	74.71 1982

POLLEN INDEX

ABSENT LOW MODERATE HIGH VERY HIGH

SOURCE: AccuWeather.com

WEATHER TRIVIA™

Q: What is the apparent temperature?

A: A heat index that factors together the temperature and humidity.

TODAY'S TIDES

	High	Low
Boca Grande	10:15 a.m.	2:52 a.m.
Cedar Key	10:52 a.m.	4:36 a.m.
Crystal River	10:49 a.m.	5:06 a.m.
Daytona Beach	4:24 a.m.	10:43 a.m.
Homosassa Bay	1:47 a.m.	9:20 a.m.
Ponce Inlet	5:16 a.m.	11:55 a.m.
St. Augustine	5:00 a.m.	11:26 a.m.
Withlacoochee	10:59 a.m.	5:31 a.m.

COASTAL CONDITIONS

Savannah to St. Augustine: Wind from the east at 6-12 knots today. Seas 2-4 feet. Inland waterways a light chop. Visibility clear to the horizon.

St. Augustine to Jupiter Inlet: Wind from the east-northeast at 8-16 knots today. Seas 3-5 feet. Inland waterways a light chop. Visibility generally clear.

Tarpon Springs to Apalachicola: Wind from the east at 3-6 knots today. Seas 2 feet or less. Inland waterways smooth. Visibility generally unrestricted.

SOLUNAR TABLES

The solunar period indicates peak feeding times for fish and game.

	A.M.	P.M.
Day	Major	Minor
Today	8:31	2:20
Fri.	9:10	2:58
Sat.	9:49	3:38

AIRPORT REPORT

ATLANTA: Some sun, a t-storm; humid. High 82, Low 67

CHARLOTTE: Clouds and sun with a t-storm. High 86, Low 65

JACKSONVILLE: Partial sunshine. High 85, Low 64

MIAMI: Partly sunny with a shower. High 87, Low 75

ORLANDO: Partly sunny and pleasant. High 88, Low 69

TAMPA: Sunny to partly cloudy. High 90, Low 70

TODAY'S FIRE RISK

LOW MODERATE HIGH EXTREME

SOURCE: U.S. Forest Service

NATION & WORLD

	Today	Tomorrow
U.S. CITIES	Hi/Low	Hi/Low
Albany	80/55/t	85/63/pc
Albuquerque	84/57/s	84/59/pc
Allentown	87/58/pc	86/63/pc
Anchorage	64/46/s	66/49/s
Asheville	80/59/t	78/59/t
Atlanta	82/67/t	84/66/t
Atlantic City	85/64/t	80/64/pc
Austin	86/70/c	84/68/t
Baltimore	89/65/t	86/65/pc
Birmingham	82/66/t	85/66/t
Bismarck	78/49/t	63/37/c
Boise	78/54/s	84/60/pc
Boston	79/60/t	70/57/pc
Buffalo	75/56/pc	84/65/pc
Burlington, VT	76/56/t	85/66/pc
Casper	66/42/c	60/42/t
Charleston, SC	85/64/t	83/67/pc
Charleston, WV	84/61/t	86/64/t
Charlotte	86/65/t	84/62/t
Chicago	83/63/s	80/58/t
Cincinnati	82/64/pc	84/66/t
Cleveland	77/61/s	85/67/t
Columbia	88/64/t	88/65/t
Columbus, OH	81/62/s	86/66/t
Concord	83/54/t	82/54/pc
Dallas	84/68/t	79/66/t
Dayton	82/65/s	86/68/pc
Denver	72/46/c	62/47/t
Des Moines	81/66/t	77/56/t
Detroit	81/60/s	85/66/t
Duluth	67/56/t	65/40/c
El Paso	93/63/s	96/65/pc
Evansville	84/66/pc	84/68/pc
Fairbanks	69/48/c	74/49/s
Fargo	79/52/t	61/38/c
Flagstaff	72/39/s	74/42/s
Grand Rapids	82/61/s	82/61/pc
Great Falls	63/43/pc	69/47/pc
Greensboro	84/67/t	83/64/t
Hartford	87/58/t	86/60/pc
Helena	65/49/pc	72/50/t
Honolulu	83/69/c	83/70/sh
Houston	86/72/pc	84/71/t
Indianapolis	83/65/s	84/65/pc
Jackson, MS	85/67/pc	87/67/t
Kansas City	78/65/t	77/59/t
Las Vegas	95/72/s	97/72/s
Little Rock	86/69/pc	85/69/t
Los Angeles	77/60/pc	79/61/pc
Louisville	85/68/pc	85/69/pc
Lubbock	79/61/t	83/58/c
Madison	83/63/pc	78/51/t
Memphis	86/71/t	86/70/t
Midland	82/65/s	88/63/pc
Milwaukee	77/57/s	77/49/t
Minneapolis	82/63/t	70/48/r
Nashville	84/65/pc	84/66/t
New Orleans	86/73/pc	87/73/t
New York	85/66/t	81/64/pc
Norfolk	84/67/t	83/68/t
Oklahoma City	80/66/t	80/63/t
Omaha	76/65/t	77/55/t

IN THE SKIES

An hour before dawn, the faint band of the Milky Way runs directly overhead, passing from northeast to southwest. The galaxy's bright center is due south, located about 30,000 light years away, toward the stars of Sagittarius the Archer.

SOURCE: Morrison Planetarium, California Academy of Sciences

-10s

-0s

0s

10s

20s

30s

40s

50s

60s

70s

80s

90s

100s

110s

Forecasts and graphics provided by AccuWeather, Inc. ©2015

Shows: T-storms, Rain, Flurries, Snow, Ice, Cold Front, Warm Front, Stationary

YESTERDAY'S U.S. EXTREMES FOR THE 48 CONTIGUOUS STATES

High: Presidio, TX at 100° Low: Truckee, CA at 32°

KEY: W-weather, S-sunny, PC-partly cloudy, C-cloudy, SH-showers, T-thunderstorms, R-rain, SF-snow flurries, SN-snow, I-ice.

	Today	Tomorrow
Philadelphia	Hi/Low	Hi/Low
Philadelphia	88/68/pc	85/67/pc
Phoenix	98/73/s	102/75/s
Pittsburgh	81/62/pc	83/65/t
Portland, ME	80/57/t	73/53/pc
Portland, OR	83/58/s	83/57/pc
Providence	79/59/t	81/57/pc
Raleigh	86/66/t	87/64/t
Rapid City	72/51/t	61/42/sh
Reno	83/56/s	86/57/s
Richmond	86/68/t	85/67/t
Sacramento	86/56/s	88/57/s
St. Louis	86/70/t	83/69/t
Salt Lake City	69/51/t	74/55/pc
San Antonio	87/73/c	86/71/t
San Diego	70/62/pc	72/62/pc
San Francisco	66/54/pc	67/54/pc
Santa Fe	80/48/s	79/50/pc
St. Ste. Marie	68/51/pc	76/46/t
Seattle	78/56/s	77/53/pc
Shreveport	87/70/pc	86/69/t
Sioux Falls	77/59/t	68/43/t
Spokane	79/58/pc	81/60/pc
Syracuse	74/54/pc	87/66/pc
Topeka	79/66/c	80/60/t
Tucson	96/65/s	98/67/s
Tulsa	81/67/c	81/65/t
Wash., DC	90/71/t	86/71/pc
Wichita	78/65/t	78/60/t
Wilkes-Barre	86/57/pc	86/65/pc
Wilmington, NC	83/63/t	82/67/t

CANADA

	Today	Tomorrow
Calgary	Hi/Low	Hi/Low
Calgary	57/41/c	64/40/pc
Edmonton	63/36/s	62/41/pc
Halifax	64/52/pc	68/49/s
Ottawa	71/47/pc	82/63/pc
Quebec	73/44/pc	74/55/pc
Regina	74/33/pc	59/36/s
Toronto	79/55/s	79/63/pc
Vancouver	71/55/s	71/53/s
Winnipeg	68/42/pc	53/33/s

CARIBBEAN

	Today	Tomorrow
Barbados	Hi/Low	Hi/Low
Barbados	87/77/sh	87/77/sh
Bridgetown	87/77/sh	87/77/sh
Curacao	87/79/pc	89/79/pc
Freeport	85/72/pc	85/73/pc
Havana	88/70/pc	88/70/pc
Kingston	87/77/t	87/78/t
St. Thomas	87/78/pc	86/78/sh
San Juan	88/76/pc	87/77/sh

WORLD

	Today	Tomorrow
St. Louis	Hi/Low	Hi/Low
Acapulco	91/77/t	89/79/t
Asuncion	68/53/s	71/55/s
Baghdad	106/85/pc	103/79/pc
Bangkok	97/81/t	97/80/t
Beijing	90/70/pc	77/60/sh
Berlin	68/48/pc	68/49/pc
Buenos Aires	64/54/s	62/54/pc
Cairo	94/68/pc	85/67/s
Cape Town	67/54/c	65/55/r
Caracas	86/74/t	86/74/t
Dublin	55/41/c	55/40/sh
Jerusalem	91/59/pc	79/53/s
Kabul	83/54/t	76/54/t
Lima	74/64/pc	74/63/pc
London	62/47/c	61/46/sh
Madrid	87/60/s	84/59/t
Manila	92/80/sh	92/80/t
Mexico City	75/55/t	75/57/t
Moscow	77/58/t	73/60/t
Nairobi	78/60/t	78/61/pc
New Delhi	112/84/pc	112/85/pc
Paris	70/50/pc	65/50/pc
Quito	70/50/t	68/52/t
Rio de Janeiro	85/71/t	78/68/r
Rome	75/54/s	75/55/s
Seoul	84/59/pc	84/63/pc
Singapore	90/80/t	90/79/t
Sydney	72/57/pc	72/52/pc
Tokyo	82/66/pc	81/68/sh

NOTICE OF CAMPUS MASTER PLAN PUBLIC HEARING AND ADOPTION

The University of Florida proposes to adopt a campus master plan to govern the use of land within the area shown on the map in this advertisement for the years 2015 – 2025.

A public hearing on the campus master plan will be held on June 4, 2015 at 3:40 PM at Emerson Alumni Hall (1938 W. University Avenue), Room 215B. Interested parties are invited to appear at the public hearing and be heard regarding the proposed campus master plan. Public parking will be provided in a designated area in the northeast corner of the O'Connell Center parking lot during the time of the hearing. Interested parties who cannot attend this hearing are invited to submit written comments to Linda Dixon, Planning Director, P.O. Box 115050, Gainesville, Florida 32611 or at ldixon@ufl.edu, which must be received no later than 5:00 PM on June 3, 2015. The agenda for the public hearing will consist of substantially the following: (i) University of Florida staff will make a brief presentation to include an overview of the relevant statutory requirements and master planning process; the review, public hearing, and approval processes; the general content of the proposed master plan; the proposed master plan's projected impacts; and any modifications made to the plan based on local government or other public input; (ii) public comment will be heard; and (iii) the University of Florida Board of Trustees will discuss, and vote on adoption of, the campus master plan.

A copy of the proposed campus master plan and meeting agenda are available for inspection at the University's [Planning, Design, and Construction Division, 232 Stadium, University of Florida, Gainesville, Florida](#) during the [normal business hours of 8:00 am to 5:00 pm](#), or online at www.masterplan.ufl.edu.

Within 45 days of adoption of the master plan by the Board of Trustees, the University shall provide written notice of adoption to any affected person, as defined in §1013.30(2)(b), Florida Statutes. Affected persons may petition the University of Florida Board of Trustees challenging the adopted campus master plan by submitting a petition within the timeframe, and meeting the requirements, set forth in §1013.30(7), Florida Statutes.

Pursuant to the provisions of the Americans with Disabilities Act, any person requiring special accommodation in order to attend and participate in this public hearing is asked to advise the University of Florida at least 48 hours in advance by contacting the Planning Design and Construction office at (352) 273-4000. Hearing and speech impaired persons should contact the university at (352) 846-1046 (TDD).

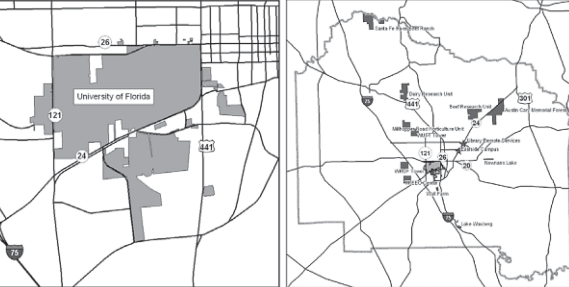

NOTICE OF PUBLIC HEARING BEFORE THE CITY COMMISSION OF THE CITY OF ALACHUA, FLORIDA

Notice is hereby given that the City Commission of the City of Alachua will hold a public hearing on the following proposed ordinance. The hearing will be held on June 8, 2015 at 6:30 p.m. in the James A. Lewis Commission Chambers in City Hall, located at 15100 NW 142nd Terrace, Alachua, Florida.

The title of the proposed ordinance is as follows:

ORDINANCE 15 06

AN ORDINANCE OF THE CITY OF ALACHUA, FLORIDA, RELATING TO THE AMENDMENT OF THE OFFICIAL ZONING ATLAS; AMENDING THE OFFICIAL ZONING ATLAS FROM RESIDENTIAL MULTIPLE FAMILY - 8 ("RMF-8") TO RESIDENTIAL MULTIPLE FAMILY - 15 ("RMF-15") ON APPROXIMATELY 12.12 ACRES; LOCATED SOUTH OF NW 151ST BLVD AND PARK VEGETARIANA; NORTH OF CLOVER RANCH ESTATES AND WYNDSWEEP HILLS; EAST OF U.S. INTERSTATE HIGHWAY 75 (I-75); AND WEST OF WYNDSWEEP HILLS AND SANTA FE STATION; ALACHUA, FLORIDA. A PORTION OF TAX PARCEL NUMBER 03863-002-001; PROVIDING A REPEALING CLAUSE; PROVIDING SEVERABILITY; AND PROVIDING AN EFFECTIVE DATE.

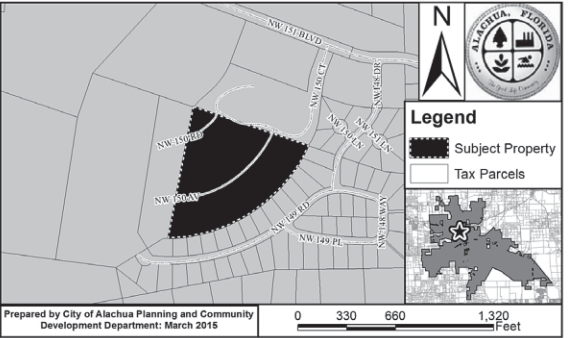

At the public hearing, all interested parties may appear and be heard with respect to the proposed ordinance. Copies of the proposed ordinance and related materials are available for public inspection at the Planning and Community Development Department, 15100 NW 142nd Terrace, on any regular business day between the hours of 7:30 a.m. to 6:00 p.m. Written comments on the proposed ordinance may be sent to the following address: City of Alachua, Planning and Community Development, P.O. Box 9, Alachua, FL 32616. Notice is given pursuant to Section 286.0105, Florida Statutes, that, in order to appeal any decision made at the public hearing, you will need a record of the proceedings, and that, for such purpose, you may need to ensure that a verbatim record of the proceedings is made, which includes the testimony and evidence upon which the appeal is to be based. In accordance with the Americans with Disabilities Act, any persons with a disability requiring reasonable accommodation in order to participate in this meeting should call the City Clerk at (386) 418-6100 x 101 at least 48 hours prior to the public hearing.

Something For Everyone.

Listings from Dealers and
Weekend Drivers,
Import or Domestic,
Classic or New.

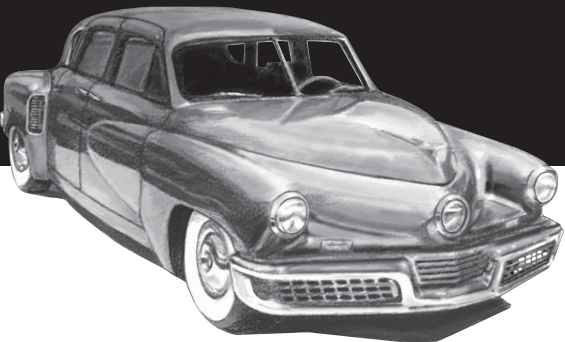

Cars.gainesville.com

Dealer and Private Listings.
Over 1600 vehicles to view.
Shop from your home.



City of ALACHUA

NOTICE OF PUBLIC HEARING BEFORE THE CITY COMMISSION OF THE CITY OF ALACHUA, FLORIDA

The title of the proposed ordinance is as follows:

ORDINANCE 15 06

AN ORDINANCE OF THE CITY OF ALACHUA, FLORIDA, RELATING TO THE AMENDMENT OF THE OFFICIAL ZONING ATLAS; AMENDING THE OFFICIAL ZONING ATLAS FROM RESIDENTIAL MULTIPLE FAMILY - 8 ("RMF-8") TO RESIDENTIAL MULTIPLE FAMILY - 15 ("RMF-15") ON APPROXIMATELY 12.12 ACRES; LOCATED SOUTH OF NW 151ST BLVD AND PARK VEGETARIANA; NORTH OF CLOVER RANCH ESTATES AND WYNDSWEEP HILLS; EAST OF U.S. INTERSTATE HIGHWAY 75 (I-75); AND WEST OF WYNDSWEEP HILLS AND SANTA FE STATION; ALACHUA, FLORIDA. A PORTION OF TAX PARCEL NUMBER 03863-002-001; PROVIDING A REPEALING CLAUSE; PROVIDING SEVERABILITY; AND PROVIDING AN EFFECTIVE DATE.

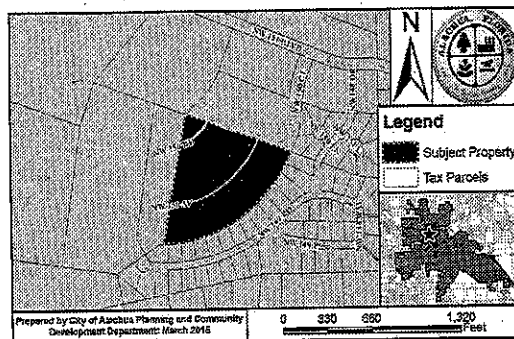

At the public hearing, all interested parties may appear and be heard with respect to the proposed ordinance. Copies of the proposed ordinance and related materials are available for public inspection at the Planning and Community Development Department, 15100 NW 142nd Terrace, on any regular business day between the hours of 7:30 a.m. to 6:00 p.m. Written comments on the proposed ordinance may be sent to the following address: City of Alachua, Planning and Community Development, P.O. Box 9, Alachua, FL 32616. Notice is given pursuant to Section 286.0105, Florida Statutes, that, in order to appeal any decision made at the public hearing, you will need a record of the proceedings, and that, for such purpose, you may need to ensure that a verbatim record of the proceedings is made, which includes the testimony and evidence upon which the appeal is to be based. In accordance with the Americans with Disabilities Act, any persons with a disability requiring reasonable accommodation in order to participate in this meeting should call the City Clerk at (386) 418-6100 x 101 at least 48 hours prior to the public hearing.



City of
ALACHUA

THE GOOD LIFE COMMUNITY

*Mailed 5/20/15
amk*

NOTICE OF PUBLIC HEARING BEFORE THE CITY COMMISSION OF THE CITY OF ALACHUA, FLORIDA

Notice is hereby given that the City Commission of the City of Alachua will hold a public hearing on the following proposed ordinance. The hearing will be held on June 8, 2015 at 6:30 p.m. in the James A. Lewis Commission Chambers in City Hall, located at 15100 NW 142nd Terrace, Alachua, Florida.

The title of the proposed ordinance is as follows:

ORDINANCE 15 06

AN ORDINANCE OF THE CITY OF ALACHUA, FLORIDA, RELATING TO THE AMENDMENT OF THE OFFICIAL ZONING ATLAS; AMENDING THE OFFICIAL ZONING ATLAS FROM RESIDENTIAL MULTIPLE FAMILY - 8 ("RMF-8") TO RESIDENTIAL MULTIPLE FAMILY - 15 ("RMF-15") ON APPROXIMATELY 12.12 ACRES; LOCATED SOUTH OF NW 151ST BLVD AND PARK VEGETARIANA; NORTH OF CLOVER RANCH ESTATES AND WYNDSWEEP HILLS; EAST OF U.S. INTERSTATE HIGHWAY 75 (I-75); AND WEST OF WYNDSWEEP HILLS AND SANTA FE STATION; ALACHUA, FLORIDA. A PORTION OF TAX PARCEL NUMBER 03863-002-001; PROVIDING A REPEALING CLAUSE; PROVIDING SEVERABILITY; AND PROVIDING AN EFFECTIVE DATE.

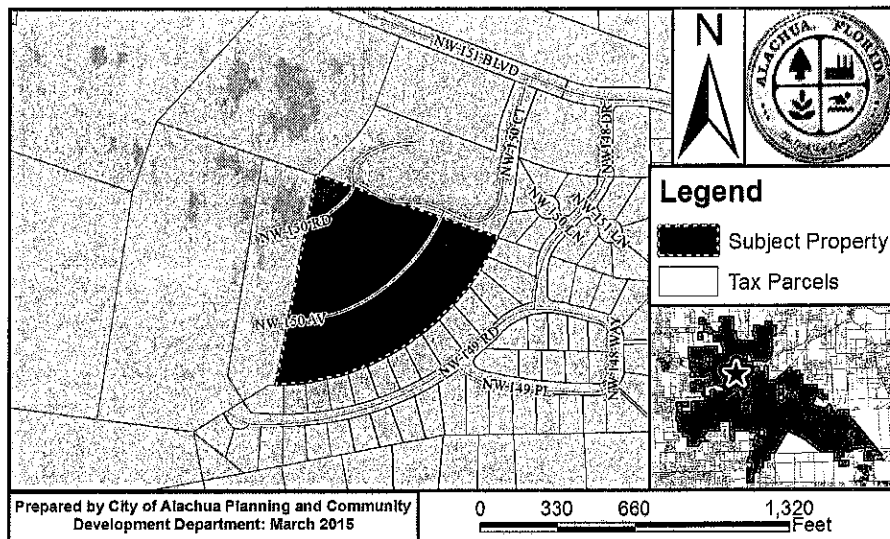

At the public hearing, all interested parties may appear and be heard with respect to the proposed ordinance. Copies of the proposed ordinance and related materials are available for public inspection at the Planning and Community Development Department, 15100 NW 142nd Terrace, on any regular business day between the hours of 7:30 a.m. to 6:00 p.m. Written comments on the proposed ordinance may be sent to the following address: City of Alachua, Planning and Community Development, P.O. Box 9, Alachua, FL 32616. Notice is given pursuant to Section 286.0105, Florida Statutes, that, in order to appeal any decision made at the public hearing, you will need a record of the proceedings, and that, for such purpose, you may need to ensure that a verbatim record of the proceedings is made, which includes the testimony and evidence upon which the appeal is to be based. In accordance with the Americans with Disabilities Act, any persons with a disability requiring reasonable accommodation in order to participate in this meeting should call the City Clerk at (386) 418-6100 x 101 at least 48 hours prior to the public hearing.

P.O. Box 9 ❖ Alachua, Florida 32616-0009
Phone: (386) 418-6121 ❖ Fax: (386) 418-6130

03863-001-000
CRUISE D M
14606 NW 154TH TER
ALACHUA FL 32615-4873

03863-002-000
R & J MCCAULEY LLC
15260 NW 147TH DR
ALACHUA FL 32615

03863-002-001
ALACHUA DEVELOPMENT LLC
5405 CYPRESS CENTER DR STE 320
TAMPA FL 33609

03863-020-005
FORD & GOODE
14849 NW 151ST LN
ALACHUA FL 32615

03863-020-006
SHAH PARUL
PO BOX 818
ALACHUA FL 32616

03863-020-007
NEWMAN ERIC M
3954 SW 21ST TER
Gainesville FL 32608

03863-020-008
CROUCH JOHNNY D
4006 NW 60TH AVE
GAINESVILLE FL 32653

03863-020-019
KINETIC PROPERTIES INC
6302 NW 18TH AVE
GAINESVILLE FL 32605

03863-020-020
DURATION BUILDERS INC
527 TURKEY CREEK
ALACHUA FL 32615

03863-020-023
DURATION BUILDERS INC
527 TURKEY CREEK
ALACHUA FL 32615

03863-020-024
KENNEDY DANIEL W
15161 NW 149TH RD
Alachua FL 32615

03863-020-025
JOAQUIN REUEL R
15195 NW 149TH RD
Alachua FL 32615

03863-020-026
STARITA GLORIA
PO BOX 1106
HAWTHORNE FL 32640-1106

03863-020-027
RWSPMS LLC
PO BOX 1977
ALACHUA FL 32616

03863-020-028
RWSPMS LLC
PO BOX 1977
Alachua FL 32616-1977

03863-020-033
RWSPMS LLC
PO BOX 1977
ALACHUA FL 32616-1977

03863-020-034
BRYANT WAYNE C
PO BOX 474
STEINHATCHEE FL 32359

03863-020-035
RBI ELECTRICAL CONTRACTING
LLC
22103 NW CR 235A
Alachua FL 32615

03863-020-036
SANTE FE STATION DEVELOPMENT
LLC
9417 NW 43RD ST
GAINESVILLE FL 32653

03863-020-037
ELITE AUTO CENTER OF
GAINESVILLE INC
907 SW 3RD ST
Gainesville FL 32601-7935

03863-020-038
MURPHY JAVON D
15122 NW 149TH RD
Alachua FL 32615

03863-020-039
BRYANT WAYNE C
PO BOX 474
STEINHATCHEE FL 32359

03863-020-040
ROVANSEK KIMBERLY
15068 NW 149TH RD
ALACHUA FL 32615

03863-020-041
JERNIGAN WILLIAM E JR
15040 NW 149TH RD
ALACHUA FL 32615

03863-020-042
OSBURN JAMES LEE
15014 NW 149TH RD
ALACHUA FL 32615

03863-020-043
HARVEY JAMES F
14972 NW 148TH RD
ALACHUA FL 32615

03863-020-044
HOWELL PAMELA C
15006 NW 148TH DR
Alachua FL 32615

03863-020-045
DURATION BUILDERS INC
527 TURKEY CREEK
ALACHUA FL 32615

03863-020-047
WETHERINGTON MARILYN E
3730 SE 14TH TER
GAINESVILLE FL 32641

03863-020-048
DURATION BUILDERS INC
527 TURKEY CREEK
ALACHUA FL 32615

03863-020-049
FLORIDA VICENTE C
14974 NW 150TH LN
Alachua FL 32669

03863-020-051
RBI ELECTRICAL CONTRACTING
LLC
22103 NW COUNTY RD 235A
Alachua FL 32615

03863-020-052
NORMAN RONNIE C
14913 NW 149TH RD
ALACHUA FL 32615

03863-020-059
CASWELL CHAD W
14936 NW 149TH PL
ALACHUA FL 32615

03863-020-060
CLAYTON MICHAEL
14970 NW 149TH PL
Alachua FL 32615-0260

03864-004-000
LYND DONALD W
PO BOX 2164
ALACHUA FL 32616-2164

03864-004-001
KENNEDY E K
PO BOX 2340
ALACHUA FL 32616-2340

03864-005-000
ROSSOW THOMAS C
15302 NW 147TH AVE
ALACHUA FL 32615

03864-005-001
MARKHAM FRANCES LIFE
ESTATE
15326 NW 147TH AVE
ALACHUA FL 32615

03864-006-000
CRUISE D M
14606 NW 154TH TER
ALACHUA FL 32615-4873

03863-020-050
VISION CONSTRUCTION INC
3201 NW 202ND ST
Newberry FL 32669

03863-020-046
SANTE FE STATION DEVELOPMENT
LLC
9417 NW 43RD ST
GAINESVILLE FL 32653

03863-020-029
SOUTHWELL RONALD K
1114 SW 79TH TER
GAINESVILLE FL 32607

03863-020-053
REALTY SOLUTIONS OF NORTH
FLORIDA INC
4802 SW 85TH AVE
Gainesville FL 32608

03863-020-022
KIRKPATRICK RANDY D
15113 NW 149TH RD
ALACHUA FL 32615

03863-020-030
BEACH KENNETH N
PMB 162
7257 NW 4TH BLVD # 162
GAINESVILLE FL 32607-1600

03863-020-021
DURATION BUILDERS INC
527 TURKEY CREEK
ALACHUA FL 32615

03869-007-001
ALACHUA DEVELOPMENT LLC
5405 CYPRESS CENTER DR STE 320
TAMPA FL 33609

03869-006-000
WYNDWEPT HILLS LLC
PO BOX 474
STEINHATCHEE FL 32359

03869-007-000
10.47 LLC
15260 NW 147TH DR
ALACHUA FL 32615

03869-009-000
10.47 LLC
15260 NW 147TH DR
ALACHUA FL 32615

03863-020-031
PELFREY GREGG M
15373 NE 149TH RD
ALACHUA FL 32615-0257

03863-020-000
WYNDWEPT HILLS
HOMEOWNERS ASSOCIATION INC
PO BOX 310
Alachua FL 32616-0310

03863-020-032
ALBAUGH & PIERATT H/W
15328 NW 149TH RD
ALACHUA FL 32615

ANTOINETTE ENDELICATO
5562 NW 93RD AVENUE
GAINESVILLE FL 32653

DAN RHINE
288 TURKEY CREEK
ALACHUA FL 32615

BILL ATWATER
6017 NW 115TH PLACE
ALACHUA FL 32615

TOM GORMAN
9210 NW 59TH STREET
ALACHUA FL 32653

RICHARD GORMAN
5716 NW 93RD AVENUE
ALACHUA FL 32653

PEGGY ARNOLD
410 TURKEY CREEK
ALACHUA FL 32615

DAVID FOREST
23 TURKEY CREEK
ALACHUA FL 32615

JOHN TINGUE
333 TURKEY CREEK
ALACHUA FL 32615

PRESIDENT
TCMOA
1000 TURKEY CREEK
ALACHUA FL 32615

LINDA DIXON, AICP
ASSISTANT DIRECTOR PLANNING
UNIVERSITY OF FLORIDA
PO BOX 115050
GAINESVILLE FL 32611

CRAIG PARENTEAU
FL DEPARTMENT OF
ENVIRONMENTAL PROTECTION
4801 CAMP RANCH ROAD
GAINESVILLE FL 32641

LAURA WILLIAMS
12416 NW 148TH AVENUE
ALACHUA FL 32615

JEANNETTE HINSDALE
PO BOX 1156
ALACHUA FL 32616

LYNN COULLIAS
7406 NW 126TH AVENUE
ALACHUA FL 32615

LYNDA COON
7216 NW 126TH AVENUE
ALACHUA FL 32615

TRACI L. CAIN, CITY MANAGER
CITY OF ALACHUA
PO BOX 9
ALACHUA FL 32616-0009

AFFIDAVIT FOR POSTED LAND USE SIGN

I ANDREW COFFEY, POSTED THE LAND USE
SIGN ON 4/27/15 FOR THE One 51 Place Zoning 5/11, 6/8, 6/22/15
LAND USE ACTION.
(Name) (Date) (State type of action and project name)

AS PER ARTICLE 2.2.9 D OF THE LAND DEVELOPMENT REGULATIONS.

THIS WILL BE INCLUDED IN THE STAFF REPORT.

(Signature)

1
(Number of signs)