



City of ALACHUA

PUBLIC NOTICE OF ENACTMENT OF AN ORDINANCE OF THE CITY OF ALACHUA, FLORIDA

NOTICE OF PUBLIC HEARING BEFORE THE CITY COMMISSION OF THE CITY OF ALACHUA, FLORIDA

Notice is hereby given that the City Commission of the City of Alachua will hold a public hearing on a proposed ordinance. The hearing will be held on November 9, 2015, at 6:30 p.m., in the James A. Lewis Commission Chambers in City Hall, located at 15100 NW 142nd Terrace, Alachua, Florida.

The ordinance title is as follows:

ORDINANCE 15-14

AN ORDINANCE OF THE CITY OF ALACHUA, FLORIDA, RELATING TO THE AMENDMENT OF THE OFFICIAL ZONING ATLAS; AMENDING THE OFFICIAL ZONING ATLAS FROM INDUSTRIAL SERVICES AND MANUFACTURING (MP) (ALACHUA COUNTY) TO LIGHT AND WAREHOUSE INDUSTRIAL (ILW) ON APPROXIMATELY 45.42 ACRES; AMENDING THE OFFICIAL ZONING ATLAS FROM INDUSTRIAL SERVICES AND MANUFACTURING (MP) (ALACHUA COUNTY) TO COMMERCIAL INTENSIVE (CI) ON APPROXIMATELY 18.02 ACRES; AMENDING THE OFFICIAL ZONING ATLAS FROM INDUSTRIAL SERVICES AND MANUFACTURING (MP) (ALACHUA COUNTY) TO COMMUNITY COMMERCIAL (CC) ON APPROXIMATELY 1 ACRE; LOCATED NORTH OF U.S. HIGHWAY 441; SOUTH OF THE SEABOARD COASTLINE RAILROAD, EAST OF NORTHWEST 89th STREET, AND ADJACENT TO THE PHOENIX COMMERCIAL PARK, ALACHUA, FLORIDA. TAX PARCEL NUMBERS 05855-002-000, 05855-003-000, 05962-001-000, AND 05962-002-000; PROVIDING A REPEALING CLAUSE; PROVIDING SEVERABILITY; AND PROVIDING AN EFFECTIVE DATE.

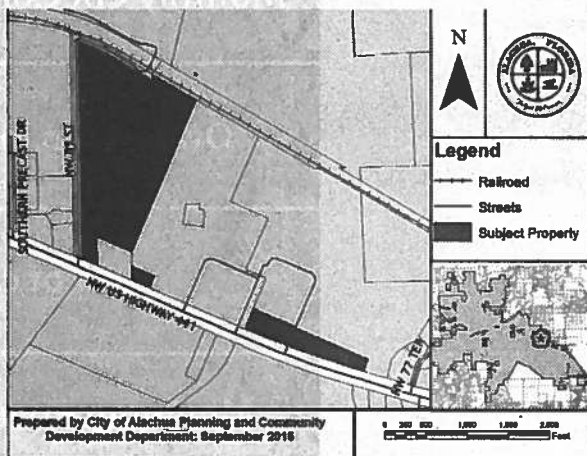

At the public hearing, all interested parties may appear and be heard with respect to the application. Copies of the application are available for public inspection at the Planning and Community Development Department, 15100 NW 142nd Terrace, Alachua, Florida, on any regular business day between the hours of 7:30 a.m. to 6:00 p.m. Written comments on the application may be sent to the following address: City of Alachua, Planning and Community Development, P.O. Box 9, Alachua, FL 32616. Notice is given pursuant to Section 286.0105, Florida Statutes, that, in order to appeal any decision made at the public hearing, you will need a record of the proceedings, and that, for such purpose, you may need to ensure that a verbatim record of the proceedings is made, which includes the testimony and evidence upon which the appeal is to be based. In accordance with the Americans with Disabilities Act, any persons with a disability requiring reasonable accommodation in order to participate in this meeting should call the City Clerk at (386) 418-6100 x 101 at least 48 hours prior to the public hearing.

(Published: Alachua County Today - October 29, 2015)

MAPS

From Page B1

and loosened restrictions on beer-growler sales, said he expected to lose Gainesville, the University of Florida and most, if not all, of Alachua County.

“I served on the redistricting committee and we reviewed all nine maps submitted by the League of Women Voters and the plaintiffs and did so because they declined an invitation to appear before the committee,” Bradley said Wednesday.

“Five of the nine maps split Alachua County so I’m genuinely perplexed by the argument coming up now that it is somehow problematic to have a map that splits Alachua County and still comply with the Constitution,” he said.

On the eve of Wednesday’s Senate vote, the plaintiffs submitted a map that would place all of Alachua County in a new District 7 with Gilchrist, Levy and western Marion County.

Under that scenario, Clay County was in an upside-down horse-shoe-shaped district that also included Putnam, Bradford, Union, Baker, Columbia, Suwannee, Dixie and Lafayette counties.

Multiple maps prepared

State Senate redistricting

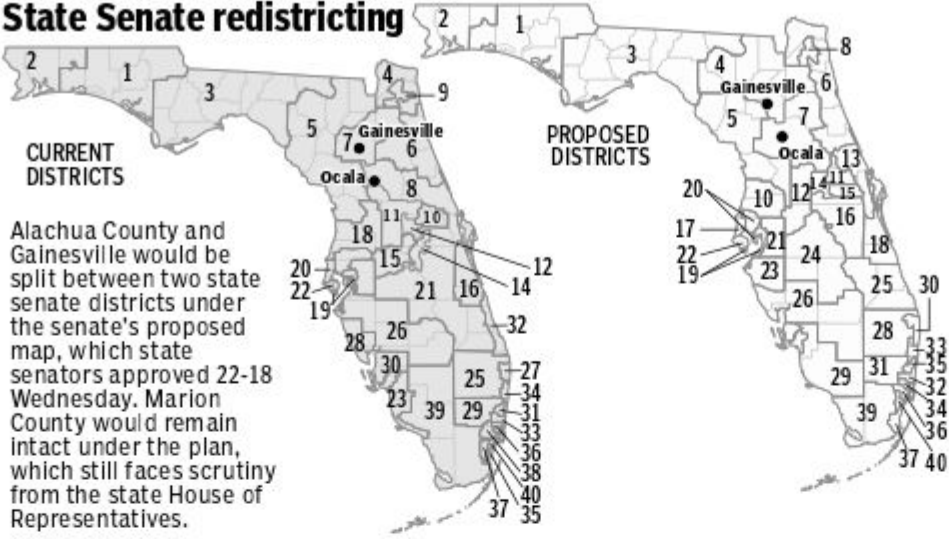

Source: Florida Senate

by Senate staff would have kept Alachua County whole and could have pitted Bradley and St. Johns County Republican Travis Hutson against one another.

The battle over the Florida Senate presidency added some political intrigue to Latvala’s criticism of splitting Alachua County, because Bradley and Hutson both support Stuart Republican Joe Negron as the next Senate president.

The maps the Senate approved Wednesday — with every Democrat and a handful of Republicans in opposition — divide Alachua County and Gainesville between newly drawn districts 4 and 5.

Gainesville is the only divided city and Alachua

County is the only divided county in the two districts.

District 4 includes Clay, Baker, Bradford, Union, Columbia, Suwannee and Lafayette counties and the eastern, northern and northwestern areas of Alachua County. That district would have 87,632 total county residents, including 41,880 in Gainesville.

The new district 5 would include western Alachua County, with the exception of the northwest area, with 159,704 Alachua County residents, including 82,474 in Gainesville. The district would stretch west to include Dixie, Gilchrist and Levy counties, then wind south, picking up Citrus and Sumter.

That district’s 133-mile length from its northern

boundary to its southern tip makes it the third longest of the 40 senate districts and more than twice the 62.3-mile average.

Speaking about the contours of that district, Bradley said he felt senators had to try and strike a balance between compact and contiguous districts and trying to follow the political boundaries of counties.

He said the maps the

Senate advanced Wednesday split counties less often than other options and followed natural boundaries, such as rivers, as much as possible.

While the redistricting process divided Alachua County, it unified Marion County into one district. Previously divided between Florida Senate districts 5, 8, and 11, Marion County would now stay whole in a district that includes Putnam and northern Lake.

The maps go to the Florida House next week. State Senate President Andy Gardiner R-Orlando said the two houses may then have to try and reach

a compromise.

With the World Series underway, Gardiner said “we’re in the first inning.”

Earlier in the week, State Rep. Keith Perry, R-Gainesville, said he felt Alachua County could benefit from being split into two districts. He said that would give the county two representatives in Tallahassee pushing for funding and other issues.

Perry said he’s been contacted about his interest in running for one of the two Alachua County senate districts, should the county remain split in the final map. But he said he hasn’t decided.

FUNDRAISE

From Page B1

heart doesn’t receive the amount of proper circulation and his condition keeps him from lung or heart transplant eligibility.

“When his left lung fails, it’ll fail,” Booth said. “And then probably his heart will go soon after that.”

Though his bouncing personality doesn’t show it, Austin’s also too weak for another open heart surgery; he has already had two. Instead the doctors and family have resorted to placing stents and coils to keep his arteries open.

“Basically whenever his time is through, he’ll go to heaven,” his mother said.

After watching Austin’s health continue to decline and Booth struggle to make the most of their remaining time, Booth’s best friend, Michelle Lee, created a fundraising campaign on GoFundMe.com entitled “Austin’s Dream Hunt 2015” to cover the cost Austin’s passion: hunting. As of Wednesday, they have raised \$125 toward their goal of \$1,500.

Lee said because of his illness, he can’t run and play like most children because he’ll get out of breath quickly, so hunting has become one of the few recreational outlets that Austin can enjoy. Lee said she’s watched Booth struggle to provide the money to drive and fly Austin to hunting locations.

“She doesn’t have anybody to help her, but she’ll do it anyway,” Lee said.

The campaign was made in hopes of granting Austin’s wish to hunt a whitetail or red deer, animals that, at the mention, cause his camouflage hat-covered head to perk up and arms to lift to demonstrate how large deer are.

“They’re huge,” he said with widened eyes.

The family hopes to raise the money to cover the cost of traveling to its three hunting grounds in Missouri, South Carolina and Alabama over the next year.

Upon arrival, the hunting company Buckmasters will cover the cost of shelter, food and training, which it does for disabled veterans and families with children who have life-threatening diseases.

For Austin, the list of illnesses he faces is



A photo in an album shows Austin Booth with Troy Landry, star of the TV Show “Swamp People” earlier this year. MATT STAMEY/STAFF PHOTOGRAPHER

extensive.

He was diagnosed at birth with complex congenital heart disease, heterotaxi (two right lungs), a heart with only one ventricle (instead of two), cyanosis (lack of oxygen which turns his skin blue) and aspenia (abnormal spleen).

In his short life, he’s already undergone a slew of surgeries including two open-heart surgeries, nine heart catheterizations and nine stents and coils and a surgery that untwisted his bowels from his heart.

According to Booth, doctors discovered a hole in her son’s heart during the 27th week of pregnancy, but doctors still don’t know what caused it or how the other abnormalities sprouted.

Booth also has a 14-year-old daughter, Savannah, who was born healthy.

As if his health concerns weren’t enough, his wheelchair and blue skin have subjected him to bullying at school.

Last year, his mother had to request that the bathroom be cleared when Austin uses it. According to Booth, boys picked up her son and threw him against a wall.

Austin said he feels scared whenever other students bully him.

Booth said she struggles as a widowed, single mother to provide a good life for both children, despite working as a nurse in the cardiology department at Spring Hill for UF Health. She said she’s often caught between paying the cable bills and taking money out to go on hunting trips with her ailing son.

Austin surpassed doctors’ expectations Tuesday by celebrating his ninth birthday with his supportive family. They celebrated his birthday with a trip to Legoland.

“I always try to make sure he’s happy. I try to make sure he fulfills everything he wants to fulfill — that he never goes without,” Booth said. “Because I never want to regret something

that I could’ve done or wish I would’ve done.”

Donations may be made at <https://www.gofundme.com/7v2a2p6k>.

PUBLIC NOTICE OF ENACTMENT OF AN ORDINANCE OF THE CITY OF ALACHUA, FLORIDA

NOTICE OF PUBLIC HEARING BEFORE THE CITY COMMISSION OF THE CITY OF ALACHUA, FLORIDA

Notice is hereby given that the City Commission of the City of Alachua will hold a public hearing on a proposed ordinance. The hearing will be held on November 9, 2015, at 6:30 p.m., in the James A. Lewis Commission Chambers in City Hall, located at 15100 NW 142nd Terrace, Alachua, Florida.

The ordinance title is as follows:

ORDINANCE 15-13

AN ORDINANCE OF THE CITY OF ALACHUA, FLORIDA, RELATING TO THE LARGE SCALE AMENDMENT OF THE CITY OF ALACHUA COMPREHENSIVE PLAN FUTURE LAND USE MAP; 2015; AMENDING THE FUTURE LAND USE MAP CLASSIFICATION FROM RURAL EMPLOYMENT CENTER (ALACHUA COUNTY) TO INDUSTRIAL ON APPROXIMATELY 45.42 ACRES; AMENDING THE FUTURE LAND USE MAP CLASSIFICATION FROM RURAL EMPLOYMENT CENTER (ALACHUA COUNTY) TO COMMERCIAL ON APPROXIMATELY 18.02 ACRES; AMENDING THE FUTURE LAND USE MAP CLASSIFICATION FROM RURAL EMPLOYMENT CENTER (ALACHUA COUNTY) TO COMMUNITY COMMERCIAL ON APPROXIMATELY 1 ACRE; LOCATED NORTH OF US HIGHWAY 441; SOUTH OF THE SEABOARD COASTLINE RAILROAD, EAST OF NORTHWEST 89th STREET, AND ADJACENT TO THE PHOENIX COMMERCIAL PARK, ALACHUA, FLORIDA. TAX PARCEL NUMBERS 05855-002-000, 05855-003-000, 05962-001-000, AND 05962-002-000; PROVIDING A REPEALING CLAUSE; PROVIDING SEVERABILITY; AND PROVIDING AN EFFECTIVE DATE.

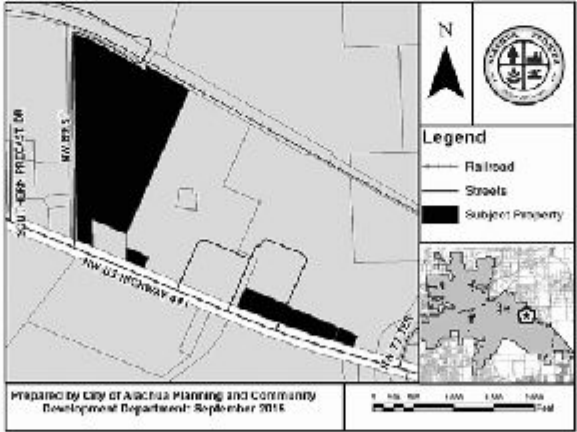

At the public hearing, all interested parties may appear and be heard with respect to the application. Copies of the application are available for public inspection at the Planning and Community Development Department, 15100 NW 142nd Terrace, Alachua, Florida, on any regular business day between the hours of 7:30 a.m. to 6:00 p.m. Written comments on the application may be sent to the following address: City of Alachua, Planning and Community Development, P.O. Box 9, Alachua, FL 32616. Notice is given pursuant to Section 286.0105, Florida Statutes, that, in order to appeal any decision made at the public hearing, you will need a record of the proceedings, and that, for such purpose, you may need to ensure that a verbatim record of the proceedings is made, which includes the testimony and evidence upon which the appeal is to be based. In accordance with the Americans with Disabilities Act, any persons with a disability requiring reasonable accommodation in order to participate in this meeting should call the City Clerk at (386) 418-6100 x 101 at least 48 hours prior to the public hearing.

“My friends all hate their cell phones... I love mine!” Here’s why.

“Cell phones have gotten so small, I can barely dial mine.”

Not Jitterbug®, it features a larger keypad for easier dialing. It even has an oversized display so you can actually see it.

Isn’t it time you found out more about the cell phone that’s changing all the rules? Call now, Jitterbug product experts are standing by.

NEW Jitterbug5 Cell Phone



Call toll free today to get your own Jitterbug5 phone. Please mention promotional code 60516.

1-888-714-5247 www.jitterbugdirect.com

PUBLIC NOTICE OF ENACTMENT OF AN ORDINANCE OF THE CITY OF ALACHUA, FLORIDA

NOTICE OF PUBLIC HEARING BEFORE THE CITY COMMISSION OF THE CITY OF ALACHUA, FLORIDA

Notice is hereby given that the City Commission of the City of Alachua will hold a public hearing on a proposed ordinance. The hearing will be held on November 9, 2015, at 6:30 p.m., in the James A. Lewis Commission Chambers in City Hall, located at 15100 NW 142nd Terrace, Alachua, Florida.

The ordinance title is as follows:

ORDINANCE 15-14

AN ORDINANCE OF THE CITY OF ALACHUA, FLORIDA, RELATING TO THE AMENDMENT OF THE OFFICIAL ZONING ATLAS; AMENDING THE OFFICIAL ZONING ATLAS FROM INDUSTRIAL SERVICES AND MANUFACTURING (MP) (ALACHUA COUNTY) TO LIGHT AND WAREHOUSE INDUSTRIAL (ILW) ON APPROXIMATELY 45.42 ACRES; AMENDING THE OFFICIAL ZONING ATLAS FROM INDUSTRIAL SERVICES AND MANUFACTURING (MP) (ALACHUA COUNTY) TO COMMERCIAL INTENSIVE (CI) ON APPROXIMATELY 18.02 ACRES; AMENDING THE OFFICIAL ZONING ATLAS FROM INDUSTRIAL SERVICES AND MANUFACTURING (MP) (ALACHUA COUNTY) TO COMMUNITY COMMERCIAL (CC) ON APPROXIMATELY 1 ACRE; LOCATED NORTH OF U.S. HIGHWAY 441; SOUTH OF THE SEABOARD COASTLINE RAILROAD, EAST OF NORTHWEST 89th STREET, AND ADJACENT TO THE PHOENIX COMMERCIAL PARK, ALACHUA, FLORIDA. TAX PARCEL NUMBERS 05855-002-000, 05855-003-000, 05962-001-000, AND 05962-002-000; PROVIDING A REPEALING CLAUSE; PROVIDING SEVERABILITY; AND PROVIDING AN EFFECTIVE DATE.

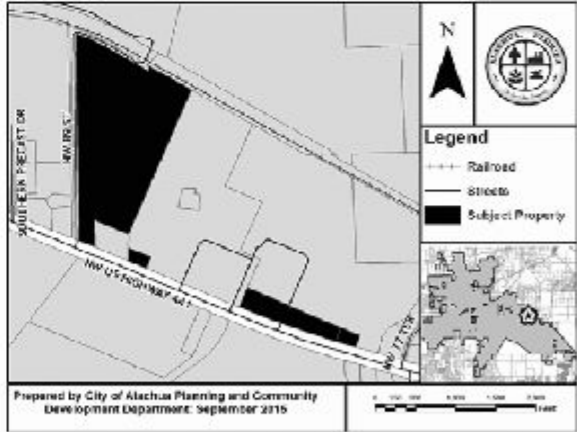

At the public hearing, all interested parties may appear and be heard with respect to the application. Copies of the application are available for public inspection at the Planning and Community Development Department, 15100 NW 142nd Terrace, Alachua, Florida, on any regular business day between the hours of 7:30 a.m. to 6:00 p.m. Written comments on the application may be sent to the following address: City of Alachua, Planning and Community Development, P.O. Box 9, Alachua, FL 32616. Notice is given pursuant to Section 286.0105, Florida Statutes, that, in order to appeal any decision made at the public hearing, you will need a record of the proceedings, and that, for such purpose, you may need to ensure that a verbatim record of the proceedings is made, which includes the testimony and evidence upon which the appeal is to be based. In accordance with the Americans with Disabilities Act, any persons with a disability requiring reasonable accommodation in order to participate in this meeting should call the City Clerk at (386) 418-6100 x 101 at least 48 hours prior to the public hearing.



THE GOOD LIFE COMMUNITY

*CLM I Sperring
Mailed - 10/26/15*

PUBLIC NOTICE OF ENACTMENT OF AN ORDINANCE OF THE CITY OF ALACHUA, FLORIDA

NOTICE OF PUBLIC HEARING BEFORE THE CITY COMMISSION OF THE CITY OF ALACHUA, FLORIDA

Notice is hereby given that the City Commission of the City of Alachua will hold a public hearing on proposed ordinance. The hearing will be held on November 9, 2015, at 6:30 p.m., in the James A. Lewis Commission Chambers in City Hall, located at 15100 NW 142nd Terrance, Alachua, Florida.

The ordinance title is as follows:

ORDINANCE 15-14

AN ORDINANCE OF THE CITY OF ALACHUA, FLORIDA, RELATING TO THE AMENDMENT OF THE OFFICIAL ZONING ATLAS; AMENDING THE OFFICIAL ZONING ATLAS FROM INDUSTRIAL SERVICES AND MANUFACTURING (MP) (ALACHUA COUNTY) TO LIGHT AND WAREHOUSE INDUSTRIAL (ILW) ON APPROXIMATELY 45.42 ACRES; AMENDING THE OFFICIAL ZONING ATLAS FROM INDUSTRIAL SERVICES AND MANUFACTURING (MP) (ALACHUA COUNTY) TO COMMERCIAL INTENSIVE (CI) ON APPROXIMATELY 18.02 ACRES; AMENDING THE OFFICIAL ZONING ATLAS FROM INDUSTRIAL SERVICES AND MANUFACTURING (MP) (ALACHUA COUNTY) TO COMMUNITY COMMERCIAL (CC) ON APPROXIMATELY 1 ACRE; LOCATED NORTH OF U.S. HIGHWAY 441; SOUTH OF THE SEABOARD COASTLINE RAILROAD, EAST OF NORTHWEST 98th STREET, AND ADJACENT TO THE PHOENIX COMMERCIAL PARK, ALACHUA, FLORIDA. TAX PARCEL NUMBERS 05855-002-000, 05855-003-000, 05962-001-000, AND 05962-002-000; PROVIDING A REPEALING CLAUSE; PROVIDING SEVERABILITY; AND PROVIDING AN EFFECTIVE DATE.



City of
ALACHUA

THE GOOD LIFE COMMUNITY

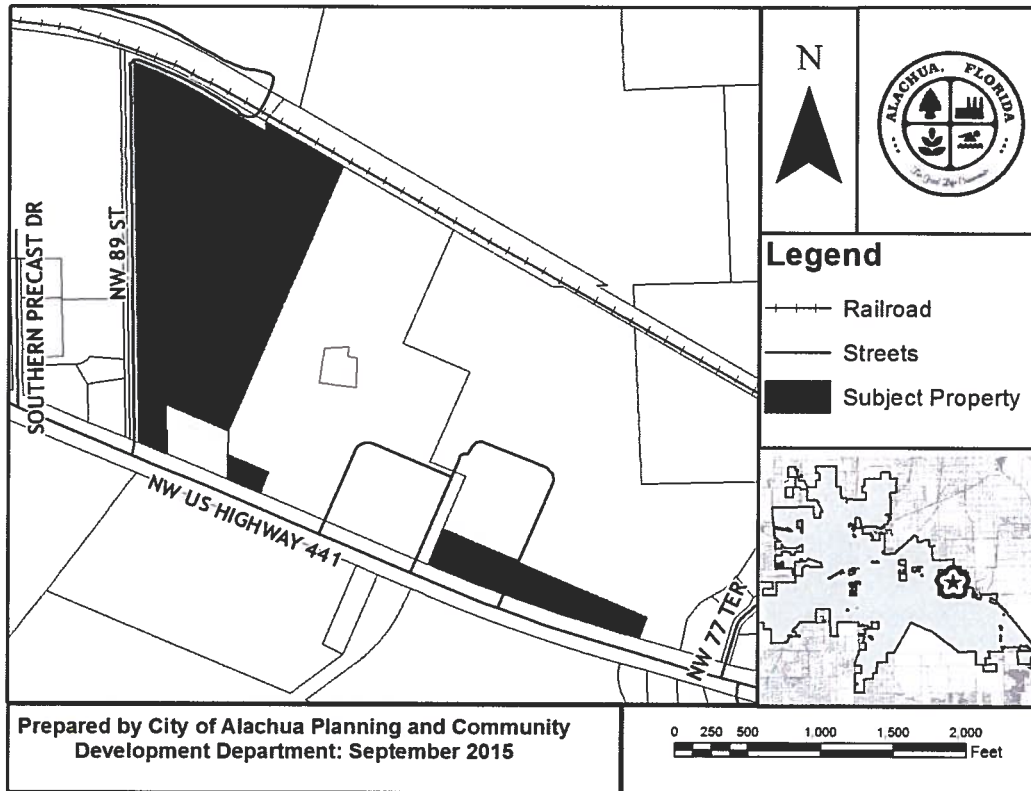

At the public hearing, all interested parties may appear and be heard with respect to the application. Copies of the application are available for public inspection at the Planning and Community Development Department, 15100 NW 142nd Terrace, Alachua, Florida, on any regular business day between the hours of 7:30 a.m. to 6:00 p.m. Written comments on the application may be sent to the following address: City of Alachua, Planning and Community Development, P.O. Box 9, Alachua, FL 32616. Notice is given pursuant to Section 286.0105, Florida Statutes, that, in order to appeal any decision made at the public hearing, you will need a record of the proceedings, and that, for such purpose, you may need to ensure that a verbatim record of the proceedings is made, which includes the testimony and evidence upon which the appeal is to be based. In accordance with the Americans with Disabilities Act, any persons with a disability requiring reasonable accommodation in order to participate in this meeting should call the City Clerk at (386) 418-6100 x 101 at least 48 hours prior to the public hearing.

CCDM RZ Sperring
mailed

✓ Sperring & Sperring Sr Co-Trustees
2928 NW 22nd St
Gainesville, FL 32605 (31)

✓ Lithium Nickel Asset Holding Company
3 Expressway Plaza
Roslyn Heights, NY 11577

✓ Tom R & Associates LLC
11 SE 2nd Ave
Gainesville, FL 32601

✓ Phoenix Commercial Park LLP
PO Box 1000
Alachua, FL 32616

✓ F&R Holdings of Gainesville LLC
50 Partridge Way
Shelburne, VT 05482

✓ Lowe Michael S Trustee
13929 NW 89th St
Alachua, FL 32615

✓ F&R Holdings of Gainesville LLC
& Lowe Trustee
13929 NW 89th St
Alachua, FL 32615

✓ F&R Holdings of Gainesville LLC
& Lowe Trustee
220 NW 122nd St
Gainesville, FL 32607

✓ Helena Chemical Co
225 Schilling Blvd Ste 300
Collierville, TN 38017

✓ Quinn Adams #5 LLC
12707 NW 77th Ter
Alachua, FL 32615

✓ MCB Oil Company
327 Turkey Creek
Alachua, FL 32615

✓ McBride Donald Wesley Trustee
327 Turkey Creek
Alachua, FL 32615

✓ U of F Foundation Inc
PO Box 14425
Gainesville, FL 32604

✓ Duke Energy Florida Inc
Tax Dept - DEC41B
550 S Tryon Street
Charlotte, NC 28202

✓ Pinkoson & Pinkoson & Upshaw
Co-trustees
2820 NW 38th Drive
Gainesville, FL 32605

✓ Phoenix Commercial Park LLLP
14610 NW 129th Ter
Alachua, FL 32615

✓ Highway 441 Holdings LLC
100 Amberwood Court
Longwood, FL 32779

✓ Triple LLC
PO Box 641
Canal Fulton, OH 44164

✓ Design Cabinet & Furniture Inc
13313 Southern Precast Dr
Alachua, FL 32615

✓ Weshow JF
204 SE 1st St
Gainesville, FL 32601

✓ CSX Transportation Inc
500 Water Street
Jacksonville, FL 32202

✓ Antoinette Endelicato
5562 NW 93rd Avenue
Gainesville, FL 32653

✓ Dan Rhine
288 Turkey Creek
Alachua, FL 32615

✓ Bill Atwater
6017 NW 115th Place
Alachua, FL 32615

✓ Tom Gorman
9210 NW 59th Street
Alachua, FL 32653

✓ Richard Gorman
5716 NW 93rd Avenue
Alachua, FL 32653

✓ Peggy Arnold
410 Turkey Creek
Alachua, FL 32615

✓ David Forest
23 Turkey Creek
Alachua, FL 32615

✓ John Tingle
333 Turkey Creek
Alachua, FL 32615

✓ President TCMOA
1000 Turkey Creek
Alachua, FL 32615

✓ Linda Dixon, AICP
PO Box 115050
Gainesville, FL 32611

✓ Craig Parenteau
FDEP
4801 Camp Ranch Road
Gainesville, FL 32641

✓ Laura Williams
12416 NW 148th Avenue
Alachua, FL 32615

✓ Jeannette Hinsdale
PO Box 1156
Alachua, FL 32616

✓ Lynn Coullias
7406 NW 126th Avenue
Alachua, FL 32615

✓ Lynda Coon
7216 NW 126th Avenue
Alachua, FL 32615

AFFIDAVIT FOR POSTED LAND USE SIGN

I Craig Brashier, POSTED THE LAND USE
(Name)
SIGN ON 9/28/15 FOR THE Sperring Properties Plan Amendment
(Date) (State type of action and project name)
LAND USE ACTION.

AS PER ARTICLE 2.2.9 D OF THE LAND DEVELOPMENT REGULATIONS.

THIS WILL BE INCLUDED IN THE STAFF REPORT.

(Signature)

7
(Number of signs)