

NOTICE OF PUBLIC HEARING BEFORE THE PLANNING AND ZONING BOARD OF THE CITY OF ALACHUA, FLORIDA

Notice is hereby given that the Planning & Zoning Board of the City of Alachua will hold a public hearing(s) on April 19th, 2016 at 6:30 p.m. The hearing(s) will be held in the James A. Lewis Commission Chambers in City Hall, located at 15100 NW 142nd Terrace, Alachua, Florida, to consider the following: A request by Ryan Thompson, AICP, of Causseaux, Hewett, & Walpole, Inc., applicant and agent, for Upland Properties of NCF, LLC, property owners, for consideration of a Small Scale Comprehensive Plan Amendment (SSCPA) to the City of Alachua Future Land Use Map from Industrial to Commercial. The ± 2.5 acre property subject to the proposed amendment is located south of NW US HWY 441, east of Southern Custom Truck and Auto Accessories, and west of Webster Veterinary Supply, consisting of Tax Parcel Nos. 05964-002-001, 05964-002-006, and portion of 05964-002-00. Existing FLUM: Industrial; Zoning: ILW (Light and Warehouse Industrial).

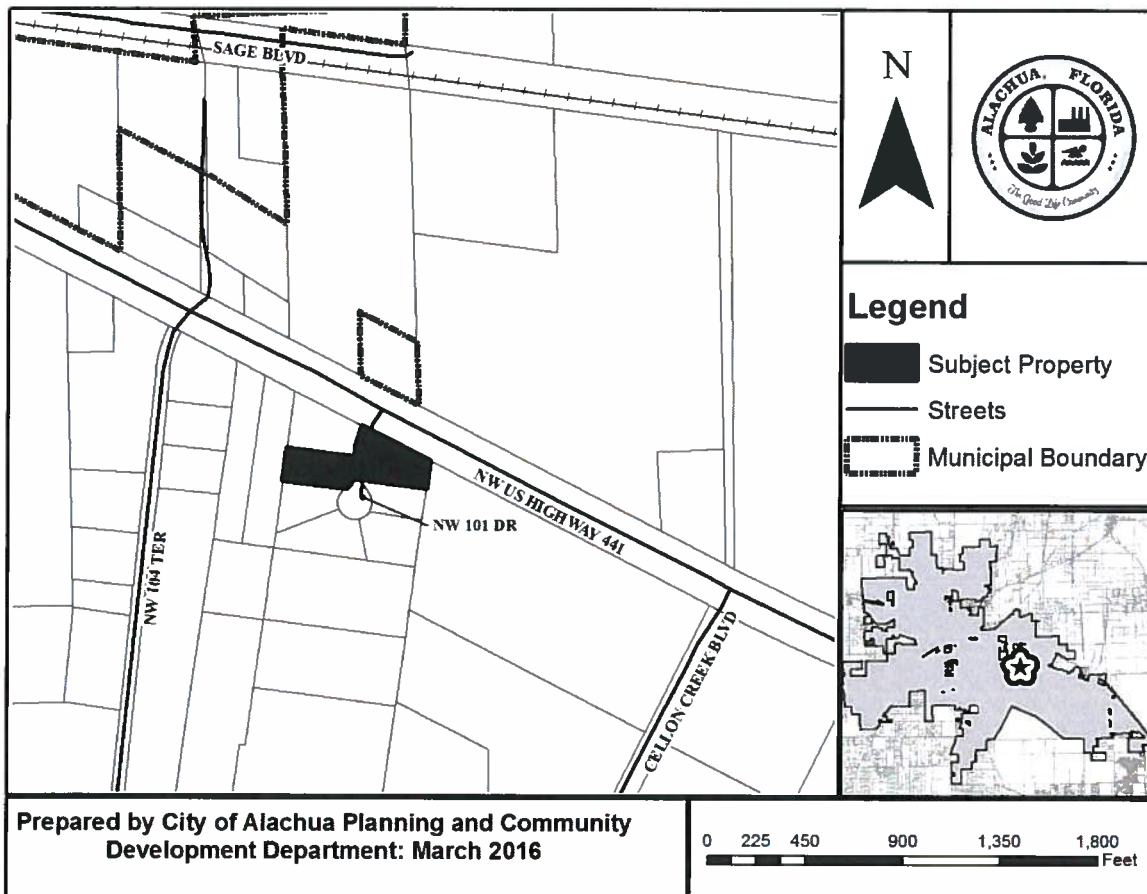

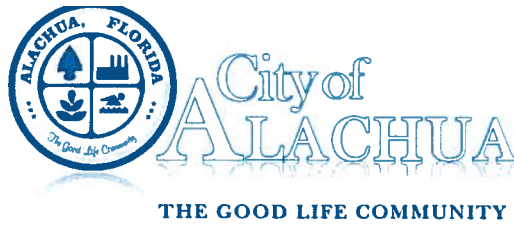

Mailed 3/31/16 amr

At the public hearing, all interested parties may appear and be heard with respect to the application. Copies of the application are available for public inspection at the Planning and Community Development Department, 15100 NW 142nd Terrace, Alachua, Florida, on any regular business day between the hours of 7:30 a.m. to 6:00 p.m. Written comments on the application may be sent to the following address: City of Alachua, Planning and Community Development, P.O. Box 9, Alachua, FL 32616. Notice is given pursuant to Section 286.0105, Florida Statutes, that, in order to appeal any decision made at the public hearing, you will need a record of the proceedings, and that, for such purpose, you may need to ensure that a verbatim record of the proceedings is made, which includes the testimony and evidence upon which the appeal is to be based. In accordance with the Americans with Disabilities Act, any persons with a disability requiring reasonable accommodation in order to participate in this meeting should call the City Clerk at (386) 418-6100 x 101 at least 48 hours prior to the public hearing.

05949-011-007
CHAMBERS RONALD C
1225 NW FRONTIER DR
LAKE CITY FL 32055

05949-011-007
CHAMBERS RONALD C
1225 NW FRONTIER DR
LAKE CITY FL 32055

05949-011-001
ROUHANI & BRANTLY ASSOCIATES LLC
2475 NW 138TH TER
Gainesville FL 32606

05959-001-000
ADG COMMERCIAL HOLDINGS LLC
PO BOX 233
LAKE BUTLER FL 32054

05959-001-000
ADG COMMERCIAL HOLDINGS LLC
PO BOX 233
LAKE BUTLER FL 32054

05964-006-000
PEPINE & PEPINE CO-TRUSTEES
6308 SW 37TH WAY
GAINESVILLE FL 32608

05964-002-004
UPLAND PROPERTIES OF NCF LLC
13570 NW 101ST DR STE 100
Alachua FL 32615

05964-002-004
UPLAND PROPERTIES OF NCF LLC
13570 NW 101ST DR STE 100
Alachua FL 32615

05964-002-003
UPLAND PROPERTIES OF NCF LLC
13570 NW 101ST DR STE 100
Alachua FL 32615

05964-002-005
UPLAND PROPERTIES OF NCF LLC
13570 NW 101ST DR STE 100
Alachua FL 32615

05964-002-005
UPLAND PROPERTIES OF NCF LLC
13570 NW 101ST DR STE 100
Alachua FL 32615

05964-002-006
UPLAND PROPERTIES OF NCF LLC
13570 NW 101ST DR STE 100
Alachua FL 32615

05964-002-001
UPLAND PROPERTIES OF NCF LLC
13570 NW 101ST DR STE 100
Alachua FL 32615

05964-002-001
UPLAND PROPERTIES OF NCF LLC
13570 NW 101ST DR STE 100
Alachua FL 32615

05964-007-000
G & C YOUNG ENTERPRISES INC
PO BOX 820
ALACHUA FL 32616

05964-002-000

05964-002-000

05970-004-000
ENVISION SEVEN LIMITED LIABILIY CO
1818 SW 28TH ST
OCALA FL 34474

05949-011-007
CHAMBERS RONALD C
1225 NW FRONTIER DR
LAKE CITY FL 32055

05949-011-007
CHAMBERS RONALD C
1225 NW FRONTIER DR
LAKE CITY FL 32055

05949-011-001
ROUHANI & BRANTLY ASSOCIATES LLC
2475 NW 138TH TER
Gainesville FL 32606

05959-001-000
ADG COMMERCIAL HOLDINGS LLC
PO BOX 233
LAKE BUTLER FL 32054

05959-001-000
ADG COMMERCIAL HOLDINGS LLC
PO BOX 233
LAKE BUTLER FL 32054

05964-006-000
PEPINE & PEPINE CO-TRUSTEES
6308 SW 37TH WAY
GAINESVILLE FL 32608

05964-002-004
UPLAND PROPERTIES OF NCF LLC
13570 NW 101ST DR STE 100
Alachua FL 32615

05964-002-004
UPLAND PROPERTIES OF NCF LLC
13570 NW 101ST DR STE 100
Alachua FL 32615

05964-002-003
UPLAND PROPERTIES OF NCF LLC
13570 NW 101ST DR STE 100
Alachua FL 32615

05964-002-005
UPLAND PROPERTIES OF NCF LLC
13570 NW 101ST DR STE 100
Alachua FL 32615

05964-002-005
UPLAND PROPERTIES OF NCF LLC
13570 NW 101ST DR STE 100
Alachua FL 32615

05964-002-006
UPLAND PROPERTIES OF NCF LLC
13570 NW 101ST DR STE 100
Alachua FL 32615

05964-002-001
UPLAND PROPERTIES OF NCF LLC
13570 NW 101ST DR STE 100
Alachua FL 32615

05964-002-001
UPLAND PROPERTIES OF NCF LLC
13570 NW 101ST DR STE 100
Alachua FL 32615

05964-007-000
G & C YOUNG ENTERPRISES INC
PO BOX 820
ALACHUA FL 32616

05964-002-000

05964-002-000

05970-004-000
ENVISION SEVEN LIMITED LIABILIY CO
1818 SW 28TH ST
OCALA FL 34474