

Mailed 5/9/16amx

PUBLIC NOTICE OF ENACTMENT OF AN ORDINANCE OF THE CITY OF ALACHUA, FLORIDA

NOTICE OF PUBLIC HEARING BEFORE THE CITY COMMISSION OF THE CITY OF ALACHUA, FLORIDA

Notice is hereby given that the City Commission of the City of Alachua will hold a public hearing on a proposed ordinance. The hearing will be held on May 23, 2016, at 6:30 p.m., in the James A. Lewis Commission Chambers in City Hall, located at 15100 NW 142nd Terrace, Alachua, Florida.

The ordinance title is as follows:

ORDINANCE 16-05

AN ORDINANCE OF THE CITY OF ALACHUA, FLORIDA, RELATING TO THE SMALL SCALE AMENDMENT OF THE CITY OF ALACHUA COMPREHENSIVE PLAN FUTURE LAND USE MAP; AMENDING THE FUTURE LAND USE MAP FROM INDUSTRIAL TO COMMERCIAL ON APPROXIMATELY 2.5 ACRES, LOCATED SOUTH OF NW US HIGHWAY 441, AND EAST AND WEST OF NW 101ST DRIVE; TAX PARCEL NUMBERS 05964-002-001, 05964-002-006, AND PORTION OF 05964-002-000; REPEALING ALL ORDINANCES IN CONFLICT; PROVIDING SEVERABILITY; AND PROVIDING AN EFFECTIVE DATE.

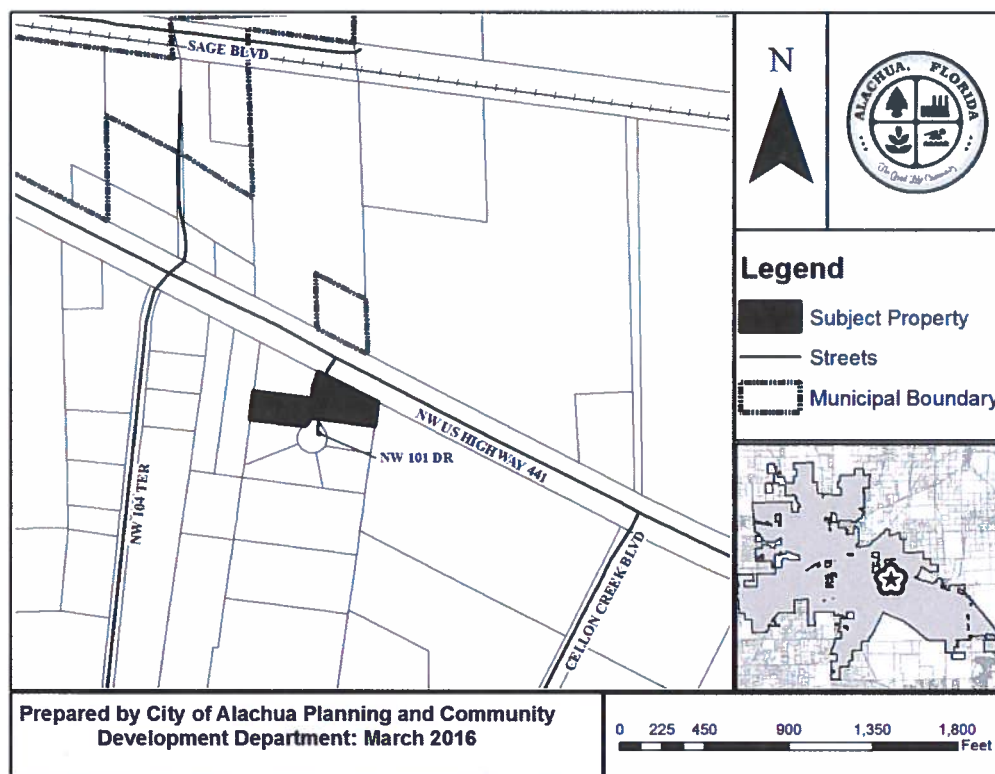

At the public hearing, all interested parties may appear and be heard with respect to the application. Copies of the application are available for public inspection at the Planning and Community Development Department, 15100 NW 142nd Terrace, Alachua, Florida, on any regular business day between the hours of 7:30 a.m. to 6:00 p.m. Written comments on the application may be sent to the following address: City of Alachua, Planning and Community Development, P.O. Box 9, Alachua, FL 32616. Notice is given pursuant to Section 286.0105, Florida Statutes, that, in order to appeal any decision made at the public hearing, you will need a record of the proceedings, and that, for such purpose, you may need to ensure that a verbatim record of the proceedings is made, which includes the testimony and evidence upon which the appeal is to be based. In accordance with the Americans with Disabilities Act, any persons with a disability requiring reasonable accommodation in order to participate in this meeting should call the City Clerk at (386) 418-6100 x 101 at least 48 hours prior to the public hearing.

Easy Peel® Labels
Use Avery® Template 5160®

Feed Paper  Bend along line to
expose Pop-up Edge™

 AVERY® 5960™

05949-011-007
CHAMBERS RONALD C
1225 NW FRONTIER DR
LAKE CITY FL 32055

05949-011-007
CHAMBERS RONALD C
1225 NW FRONTIER DR
LAKE CITY FL 32055

05949-011-001 *Mailed 5/9/16 amy*
ROUHANI & BRANTLY ASSOCIATES LLC
2475 NW 138TH TER
Gainesville FL 32606

05959-001-000
ADG COMMERCIAL HOLDINGS LLC
PO BOX 233
LAKE BUTLER FL 32054

05959-001-000
ADG COMMERCIAL HOLDINGS LLC
PO BOX 233
LAKE BUTLER FL 32054

05964-006-000
PEPINE & PEPINE CO-TRUSTEES
6308 SW 37TH WAY
GAINESVILLE FL 32608

05964-002-004
UPLAND PROPERTIES OF NCF LLC
13570 NW 101ST DR STE 100
Alachua FL 32615

05964-002-004
UPLAND PROPERTIES OF NCF LLC
13570 NW 101ST DR STE 100
Alachua FL 32615

05964-002-003
UPLAND PROPERTIES OF NCF LLC
13570 NW 101ST DR STE 100
Alachua FL 32615

05964-002-005
UPLAND PROPERTIES OF NCF LLC
13570 NW 101ST DR STE 100
Alachua FL 32615

05964-002-005
UPLAND PROPERTIES OF NCF LLC
13570 NW 101ST DR STE 100
Alachua FL 32615

05964-002-006
UPLAND PROPERTIES OF NCF LLC
13570 NW 101ST DR STE 100
Alachua FL 32615

05964-002-001
UPLAND PROPERTIES OF NCF LLC
13570 NW 101ST DR STE 100
Alachua FL 32615

05964-002-001
UPLAND PROPERTIES OF NCF LLC
13570 NW 101ST DR STE 100
Alachua FL 32615

05964-007-000
G & C YOUNG ENTERPRISES INC
PO BOX 820
ALACHUA FL 32616

05964-002-000

05964-002-000

05970-004-000
ENVISION SEVEN LIMITED LIABILITY CO
1818 SW 28TH ST
OCALA FL 34474

Easy Peel® Labels
Use Avery® Template 5160®

Antoinette Endelicato
5562 NW 93rd Avenue
Gainesville, Florida 32653

Dan Rhine
288 Turkey Creek
Alachua, Florida 32615

Bill Atwater
6017 NW 115th Place
Alachua, Florida 32615

Tom Gorman
9210 NW 59th Street
Alachua, Florida 32653

Richard Gorman
5716 NW 93rd Avenue
Alachua, Florida 32653

Peggy Arnold
410 Turkey Creek
Alachua, Florida 32615

David Forest
23 Turkey Creek
Alachua, Florida 32615

John Tingue
333 Turkey Creek
Alachua, Florida 32615

President
TCMOA
1000 Turkey Creek
Alachua, Florida 32615

Linda Dixon, AICP
Assistant Director Planning
PO Box 115050
Gainesville, Florida 32611

Feed Paper  Bend along line to
expose Pop-up Edge™

Craig Parenteau
FL Department of Environmental
Protection
4801 Camp Ranch Road
Gainesville, Florida 32641

 **AVERY® 5960™**

Mailed 5/9/16 amg

Jeannette Hinsdale
P.O. Box 1156
Alachua, Florida 32616

Lynn Coullias
7406 NW 126th Ave
Alachua, Florida 32615

Lynda Coon
7216 NW 126 Avenue
Alachua, Florida 32615

Tamara Robbins
PO Box 2317
Alachua, Florida 32616

Dr. Lee A. Niblock
Alachua County Manager
12 SE 1st Street
Gainesville, Florida 32601

John Amerson
All County Marion Property Management
2916 NE Jacksonville Road
Ocala, FL 34479

