

Vandella Price Durr 90th Birthday Celebration

June 4, 2016
2:30 - 5:00 PM
St. Madeline Family Life Center
17155 NW US Hwy 441
High Springs

Contact Info & Well Wishes
Wanda Durr-Spidell @ 386-454-4469
or wanda_durr@hotmail.com

Buddy and Pat Deas 50th Wedding Anniversary Celebration



Saturday, June 11, 2016
11 AM - 2 PM
Cedar Key Community Center
809 6th Street
Cedar Key, Florida

All former students are encouraged to attend

games, do crafts, have a snack and "dive" into Bible stories to find truth below the surface. Children can be registered from the church website fbcalachua.com by clicking on the top

Membership Meeting, sponsored by Haven Hospice. Location: High Springs Civic Center, 330 Santa Fe Blvd., High Springs. Times: 5:30 - 6:30 p.m.



City of ALACHUA NOTICE OF PUBLIC HEARING BEFORE THE CITY COMMISSION OF THE CITY OF ALACHUA, FLORIDA

Notice is hereby given that the City Commission of the City of Alachua will hold a public hearing on June 13, 2016, at 6:30 p.m. The hearing will be held in the James A. Lewis Commission Chambers in City Hall, located at 15100 NW 142nd Terrace, Alachua, Florida, to consider the following: A request by Monique Heathcock, PE, LEED AP, of Causseaux, Hewett, & Walpole, Inc., applicant and agent, for Duration Builders, Inc., property owner, for consideration of the final plat of Heritage Oaks Phase II, which proposes the subdivision of the subject property into a total of 44 lots. The ±17.25 acre property subject to the proposed subdivision is located immediately north of Heritage Oaks Phase I, as recorded in Official Records of Alachua County, Plat Book 24, Pages 79 through 82, and east of Santa Fe High School, consisting of Tax Parcel No. 03053-001-000. FLUM: Moderate Density Residential; Zoning: Planned Development - Residential (PD-R.)

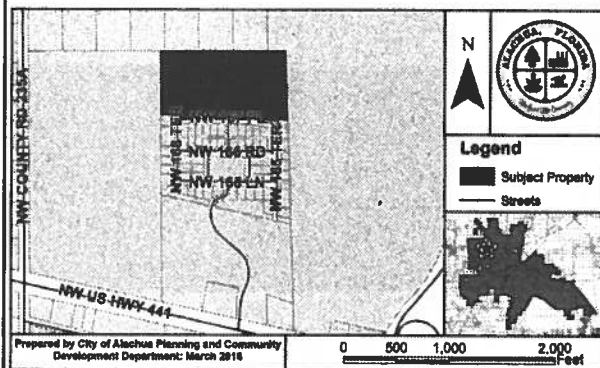

At the public hearing, all interested parties may appear and be heard with respect to the application. Copies of the application are available for public inspection at the Planning and Community Development Department, 15100 NW 142nd Terrace, Alachua, Florida, on any regular business day between the hours of 7:30 a.m. to 6:00 p.m. Written comments on the application may be sent to the following address: City of Alachua, Planning and Community Development, P.O. Box 9, Alachua, FL 32616. Notice is given pursuant to Section 286.0105, Florida Statutes, that, in order to appeal any decision made at the public hearing, you will need a record of the proceedings, and that, for such purpose, you may need to ensure that a verbatim record of the proceedings is made, which includes the testimony and evidence upon which the appeal is to be based. In accordance with the Americans with Disabilities Act, any persons with a disability requiring reasonable accommodation in order to participate in this meeting should call the City Clerk at (386) 418-6100 x 101 at least 48 hours prior to the public hearing.

(Published: Alachua County Today - June 02, 2016)

BY THE CITY COMI
proposes to amend the
Economic Developer
of Newberry Compreh
Plan, as stated below. T
comments objections ar
on Monday June 13, 20
heard, in the City Com
Newberry Road, Newb
the City Commission v
Department of Econom
first reading for said ar

CPA 16-02 - an applica
Land Use Element, Fut
and Capital Improve
The proposed changes a
"Corporate/Research F
modifications to the Eco

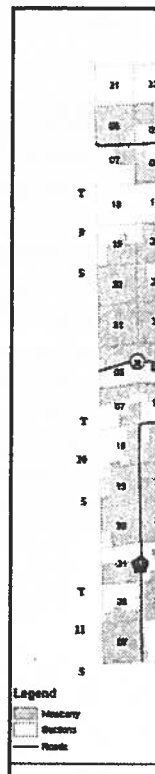

These public hearings
interested party shall be
of these public hearings
further notice regarding

At the aforementioned
heard with respect to the

Copies of the proposed
public inspection at the
2nd Avenue, Newberry,

All persons are advised
above referenced publi
and that, for such purp
the proceeding is made,
which the appeal is to be

In accordance with the
needing a special acco
MV Transportation, Inc
proceedings. If hearing
8770.

(Publishe



City of
ALACHUA

THE GOOD LIFE COMMUNITY

*Mailed 5/26/16
amz*

NOTICE OF PUBLIC HEARING BEFORE THE CITY COMMISSION OF THE CITY OF ALACHUA, FLORIDA

Notice is hereby given that the City Commission of the City of Alachua will hold a public hearing on June 13, 2016, at 6:30 p.m. The hearing will be held in the James A. Lewis Commission Chambers in City Hall, located at 15100 NW 142nd Terrace, Alachua, Florida, to consider the following: A request by Monique Heathcock, PE, LEED AP, of Causseaux, Hewett, & Walpole, Inc., applicant and agent, for Duration Builders, Inc., property owner, for consideration of the final plat of Heritage Oaks Phase II, which proposes the subdivision of the subject property into a total of 44 lots. The ± 17.25 acre property subject to the proposed subdivision is located immediately north of Heritage Oaks Phase I, as recorded in Official Records of Alachua County, Plat Book 24, Pages 79 through 82, and east of Santa Fe High School, consisting of Tax Parcel No. 03053-001-000. FLUM: Moderate Density Residential; Zoning: Planned Development – Residential (PD-R.)

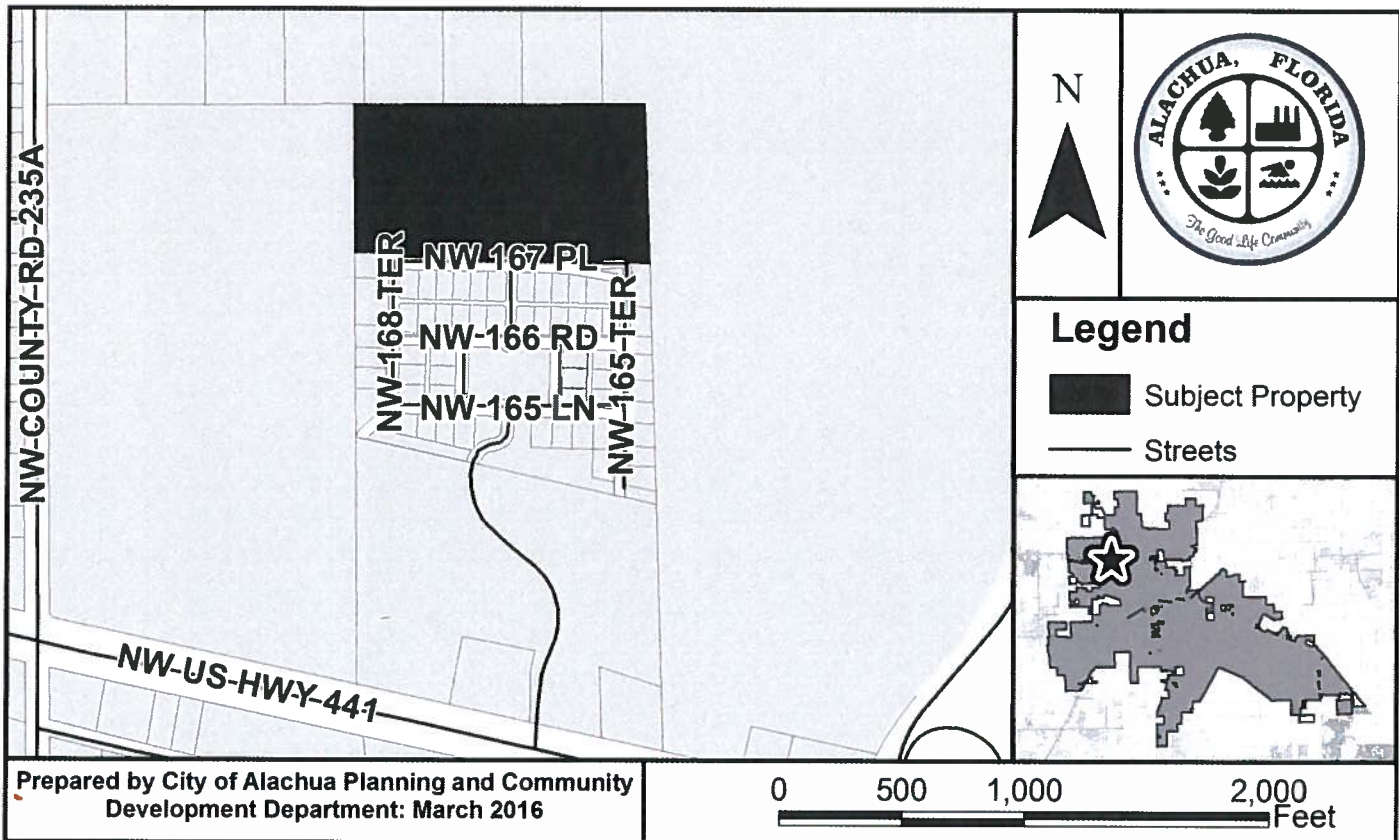

At the public hearing, all interested parties may appear and be heard with respect to the application. Copies of the application are available for public inspection at the Planning and Community Development Department, 15100 NW 142nd Terrace, Alachua, Florida, on any regular business day between the hours of 7:30 a.m. to 6:00 p.m. Written comments on the application may be sent to the following address: City of Alachua, Planning and Community Development, P.O. Box 9, Alachua, FL 32616. Notice is given pursuant to Section 286.0105, Florida Statutes, that, in order to appeal any decision made at the public hearing, you will need a record of the proceedings, and that, for such purpose, you may need to ensure that a verbatim record of the proceedings is made, which includes the testimony and evidence upon which the appeal is to be based. In accordance with the Americans with Disabilities Act, any persons with a disability requiring reasonable accommodation in order to participate in this meeting should call the City Clerk at (386) 418-6100 x 101 at least 48 hours prior to the public hearing.

P.O. Box 9 ♦ Alachua, Florida 32616-0009
Phone: (386) 418-6121 ♦ Fax: (386) 418-6130

03049-000-000
MEGAHEE ENTERPRISES LTD.,LLLP
2632 NW 43RD ST # 2138
GAINESVILLE FL 32606

03049-001-001
BRIDGES R O
PO BOX 1028
ALACHUA FL 32616-1028

03049-001-002
CAIOZZO GIACOMO
16615 NW 171ST PL
ALACHUA FL 32615

03049-001-011
KENNA VICKY ANN
16609 NW 171ST PL
ALACHUA FL 32615-4863

03049-001-012
ROGERS R E
PO BOX 1188
ALACHUA FL 32616-1188

03049-001-014
CRAIG & CRAIG & CRAIG TRUSTEES
17007 NW 171ST PL
ALACHUA FL 32615

03052-000-000
SCHOOL BD OF ALACHUA CTY
SANTA FE HIGH SCHOOL
620 E UNIV AVE
GAINESVILLE FL 32601

03053-001-000
DURATION BUILDERS INC
PO BOX 357665
GAINESVILLE FL 32635-7665

03053-010-006
STANDISH KYLE A
16648 NW 168TH TER
ALACHUA FL 32615

03053-010-007
SALES AMADEO M
4715 NW 53RD AVE STE C
C/O HAILE TITLE CO LLC
Gainesville FL 32653

03053-010-008
TAYLOR DAVID LEE
16702 NW 168TH TER
ALACHUA FL 32615

03053-010-009
OSEJO RAMON J
16681 NW 165TH TER
ALACHUA FL 32615-4992

03053-010-010
RICHARD WILLIAM SCOTT
16631 NW 165TH TER
Alachua FL 32615

03053-010-020
HOLLER & KELSO
16885 NW 167TH PL
Alachua FL 32615

03053-010-021
MCNICHOLS AUSTIN
16855 NW 167TH PL
Alachua FL 32615

03053-010-022
WEBB BILL E
16825 NW 167TH PL
ALACHUA FL 32615

03053-010-023
OLIVO & RIVERA W/H
16787 NW 167TH PL
ALACHUA FL 32615

03053-010-024
FAIRCLOTH & FLOYD
PO BOX 433
ALACHUA FL 32616

03053-010-025
FISCHER & FISCHER
16707 NW 167TH PL
Alachua FL 32615

03053-010-026
CHESSER ROYCE W
16704 NW 166TH RD
ALACHUA FL 32615

03053-010-027
DRURY JOE
16744 NW 166TH RD
ALACHUA FL 32615

03053-010-028
DAVIS LOGAN C
16774 NW 166TH RD
ALACHUA FL 322615

03053-010-029
BOUWENS & DOLLARD
16820 NW 66TH RD
Alachua FL 32615

03053-010-030
NUNN JASON
16850 NW 166TH RD
ALACHUA FL 32615

03053-010-031
ROBERTSON WILLIAM M JR
16880 NW 166TH RD
ALACHUA ALACHUAFL 32615

03053-010-032
ADAM & MAHMOOD
16683 NW 167TH PL
Alachua FL 32615

03053-010-033
DYAL VICKIE LUE
16653 NW 167TH PL
ALACHUA FL 32615

03053-010-034
CRUZ JUAN C
220 SW CELINE CT
LAKE CITY FL 32024

03053-010-035

03053-010-036
BLUE4.COM INFORMATION SERVICES
INC
16539 NW 167TH PL
ALACHUA FL 32615-8906

03053-010-037
FLOYD & RUTTENBER
16518 NW 166TH RD
ALACHUA FL 32615

03053-010-038
MCCARDLE JOSHUA N
16548 NW 166TH RD
Alachua FL 32615

03053-010-039
BRINER LANCE
16578 NW 166TH RD
ALACHUA FL 32615

03053-010-040
HYDEN & HYDEN
16622 NW 166TH RD
Alachua FL 32615

03053-010-041
FELICIANO & MALDONADO W/H
16652 NW 166TH RD
Alachua FL 32615

03053-010-042
BLAHAK CREIGHTON PAUL
16682 NW 166TH RD
ALACHUA FL 32615

03053-010-043
KINCAID & WUENSTEL JR
16643 NW 168TH TER
ALACHUA FL 32615

03053-010-046
BOLANOS & MCKERCHER W/H
16642 NW 167TH DR
ALACHUA FL 32615

03053-010-049
MEADOWS & MEADOWS
16649 NW 166TH DR
ALACHUA FL 32615-4996

03053-010-052
CAMPBELL MICHAEL PATRICK
16644 NW 165TH TER
Alachua FL 32615

03053-010-000
HERITAGE OAKS PROPERTY OWNERS
ASSN INC
PO BOX 969
Alachua FL 32516

Antoinette Endelicato
5562 NW 93rd Avenue
Gainesville, FL 32653

Dan Rhine
288 Turkey Creek
Alachua, FL 32615

Bill Atwater
6017 NW 115th Place
Alachua, FL 32615

Tom Gorman
9210 NW 59th Street
Alachua, FL 32653

Richard Gorman
5716 NW 93rd Avenue
Alachua, FL 32653

Peggy Arnold
410 Turkey Creek
Alachua, FL 32615

David Forest
23 Turkey Creek
Alachua, FL 32615

John Tingle
333 Turkey Creek
Alachua, FL 32615

President
TCMOA
1000 Turkey Creek
Alachua, FL 32615

Linda Dixon, AICP
Assistant Director Planning
PO Box 115050
Gainesville, FL 32611

Craig Parenteau
FL Department of Environmental
Protection
4801 Camp Ranch Road
Gainesville, FL 32641

Laura Williams
12416 NW 148th Avenue
Alachua, FL 32615

Jeannette Hinsdale
P.O. Box 1156
Alachua, FL 32616

Lynn Coullias
7406 NW 126th Ave
Alachua, FL 32615

Lynda Coon
7216 NW 126 Avenue
Alachua, FL 32615

Tamara Robbins
P.O. Box 2317
Alachua, Florida 32616

Dr. Lee A. Niblock
Alachua County Manager
12 SE 1st Street
Gainesville, FL 32601

AFFIDAVIT FOR POSTED LAND USE SIGN

I Jessica Junkin, POSTED THE LAND USE
(name)
SIGN ON 5/26/16 FOR THE Heritage Oaks - Phase II - Final Plat
(date) (state type of action and project name)
LAND USE ACTION.

AS PER ARTICLE 2.2.9 D OF THE LAND DEVELOPMENT REGULATIONS.

THIS WILL BE INCLUDED IN THE STAFF REPORT.

(signature)

3
(number of signs)