

02524-005-
4377-003-000,
4377-004-002,
1919-000-000,
2516-003-000,
5-002-000 and
from Alachua
y of Newberry

ewberry
tions

to one or more
be advised that
uation of these
ing the public
egarding these

all interested
respect to the
sive Plan.
ents to the
blic inspection
ated at 25815
during regular

e to appeal any
blic hearings,
s, and that, for
hat a verbatim
ecord includes
he appeal is to

h Disabilities
ng a special
eeting should
375-2784, no
gs. If hearing
t

9, 2016)

Y
.3355

Community Center for overdue.
approximately 40 years of # # #
service to the residents of Email editor@
Archer. alachuatoday.com



City of ALACHUA

NOTICE OF PUBLIC HEARING BEFORE THE CITY COMMISSION OF THE CITY OF ALACHUA, FLORIDA

Notice is hereby given that the City Commission of the City of Alachua will hold a public hearing on October 10, 2016, at 6:30 p.m. The hearing will be held in the James A. Lewis Commission Chambers in City Hall, located at 15100 NW 142nd Terrace, Alachua, Florida, to consider the following: A request by Stacy Hall, PSM, of George F. Young, Inc., applicant and agent, for Paul Elkins, property owner, for consideration of a final plat (a replatting of Lot 18 of the Pilot Forest subdivision as recorded in Plat Book J, Page 92). The ±.51 acre property subject to the proposed subdivision is located to the east of County Road 235, west of NW 157th Street, at 16025 NW 118th Place in the Pilot Forest Subdivision, consisting of Tax Parcel No. 03980-003-018. FLUM: Moderate Density Residential; Zoning: Residential Single Family- 1 (RSF-1).

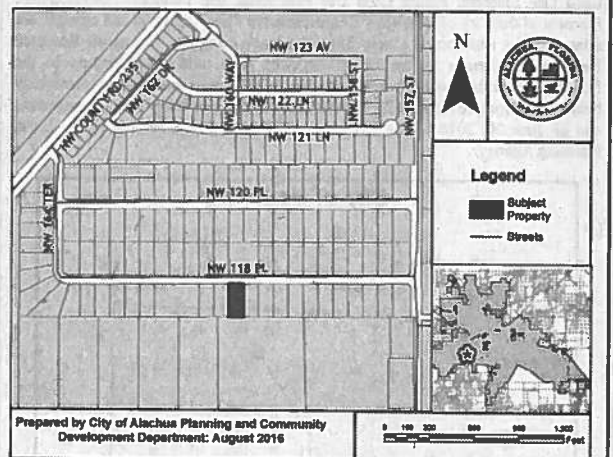

At the public hearing, all interested parties may appear and be heard with respect to the application. Copies of the application are available for public inspection at the Planning and Community Development Department, 15100 NW 142nd Terrace, Alachua, Florida, on any regular business day between the hours of 7:30 a.m. to 6:00 p.m. Written comments on the application may be sent to the following address: City of Alachua, Planning and Community Development, P.O. Box 9, Alachua, FL 32616. Notice is given pursuant to Section 286.0105, Florida Statutes, that, in order to appeal any decision made at the public hearing, you will need a record of the proceedings, and that, for such purpose, you may need to ensure that a verbatim record of the proceedings is made, which includes the testimony and evidence upon which the appeal is to be based. In accordance with the Americans with Disabilities Act, any persons with a disability requiring reasonable accommodation in order to participate in this meeting should call the City Clerk at (386) 418-6100 x 101 at least 48 hours prior to the public hearing.
(Published: Alachua County Today - September 29, 2016)



Sign Barrel

.com

Signs and Banners

Full Color

Wide Format Digital Sign Printing

Metal • Wood • Vinyl
Office • Automobile • Construction

- Event Banners • Table Banners
- 24x18 Cr eplast Signs
- Window Lettering and Graphics

(386) 462-3355 14804 Main Street, Alachua, Florida

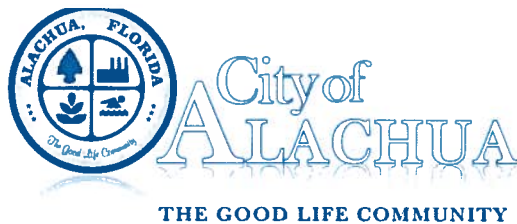

Mailed 9/26/16 CMK

NOTICE OF PUBLIC HEARING BEFORE THE CITY COMMISSION OF THE CITY OF ALACHUA, FLORIDA

Notice is hereby given that the City Commission of the City of Alachua will hold a public hearing on October 10, 2016, at 6:30 p.m. The hearing will be held in the James A. Lewis Commission Chambers in City Hall, located at 15100 NW 142nd Terrace, Alachua, Florida, to consider the following: A request by Stacy Hall, PSM, of George F. Young, Inc., applicant and agent, for Paul Elkins, property owner, for consideration of a final plat (a replatting of Lot 18 of the Pilot Forest subdivision as recorded in Plat Book J, Page 92). The \pm .51 acre property subject to the proposed subdivision is located to the east of County Road 235, west of NW 157th Street, at 16025 NW 118th Place in the Pilot Forest Subdivision, consisting of Tax Parcel No. 03980-003-018. FLUM: Moderate Density Residential; Zoning: Residential Single Family- 1 (RSF-1).

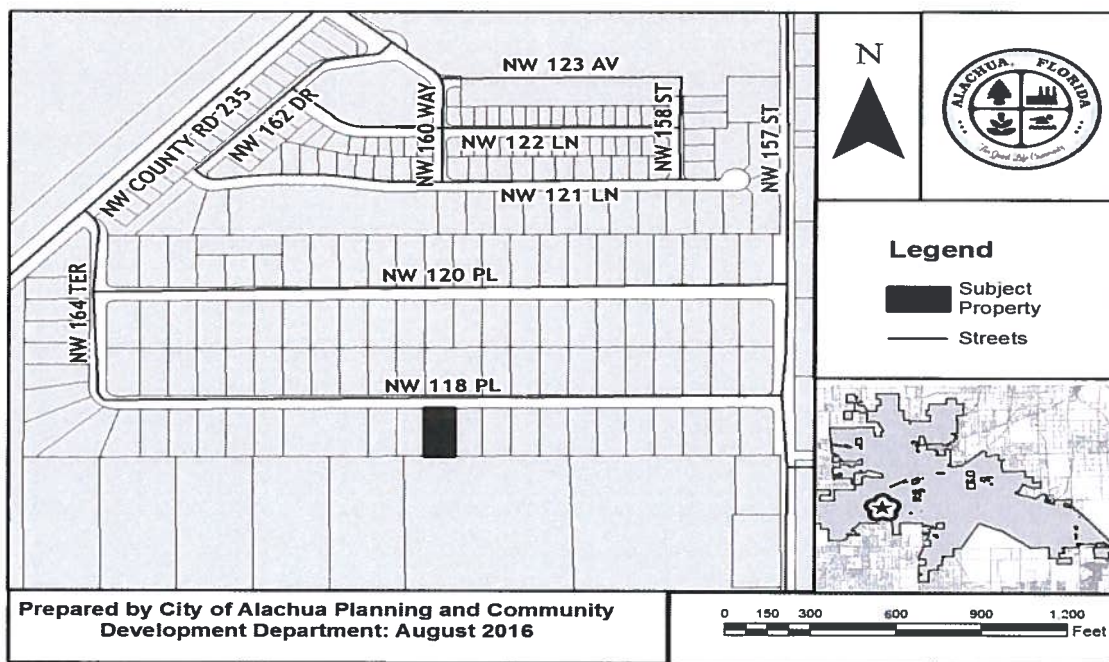

At the public hearing, all interested parties may appear and be heard with respect to the application. Copies of the application are available for public inspection at the Planning and Community Development Department, 15100 NW 142nd Terrace, Alachua, Florida, on any regular business day between the hours of 7:30 a.m. to 6:00 p.m. Written comments on the application may be sent to the following address: City of Alachua, Planning and Community Development, P.O. Box 9, Alachua, FL 32616. Notice is given pursuant to Section 286.0105, Florida Statutes, that, in order to appeal any decision made at the public hearing, you will need a record of the proceedings, and that, for such purpose, you may need to ensure that a verbatim record of the proceedings is made, which includes the testimony and evidence upon which the appeal is to be based. In accordance with the Americans with Disabilities Act, any persons with a disability requiring reasonable accommodation in order to participate in this meeting should call the City Clerk at (386) 418-6100 x 101 at least 48 hours prior to the public hearing.

P.O. Box 9 ♦ Alachua, Florida 32616-0009
Phone: (386) 418-6121 ♦ Fax: (386) 418-6130

Mailed 9/26/16 amx

JAMES C III GILBREATH

16103 NW 118TH PL, ALACHUA, FL,
32615-6424

JAMES R ACKERMAN

4421 NW 41ST LN, GAINESVILLE, FL,
32606-4522

OWEN J III WILSON

15915 NW 118TH PL, ALACHUA, FL,
32615-6423

MICHAEL D RUSSELL

15922 NW 118TH PL, ALACHUA, FL,
32615

THOMAS C MCNAMARA

16034 NW 118TH PL, ALACHUA, FL,
32615

BRUCE SHEPARD

16118 NW 118TH PL, ALACHUA, FL,
32615-6420

DEBRA L REDFIELD

330 NE 4TH AVE, HIGH SPRINGS, FL,
32643-4310

KATHLEEN NOEL CONNOLLY

15921 NW 120TH PL, ALACHUA, FL,
32615

CLARK & DAVIS W/H

11633 NW 161ST ST, Alachua, FL,
32615

DARRIN R BARRELLE

16031 NW 118TH PL, ALACHUA, FL,
32615

JANICE LEA SHROCK

PO BOX 21931, SARASOTA, FL,
34276-4931

STEPHEN F STAMPER

15901 NW 118TH PL, ALACHUA, FL,
32615-6423

FRANCES B MCCRAY

16008 NW 118TH PL, Alachua, FL,
32615

TANYA CHRISTINE ALVAREZ

926 COSTA MESA LN, KISSIMMEE, FL,
34744-7229

JOSEPH A GREASER

16111 NW 120TH PL, ALACHUA, FL,
32615

JAMES C SR HASKELL

16017 NW 120TH PL, Alachua, FL,
32615

CAIN & LEWIS & LEWIS & POPE JR

PO BOX 100, Alachua, FL,
32616

WILLIAM R WEAVER

8461 SW 129TH TERRACE RD,
DUNNELLON, FL,
34432-3522

PAUL R ELKINS

6207 NW 164TH ST, ALACHUA, FL,
32615

MARY ANN WILSON

PO BOX 100, ALACHUA, FL,
32616-0100

WILLIAM W WENTWORTH

15916 NW 118TH PL, ALACHUA, FL,
32615

KEITH J CASEY

16020 NW 118TH PL, ALACHUA, FL,
32615-6419

CHRISTIE L BORJA

16110 NW 118TH PL, ALACHUA, FL,
32615-6420

ROBERT J O'BRIEN

16029 NW 120TH PL, ALACHUA, FL,
32615-6678

DENNIS J STINSON

16005 NW 120TH PL, ALACHUA, FL,
32615

HARRY J JR GIBSON

16103 NW 120TH PL, ALACHUA, FL,
32615

WILLIAM R WEAVER

8461 SW 129TH TERRACE RD,
DUNNELLON, FL,
34432-3522

Antoinette Endelicato

5562 NW 93rd Avenue
Gainesville,FL,32653

Dan Rhine

288 Turkey Creek
Alachua,FL,32615

Tom Gorman

9210 NW 59th Street
Alachua,FL,32653

Richard Gorman

5716 NW 93rd Avenue
Alachua,FL,32653

Peggy Arnold

410 Turkey Creek
Alachua,FL,32615

David Forest

23 Turkey Creek
Alachua,FL,32615

John Tingue

333 Turkey Creek
Alachua,FL,32615

President

TCMOA
1000 Turkey Creek
Alachua,FL,32615

Linda Dixon, AICP

Assistant Director Planning
PO Box 115050
Gainesville,FL,32611

Craig Parenteau

FL Department of Environmental Protection
4801 Camp Ranch Road
Gainesville,FL,32641

Jeannette Hinsdale

P.O. Box 1156
Alachua,FL,32616

Lynn Coullias

7406 NW 126th Ave
Alachua,FL,32615

Lynda Coon

7216 NW 126 Avenue
Alachua,FL,32615

Tamara Robbins

PO Box 2317
Alachua,FL,32616

Dr. Lee A. Niblock

Alachua County Manager
12 SE 1st Street
Gainesville,FL,32601

John Amerson

All County Marion Property Management
2916 NE Jacksonville Rd
Ocala,FL,34479



Paul Elkins
6207 NW 164th Street
Alachua, FL 32615

AFFIDAVIT FOR POSTED LAND USE SIGN

I Stacey Hall, POSTED THE LAND USE
(name)
SIGN ON 8/29/16 FOR THE Pilot Forest Re-Plat
(date) (state type of action and project name)
LAND USE ACTION.

AS PER ARTICLE 2.2.9 D OF THE LAND DEVELOPMENT REGULATIONS.

THIS WILL BE INCLUDED IN THE STAFF REPORT.

(signature)

1
(number of signs)