**RS&H**

RS&H, Inc.
10748 Deerwood Park Blvd. South
Jacksonville, Florida 32256-0597
904-256-2500 Fax 904-256-2503
www.rsandh.com
FL Cert. Nos. AAC001886 * IB26000956 *
5620 * LCC000210 * GB238



14193 NW 119TH TERRACE
ALACHUA, FL 32615

CONSULTANTS



132 NW 76th Drive
Gainesville, Florida 32607
(352) 331-1976 / (352) 331-2476
www.chw-inc.com

est. 1988 **FLORIDA**
CA-6075

REVISIONS

[illegible]

DATE ISSUED: 06/30/16

SCALE: 1"=50'-0"

DRAWN BY: CMT

REVIEWED BY: CEM

CHW PROJECT NUMBER
16-0111

© 2016 RS&H, INC.

LANDSCAPE &
IRRIGATION PLAN
REFERENCE MAP

SHEET NUMBER

L-100

CITY
SUBMITTAL





CONSULTANTS

[illegible]

REVIEWED BY: CEM

© 2016 RS&H, INC.

SHEET NUMBER

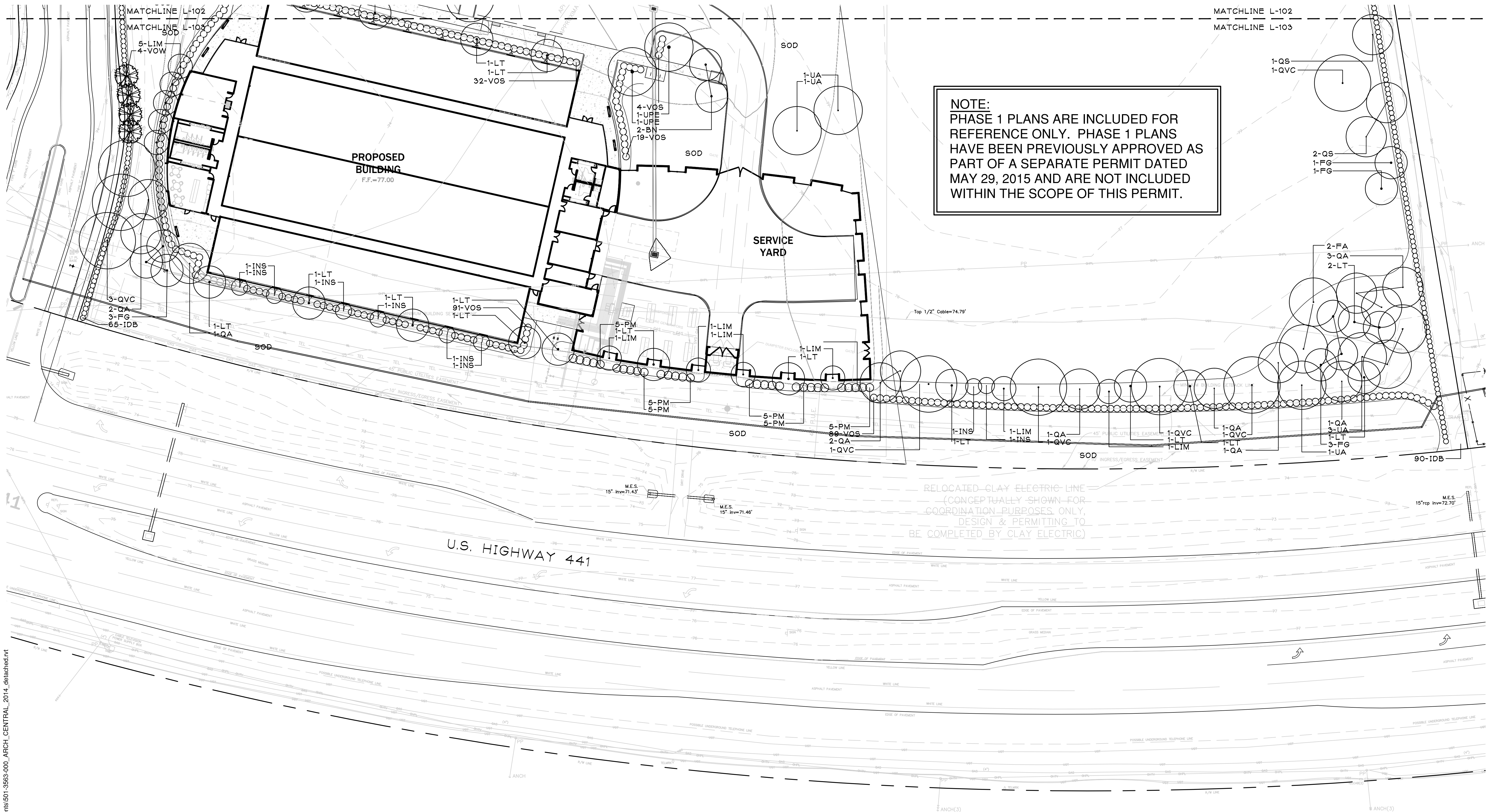
CITY
SUBMITTAL

Tech: cecill Plot Date: Oct 15, 2016 1:28pm Filename: C:\Users\Cecill\appdata\local\temp\AcPublish_8072\16-0111_design-base-PH1.dwg
9/9/2014 4:36:35 PM C:\Users\pourtchb\Documents\501-3563-000_ARCH_CENTRAL_2014_detached.rvt

The diagram consists of two circles. The top circle has a center point marked with a dot. A vertical line segment extends from the center point down to the bottom edge of the circle, and a horizontal line segment extends from that point to the left, labeled '1-QV'. To the right of the top circle is the text 'NEW TREES TO BE ADDED'. Below the top circle is another circle, which is empty except for its center point. To the right of this bottom circle is the text 'EXISTING TREES TO REMAIN'.

ALL ASPHALT, LIMESTOCK, AND CONSTRUCTION DEBRIS TO BE REMOVED FROM PLANTING BEDS AND AREAS TO BE SODDED PRIOR TO LANDSCAPE INSTALLATION. PLANTING DEPTH OF SOIL IN SUCH AREAS SHOULD BE AT LEAST 3". IF FILL MUST BE ADDED, IT MUST BE FLOUNDER CLEAN DEEP FILL (FREE OF WEED SEEDS) SANDY LOAM WITH pH 5.5-6.5.

CANOPY TREES SHALL BE A MINIMUM OF EIGHT (8) FEET IN HEIGHT AND ORNAMENTAL OR UNDERSTORY TREES SHALL HAVE A MINIMUM CALIPER OF ONE AND A HALF (1.5) INCHES, UNLESS OTHERWISE SPECIFIED BY THE LANDSCAPE ARCHITECT.

ALL TREES TO BE PLANTED 1"-2" ABOVE FINISHED GRADE

ALL LANDSCAPED AREAS TO BE MULCHED WITH 3" THICKNESS OF MULCH. PINE BARK MULCH SHALL BE USED IN ALL AREAS.

LEADER SHOOTS AND MAIN STRUCTURAL LIMBS OF TREES WILL NOT BE TOPPED OR PRUNED. TREES TO BE STAKED AS NEEDED, GUYLINES TO BE NON-SYNTHETIC BIODEGRADABLE MATERIAL.

OWNER SHALL BE RESPONSIBLE FOR (1) THE SURVIVAL OF THE LANDSCAPING ELEMENTS AND (2) REMOVAL OF ALL STAKING SYSTEMS WITHIN ONE YEAR. TREES WILL BE STAKED ONLY IF NECESSARY, AND IF STAKED, BIODEGRADABLE TWINE WILL BE USED.

ALL DISTURBED AND UNPAVED AREAS TO BE GRASSED WITH NOXIOUS WEED AND TROPICAL SODA APPLE FREE SOD OR SEEDED AND MULCHED. SEE CIVIL SITE PLANS FOR ADDITIONAL RELATED INFORMATION.

ALL PLANT MATERIAL TO BE FLORIDA NO.1 OR BETTER, GRADED IN ACCORDANCE WITH GRADES AND STANDARDS FOR NURSERY PLANTS PUBLISHED BY THE STATE OF FLORIDA, DEPARTMENT OF AGRICULTURE.

TREE MITIGATION FOR THE REGULATED TREES TO BE REMOVED SHALL BE PROVIDED ON A 1 FOR 1 BASIS. TREE MITIGATION FOR HERITAGE TREES TO BE REMOVED SHALL BE PROVIDED ON AN INCH-FOR-INCH BASIS. THERE ARE NO REGULATED TREES PROPOSED TO BE REMOVED IN POD A.

CITY OF ALACHUA LDR SECTION 6.7.3 (A) STATES THAT THE MINIMUM OPEN SPACE SET-ASIDE SHALL BE 10% OF THE DEVELOPMENT SITE. SEE CIVIL PLANS FOR OPEN SPACE CALCULATIONS.

LANDSCAPE IRRIGATION TO BE PROVIDED BY AUTOMATIC IRRIGATION SYSTEM IN ACCORDANCE WITH CITY OF ALACHUA LDR SECTION 6.2.2(D)(6)(B)(VI). SEE SHEETS L-203 THROUGH L-204 FOR POD A IRRIGATION PLANS.

TREES	QTY	BOTANICAL NAME	COMMON NAME	SIZE	TYPE
BN	8	BETULA NIGRA 'DURA HEAT'	DURA HEAT RIVER BIRCH	1½" CALIPER, MIN.	UNDERSTORY
FG	6	FRAXINUS PENNSYLVANICA	GREEN ASH	8" HEIGHT, MIN.	CANOPY
LIM	5	LAGERSTROEMIA INDICA 'MUSKOGEE'	MUSKOGEE CRAPE MYRTLE	1½" CALIPER, MIN., MULTI-TRUNK	UNDERSTORY
LIN	1	LAGERSTROEMIA INDICA 'NATCHEZ'	NATCHEZ CRAPE MYRTLE	1½" CALIPER, MIN., MULTI-TRUNK	UNDERSTORY
LT	5	LIRIODENDRON TULIPIFERA	TULIP TREE	8" HEIGHT, MIN.	CANOPY
PM	12	PODOCARPUS MACROPHYLLUS	PODOCARPUS	1½" CALIPER, MIN.	UNDERSTORY
QS	2	QUERCUS SHUMARDII	SHUMARD OAK	8" HEIGHT, MIN.	CANOPY
QVC	16	QUERCUS VIRGINIANA 'CATHEDRAL'	CATHEDRAL LIVE OAK	8" HEIGHT, MIN.	CANOPY
TD	18	TAXODIUM DISTICHUM	BALD CYPRESS	8" HEIGHT, MIN.	CANOPY
UA	7	ULMUS ALATA	WINGED ELM	8" HEIGHT, MIN.	CANOPY
VOW	6	VIBURNUM OBOVATUM	WALTER'S VIBURNUM	1½" CALIPER, MIN.	UNDERSTORY
<u>SHRUBS</u>	<u>QTY</u>	<u>BOTANICAL NAME</u>	<u>COMMON NAME</u>	<u>SIZE</u>	
BX	99	BUXUS MICROPHYLLA	BOXWOOD	24" HEIGHT, MIN.	
IDB	448	ILEX CORNUTA 'DWARF BURFORDII'	DWARF BURFORD HOLLY	24" HEIGHT, MIN.	
RI	14	RHAPHIOLEPS INDICA 'ELEANOR TABOR'	ELEANOR TABOR INDIAN HAWTHORN	24" HEIGHT, MIN.	
VOS	130	VIBURNUM OBOVATUM 'MRS. SCHILLER'S DELIGHT'	MRS. SCHILLER'S DELIGHT VIBURNUM	24" HEIGHT, MIN.	
<u>SOD/SEED</u>		<u>BOTANICAL NAME</u>	<u>COMMON NAME</u>	<u>SIZE</u>	
SOD		PASPALUM NOTATUM 'ARGENTINE'	BAHIA GRASS	WEED FREE AND SAND GROWN SOD	

FULL LENGTH OF SOUTHERN PROPERTY BOUNDARY ALONG U.S. HWY. 441

DESCRIPTION	LANDSCAPE REQUIREMENTS	LANDSCAPE PROVIDED
U.S. HWY. 441 (873 LIN. FT.)	5 CANOPY TREES PER 100 LIN. FT. REQUIRED = 44 CANOPY TREES REQUIRED 3 UNDERSTORY TREES PER 100 LIN. FT. REQUIRED = 26 UNDERSTORY TREES REQUIRED CONTINUOUS HEDGE REQUIRED	44 CANOPY TREES PROVIDED 26 UNDERSTORY TREES PROVIDED CONTINUOUS HEDGE PROVIDED

EXISTING PARKING IN POD 1 AND PROPOSED POD A PARKING AREA

DESCRIPTION	LANDSCAPE REQUIRED	LANDSCAPE PROVIDED
PARKING AREA PERIMETER LANDSCAPE	PARKING PERIMETER = 1,273 L.F. 4 CANOPY TREES PER 100 L.F. 2 UNDERSTORY/ORNAMENTAL PER 100 L.F. CONTINUOUS ROW OF SHRUBS 51 CANOPY TREES REQUIRED 26 UNDERSTORY TREES REQUIRED CONTINUOUS ROW OF SHRUBS	51 CANOPY TREES PROVIDED 26 UNDERSTORY TREES PROVIDED CONTINUOUS ROW OF SHRUBS PROVIDED
INTERIOR PARKING AREA LANDSCAPE	PARKING AREA = 70,262 S.F. 1 CANOPY TREE REQUIRED PER 2,000 S.F. 10 SHRUBS REQUIRED PER CANOPY TREE REQUIRED 36 CANOPY TREES REQUIRED 360 SHRUBS REQUIRED	36 CANOPY TREES PROVIDED 360 SHRUBS PROVIDED

ENTIRE SITE

DESCRIPTION	TREE REQUIREMENTS	TREES PROVIDED
PRIMARY SIDE CANOPY TREES (SOUTH SIDE)	3 TREES PER ACRE X 14.5 ACRES = 44 CANOPY TREES REQUIRED	44 CANOPY TREES PROVIDED
REAR SIDE CANOPY TREES (NORTH SIDE)	2 TREES PER ACRE X 14.5 ACRES = 29 TREES REQUIRED	29 CANOPY TREES PROVIDED
EAST SIDE CANOPY TREES	2 TREES PER ACRE X 14.5 ACRES = 29 TREES REQUIRED	29 CANOPY TREES PROVIDED
WEST SIDE CANOPY TREES	2 TREES PER ACRE X 14.5 ACRES = 29 TREES REQUIRED	29 CANOPY TREES PROVIDED
SITE UNDERSTORY TREES	6 UNDERSTORY TREES PER ACRE X 14.5 ACRES = 87 TREES REQUIRED 50% IN FRONT = 44 TREES REQUIRED 25% ON EAST SIDE = 21 TREES REQUIRED 25% ON WEST SIDE = 22 TREES REQUIRED 87 UNDERSTORY TREES REQUIRED	FRONT SIDE 44 UNDERSTORY TREES PROVIDED EAST SIDE 21 UNDERSTORY TREES PROVIDED WEST SIDE 22 UNDERSTORY TREES PROVIDED 87 UNDERSTORY TREES PROVIDED
BUILDING FACADE (POD A)	349 LINEAR FEET 4 CANOPY TREES PER 100 LIN. FT. REQUIRED = 14 CANOPY TREES REQUIRED + ROW OF SHRUBS	14 CANOPY TREES PROVIDED ROW OF SHRUBS PROVIDED

*Per City of Alachua Comprehensive Plan Future Land Use
Element, Objective 2.4, Policy 2.4.a*

ENTIRE SITE

TOTAL SITE AREA.....	633,271 S.F.
TOTAL PROPOSED LANDSCAPED AREA.....	212,228 S.F.
LANDSCAPED AREA % OF TOTAL SITE AREA.....	64.5%
(MIN. 30%)	

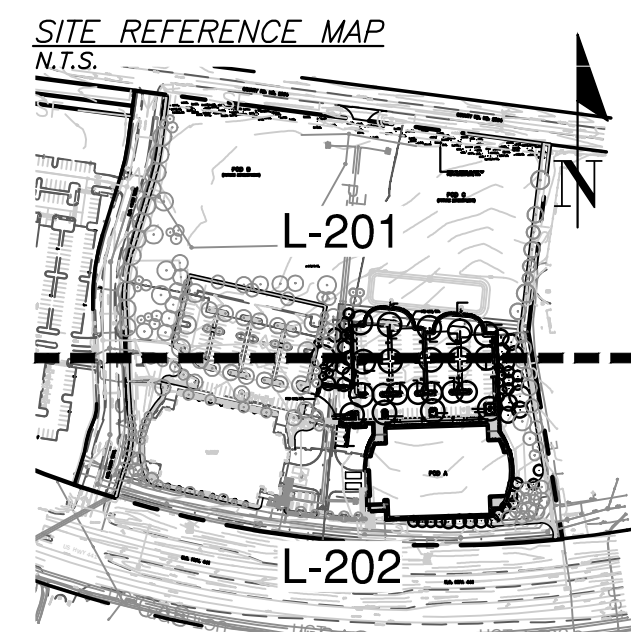

**10748 Deerwood Park Blvd. South
Jacksonville, Florida 32256-0597
904-256-2500 Fax 904-256-2503
www.rsandh.com
FL Cert. Nos. AAC001886 * IB26000956 *
5620 * LCC000210 * GB238**



132 NW 76th Drive
Gainesville, Florida 32607
(352) 331-1976 / (352) 331-2476
www.chw-inc.com

est. 1988 **FLORIDA**
CA-507

[illegible]

DATE ISSUED: 06/30/16

SCALE: N/A

DRAWN BY: CMT

REVIEWED BY: CEM

CHW PROJECT NUMBER

16-0111

© 2010 ECHO, INC.

LANDSCAPE
NOTES, DETAILS,
& CALCULATIONS -
POD A

SHEET NUMBER

L-200

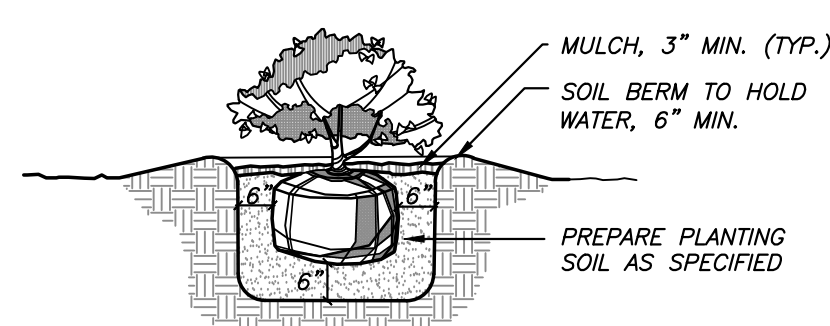
CITY
SUBMITTAL

3 SHRUB PLANTING DETAIL
N.T.S.

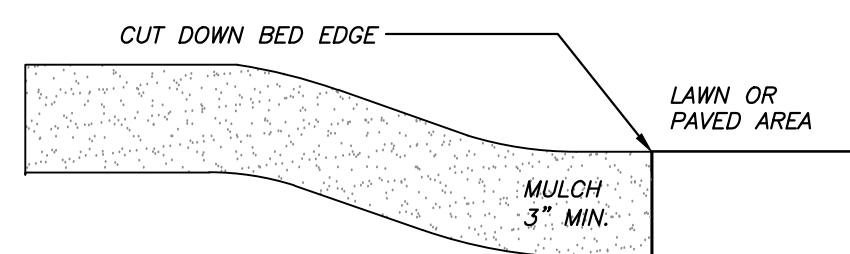

4 MULCH DETAIL
N.T.S.

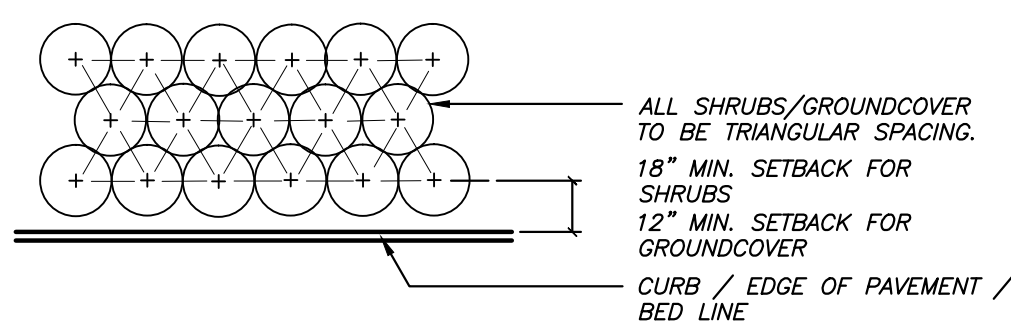

NOTE: THE PERIMETER OF ALL CURVED PLANTING BEDS SHALL BE PLANTED WITH A ROW OF SHRUBS AS SHOWN IN THE PLANS AND AT THE SPACING SHOWN IN THE PLANT LIST. INTERIOR PORTIONS OF EACH BED SHALL BE PLANTED AT APPROPRIATE SPACING ACCORDING TO THIS PLANT SPACING DETAIL.

5 PLANT SPACING DETAIL
N.T.S.

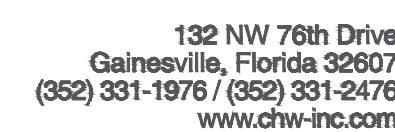

CONSULTANTS

est. 1988 **FLORIDA**
CA-5075

DATE ISSUED:	06/30/18
SCALE:	1" = 30'-0"
DRAWN BY:	CMT
REVIEWED BY:	CEM

CHW PROJECT NUMBER
16-0111

© 2016 RS&H, INC.

SHEET NUMBER

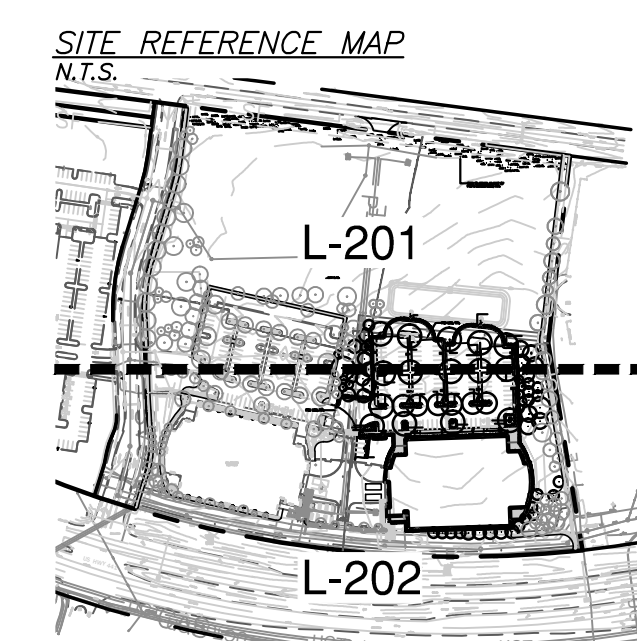
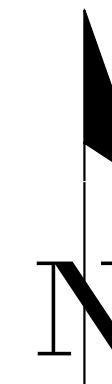
CITY
SUBMITTAL



CONSULTANTS

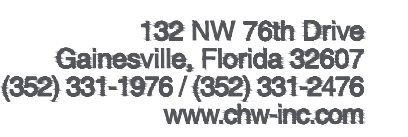

REVISIONS

[illegible]

DATE ISSUED: 06/30/16

SCALE: 1" = 30' - 0"

DRAWN BY: CMT

REVIEWED BY: CEM

CHW PROJECT NUMBER

16-0111

LANDSCAPE PLAN
- POD A

SHEET NUMBER

L-202

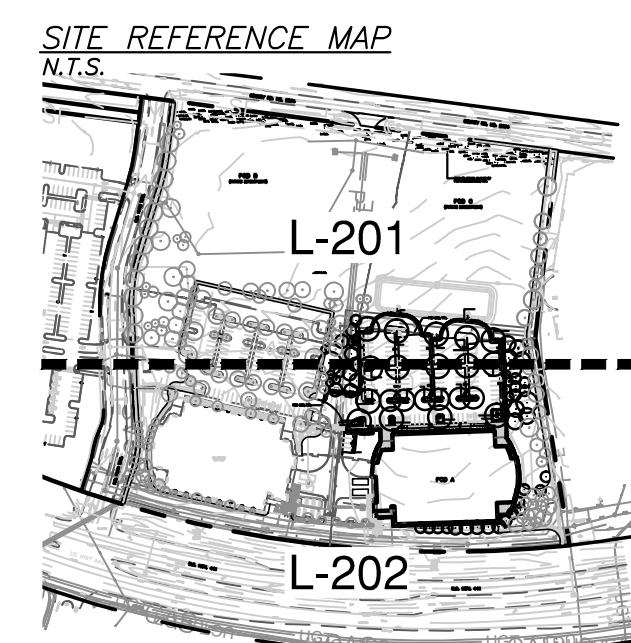
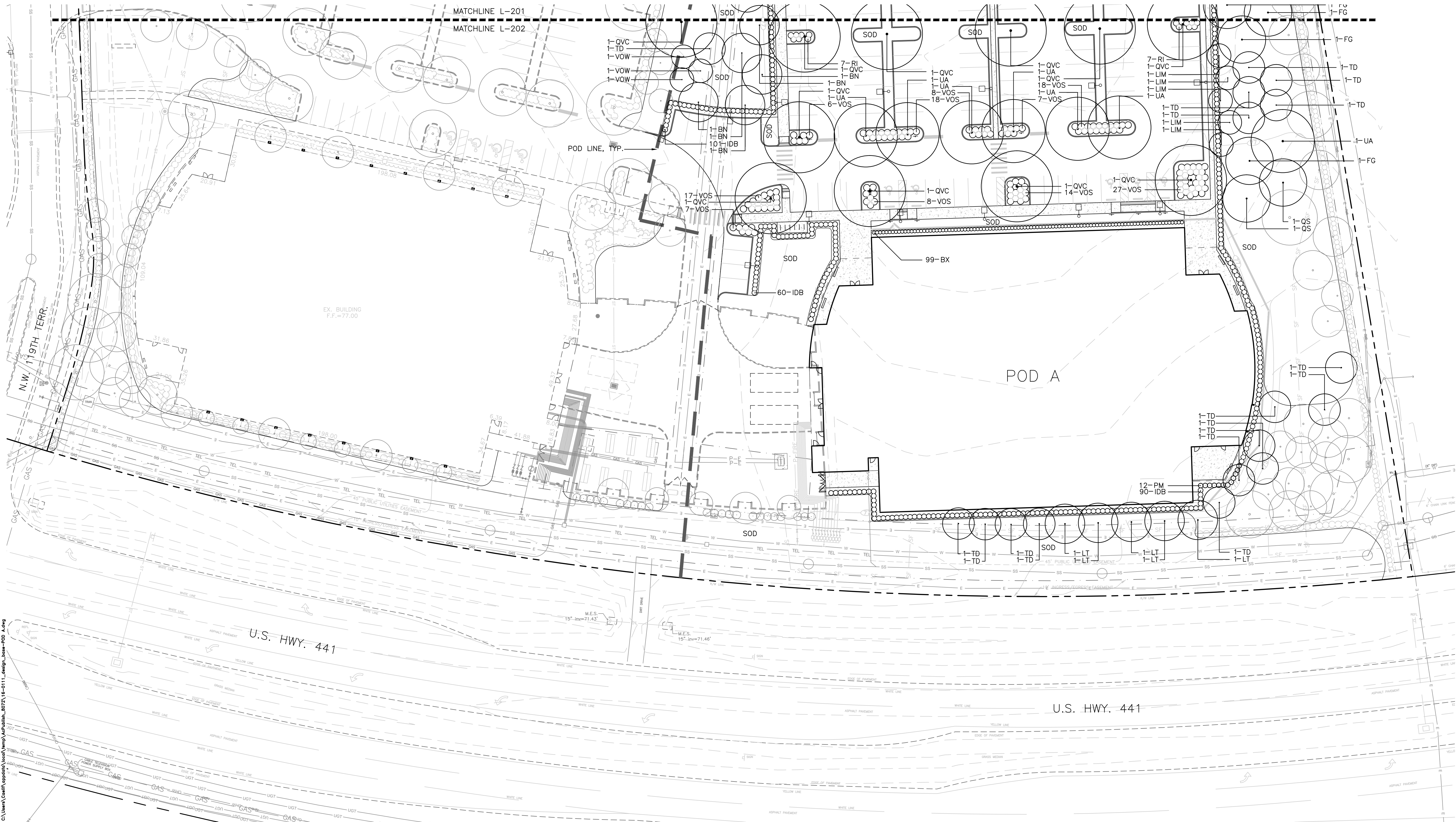
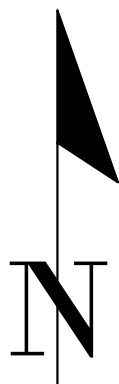
CITY
SUBMITTAL

Tech: coalit Plot Date: Oct 15, 2016 1:23pm Filename: C:\Users\Coalit\appdata\local\temp\AcPublish_8072\16-0111_design_base-P00_A.dwg

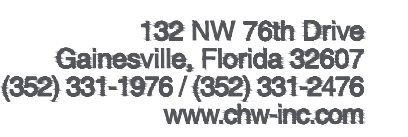

CONSULTANTS

[illegible]

CHW PROJECT NUMBER

CITY
SUBMITTAL