

Mailed 11/28/16
[Signature]

NOTICE OF PUBLIC HEARING BEFORE THE PLANNING AND ZONING BOARD OF THE CITY OF ALACHUA, FLORIDA

Notice is hereby given that the Planning and Zoning Board of the City of Alachua will hold a public hearing on December 13, 2016, at 6:30 p.m. The hearing will be held in the James A. Lewis Commission Chambers in City Hall, located at 15100 NW 142nd Terrace, Alachua, Florida, to consider the following: A request by Randall S. Olney, P.E., of Causseaux, Hewett, & Walpole, Inc., applicant and agent for Alachua Foundation Park Holding Company, LLC, and the University of Florida Foundation, Inc., property owners, for consideration of a Site Plan for the construction of three (3) ±42,460 square foot buildings, with associated parking, utilities, and supporting site improvements, on a ±14.53 acre subject property, located northeast of the intersection of NW US Highway 441, southeast of the intersection of County Road 2054 (also known as Rachael Boulevard) and NW 119th Terrace, east of NW 119th Terrace and the Santa Fe College Perry Center, and west of the State of Florida Building; Tax Parcel Numbers 03191-010-001 and 03191-011-000; FLUM: Industrial; Zoning: Light & Warehouse Industrial (ILW).

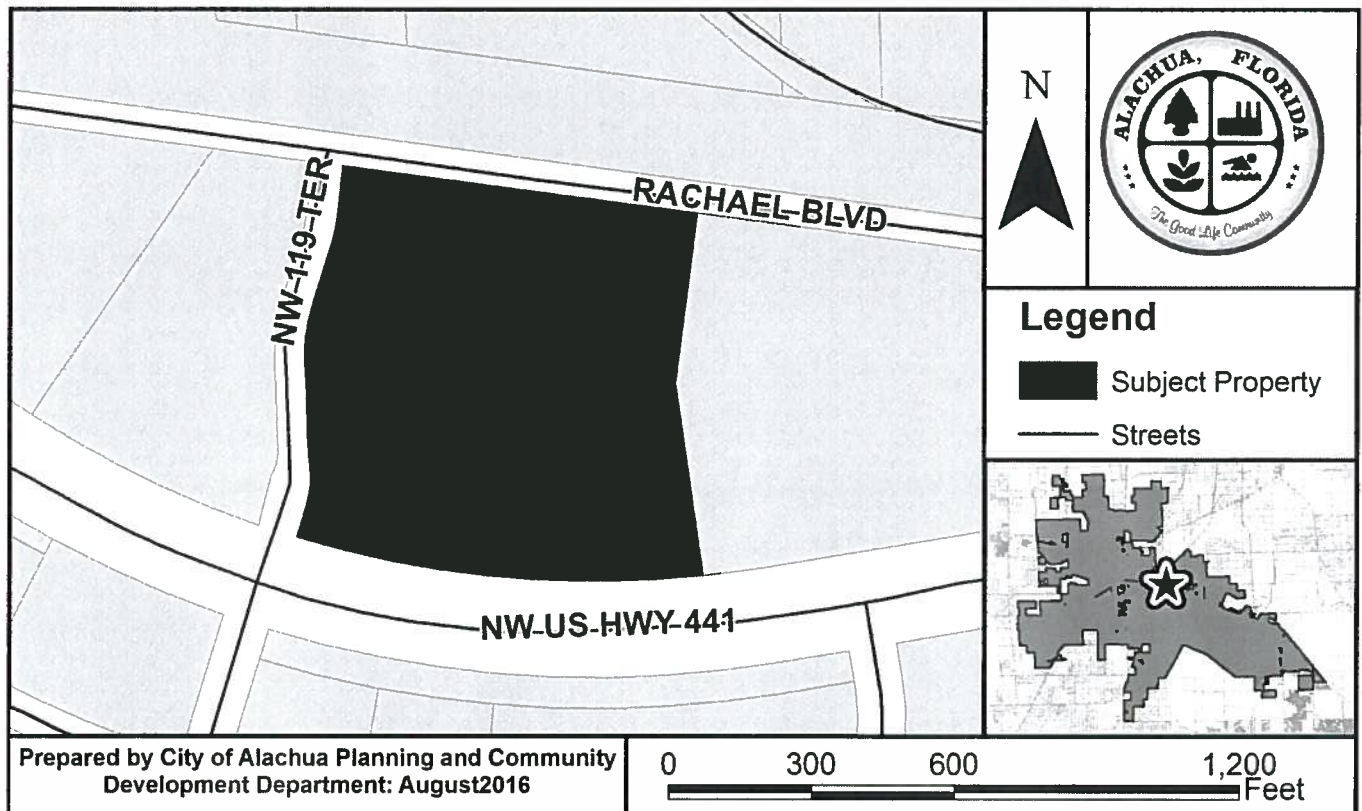

At the public hearing, all interested parties may appear and be heard with respect to the application. Copies of the application are available for public inspection at the Planning and Community Development Department, 15100 NW 142nd Terrace, Alachua, Florida, on any regular business day between the hours of 7:30 a.m. to 6:00 p.m. Written comments on the application may be sent to the following address: City of Alachua, Planning and Community Development, P.O. Box 9, Alachua, FL 32616. Notice is given pursuant to Section 286.0105, Florida Statutes, that, in order to appeal any decision made at the public hearing, you will need a record of the proceedings, and that, for such purpose, you may need to ensure that a verbatim record of the proceedings is made, which includes the testimony and evidence upon which the appeal is to be based. In accordance with the Americans with Disabilities Act, any persons with a disability requiring reasonable accommodation in order to participate in this meeting should call the City Clerk at (386) 418-6100 x 101 at least 48 hours prior to the public hearing.

P.O. Box 9 ♦ Alachua, Florida 32616-0009
Phone: (386) 418-6121 ♦ Fax: (386) 418-6130

03189-001-000
TEMPLE OF THE UNIVERSE INC
15808 NW 90TH ST
ALACHUA FL 32615

03189-004-000
COURTNEY CLIFTON
PO BOX 1454
ALACHUA FL 32616-1454

03189-006-000
MARKHAM, BRENN A
11707 SAGE BLVD
ALACHUA FL 32615-5737

03189-006-001
MARKHAM BRENN A
11707 SAGE BLVD
ALACHUA FL 32615-5737

03189-200-000
CSX TRANSPORTATION INC
TAX DEPARTMENT J-910, 500 WATER ST.
JACKSONVILLE FL 32202-4423

03191-001-000
BOARD OF TRUSTEES OF THE, INTE
THTF/DMS
3900 COMMONWEALTH BLVD
TALLAHASSEE FL 32399-6575

03191-010-000
U OF F FOUNDATION INC
PO BOX 14425
GAINESVILLE FL 32604-2425

03191-010-001
U OF F FOUNDATION INC
PO BOX 14425
GAINESVILLE FL 32604-2425

03191-010-002
DISTRICT BOARD OF TRUSTEES OF
3000 NW 83RD ST
GAINESVILLE FL 32606

03197-000-000
GARDNER & GARDNER
11708 SAGE BLVD
ALACHUA FL 32615

03956-010-021
TOMPKINS, DARRY J & CINDY P
PO BOX 519
ALACHUA FL 32616

03956-010-024
TOMPKINS, DARRYL J
PO BOX 519
ALACHUA FL 32616

03956-010-027
SHOPPES AT PROGRESS CENTER LLC
3600 NW 43RD ST STE E-2
GAINESVILLE FL 32606

03956-010-028
PONCE INLET INVESTMENTS LLC
15105 NW 94TH AVE
ALACHUA FL 32615

03956-010-038
PROGRESS CENTER PROPERTY, OWNE
13709 PROGRESS BLVD
ALACHUA FL 32615

92060-517-900
CSX TRANSPORTATION INC
TAX DEPARTMENT J-910, 500 WATER ST.
JACKSONVILLE FL 32202-4423

03091-011-001

Antoinette Endelicato
5562 NW 93rd Avenue
Gainesville, FL 32653

Dan Rhine
288 Turkey Creek
Alachua, FL 32615

Tom Gorman
9210 NW 59th Street
Alachua, FL 32653

Richard Gorman
5716 NW 93rd Avenue
Alachua, FL 32653

Peggy Arnold
410 Turkey Creek
Alachua, FL 32615

David Forest
23 Turkey Creek
Alachua, FL 32615

John Tingle
333 Turkey Creek
Alachua, FL 32615

President
TCMOA
1000 Turkey Creek
Alachua, FL 32615

Linda Dixon, AICP
Assistant Director Planning
PO Box 115050
Gainesville, FL 32611

Craig Parenteau
FDEP
4801 Camp Ranch Road
Gainesville, FL 32641

Jeannette Hinsdale
PO Box 1156
Alachua, FL 32616

Lynn Coullias
7406 NW 126th Avenue
Alachua, FL 32615

Lynda Coon
7216 NW 126 Avenue
Alachua, FL 32615

Tamara Robbins
PO Box 2317
Alachua, FL 32616

Dr. Lee A. Niblock
Alachua County Manager
12 SE 1st Street
Gainesville, FL 32601

John Amerson
All County Marion Property
Management
2916 NW Jacksonville Road
Ocala, FL 34479



City of ALACHUA

NOTICE OF PUBLIC HEARING BEFORE THE PLANNING AND ZONING BOARD OF THE CITY OF ALACHUA, FLORIDA

Notice is hereby given that the Planning and Zoning Board of the City of Alachua will hold a public hearing on December 13, 2016, at 6:30 p.m. The hearing will be held in the James A. Lewis Commission Chambers in City Hall, located at 15100 NW 142nd Terrace, Alachua, Florida, to consider the following: A request by Randall S. Olney, P.E., of Causseaux, Hewett, & Walpole, Inc., applicant and agent for Alachua Foundation Park Holding Company, LLC, and the University of Florida Foundation, Inc., property owners, for consideration of a Site Plan for the construction of three (3) \pm 42,460 square foot buildings, with associated parking, utilities, and supporting site improvements, on a \pm 14.53 acre subject property, located northeast of the intersection of NW US Highway 441, southeast of the intersection of County Road 2054 (also known as Rachael Boulevard) and NW 119th Terrace, east of NW 119th Terrace and the Santa Fe College Perry Center, and west of the State of Florida Building; Tax Parcel Numbers 03191-010-001 and 03191-011-000; FLUM: Industrial; Zoning: Light & Warehouse Industrial (ILW).

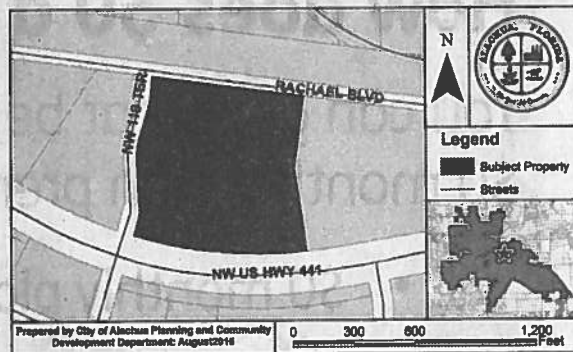

At the public hearing, all interested parties may appear and be heard with respect to the application. Copies of the application are available for public inspection at the Planning and Community Development Department, 15100 NW 142nd Terrace, Alachua, Florida, on any regular business day between the hours of 7:30 a.m. to 6:00 p.m. Written comments on the application may be sent to the following address: City of Alachua, Planning and Community Development, P.O. Box 9, Alachua, FL 32616. Notice is given pursuant to Section 286.0105, Florida Statutes, that, in order to appeal any decision made at the public hearing, you will need a record of the proceedings, and that, for such purpose, you may need to ensure that a verbatim record of the proceedings is made, which includes the testimony and evidence upon which the appeal is to be based. In accordance with the Americans with Disabilities Act, any persons with a disability requiring reasonable accommodation in order to participate in this meeting should call the City Clerk at (386) 418-6100 x 101 at least 48 hours prior to the public hearing.

(Published: Alachua County Today - December 01, 2016)

AFFIDAVIT FOR POSTED LAND USE SIGN

I Garrett Grantham
Garrett H. Grantham, POSTED THE LAND USE
(Name)
SIGN ON 11/28/2016 FOR THE Foundation Park Phase 2 Site Plan
(Date) (State type of action and project name)
LAND USE ACTION.

AS PER ARTICLE 2.2.9 D OF THE LAND DEVELOPMENT REGULATIONS.

THIS WILL BE INCLUDED IN THE STAFF REPORT.

Garrett H. Grantham
(Signature)

5
(Number of signs)