

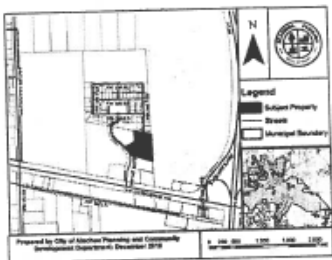

City of ALACHUA

NOTICE OF PUBLIC HEARING BEFORE THE PLANNING AND ZONING BOARD OF THE CITY OF ALACHUA, FLORIDA

Notice is hereby given that the Planning and Zoning Board of the City of Alachua will hold a public hearing on January 10, 2017 at 6:00 p.m. The hearing will be held in the James A. Lewis Commission Chambers in City Hall, located at 15100 NW 142nd Terrace, Alachua, Florida, to consider the following: A request by Sergio Reyes, PE, of eda engineers-surveyors-planners, inc., applicant and agent for Hipp Investments, LLC., property owner, for consideration of a Site Plan for a proposed $\pm 58,821$ square foot, 92 room hotel with associated drainage, paving, grading, and utility infrastructure improvements on a ± 4.24 acre subject property, located at 16367 NW 167th Boulevard (north of NW US Highway 441, south of the Heritage Oaks Subdivision, east of the Alachua Market Place Plaza); a portion of Tax Parcel No. 03053-001-001; FLUM: Commercial; Zoning: Commercial Intensive (CI).



At the public hearing, all interested parties may appear and be heard with respect to the application. Copies of the application are available for public inspection at the Planning and Community Development Department, 15100 NW 142nd Terrace, Alachua, Florida, on any regular business day between the hours of 7:30 a.m. to 6:00 p.m. Written comments on the application may be sent to the following address: City of Alachua, Planning and Community Development, P.O. Box 9, Alachua, FL 32616. Notice is given pursuant to Section 286.0105, Florida Statutes, that, in order to appeal any decision made at the public hearing, you will need a record of the proceedings, and that, for such purpose, you may need to ensure that a verbatim record of the proceedings is made, which includes the testimony and evidence upon which the appeal is to be based. In accordance with the Americans with Disabilities Act, any persons with a disability requiring reasonable accommodation in order to participate in this meeting should call the City Clerk at (386) 418-6100 x 101 at least 48 hours prior to the public hearing.

(Published: Alachua County Today - December 29, 2016)

level
Ame
New
Club
a nu
raise
from
town
Acro

• USEFUL & DECORATIVE ITEMS •

MAILED 12/21/16
AJH

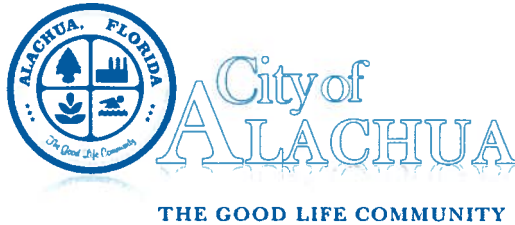

NOTICE OF PUBLIC HEARING BEFORE THE PLANNING AND ZONING BOARD OF THE CITY OF ALACHUA, FLORIDA

Notice is hereby given that the Planning and Zoning Board of the City of Alachua will hold a public hearing on January 10, 2017 at 6:00 p.m. The hearing will be held in the James A. Lewis Commission Chambers in City Hall, located at 15100 NW 142nd Terrace, Alachua, Florida, to consider the following: A request by Sergio Reyes, PE, of eda engineers-surveyors-planners, inc., applicant and agent for Hipp Investments, LLC., property owner, for consideration of a Site Plan for a proposed $\pm 58,821$ square foot, 92 room hotel with associated drainage, paving, grading, and utility infrastructure improvements on a ± 4.24 acre subject property, located at 16367 NW 167th Boulevard (north of NW US Highway 441, south of the Heritage Oaks Subdivision, and east of the Alachua Market Place Plaza); a portion of Tax Parcel No. 03053-001-001; FLUM: Commercial; Zoning: Commercial Intensive (CI).

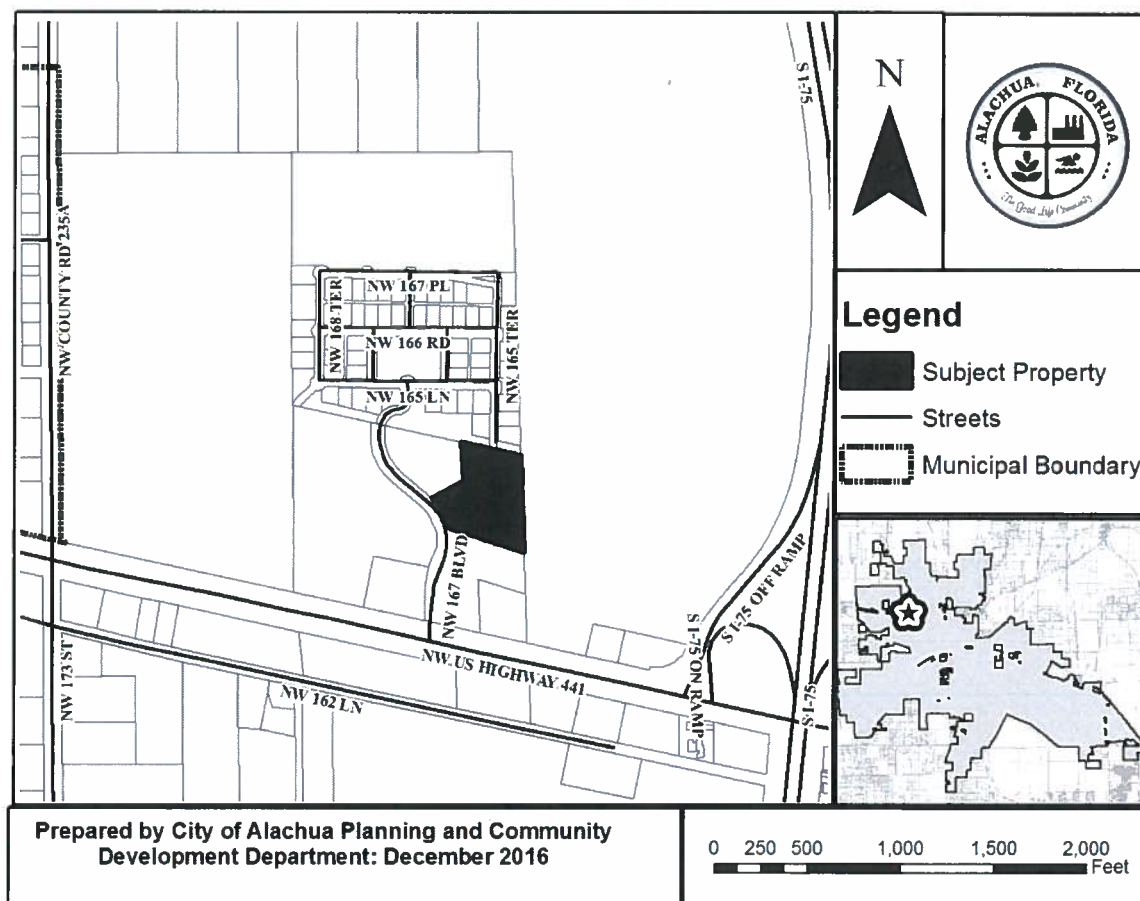

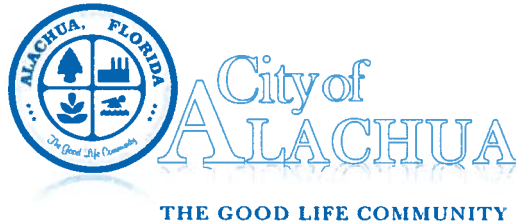

At the public hearing, all interested parties may appear and be heard with respect to the application. Copies of the application are available for public inspection at the Planning and Community Development Department, 15100 NW 142nd Terrace, Alachua, Florida, on any regular business day between the hours of 7:30 a.m. to 6:00 p.m. Written comments on the application may be sent to the following address: City of Alachua, Planning and Community Development, P.O. Box 9, Alachua, FL 32616. Notice is given pursuant to Section 286.0105, Florida Statutes, that, in order to appeal any decision made at the public hearing, you will need a record of the proceedings, and that, for such purpose, you may need to ensure that a verbatim record of the proceedings is made, which includes the testimony and evidence upon which the appeal is to be based. In accordance with the Americans with Disabilities Act, any persons with a disability requiring reasonable accommodation in order to participate in this meeting should call the City Clerk at (386) 418-6100 x 101 at least 48 hours prior to the public hearing.

03053-001-002
TALAL PROPERTIES LTD & TAREK
1326 E LUMSDEN RD
BRANDON, FL 33511

03053-010-014
FORD NATHANIEL M III & TIROSHSA
T
16515 NW 165TH TER
ALACHUA, FL 32615

03053-010-017
NYGAARD & STRATTAN
16567 NW 165TH LN
ALACHUA, FL 32615

03053-010-045
NOTO & NOTO
16603 NW 168TH TER
Alachua, FL 32615

03053-010-018
WALLACE CHARLES E & PATRICIA A
16621 NW 165TH LN
ALACHUA, FL 32615

03053-010-046
BOLANOS & MCKERCHER W/H
16642 NW 167TH DR
ALACHUA, FL 32615

03053-010-002
DOLBEC RICHARD D II & LAUREN K
16813 NW 165TH LANE
Alachua, FL 32615

03053-010-047
ROGERS, MICHAEL C & FELICIA GA
24644 49TH RD
O'BRIEN, FL 32071

03053-001-004
ALACHUA-WINDCREST LLC
605 EAST ROBINSON ST STE 340
ORLANDO, FL 32801

03053-001-005
A MASON GRACE RENTALS LLC
13929 NW 166TH TER
ALACHUA, FL 32615

03053-010-015
MITCHELL CHARLES E & NANCY E
16530 NW 165TH TER
ALACHUA, FL 32615

03053-010-012
FROMHOLT DAVID B & SUSAN E
16575 NW 165TH TER
ALACHUA, FL 32615

03053-010-051
HARRIS AARON A
16609 NW 166TH DR
ALACHUA, FL 32615

03053-010-044
GEPHART RALPH G & DOROTHY J
16623 NW 168TH TER
ALACHUA, FL 32615

03053-010-019
MANDARINO TERRANCE M & LISA
CLARK
16651 NW 165TH LN
ALACHUA, FL 32615

03053-010-003
GRIEVE THOMAS H & MELISA A
16843 NW 165TH LN
ALACHUA, FL 32615

03049-000-000
MEGAHEE ENTERPRISES LTD.,LLLP
2632 NW 43RD ST # 2138
GAINESVILLE, FL 32606

03053-010-016
CARTER DIANE S
8502 NW 35TH RD
GAINESVILLE, FL 32606

03053-010-054
SCHULTZ, RICHARD B & CECILIA
1171 APPIAN WAY
SANTA ANA, CA 92705

03053-001-001
HIPPI INVESTMENTS LLC
14610 NW 129TH TER
ALACHUA, FL 32615

03053-010-013
JELMBERG MICHAEL & MARY
16545 NW 165TH TER
ALACHUA, FL 32615

03053-010-048
WESTBROOK BENTON C & DORA H
16602 NW 167TH DR
ALACHUA, FL 32615

03053-010-011
AXIAK LAURA ANNE
16611 NW 165TH TER
ALACHUA, FL 32615

03053-010-053
DAVIS RICHARD E JR & MAUREEN
16624 NW 165TH TER
ALACHUA, FL 32615

03053-010-001
STEVENS JOHN J & JAMIE N
16775 NW 165TH LANE
ALACHUA, FL 32615

03053-010-004
BROOKS TODD B
16873 NW 165TH LN
ALACHUA, FL 32615

03049-003-000
MURPHY'S LOT LLC
2632 NW 43RD ST STE 2138
GAINESVILLE, FL 32606-7545

03053-002-000
PATEL, INDIRA K
8706 SADDLEHORN DR
IRVING, TX 75063



03053-000-000
CAVACEPPI, SHARLEEN O TRUSTEE
PO BOX 1325
ALACHUA, FL 32616-1325

03053-001-003
RACETRAC PETROLEUM INC
PO BOX 56607
ATLANTA, GA 30343

03061-004-001
CIRCLE K STORES INC
PO BOX 8019
GARY, NC 27512-9998

03053-010-000
HERITAGE OAKS PROPERTY,
OWNERS
PO BOX 969
Alachua, FL 32516

Antoinette Endelicato
5562 NW 93rd Avenue
Gainesville, FL 32653

Dan Rhine
288 Turkey Creek
Alachua, FL 32615

Tom Gorman
9210 NW 59th Street
Alachua, FL 32653

Richard Gorman
5716 NW 93rd Avenue
Alachua, FL 32653

Peggy Arnold
410 Turkey Creek
Alachua, FL 32615

David Forest
23 Turkey Creek
Alachua, FL 32615

John Tingue
333 Turkey Creek
Alachua, FL 32615

President of TCMOA
1000 Turkey Creek
Alachua, FL 32615

Linda Dixon, AICP
Assistant Director Planning
PO Box 115050
Gainesville, FL 32611

Craig Parenteau
FL Department of Environmental Protection
4801 Camp Ranch Road
Gainesville, FL 32641

Jeannette Hinsdale
P.O. Box 1156
Alachua, FL 32616

Lynn Coullias
7406 NW 126th Ave
Alachua, FL 32615

Lynda Coon
7216 NW 126 Avenue
Alachua, FL 32615

Tamara Robbins
PO Box 2317
Alachua, FL 32616

Dr. Lee A. Niblock
Alachua County Manager
12 SE 1st Street
Gainesville, FL 32601

John Amerson
All County Marion Property Management
2916 NE Jacksonville Rd
Ocala, FL 34479



AFFIDAVIT FOR POSTED LAND USE SIGN

I MELISSA WATSON, POSTED THE LAND USE
(Name)
SIGN ON 12-21-16 FOR THE HOLIDAY INN SITE PLAN
(Date) (State type of action and project name)
LAND USE ACTION.

AS PER ARTICLE 2.2.9 D OF THE LAND DEVELOPMENT REGULATIONS.

THIS WILL BE INCLUDED IN THE STAFF REPORT.

Melissa Watson
(Signature)

1
(Number of signs)