

Teatime, Tranquility and Treasures at Willow's Rest opened to the public two weeks ago and is already so popular that the owners suggest reservations during the lunch hour. "We have

9 a.m. to 4 p.m. Additional information or reservations can be made by calling 386-243-9199. # # # Email rcarson@alachuatoday.com



City of ALACHUA

NOTICE OF PUBLIC HEARING BEFORE THE PLANNING AND ZONING BOARD OF THE CITY OF ALACHUA, FLORIDA

Notice is hereby given that the Planning & Zoning Board of the City of Alachua will hold a public hearing on July 12, 2022 at 6:00 p.m. The hearing will be held in the James A. Lewis Commission Chambers in City Hall, located at 15100 NW 142nd Terrace, Alachua, Florida, to consider the following: A request by Clay Sweger, AICP, LEED AP of eda consultants, inc, for William and Margaret Kirkland, property owners, for consideration of a Large Scale Comprehensive Plan Amendment to amend the Future Land Use Map (FLUM) on a ±51.7 acre subject property from Agriculture and Rural/ Agriculture (Alachua County) to Moderate Density Residential; located south of Peggy Road and Legacy Park, east of I-75, and north of the CSX rail line right-of-way; consisting of Tax Parcel Numbers 03924-000-000, 03865-000-000, and 03917-200-002. Existing FLUM: Agriculture and Rural/ Agriculture (Alachua County); Proposed FLUM: Moderate Density Residential; Existing Zoning: Agricultural (A) and Agricultural (A)(Alachua County).

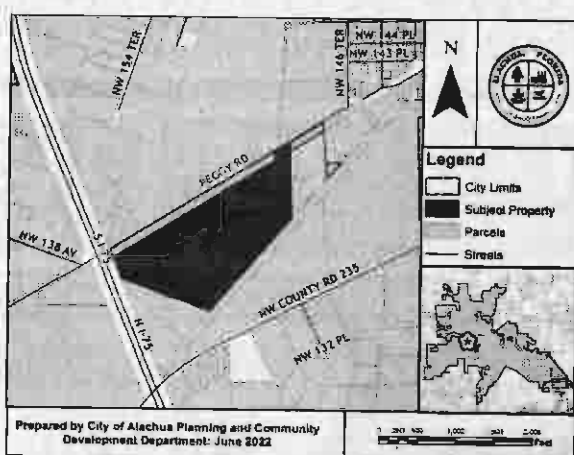

At the public hearing, all interested parties may appear and be heard with respect to the application. Copies of the application are available for public inspection at the Planning and Community Development Department, 15100 NW 142nd Terrace, Alachua, Florida, on any regular business day between the hours of 7:30 a.m. to 6:00 p.m. Written comments on the application may be sent to the following address: City of Alachua, Planning and Community Development, P.O. Box 9, Alachua, FL 32616. Notice is given pursuant to Section 286.0105, Florida Statutes, that, in order to appeal any decision made at the public hearing, you will need a record of the proceedings, and that, for such purpose, you may need to ensure that a verbatim record of the proceedings is made, which includes the testimony and evidence upon which the appeal is to be based. In accordance with the Americans with Disabilities Act, any persons with a disability requiring reasonable accommodation in order to participate in this meeting should call the City Clerk at (386) 418-6100 x 1501 at least 48 hours prior to the public hearing.

(Published: Alachua County Today - June 30, 2022)



City of ALACHUA

NOTICE OF PUBLIC HEARING BEFORE THE PLANNING AND ZONING BOARD OF THE CITY OF ALACHUA, FLORIDA

Notice is hereby given that the Planning & Zoning Board of the City of Alachua will hold a public hearing on July 12, 2022 at 6:00 p.m. The hearing will be held in the James A. Lewis Commission Chambers in City Hall, located at 15100 NW 142nd Terrace, Alachua, Florida, to consider the following: A request by Clay Sweger, AICP, LEED AP of eda consultants, inc, for William and Margaret Kirkland, property owners, for consideration of a Site-Specific Amendment to the Official Zoning Atlas (Rezoning) on a ±51.7 acre subject property from Agricultural (A) and Agricultural (A)(Alachua County) to Planned Development - Residential (PD-R); located south of Peggy Road and Legacy Park, east of I-75, and north of the CSX rail line right-of-way; consisting of Tax Parcel Numbers 03924-000-000, 03865-000-000, and 03917-200-002. Existing Zoning: Agricultural; (A) and Agricultural (A)(Alachua County); Proposed Zoning: Planned Development - Residential (PD-R); Existing FLUM: Agriculture and Rural/Agriculture (Alachua County).

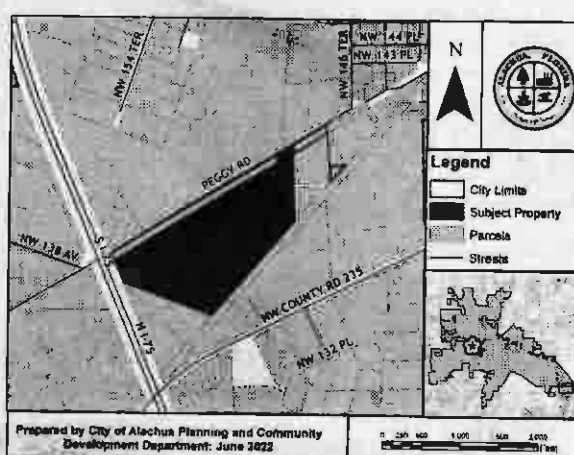

At the public hearing, all interested parties may appear and be heard with respect to the application. Copies of the application are available for public inspection at the Planning and Community Development Department, 15100 NW 142nd Terrace, Alachua, Florida, on any regular business day between the hours of 7:30 a.m. to 6:00 p.m. Written comments on the application may be sent to the following address: City of Alachua, Planning and Community Development, P.O. Box 9, Alachua, FL 32616. Notice is given pursuant to Section 286.0105, Florida Statutes, that, in order to appeal any decision made at the public hearing, you will need a record of the proceedings, and that, for such purpose, you may need to ensure that a verbatim record of the proceedings is made, which includes the testimony and evidence upon which the appeal is to be based. In accordance with the Americans with Disabilities Act, any persons with a disability requiring reasonable accommodation in order to participate in this meeting should call the City Clerk at (386) 418-6100 x 1501 at least 48 hours prior to the public hearing.

(Published: Alachua County Today - June 30, 2022)



City of ALACHUA

NOTICE OF PUBLIC HEARING BEFORE THE PLANNING AND ZONING BOARD OF THE CITY OF ALACHUA, FLORIDA

Notice is hereby given that the Planning and Zoning Board of the City of Alachua will hold a public hearing on July 12, 2022, at 6:00 p.m. The hearing will be held in the James A. Lewis Commission Chambers in City Hall, located at 15100 NW 142nd Terrace, Alachua, Florida, to consider the following: A request by Claudia Vega, P.E., of EDA Consultants, Inc., applicant and agent for The Laser Investment Group, LLC, property owner, for consideration of a Site Plan proposing the construction of three (3) nonresidential buildings totaling ±88,413 square feet, 20 attached residential units, ten (10) single family residential units, a ±3,140 square foot neighborhood recreation center, and a ±1,044 square foot amenity center on a ±13.23 acre subject property; Consisting of portions of Tax Parcel Numbers 05844-004-001 and 05855-005-000; FLUM: Corporate Park; Zoning: Corporate Park (CP).

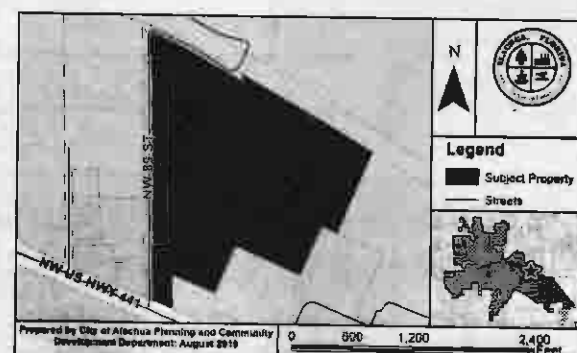

At the public hearing, all interested parties may appear and be heard with respect to the application. Copies of the application are available for public inspection at the Planning and Community Development Department, 15100 NW 142nd Terrace, Alachua, Florida, on any regular business day between the hours of 7:30 a.m. to 6:00 p.m. Written comments on the application may be sent to the following address: City of Alachua, Planning and Community Development, P.O. Box 9, Alachua, FL 32616. Notice is given pursuant to Section 286.0105, Florida Statutes, that, in order to appeal any decision made at the public hearing, you will need a record of the proceedings, and that, for such purpose, you may need to ensure that a verbatim record of the proceedings is made, which includes the testimony and evidence upon which the appeal is to be based. In accordance with the Americans with Disabilities Act, any persons with a disability requiring reasonable accommodation in order to participate in this meeting should call the City Clerk at (386) 418-6100 x 1501 at least 48 hours prior to the public hearing.

(Published: Alachua County Today - June 30, 2022)

Challengers take Florida’s abortion ban to court, saying it violates privacy right

John Kennedy
 Capital Bureau | USA TODAY NETWORK – FLORIDA

TALLAHASSEE — Only days before Florida is poised to ban most abortions after 15 weeks of pregnancy, a Leon County judge was asked this week to block the new law as a violation of the state constitutional right to privacy.

Circuit Judge John Cooper has indicated he expects to rule in the case before Friday, when the new restriction is set to take effect. Planned Parenthood affiliates in Florida and allied organizations sued this month to block the law.

“Abortion is a very common procedure,” Dr. Shelly Tien of Jacksonville said, in testimony Monday before Cooper. “It’s a very safe procedure.”

Tien, among the plaintiffs in the case, is a maternal-fetal medicine specialist who performs abortions with Planned Parenthood of South, East and North Florida. She also travels around the country to provide abortions in regions with limited access.

In mostly party-line votes, Florida’s Republican-controlled House and Senate approved overhauling the state’s abortion law earlier this year. The legislation, HB 5, was signed by Gov. Ron DeSantis in April.

Florida’s law has allowed abortions for up to 24 weeks of pregnancy for most of the decades since the U.S. Supreme Court’s Roe v. Wade decision legalizing the procedure in 1973.

The U.S. Supreme Court last Friday overturned Roe v. Wade, stripping away federal constitutional protections for abortion and potentially leading to abortion bans in half the states. In their 6-3 ruling, justices also upheld Mississippi’s 15-week abortion limit, which is identical to the Florida law about to take effect.

But Florida’s constitutional right to privacy, approved overwhelmingly by voters in 1980, adds certain safeguards that Planned Parenthood and others argue should halt the new 15-week ban.

Attorneys for the state, however, questioned Tien who acknowledged that data showed that 96.4% of abortions in Florida in 2019 occurred before the thirteenth week of pregnancy. When Tien was asked to acknowledge that few women seeking abortions would be affected by the new law, Cooper interrupted, also citing the 2019 statistics.

“Sixteen hundred (women) would be” barred from abortions under the 15-week standard, Cooper said. “And all those who have become pregnant by rape would be affected by HB 5.”

The state Supreme Court in 1989 relied on the state’s privacy right in striking down a parental consent law for minors seeking abortion, and the constitutional standard was cited by courts blocking other abortion restrictions in subsequent years.

But the current, seven-member state Supreme Court, comprised of three DeSantis appointees and all appointed by Republican governors, is viewed as conservative and potentially poised to reinterpret the privacy right, which states “every natural person has the right to be let alone and free from governmental intrusion.”

DeSantis and Republican leaders in the Legislature haven’t spoken about what could happen next in Florida, now that federal justices have given states authority to enact even stricter abortion laws or outright bans.

DeSantis in his comments following the Supreme Court ruling said his focus is on defending the state’s new restriction “against state court challenges,” hinting he is not eager to call lawmakers back into special session to enact tougher limits.

A Florida Atlantic University poll in May found that 67% of Floridians think abortion should be legal in all or most cases. For now, DeSantis and most Florida lawmakers up for election this year appear inclined to gauge how reaction to the Supreme Court ruling plays across the nation and state.

NOTICE OF PUBLIC HEARING BEFORE THE PLANNING AND ZONING BOARD OF THE CITY OF ALACHUA, FLORIDA

Notice is hereby given that the Planning & Zoning Board of the City of Alachua will hold a public hearing on July 12, 2022 at 6:00 p.m. The hearing will be held in the James A. Lewis Commission Chambers in City Hall, located at 15100 NW 142nd Terrace, Alachua, Florida, to consider the following: A request by Clay Sweger, AICP, LEED AP of eda consultants, inc, for William and Margaret Kirkland, property owners, for consideration of a Large Scale Comprehensive Plan Amendment to amend the Future Land Use Map (FLUM) on a ±51.7 acre subject property from Agriculture and Rural/ Agriculture (Alachua County) to Moderate Density Residential; located south of Peggy Road and Legacy Park, east of I-75, and north of the CSX rail line right-of-way; consisting of Tax Parcel Numbers 03924-000-000, 03865-000-000, and 03917-200-002. Existing FLUM: Agriculture and Rural/ Agriculture (Alachua County); Proposed FLUM: Moderate Density Residential; Existing Zoning: Agricultural (A) and Agricultural (A)(Alachua County).

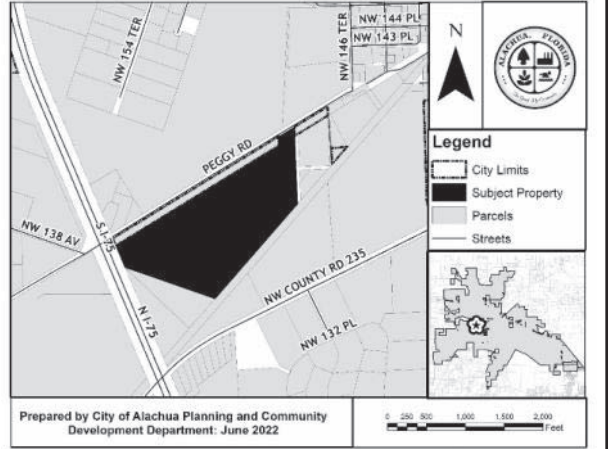

At the public hearing, all interested parties may appear and be heard with respect to the application. Copies of the application are available for public inspection at the Planning and Community Development Department, 15100 NW 142nd Terrace, Alachua, Florida, on any regular business day between the hours of 7:30 a.m. to 6:00 p.m. Written comments on the application may be sent to the following address: City of Alachua, Planning and Community Development, P.O. Box 9, Alachua, FL 32616. Notice is given pursuant to Section 286.0105, Florida Statutes, that, in order to appeal any decision made at the public hearing, you will need a record of the proceedings, and that, for such purpose, you may need to ensure that a verbatim record of the proceedings is made, which includes the testimony and evidence upon which the appeal is to be based. In accordance with the Americans with Disabilities Act, any persons with a disability requiring reasonable accommodation in order to participate in this meeting should call the City Clerk at (386) 418-6100 x 1501 at least 48 hours prior to the public hearing.

GF-30946574

Elections

Continued from Page 3A

Boatner also comes to the office with an impressive resume, Barton added.

The political science major is just 10 credits shy of earning his degree, the least anyone has needed for anyone who held the position prior. He also played a role in helping draw new district lines locally, assisting UF professors Dan Smith and Michael McDonald.

Candidates often rely on UF students to help with campaigns during election years, though many under-

stand the job is only temporary. Those campaign workers then develop experience and skills to move on to careers in politics. Campaign expenses show that Arreola’s campaign last paid \$750 to Boatner for his help on April 12.

Arreola praised Boatner for his work and congratulated him on his new role, adding that Boatner was immediately removed as treasurer and severed all campaign accounts and activity once he received the job offer.

“I hired him for a reason,” Arreola said. “I encourage anybody who wants to know more about elections and politics to work for campaigns. It really is an educational experience.”

NOTICE OF PUBLIC HEARING BEFORE THE PLANNING AND ZONING BOARD OF THE CITY OF ALACHUA, FLORIDA

Notice is hereby given that the Planning & Zoning Board of the City of Alachua will hold a public hearing on July 12, 2022 at 6:00 p.m. The hearing will be held in the James A. Lewis Commission Chambers in City Hall, located at 15100 NW 142nd Terrace, Alachua, Florida, to consider the following: A request by Craig Brashier, AICP, of Causseaux, Hewett, & Walpole, Inc., applicant and agent for Tomoka Hills Farms, Inc., property owner, for consideration of a Site-Specific Amendment to the Official Zoning Atlas (Rezoning) to amend the Official Zoning Atlas on a ±45.3 acre subject property from Agricultural (A) to Community Commercial (CC) on a parcel of land generally located southeast of the US Highway 441/Interstate 75 interchange, south of US Highway 441 and NW 162nd Lane, west of Interstate 75, and east of NW 173rd Street (also known as County Road 235-A); consisting of portions of Tax Parcel Numbers 03873-000-000 and 03873-001-000. Existing FLUM: Agriculture; Proposed FLUM: Community Commercial; Existing Zoning: Agricultural (A).

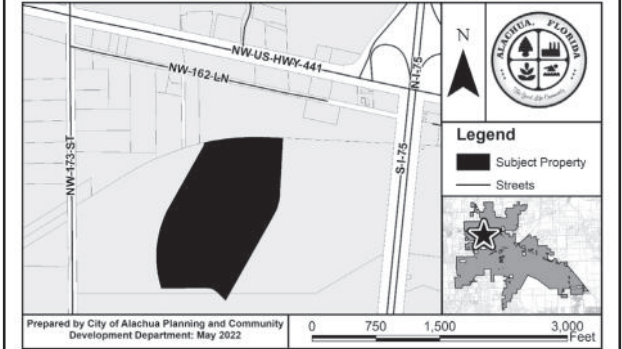

At the public hearing, all interested parties may appear and be heard with respect to the application. Copies of the application are available for public inspection at the Planning and Community Development Department, 15100 NW 142nd Terrace, Alachua, Florida, on any regular business day between the hours of 7:30 a.m. to 6:00 p.m. Written comments on the application may be sent to the following address: City of Alachua, Planning and Community Development, P.O. Box 9, Alachua, FL 32616. Notice is given pursuant to Section 286.0105, Florida Statutes, that, in order to appeal any decision made at the public hearing, you will need a record of the proceedings, and that, for such purpose, you may need to ensure that a verbatim record of the proceedings is made, which includes the testimony and evidence upon which the appeal is to be based. In accordance with the Americans with Disabilities Act, any persons with a disability requiring reasonable accommodation in order to participate in this meeting should call the City Clerk at (386) 418-6100 x 1501 at least 48 hours prior to the public hearing.

GF-30946323

NOTICE OF PUBLIC HEARING BEFORE THE PLANNING AND ZONING BOARD OF THE CITY OF ALACHUA, FLORIDA

Notice is hereby given that the Planning & Zoning Board of the City of Alachua will hold a public hearing on July 12, 2022 at 6:00 p.m. The hearing will be held in the James A. Lewis Commission Chambers in City Hall, located at 15100 NW 142nd Terrace, Alachua, Florida, to consider the following: A request by Craig Brashier, AICP, of Causseaux, Hewett, & Walpole, Inc., applicant and agent for Tomoka Hills Farms, Inc., property owner, for consideration of a Small Scale Comprehensive Plan Amendment on a ±45.3 acre subject property to amend the Future Land Use Map (FLUM) from Agriculture to Community Commercial on a parcel of land generally located southeast of the US Highway 441/Interstate 75 interchange, south of US Highway 441 and NW 162nd Lane, west of Interstate 75, and east of NW 173rd Street (also known as County Road 235-A); consisting of portions of Tax Parcel Numbers 03873-000-000 and 03873-001-000. Existing FLUM: Agriculture; Proposed FLUM: Community Commercial; Existing Zoning: Agricultural (A).

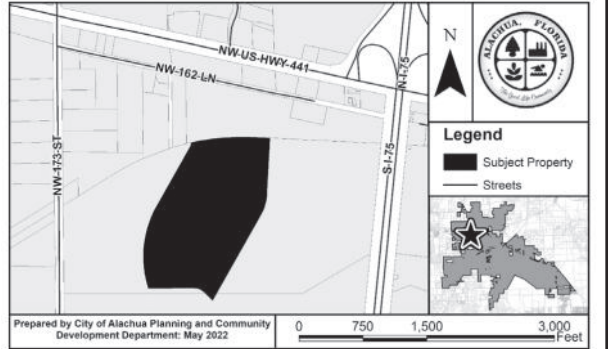

At the public hearing, all interested parties may appear and be heard with respect to the application. Copies of the application are available for public inspection at the Planning and Community Development Department, 15100 NW 142nd Terrace, Alachua, Florida, on any regular business day between the hours of 7:30 a.m. to 6:00 p.m. Written comments on the application may be sent to the following address: City of Alachua, Planning and Community Development, P.O. Box 9, Alachua, FL 32616. Notice is given pursuant to Section 286.0105, Florida Statutes, that, in order to appeal any decision made at the public hearing, you will need a record of the proceedings, and that, for such purpose, you may need to ensure that a verbatim record of the proceedings is made, which includes the testimony and evidence upon which the appeal is to be based. In accordance with the Americans with Disabilities Act, any persons with a disability requiring reasonable accommodation in order to participate in this meeting should call the City Clerk at (386) 418-6100 x 1501 at least 48 hours prior to the public hearing.

GF-30946402

At the public hearing, all interested parties may appear and be heard with respect to the application. Copies of the application are available for public inspection at the Planning and Community Development Department, 15100 NW 142nd Terrace, Alachua, Florida, on any regular business day between the hours of 7:30 a.m. to 6:00 p.m. Written comments on the application may be sent to the following address: City of Alachua, Planning and Community Development, P.O. Box 9, Alachua, FL 32616. Notice is given pursuant to Section 286.0105, Florida Statutes, that, in order to appeal any decision made at the public hearing, you will need a record of the proceedings, and that, for such purpose, you may need to ensure that a verbatim record of the proceedings is made, which includes the testimony and evidence upon which the appeal is to be based. In accordance with the Americans with Disabilities Act, any persons with a disability requiring reasonable accommodation in order to participate in this meeting should call the City Clerk at (386) 418-6100 x 1501 at least 48 hours prior to the public hearing.

GF-30946532

NOTICE OF PUBLIC HEARING BEFORE THE AND ZONING BOARD OF THE CITY OF ALACHUA, FLORIDA

Notice is hereby given that the Planning & Zoning Board of the City of Alachua will hold a public hearing on July 12, 2022 at 6:00 p.m. The hearing will be held in the James A. Lewis Commission Chambers in City Hall, located at 15100 NW 142nd Terrace, Alachua, Florida, to consider the following:

A request by Clay Sweger, AICP, LEED AP of eda consultants, inc, for William and Margaret Kirkland, property owners, for consideration of a Large Scale Comprehensive Plan Amendment to amend the Future Land Use Map (FLUM) on a ± 51.7 acre subject property from Agriculture and Rural/ Agriculture (Alachua County) to Moderate Density Residential; located south of Peggy Road and Legacy Park, east of I-75, and north of the CSX rail line right-of-way; consisting of Tax Parcel Numbers 03924-000-000, 03865-000-000, and 03917-200-002. Existing FLUM: Agriculture and Rural/ Agriculture (Alachua County); Proposed FLUM: Moderate Density Residential; Existing Zoning: Agricultural (A) and Agricultural (A)(Alachua County).

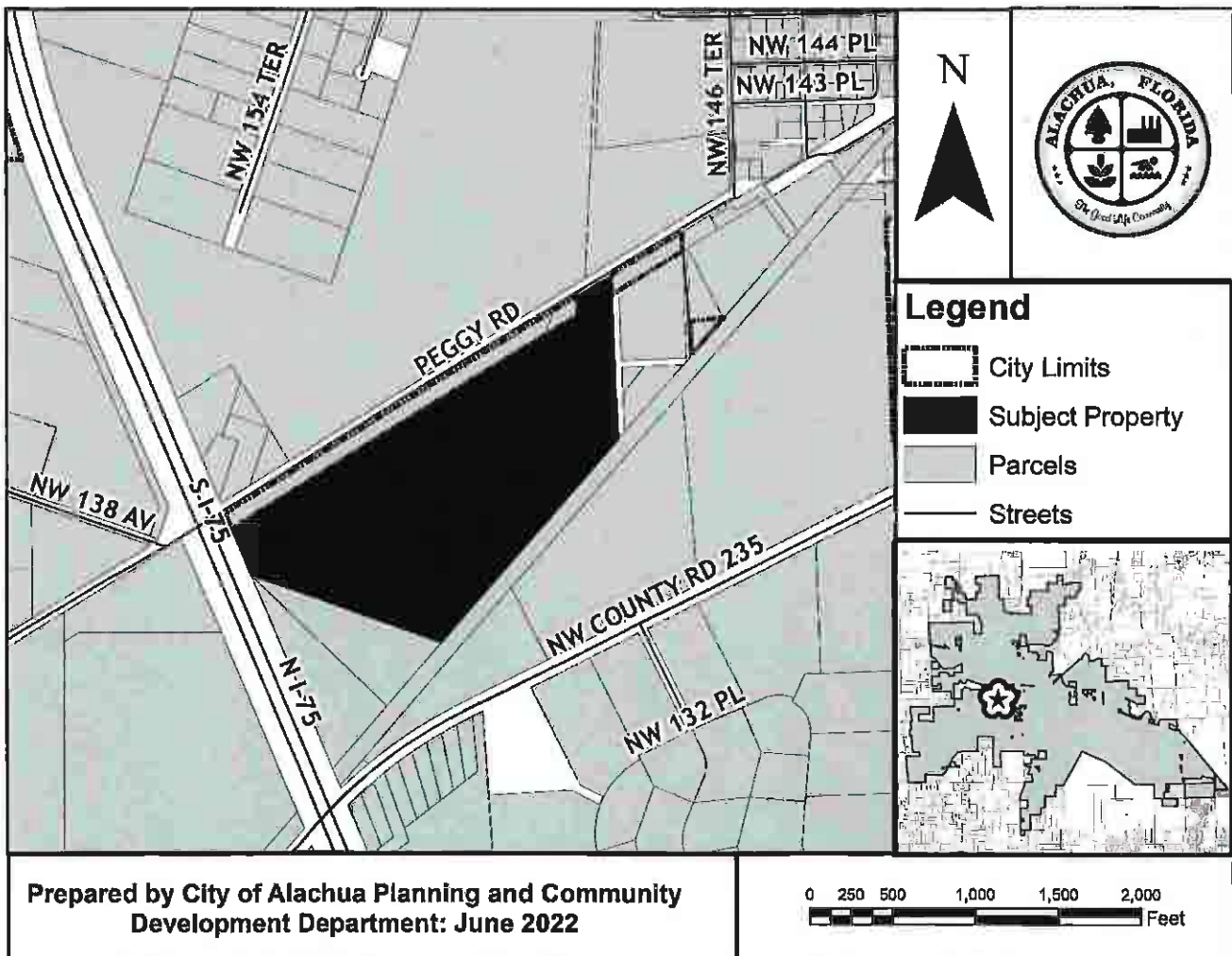

At the public hearing, all interested parties may appear and be heard with respect to the application. Copies of the application are available for public inspection at the Planning and Community Development Department, 15100

Antoinette Endelicato
5562 NW 93rd Avenue
Gainesville, FL 32653

Richard Gorman
5716 NW 93rd Avenue
Alachua, FL 32653

President of TCMOA
1000 Turkey Creek
Alachua, FL 32615

Jeannette Hinsdale
P.O. Box 1156
Alachua, FL 32616

Tamara Robbins
PO Box 2317
Alachua, FL 32616

Hugh & Jean Calderwood
P.O. Box 2307
Alachua, FL 32616

Carrie Luke
16611 NW 138th Ave.
Alachua, FL 32615

Dan Rhine
288 Turkey Creek
Alachua, FL 32615

Peggy Arnold
410 Turkey Creek
Alachua, FL 32615

Linda Dixon, AICP
Assistant Director of Planning
PO Box 115050
Gainesville, FL 32611

Lynn Coullias
7406 NW 126th Ave
Alachua, FL 32615

Michele L. Lieberman
County Manager
12 SE 1st Street
Gainesville, FL 32601

Lisia Jenkins
P.O. Box 1071
Alachua, FL 32616

Dena Courtney
PO Box 1215
High Springs, FL 32655

Tom Gorman
9210 NW 59th Street
Alachua, FL 32653

David Forest
23 Turkey Creek
Alachua, FL 32615

Craig Parenteau
FL Dept. of Environmental Protection
4801 Camp Ranch Road
Gainesville, FL 32641

Lynda Coon
7216 NW 126 Avenue
Alachua, FL 32615

Bonnie Flynn
16801 NW 166th Drive
Alachua, FL 32615

Shasta Schoellhorn
15907 NW 188th St.
Alachua, FL 32615

03916-001-000
ROSARIO HECTOR & VERONICA
13116 NW COUNTY RD 235
ALACHUA, FL 32615

03919-000-000
HUNTER B R & CHRISTINE
14905 PEGGY RD
ALACHUA, FL 32615-5451

03866-000-000 & 03866-003-000
LUMPKIN O A JR & JOYCE
15716 PEGGY RD
ALACHUA, FL 32615-5455

03923-001-000
JACKSON ROBERT HEIRS
PO BOX 657
ALACHUA, FL 32616-0657

03905-002-000 & 03905-003-000
WACO PROPERTIES INC
569 EDGEWOOD AVE SOUTH
JACKSONVILLE, FL 32205

03918-000-000
CITIZENS & SOUTHERN NATIONAL BANK TR
13500 NW COUNTY RD 235
ALACHUA, FL 32615-6150

03917-200-001
HUNTER CHRISTINE A
14905 PEGGY RD
ALACHUA, FL 32615-5451

03870-000-000 & 03870-001-000
CITY OF ALACHUA
PO BOX 9
ALACHUA, FL 32616

03865-000-000 & 03924-000-000
03917-200-002
KIRKLAND W & MARGARET
PO BOX 1360
ALACHUA, FL 32616-1360

03923-000-000
GARRISON & ROBINSON
PO BOX 1084
ALACHUA, FL 32616-1084

03925-002-000
Sandvik Mining & Construction USA LLC
13500 NW COUNTY RD 235
ALACHUA, FL 32615

03866-001-000
MILLER MARTHA L LIFE ESTATE
15708 PEGGY RD
ALACHUA, FL 32615-5455

03865-200-000 & 03917-200-000
92060-517-900
CSX TRANSPORTATION INC
500 WATER ST TAX DEPT J-910
JACKSONVILLE, FL 32202-4423

03916-002-000
SMITH STEPHEN F & RENEE
503 SW 3RD ST
GAINESVILLE, FL 32601

03918-003-000
BLACK FLAG METALSMITH LLC
9744 NW 27TH PL
GAINESVILLE, FL 32606

AFFIDAVIT FOR POSTED LAND USE SIGN

I Melissa Watson, POSTED THE LAND USE
SIGN ON 6/23/22 FOR THE Peggy Rd Planned Development LSCPA/RZ
(Name) (Date) (State type of action and project name)
LAND USE ACTION.

AS PER ARTICLE 2.2.9 D OF THE LAND DEVELOPMENT REGULATIONS.

THIS WILL BE INCLUDED IN THE STAFF REPORT.

Melissa Watson
(Signature)

One (1)
(Number of signs)