

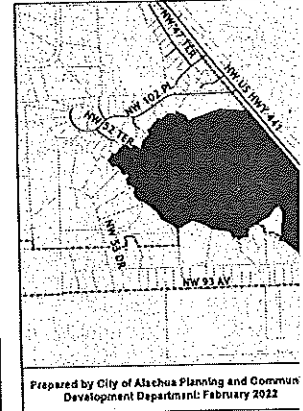

**NOTICE OF
HEARING BEI
PLANNING AN
BOARD OF TH
ALACHUA, I**

Notice is hereby given that the Board of the City of Alachua will hold a hearing on August 8, 2022 at 6:00 p.m. The hearing will be held in the A. Lewis Commission Chamber, 15100 NW 142nd Terrace, Alachua, Florida 32310. The following: A request by Dav Investments, LLC, property owner, to amend the Future Land Use Map to change the subject property from Agriculture Commercial (±39.95 acres) to Community Moderate Density Residential (±17.8 acres), and C-1 Residential (±17.8 acres), and C-2 Residential located west of the intersection of Highway 1, south of the Brooke Point Road, south of Tax Parcel Numbers 05936-007-002, 05936-007-001, 05936-007-003, 05936-007-004, 05936-007-005, 05936-007-006, 05936-007-007, 05936-007-008, 05936-007-009, 05936-007-010, 05936-007-011, 05936-007-012, 05936-007-013, 05936-007-014, 05936-007-015, 05936-007-016, 05936-007-017, 05936-007-018, 05936-007-019, 05936-007-020, 05936-007-021, 05936-007-022, 05936-007-023, 05936-007-024, 05936-007-025, 05936-007-026, 05936-007-027, 05936-007-028, 05936-007-029, 05936-007-030, 05936-007-031, 05936-007-032, 05936-007-033, 05936-007-034, 05936-007-035, 05936-007-036, 05936-007-037, 05936-007-038, 05936-007-039, 05936-007-040, 05936-007-041, 05936-007-042, 05936-007-043, 05936-007-044, 05936-007-045, 05936-007-046, 05936-007-047, 05936-007-048, 05936-007-049, 05936-007-050, 05936-007-051, 05936-007-052, 05936-007-053, 05936-007-054, 05936-007-055, 05936-007-056, 05936-007-057, 05936-007-058, 05936-007-059, 05936-007-060, 05936-007-061, 05936-007-062, 05936-007-063, 05936-007-064, 05936-007-065, 05936-007-066, 05936-007-067, 05936-007-068, 05936-007-069, 05936-007-070, 05936-007-071, 05936-007-072, 05936-007-073, 05936-007-074, 05936-007-075, 05936-007-076, 05936-007-077, 05936-007-078, 05936-007-079, 05936-007-080, 05936-007-081, 05936-007-082, 05936-007-083, 05936-007-084, 05936-007-085, 05936-007-086, 05936-007-087, 05936-007-088, 05936-007-089, 05936-007-090, 05936-007-091, 05936-007-092, 05936-007-093, 05936-007-094, 05936-007-095, 05936-007-096, 05936-007-097, 05936-007-098, 05936-007-099, 05936-007-100, 05936-007-101, 05936-007-102, 05936-007-103, 05936-007-104, 05936-007-105, 05936-007-106, 05936-007-107, 05936-007-108, 05936-007-109, 05936-007-110, 05936-007-111, 05936-007-112, 05936-007-113, 05936-007-114, 05936-007-115, 05936-007-116, 05936-007-117, 05936-007-118, 05936-007-119, 05936-007-120, 05936-007-121, 05936-007-122, 05936-007-123, 05936-007-124, 05936-007-125, 05936-007-126, 05936-007-127, 05936-007-128, 05936-007-129, 05936-007-130, 05936-007-131, 05936-007-132, 05936-007-133, 05936-007-134, 05936-007-135, 05936-007-136, 05936-007-137, 05936-007-138, 05936-007-139, 05936-007-140, 05936-007-141, 05936-007-142, 05936-007-143, 05936-007-144, 05936-007-145, 05936-007-146, 05936-007-147, 05936-007-148, 05936-007-149, 05936-007-150, 05936-007-151, 05936-007-152, 05936-007-153, 05936-007-154, 05936-007-155, 05936-007-156, 05936-007-157, 05936-007-158, 05936-007-159, 05936-007-160, 05936-007-161, 05936-007-162, 05936-007-163, 05936-007-164, 05936-007-165, 05936-007-166, 05936-007-167, 05936-007-168, 05936-007-169, 05936-007-170, 05936-007-171, 05936-007-172, 05936-007-173, 05936-007-174, 05936-007-175, 05936-007-176, 05936-007-177, 05936-007-178, 05936-007-179, 05936-007-180, 05936-007-181, 05936-007-182, 05936-007-183, 05936-007-184, 05936-007-185, 05936-007-186, 05936-007-187, 05936-007-188, 05936-007-189, 05936-007-190, 05936-007-191, 05936-007-192, 05936-007-193, 05936-007-194, 05936-007-195, 05936-007-196, 05936-007-197, 05936-007-198, 05936-007-199, 05936-007-200, 05936-007-201, 05936-007-202, 05936-007-203, 05936-007-204, 05936-007-205, 05936-007-206, 05936-007-207, 05936-007-208, 05936-007-209, 05936-007-210, 05936-007-211, 05936-007-212, 05936-007-213, 05936-007-214, 05936-007-215, 05936-007-216, 05936-007-217, 05936-007-218, 05936-007-219, 05936-007-220, 05936-007-221, 05936-007-222, 05936-007-223, 05936-007-224, 05936-007-225, 05936-007-226, 05936-007-227, 05936-007-228, 05936-007-229, 05936-007-230, 05936-007-231, 05936-007-232, 05936-007-233, 05936-007-234, 05936-007-235, 05936-007-236, 05936-007-237, 05936-007-238, 05936-007-239, 05936-007-240, 05936-007-241, 05936-007-242, 05936-007-243, 05936-007-244, 05936-007-245, 05936-007-246, 05936-007-247, 05936-007-248, 05936-007-249, 05936-007-250, 05936-007-251, 05936-007-252, 05936-007-253, 05936-007-254, 05936-007-255, 05936-007-256, 05936-007-257, 05936-007-258, 05936-007-259, 05936-007-260, 05936-007-261, 05936-007-2



At the public hearing, all int and be heard with respect to the application are available : Planning and Community 15100 NW 142nd Terrace, regular business day between 1 p.m. Written comments on t to the following address: City Community Development, P.O Notice is given pursuant to Statutes, that, in order to app public hearing, you will need and that, for such purpose, ye verbatim record of the proceed the testimony and evidence up based. In accordance with the Act, any persons with a dis accommodation in order to should call the City Clerk at (48 hours prior to the public he

NOTICE OF PUBLIC HEARING BEFORE THE PLANNING AND ZONING BOARD OF THE CITY OF ALACHUA, FLORIDA

Notice is hereby given that the Planning & Zoning Board of the City of Alachua will hold a public hearing on March 8, 2022 at 6:00 p.m. The hearing will be held in the James A. Lewis Commission Chambers in City Hall, located at 15100 NW 142nd Terrace, Alachua, Florida, to consider the following:

A request by Clay Sweger, AICP, LEED AP, of eda,inc., applicant and agent for JTFA, LLC and Kevin and Shima Carter, property owners, for consideration of a Site-Specific Amendment to the Official Zoning Atlas (Rezoning) on a ± 162.5 acre subject property from Agricultural (A) and Agricultural (Alachua County) to Planned Development- Residential (PD-R) (± 155.5 acres) and Community Commercial (CC) (± 7 acres); located south of US 441 and east of NW 188th Street; Tax Parcel Numbers 03046-003-001, 03046-003-002, 03046-003-003, 03046-003-004, 03046-003-005, 03042-050-004, 03042-050-005, 03875-001-001, 03875-010-001, 03875-010-002, and a portion of 03046-003-000. Existing FLUM: Agriculture. Proposed FLUM: Low Density Residential, Moderate Density Residential, and Community Commercial. Existing Zoning: Agricultural (A).

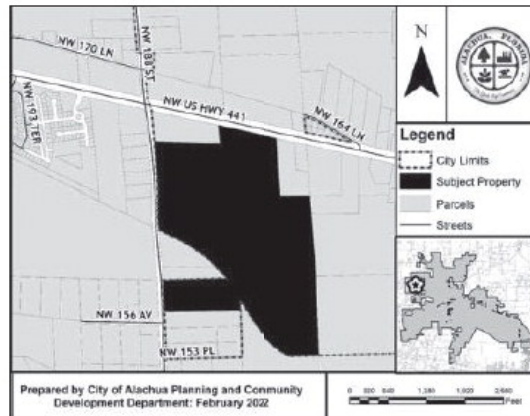

At the public hearing, all interested parties may appear and be heard with respect to the application. Copies of the application are available for public inspection at the Planning and Community Development Department, 15100 NW 142nd Terrace, Alachua, Florida, on any regular business day between the hours of 7:30 a.m. to 6:00 p.m. Written comments on the application may be sent to the following address: City of Alachua, Planning and Community Development, P.O. Box 9, Alachua, FL 32616. Notice is given pursuant to Section 286.0105, Florida Statutes, that, in order to appeal any decision made at the public hearing, you will need a record of the proceedings, and that, for such purpose, you may need to ensure that a verbatim record of the proceedings is made, which includes the testimony and evidence upon which the appeal is to be based. In accordance with the Americans with Disabilities Act, any persons with a disability requiring reasonable accommodation in order to participate in this meeting should call the City Clerk at (386) 418-6100 x 101 at least 48 hours prior to the public hearing.

GF-2860900



City of
ALACHUA
THE GOOD LIFE COMMUNITY

Mailed 2/17/22
(RC)

NOTICE OF PUBLIC HEARING BEFORE THE PLANNING AND ZONING BOARD OF THE CITY OF ALACHUA, FLORIDA

Notice is hereby given that the Planning & Zoning Board of the City of Alachua will hold a public hearing on March 8, 2022 at 6:00 p.m. The hearing will be held in the James A. Lewis Commission Chambers in City Hall, located at 15100 NW 142nd Terrace, Alachua, Florida, to consider the following: A request by Clay Sweger, AICP, LEED AP, of eda,inc., applicant and agent for JTFA, LLC and Kevin and Shima Carter, property owners, for consideration of a Site-Specific Amendment to the Official Zoning Atlas (Rezoning) on a ± 162.5 acre subject property from Agricultural (A) and Agricultural (Alachua County) to Planned Development- Residential (PD-R) (± 155.5 acres) and Community Commercial (CC) (± 7 acres); located south of US 441 and east of NW 188th Street; Tax Parcel Numbers 03046-003-001, 03046-003-002, 03046-003-003, 03046-003-004, 03046-003-005, 03042-050-004, 03042-050-005, 03875-001-001, 03875-010-001, 03875-010-002, and a portion of 03046-003-000 . Existing FLUM: Agriculture. Proposed FLUM: Low Density Residential, Moderate Density Residential, and Community Commercial. Existing Zoning: Agricultural (A).

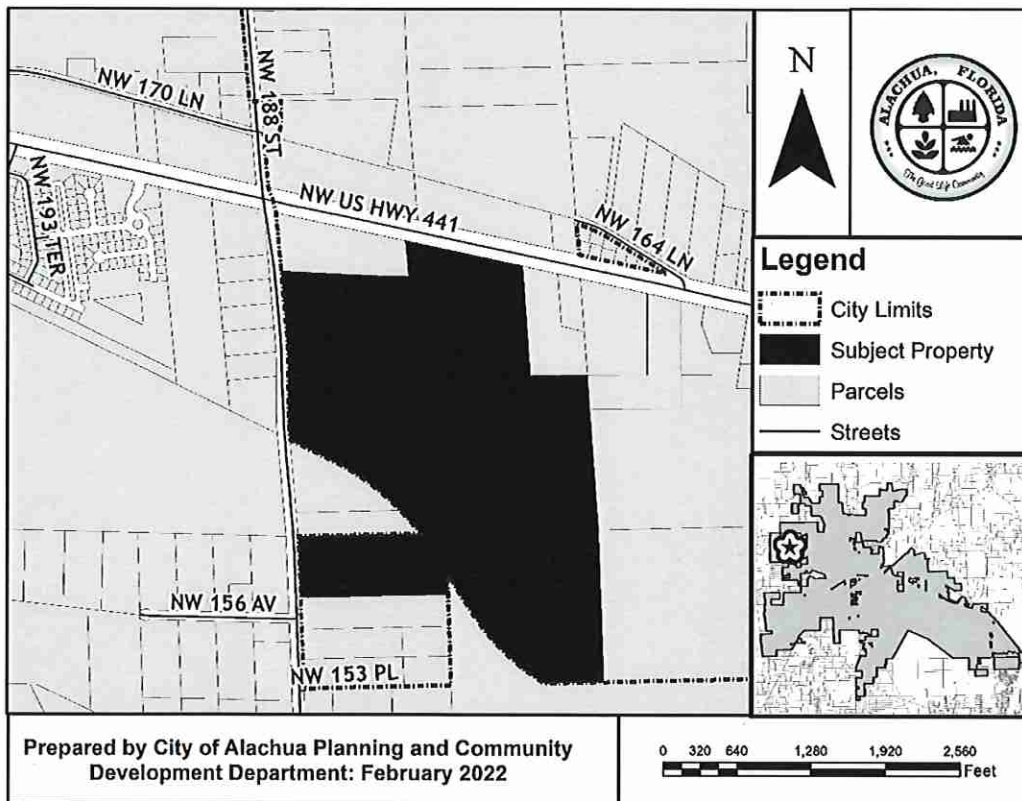

At the public hearing, all interested parties may appear and be heard with respect to the application. Copies of the application are available for public inspection at the Planning and Community Development Department, 15100 NW 142nd Terrace, Alachua, Florida, on any regular business day between the hours of 7:30 a.m. to 6:00 p.m. Written comments on the application may be sent to the following address: City of Alachua, Planning and Community Development, P.O. Box 9, Alachua, FL 32616. Notice is given pursuant to Section 286.0105, Florida Statutes, that, in order to appeal any decision made at the public hearing, you will need a record of the proceedings, and that, for such purpose, you may need to ensure that a verbatim record of the proceedings is made, which includes the testimony and evidence upon which the appeal is to be based. In accordance with the Americans with Disabilities Act, any persons with a disability requiring reasonable accommodation in order to participate in this meeting should call the City Clerk at (386) 418-6100 x 101 at least 48 hours prior to the public hearing.

P.O. Box 9 ♦ Alachua, Florida 32616-0009
Phone: (386) 418-6121 ♦ Fax: (386) 418-6130

03046-003-003
CARTER KEVIN L & SHIMA
7853 GUNN HIGHWAY
TAMPA, FL 33626

03046-003-004
CARTER KEVIN L & SHIMA
7853 GUNN HIGHWAY
TAMPA, FL 33626

03046-003-005
CARTER KEVIN L & SHIMA
7853 GUNN HIGHWAY
TAMPA, FL 33626

03035-001-000
CAIN J GERALD TRUSTEE
790 MILLSHORE DR
CHULUOTA, FL 32766

030875-010-003
JOHNS JONATHAN MARK & CHRISTINA RAE
PO BOX 225
ALACHUA, FL 32616

03046-000-000
PARKER ERIC J & JOY A
PO BOX 357133
GAINESVILLE, FL 32635

03042-050-000
SMYDER CHARLES & REGINA
PO BOX 842
ALACHUA, FL 32616-0842

03042-050-001
SMYDER CHARLES R
PO BOX 842
ALACHUA, FL 32616-0842

030875-000-000
SMYDER CHARLES & REGINA
PO BOX 842
ALACHUA, FL 32616-0842

03038-003-000
IMPACT FAMILY CHURCH INC
PO BOX 903
HIGH SPRINGS, FL 32655-0903

*124th Sharon D Trustee
1880S NW 156th Ave
Alachua, FL 32615*

03042-050-003
FIRST COAST ROAD RANGERS LLC
11461 BOOTE BLVD
JACKSONVILLE, FL 32218-4223

03876-100-000
ALACHUA COUNTY
12 SE 1ST ST
GAINESVILLE, FL 32601

03875-001-002
JOHNS JONATHAN M & CHRISTINA R
15601 NW 188TH ST
ALACHUA, FL 32615

03038-008-000
PAPPAS & STEVENS TRUSTEES
16104 NW 188TH ST
ALACHUA, FL 32615

03038-002-000
KALAF JOHN W JR
16502 NW 188TH ST
ALACHUA, FL 32615

03877-011-000
FORTSON & HERRIN
18529 NW 153RD PL
ALACHUA, FL 32615-5274

03038-001-000
LANG VICTORIA S TRUSTEE
242 SE ST JOHNS ST
LAKE CITY, FL 32025

03875-001-001
JTFA LLC
4881 NW 8TH AVE STE 4
GAINESVILLE, FL 32605

03875-010-004
PASCHAL GARY SCOTT
5200 NW 43RD ST STE 102-335
GAINESVILLE, FL 32606

03046-003-000
CARTER KEVIN L & SHIMA
7853 GUNN HIGHWAY
TAMPA, FL 33626

03033-000-000
WHITE I L & JOAN
115 COUNTRY CLUB RD
ARDMORE, OK 73401

03875-010-005
SHEPHERD BENJAMIN & CASSANDRA
15407 NW188TH ST
GAINESVILLE, FL 32615

03046-002-000
LATNER WILLIAM RAY & WENDY DAY
15815 NW 188TH ST
ALACHUA, FL 32615

03038-006-000
PFAU PAUL H & MAEGHAN K
16212 NW 188TH ST
ALACHUA, FL 32615-5239

03042-050-010
JACK'S SMALL ENGINE REPAIR LLC
16530 NW US HIGHWAY 441
ALACHUA, FL 32615

03878-001-001
LAWRENCE KRISTINE C
18818 NW 156TH AVE
ALACHUA, FL 32615-8052

03042-050-005
JTFA LLC
4881 NW 8TH AVE STE 4
GAINESVILLE, FL 32605

03875-010-001
JTFA LLC
4881 NW 8TH AVE STE 4
GAINESVILLE, FL 32605

03046-005-000
JEFFORDS LILLIE BELLE TRUSTEE
608 PARHAM RD NW
MILLEDGEVILLE, GA 31061

03046-003-001
CARTER KEVIN L & SHIMA
7853 GUNN HIGHWAY
TAMPA, FL 33626

03046-004-000
NORTH FLA WATER SYSTEM INC
11814 NW 202ND ST
ALACHUA, FL 32615-5924

03875-001-000
SHEPHERD BENJAMIN & CASSANDRA
15407 NW188TH ST
GAINESVILLE, FL 32615

03046-001-000
SCHOELLHORN SHASTA
15907 NW 188TH ST
ALACHUA, FL 32615

03038-004-000
LANG S F & JO ANN
16320 NW 188TH ST
ALACHUA, FL 32615-5240

03877-012-000
LAFRANCE ALICIA M
18525 NW 153RD PL
ALACHUA, FL 32615

03038-005-000
DORNBLASER & DORNBLASER TRUST
2415 NW TIMBERCREEK CIR
BOCA RATON, FL 33431-4059

03042-051-001
AYLA LLC
4881 NW 8TH AVE STE 4
GAINESVILLE, FL 32605

03875-010-002
JTFA LLC
4881 NW 8TH AVE STE 4
GAINESVILLE, FL 32605

03042-050-004
CARTER KEVIN L & SHIMA
7853 GUNN HIGHWAY
TAMPA, FL 33626

03046-003-002
CARTER KEVIN L & SHIMA
7853 GUNN HIGHWAY
TAMPA, FL 33626

Antoinette Endelicato
5562 NW 93rd Avenue
Gainesville, FL 32653

Dan Rhine
288 Turkey Creek
Alachua, FL 32615

Tom Gorman
9210 NW 59th Street
Alachua, FL 32653

Richard Gorman
5716 NW 93rd Avenue
Alachua, FL 32653

Peggy Arnold
410 Turkey Creek
Alachua, FL 32615

David Forest
23 Turkey Creek
Alachua, FL 32615

President of TCMOA
1000 Turkey Creek
Alachua, FL 32615

Linda Dixon, AICP
Assistant Director of Planning
PO Box 115050
Gainesville, FL 32611

Craig Parenteau
FL Dept. of Environmental Protection
4801 Camp Ranch Road
Gainesville, FL 32641

Jeannette Hinsdale
P.O. Box 1156
Alachua, FL 32616

Lynn Coullias
7406 NW 126th Ave
Alachua, FL 32615

Lynda Coon
7216 NW 126 Avenue
Alachua, FL 32615

Tamara Robbins
PO Box 2317
Alachua, FL 32616

Michele L. Lieberman
County Manager
12 SE 1st Street
Gainesville, FL 32601

Bonnie Flynn
16801 NW 166th Drive
Alachua, FL 32615

Hugh & Jean Calderwood
P.O. Box 2307
Alachua, FL 32616

Lisia Jenkins
P.O. Box 1071
Alachua, FL 32616

Shirley Schoellham
15907 NW 188th St
Alachua, FL 32615

Carrie Lake
16611 NW 138th Ave
Alachua, FL 32615

Dena Courtney
PO Box 1215
High Springs, FL 32655

AFFIDAVIT FOR POSTED LAND USE SIGN

I Debbie Wallen, POSTED THE LAND USE
SIGN ON 2/17/22 FOR THE NW 188th Street LSCPA/Rezoning - PZB & CCOM1
(name) (date) (state type of action and project name)
LAND USE ACTION.

AS PER ARTICLE 2.2.9 D OF THE LAND DEVELOPMENT REGULATIONS.

THIS WILL BE INCLUDED IN THE STAFF REPORT.

Debbie Wallen
(signature)

8 (eight)
(number of signs)