

Alachua County Schools will begin its annual Round-Up in elementary schools and kindergarten will be opening the afternoon of Friday, April 27 to kindergarten families. Children and guardians have a chance to talk with staff, tour the school and learn more about the school. Parents in Alachua, Hawthorne, High

will begin their school documents, including a birth certificate, proof of a physical exam performed sometime within the last year, immunization records and two items in the parents' name to show proof of residence.

The first day for students in the 2022-23 school year will be Wednesday, Aug. 10. Under Florida law, children must be five years old on or before Sept. 1 to enroll in kindergarten. Parents can begin the online registration

zoned school several documents, including a birth certificate, proof of a physical exam performed sometime within the last year, immunization records and two items in the parents' name to show proof of residence.

Examples of a proof of residence include a lease agreement, a property tax statement, a utility bill or other documents. Parents may bring those documents to the Round-Up if they wish, but it is not required. More information,



City of ALACHUA

PUBLIC NOTICE OF ENACTMENT OF AN ORDINANCE OF THE CITY OF ALACHUA, FLORIDA

Notice is hereby given that the City Commission of the City of Alachua will hold a public hearing on a proposed ordinance. The hearing will be held on April 25, 2022 at 6:00 p.m., in the James A. Lewis Commission Chambers in City Hall, located at 15100 NW 142nd Terrace, Alachua, Florida.

The ordinance title is as follows:

ORDINANCE 22-07

AN ORDINANCE OF THE CITY OF ALACHUA, FLORIDA, RELATING TO THE AMENDMENT OF THE OFFICIAL ZONING ATLAS; AMENDING THE OFFICIAL ZONING ATLAS FROM AGRICULTURAL ("A") (ALACHUA COUNTY) AND AGRICULTURAL ("A") TO PLANNED DEVELOPMENT - RESIDENTIAL ("PD-R") (±155.50 ACRES) AND COMMUNITY COMMERCIAL ("CC") (±7.00 ACRES) ON APPROXIMATELY ± 162.5 ACRES; LOCATED SOUTHEAST OF THE INTERSECTION OF US HIGHWAY 441 AND NW 188TH STREET; CONSISTING OF TAX PARCEL NUMBERS 03046-003-001, 03046-003-002, 03046-003-003, 03046-003-004, 03046-002-005, 03042-050-004, 03042-050-005, 03875-001-001, 03875-010-001, 03875-010-002, AND A PORTION OF 03046-003-000; REPEALING ALL ORDINANCES IN CONFLICT; PROVIDING SEVERABILITY; AND PROVIDING AN EFFECTIVE DATE.

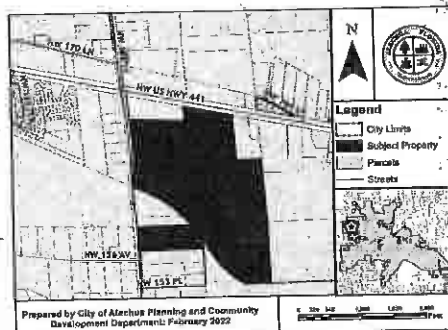

At the public hearing, all interested parties may appear and be heard with respect to the application. Copies of the application are available for public inspection at the Planning and Community Development Department, 15100 NW 142nd Terrace, Alachua, Florida, on any regular business day between the hours of 7:30 a.m. to 6:00 p.m. Written comments on the application may be sent to the following address: City of Alachua, Planning and Community Development, P.O. Box 9, Alachua, FL 32616. Notice is given pursuant to Section 286.0105, Florida Statutes, that, in order to appeal any decision made at the public hearing, you will need a record of the proceedings, and that, for such purpose, you may need to ensure that a verbatim record of the proceedings is made, which includes the testimony and evidence upon which the appeal is to be based. In accordance with the Americans with Disabilities Act, any persons with a disability requiring reasonable accommodation in order to participate in this meeting should call the City Clerk at (386) 418-6100 x 1501 at least 48 hours prior to the public hearing.

(Published: Alachua County Today - April 14, 2022)

MISSION:
d from page A1

Alachua Great American Cleanup May 14

Completed, these
being returned to
Builders, Inc.

cleanup time
Alachua as the
Commission has
ed Saturday, May
e Great American
Day. The Great

in Cleanup is
country's largest
improvement
in more than
communities each

The program is
d to end littering,
recycling and
the community.
ar, volunteers will
at 8:30 a.m. at City
kick off the project.
volunteer will be
d with trash bags,
vests, gloves, maps
instructions for the

This Saturday's
ication activities
cleaning up Main
planting trees on
Road to strengthen
community's green
ature, cleaning up
all Park and Hipp
ad the Swick House.

Alachua's Legacy
Summer Program,
runs from June
July 30, is actively
ng youth from
to 15. To fund the
am, the Commission
ed amending the
Year 2021-22
t for acceptance of
cipated revenue from
children's Trust Grant
al Revenue Fund
children's programs.

The Children's Trust of Alachua County (CTAC) will provide \$66,665 for summer programs at Legacy Park. Additional funding of \$20,000 is projected to be received from non-CTAC funded enrollment fees for a total of \$86,665 to be added to the budget.

In other business, students from the Bhaktivedanta Academy have their artwork featured on display in City Hall as part of the Art in City Hall program. Mayor Gib Coerper and the school's Leela Sikdar presented certificates to the 20 students participating in the art display. After the certificates were presented, the entire City Commission gathered with the students for a group photograph.

The Florida League of Cities recently recognized Coerper with a 2022 Home Rule Hero Award. Home Rule is the ability for a city to address local problems with local solutions with minimal state interference. The Home Rule Hero Award recognizes the efforts of individuals, both elected and non-elected who reach out to members of the legislature to give a local perspective on issues.

"I am greatly humbled to be selected for this honor," Coerper said. "I've always felt the government closest to its community should be the one making decisions based on the best interests of that community."

The Commission has proclaimed the week of April 10 - 16 as "National Public Safety Telecommunications Week" in Alachua. Each year, the second week in the month of April is dedicated to the men and women who serve as public safety telecommunications. The City of Alachua Police Department telecommunications section is staffed by seven full-time employees, including a communications supervisor and six communications operators. As the public's first line of contact with the department, they are responsible for handling all incoming emergency calls for service to the department, including 911 transfers from the Alachua County Sheriff's Office; dispatching and monitoring of radio traffic for all officers responding to calls for service, as well as walk-ins at the station.

In other police related news, the Alachua Police Department is partnering with the Alachua County Child Abuse Prevention Taskforce to bring child abuse awareness to Alachua. The National Child Abuse Prevention month campaign, which occurs in April, is an initiative to protect Florida's children from physical and mental abuse.

email rcarrson@
alachuatoday.com

Outreach

Continued from Page 3A

DeCarmine told city commissioners last Thursday that the nonprofit needs more city funding for its outreach program due to a \$38,000 federal grant that helped fund the launch of the program begins to dry up. The money allowed Grace to hire seven outreach workers and a part-time psychiatrist.

DeCarmine said the outreach program has so far exceeded expectations. During its first seven months, it resulted in housing 88 people and reduced downtown homelessness by about 25%, he said.

While acknowledging that the program appears to be working, City Commissioner Adrian Hayes-Santos expressed concerns about additional recurring costs the city has taken on lately, which should be more broadly discussed as officials enter budget negotiations.

“I do think it’s a great program,” Hayes-Santos said. “I support it.”

Aside from city funding, Grace, which will celebrate its eighth anniversary next month, also gets funding from state and federal sources and private contributions. The city’s \$1.5 million contributions to Grace three years ago made up 70% of the shelter’s budget. This year’s funding accounts for only 34%.

“What you’ve done is planted a seed that we have been able to successfully leverage to bring in millions of other dollars in support at the state, federal and private level,” DeCarmine told commissioners last week.

Mayor Lauren Poe said Tuesday that the outreach program is a good investment and wants to see it succeed.

“They are folks with the most chronic homeless issues, with significant mental health challenges,” he said.

County contributions

Several commissioners on Thursday also criticized the county for gradually withdrawing its funding from the Grace shelter program.

At one point, the city and county were splitting the bill until the county has cut back \$250,000 of its contribution each year.



Jerry Giardina, right, an outreach specialist with the homeless shelter Grace Marketplace, talks with Steven Boyt, center, a homeless individual, to get some information so that the shelter can help provide whatever Boyt needs in assistance, off South Main Street in Gainesville on March 4, 2021. BRAD MCLENNY/THE GAINESVILLE SUN

“I’m not going to suggest that we have another conversation with the county because I got really tired of having those conversations a couple of years ago,” City Commissioner Harvey Ward said. “They inevitably ended up being a game of chicken and we lost every time because we are going to fund it. We are always going to do the right thing.”

DeCarmine said in an interview on Tuesday that even though the county has done away with funding the emergency shelter, it does contribute about \$22,000 a year to Grace for case management services. The county also helps house some of Grace’s clients, he added, which is appreciated.

“Many of the people that we have been able to get off the street have

moved into (the county’s) permanent supportive housing program,” DeCarmine said.

Alachua County spokesman Mark Sexton pointed out that the \$201,000 the city spent to get the outreach program going came from Gainesville Community Reinvestment Area funding, which the county puts a majority into. Of the \$70 million to be collected over a 10-year span, the county will have contributed approximately \$40 million.

Claudia Tuck, director of Alachua County Community Support Services, said the county has purchased the former Budget Inn building, located at 4401 Southwest 13th Street, which will be used for 36 units for the homeless.

“We are in the final stages of processing that grant,” she said.

The county has been investing \$1.5 million a year for permanent housing in place of its direct shelter contribution to Grace.

Susan Moore, the homeless services manager for Alachua County Social Services, said some of their clients for permanent housing have been referred by Grace Marketplace’s outreach program.

“It is a collaborative effort that we have,” she said. “In the beginning, a majority of our clients came from (Grace) Dignity Village.”

She said the county recently has been able to house a man in his 70s who has been homeless for decades with severe mental health issues.

“When he was in the streets, people had the opportunity to take advantage of him,” she said.

PUBLIC NOTICE OF ENACTMENT OF AN ORDINANCE OF THE CITY OF ALACHUA, FLORIDA

Notice is hereby given that the City Commission of the City of Alachua will hold a public hearing on a proposed ordinance. The hearing will be held on April 25, 2022 at 6:00 p.m., in the James A. Lewis Commission Chambers in City Hall, located at 15100 NW 142nd Terrace, Alachua, Florida.

The ordinance title is as follows:

ORDINANCE 22-06

AN ORDINANCE OF THE CITY OF ALACHUA, FLORIDA, RELATING TO THE LARGE SCALE AMENDMENT OF THE CITY OF ALACHUA COMPREHENSIVE PLAN FUTURE LAND USE MAP; AMENDING THE FUTURE LAND USE MAP CLASSIFICATION ON ±162.5 ACRES FROM AGRICULTURE TO COMMUNITY COMMERCIAL (±7.00 ACRES), LOW DENSITY RESIDENTIAL (±115.5 ACRES), AND MODERATE DENSITY RESIDENTIAL (±40.0 ACRES) ON A PARCEL OF LAND GENERALLY LOCATED SOUTHEAST OF THE INTERSECTION OF US HIGHWAY 441 AND NW 188TH STREET; CONSISTING OF TAX PARCEL NUMBERS 03046-003-001, 03046-003-002, 03046-003-003, 03046-003-004, 03046-002-005, 03042-050-004, 03042-050-005, 03875-001-001, 03875-010-001, 03875-010-002, AND A PORTION OF 03046-003-000; REPEALING ALL ORDINANCES IN CONFLICT; PROVIDING SEVERABILITY; AND PROVIDING AN EFFECTIVE DATE.

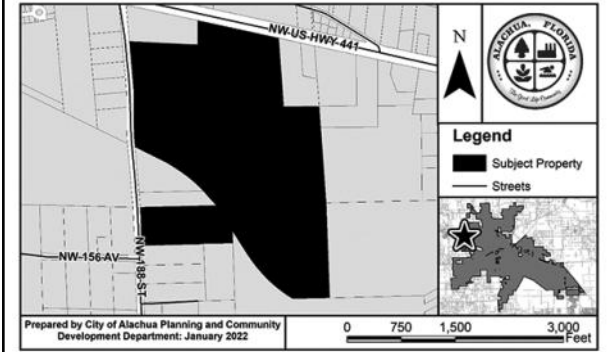

At the public hearing, all interested parties may appear and be heard with respect to the application. Copies of the application are available for public inspection at the Planning and Community Development Department, 15100 NW 142nd Terrace, Alachua, Florida, on any regular business day between the hours of 7:30 a.m. to 6:00 p.m. Written comments on the application may be sent to the following address: City of Alachua, Planning and Community Development, P.O. Box 9, Alachua, FL 32616. Notice is given pursuant to Section 286.0105, Florida Statutes, that, in order to appeal any decision made at the public hearing, you will need a record of the proceedings, and that, for such purpose, you may need to ensure that a verbatim record of the proceedings is made, which includes the testimony and evidence upon which the appeal is to be based. In accordance with the Americans with Disabilities Act, any persons with a disability requiring reasonable accommodation in order to participate in this meeting should call the City Clerk at (386) 418-6100 x 1501 at least 48 hours prior to the public hearing.

GF-29715753

PUBLIC NOTICE OF ENACTMENT OF AN ORDINANCE OF THE CITY OF ALACHUA, FLORIDA

Notice is hereby given that the City Commission of the City of Alachua will hold a public hearing on a proposed ordinance. The hearing will be held on April 25, 2022 at 6:00 p.m., in the James A. Lewis Commission Chambers in City Hall, located at 15100 NW 142nd Terrace, Alachua, Florida.

The ordinance title is as follows:

ORDINANCE 22-07

AN ORDINANCE OF THE CITY OF ALACHUA, FLORIDA, RELATING TO THE AMENDMENT OF THE OFFICIAL ZONING ATLAS; AMENDING THE OFFICIAL ZONING ATLAS FROM AGRICULTURAL (“A”)(ALACHUA COUNTY) AND AGRICULTURAL (“A”) TO PLANNED DEVELOPMENT – RESIDENTIAL (“PD-R”) (±155.50 ACRES) AND COMMUNITY COMMERCIAL (“CC”)(±7.00 ACRES) ON APPROXIMATELY ± 162.5 ACRES; LOCATED SOUTHEAST OF THE INTERSECTION OF US HIGHWAY 441 AND NW 188TH STREET; CONSISTING OF TAX PARCEL NUMBERS 03046-003-001, 03046-003-002, 03046-003-003, 03046-003-004, 03046-002-005, 03042-050-004, 03042-050-005, 03875-001-001, 03875-010-001, 03875-010-002, AND A PORTION OF 03046-003-000; REPEALING ALL ORDINANCES IN CONFLICT; PROVIDING SEVERABILITY; AND PROVIDING AN EFFECTIVE DATE.

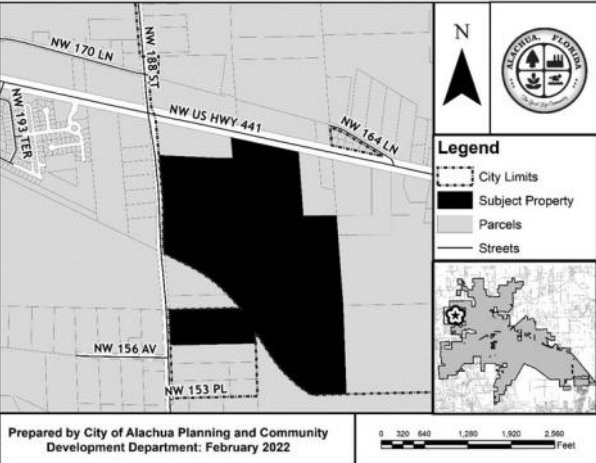

At the public hearing, all interested parties may appear and be heard with respect to the application. Copies of the application are available for public inspection at the Planning and Community Development Department, 15100 NW 142nd Terrace, Alachua, Florida, on any regular business day between the hours of 7:30 a.m. to 6:00 p.m. Written comments on the application may be sent to the following address: City of Alachua, Planning and Community Development, P.O. Box 9, Alachua, FL 32616. Notice is given pursuant to Section 286.0105, Florida Statutes, that, in order to appeal any decision made at the public hearing, you will need a record of the proceedings, and that, for such purpose, you may need to ensure that a verbatim record of the proceedings is made, which includes the testimony and evidence upon which the appeal is to be based. In accordance with the Americans with Disabilities Act, any persons with a disability requiring reasonable accommodation in order to participate in this meeting should call the City Clerk at (386) 418-6100 x 1501 at least 48 hours prior to the public hearing.

GF-29715936

PUBLIC NOTICE OF ENACTMENT OF AN ORDINANCE OF THE CITY OF ALACHUA, FLORIDA

Notice is hereby given that the City Commission of the City of Alachua will hold a public hearing on a proposed ordinance. The hearing will be held on April 25, 2022 at 6:00 p.m., in the James A. Lewis Commission Chambers in City Hall, located at 15100 NW 142nd Terrace, Alachua, Florida.

The ordinance title is as follows:

ORDINANCE 22-10

AN ORDINANCE OF THE CITY OF ALACHUA, FLORIDA, RELATING TO THE AMENDMENT OF THE OFFICIAL ZONING ATLAS; AMENDING THE OFFICIAL ZONING ATLAS FROM AGRICULTURAL (“A”) TO PLANNED DEVELOPMENT – RESIDENTIAL (“PD-R”) ON APPROXIMATELY 118 ACRES; LOCATED SOUTH OF THE PILOT FOREST SUBDIVISION AND EAST OF CR 235; TAX PARCEL NUMBER 03980-002-001; REPEALING ALL ORDINANCES IN CONFLICT; PROVIDING SEVERABILITY; AND PROVIDING AN EFFECTIVE DATE.

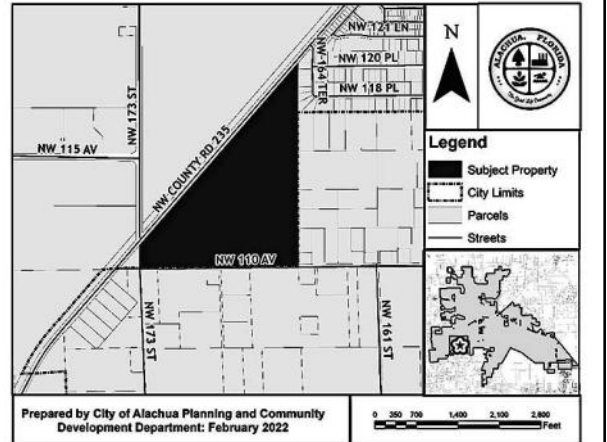

At the public hearing, all interested parties may appear and be heard with respect to the application. Copies of the application are available for public inspection at the Planning and Community Development Department, 15100 NW 142nd Terrace, Alachua, Florida, on any regular business day between the hours of 7:30 a.m. to 6:00 p.m. Written comments on the application may be sent to the following address: City of Alachua, Planning and Community Development, P.O. Box 9, Alachua, FL 32616. Notice is given pursuant to Section 286.0105, Florida Statutes, that, in order to appeal any decision made at the public hearing, you will need a record of the proceedings, and that, for such purpose, you may need to ensure that a verbatim record of the proceedings is made, which includes the testimony and evidence upon which the appeal is to be based. In accordance with the Americans with Disabilities Act, any persons with a disability requiring reasonable accommodation in order to participate in this meeting should call the City Clerk at (386) 418-6100 x 1501 at least 48 hours prior to the public hearing.

GF-29716010

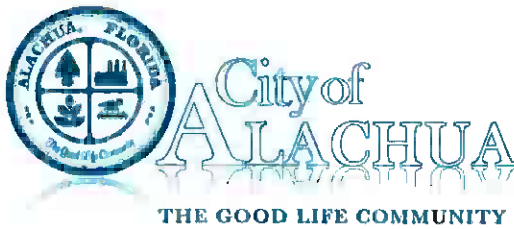

Marked 4/11/22
(KC)

PUBLIC NOTICE OF ENACTMENT OF AN ORDINANCE OF THE CITY OF ALACHUA, FLORIDA

Notice is hereby given that the City Commission of the City of Alachua will hold a public hearing on a proposed ordinance. The hearing will be held on April 25, 2022 at 6:00 p.m., in the James A. Lewis Commission Chambers in City Hall, located at 15100 NW 142nd Terrace, Alachua, Florida.

The ordinance title is as follows:

ORDINANCE 22-07

AN ORDINANCE OF THE CITY OF ALACHUA, FLORIDA, RELATING TO THE AMENDMENT OF THE OFFICIAL ZONING ATLAS; AMENDING THE OFFICIAL ZONING ATLAS FROM AGRICULTURAL ("A") (ALACHUA COUNTY) AND AGRICULTURAL ("A") TO PLANNED DEVELOPMENT - RESIDENTIAL ("PD-R") (±155.50 ACRES) AND COMMUNITY COMMERCIAL ("CC") (±7.00 ACRES) ON APPROXIMATELY ± 162.5 ACRES; LOCATED SOUTHEAST OF THE INTERSECTION OF US HIGHWAY 441 AND NW 188TH STREET; CONSISTING OF TAX PARCEL NUMBERS 03046-003-001, 03046-003-002, 03046-003-003, 03046-003-004, 03046-002-005, 03042-050-004, 03042-050-005, 03875-001-001, 03875-010-001, 03875-010-002, AND A PORTION OF 03046-003-000; REPEALING ALL ORDINANCES IN CONFLICT; PROVIDING SEVERABILITY; AND PROVIDING AN EFFECTIVE DATE.

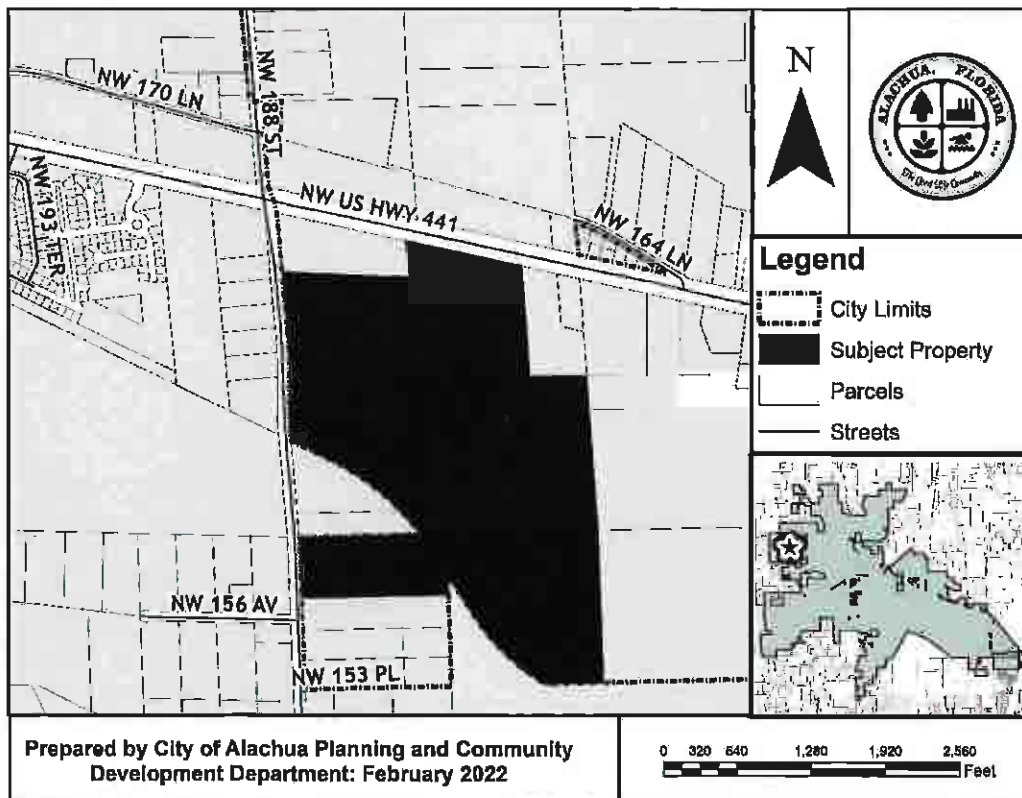

At the public hearing, all interested parties may appear and be heard with respect to the application. Copies of the application are available for public inspection at the Planning and Community Development Department, 15100 NW 142nd Terrace, Alachua, Florida, on any regular business day between the hours of 7:30 a.m. to 6:00 p.m. Written comments on the application may be sent to the

P.O. Box 9 ♦ Alachua, Florida 32616-0009
Phone: (386) 418-6121 ♦ Fax: (386) 418-6130

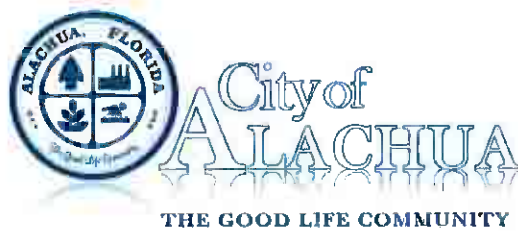

following address: City of Alachua, Planning and Community Development, P.O. Box 9, Alachua, FL 32616. Notice is given pursuant to Section 286.0105, Florida Statutes, that, in order to appeal any decision made at the public hearing, you will need a record of the proceedings, and that, for such purpose, you may need to ensure that a verbatim record of the proceedings is made, which includes the testimony and evidence upon which the appeal is to be based. In accordance with the Americans with Disabilities Act, any persons with a disability requiring reasonable accommodation in order to participate in this meeting should call the City Clerk at (386) 418-6100 x 101 at least 48 hours prior to the public hearing.

03980-002-000

BAUGH SOUTHEAST COOPERATIVE INC
SYSCO CORPORATION
ATTN TAX DEPARTMENT 1390 ENCLAVE
HOUSTON, TX 77077

03980-003-002

CAICEDO EDGAR H & FRANCES
12012 NW 164TH TER
ALACHUA, FL 32615

03980-003-005

KEDEM CECIL KAY
11920 NW 164TH TER
ALACHUA, FL 32615

03980-003-008

FREDERICK JULIE
11902 NW 164TH TER
ALACHUA, FL 32615

03980-003-052

BOYETTE BETTY L LIFE ESTATE
16326 NW 118TH PL
ALACHUA, FL 32615

03980-010-022

STEWART WILLIAM O & JOSIE P
16324 NW 120TH PL
ALACHUA, FL 32615

03981-004-006

STREIT WOLFGANG J
16414 NW 110TH AVE
ALACHUA, FL 32615

03981-005-002

HARRELL VAUGHN R
11218 NW 161ST ST
ALACHUA, FL 32615

03981-008-000

WEAVER WILLIAM R & BEVERLY GAIL
8461 SW 129TH TERRACE RD
DUNNELLON, FL 34432

03997-005-000

PADGETT CAROLYN S
10714 NW 173RD ST
ALACHUA, FL 32615

03980-002-001

WACO OF ALABAMA INC
PO BOX 6937
JACKSONVILLE, FL 32236

03980-003-003

WAITHE SEAN L & ASHLEY M
12004 NW 164TH TER
ALACHUA, FL 32615

03980-003-006

PARRIS R SCOTT & LYLIA A
11914 NW 164TH TER
ALACHUA, FL 32615

03980-003-009

GRISHAM & VERMILLION
16337 NW 118TH PL
ALACHUA, FL 32615

03980-003-053

WIGGLESWORTH ERNEST BARTOW JR
11923 NW 164TH TER
ALACHUA, FL 32615

03980-020-000

SAVANNAH STATION
4510 NW 6TH PLACE 3RD FLOOR
GAINESVILLE, FL 32607

03981-004-007

STREIT WOLFGANG J
16414 NW 110TH AVE
ALACHUA, FL 32615

03981-006-000

OWENS LIFE ESTATE & OWENS LIFE ES
11418 NW 161ST ST
ALACHUA, FL 32615

03983-011-000

WACO PROPERTIES INC
569 EDGEWOOD AVE SOUTH
JACKSONVILLE, FL 32205

03997-006-000

MORALES DANIEL J & SHELLEY H
10945 NW COUNTY ROAD 235
ALACHUA, FL 32615

03980-003-001

MCDONALD & MCDONALD
15824 OPEN SKY WAY
COLORADO SPRINGS, CO 80908

03980-003-004

ESKRIDGE MARTY R
14705 MAIN ST
ALACHUA, FL 32615

03980-003-007

JARMON RANDALL L
11908 NW 164TH TER
ALACHUA, FL 32615

03980-003-010

BERG JEFFERY E & RENEE D
16329 NW 118TH PL
ALACHUA, FL 32615

03980-003-054

MOORE WENDY SANDRA
12017 NW 164TH TER
ALACHUA, FL 32615

03981-004-005

SULAK KENNETH J & MARSHA J
16328 NW 110TH AVE
ALACHUA, FL 32615

03981-005-001

HALBROOK JAMES RONALD JR & MELII
11306 NW 161ST ST
ALACHUA, FL 32615

03981-007-000

LEWIS SHEREE WILSON
16008 NW 118TH PL
ALACHUA, FL 32615

03984-000-000

GAVIGAN & GAVIGAN
25348 CARNOUSTIE DR
SORRENTO, FL 32776

04008-001-001

AUGSPURG JASON R & JANET R
16825 NW 110TH AVE
ALACHUA, FL 32615

Antoinette Endelicato
5562 NW 93rd Avenue
Gainesville FL 32653

Dan Rhine
288 Turkey Creek
Alachua FL 32615

Richard Gorman
5716 NW 93rd Avenue
Alachua FL 32653

Tom Gorman
9210 NW 59th Street
Alachua FL 32653

Peggy Arnold
410 Turkey Creek
Alachua FL 32615

David Forest
23 Turkey Creek
Alachua FL 32615

President
TCMOA
1000 Turkey Creek
Alachua FL 32615

Linda Dixon, AICP
Assistant Director Planning
PO Box 115050
Gainesville FL 32611

Craig Parenteau
FL Department of Environmental
Protection
4801 Camp Ranch Road
Gainesville FL 32641

Jeannette Hinsdale
P.O. Box 1156
Alachua FL 32616

Lynn Coullias
7406 NW 126th Ave
Alachua FL 32615

Lynda Coon
7216 NW 126 Avenue
Alachua FL 32615

Tamara Robbins
PO Box 2317
Alachua FL 32616

Michele L. Lieberman
County Manager
12 SE 1st Street
Gainesville FL 32601

Bonnie Flynn
16801 NW 166th Drive
Alachua FL 32615

Hugh & Jean Calderwood
P.O. Box 2307
Alachua FL 32616

Lisia Jenkins
P.O. Box 1071
Alachua FL 32616

Shayla Schoelhorn
15907 NW 185th St
Alachua, FL 32615

Carrie Luke
16611 NW 138th Ave
Alachua, FL 32615

Dana Courtney
PO Box 1215
High Springs, FL 32655

Tom & Vicki Coleridge
4322 NW 93rd Ave
Gainesville, FL 32653

Ken Sulak
16328 NW 110th Ave
Alachua, FL 32615

Leslie Flage
PO Box 907
Alachua, FL 32616

David & Enid Turner
17011 NW 110th Ave
Alachua, FL 32615

Lee Ann Montagne
10616 NW 173rd St
Alachua, FL 32615

PROPERTY OCCUPANT(S)
10945 NW COUNTY RD 235
ALACHUA FLORIDA 32615

PROPERTY OCCUPANT(S)
11926 NW 164TH TER
ALACHUA FLORIDA 32615

PROPERTY OCCUPANT(S)
16419 NW 110TH AVE
ALACHUA FLORIDA 32615

PROPERTY OCCUPANT(S)
11126 NW COUNTY RD 235
ALACHUA FLORIDA 32615

PROPERTY OCCUPANT(S)
12004 NW 164TH TER
ALACHUA FLORIDA 32615

PROPERTY OCCUPANT(S)
16513 NW 110TH AVE
ALACHUA FLORIDA 32615

PROPERTY OCCUPANT(S)
11305 NW 173RD ST
ALACHUA FLORIDA 32615

PROPERTY OCCUPANT(S)
12012 NW 164TH TER
ALACHUA FLORIDA 32615

PROPERTY OCCUPANT(S)
16919 NW 110TH AVE
ALACHUA FLORIDA 32615

PROPERTY OCCUPANT(S)
11306 NW 161ST ST
ALACHUA FLORIDA 32615

PROPERTY OCCUPANT(S)
12017 NW 164TH TER
ALACHUA FLORIDA 32615

PROPERTY OCCUPANT(S)
17011 NW 110TH AVE
ALACHUA FLORIDA 32615

PROPERTY OCCUPANT(S)
11636 NW 161ST ST
ALACHUA FLORIDA 32615

PROPERTY OCCUPANT(S)
12028 NW 164TH TER
ALACHUA FLORIDA 32615

PROPERTY OCCUPANT(S)
17309 NW 110TH AVE
ALACHUA FLORIDA 32615

PROPERTY OCCUPANT(S)
11902 NW 164TH TER
ALACHUA FLORIDA 32615

PROPERTY OCCUPANT(S)
16328 NW 110TH AVE
ALACHUA FLORIDA 32615

PROPERTY OCCUPANT(S)
17345 NW 110TH AVE
ALACHUA FLORIDA 32615

PROPERTY OCCUPANT(S)
11908 NW 164TH TER
ALACHUA FLORIDA 32615

PROPERTY OCCUPANT(S)
16329 NW 118TH PL
ALACHUA FLORIDA 32615

PROPERTY OCCUPANT(S)
17411 NW 110TH AVE
ALACHUA FLORIDA 32615

PROPERTY OCCUPANT(S)
11914 NW 164TH TER
ALACHUA FLORIDA 32615

PROPERTY OCCUPANT(S)
16337 NW 118TH PL
ALACHUA FLORIDA 32615

PROPERTY OCCUPANT(S)
11920 NW 164TH TER
ALACHUA FLORIDA 32615

PROPERTY OCCUPANT(S)
11923 NW 164TH TER
ALACHUA FLORIDA 32615

PROPERTY OCCUPANT(S)
16414 NW 110TH AVE
ALACHUA FLORIDA 32615

PROPERTY OCCUPANT(S)
16415 NW 110TH AVE
ALACHUA FLORIDA 32615

04008-003-000
BRANDON-TURNER & TURNER TRUSTEE
17011 NW 110TH AVE
ALACHUA, FL 32615

04008-003-001
VINCENT & VINCENT TRUSTEES
16919 NW 110TH AVE
ALACHUA, FL 32615

04008-003-005
FAIRCLOTH CHARLOTTE LEE
PO BOX 73
ALACHUA, FL 32616

04008-004-000
CRUSE & CRUSE & STORMANT
PO BOX 126
ALACHUA, FL 32616

04008-005-000
CLARK CODY THOMAS & RUTH CHANCE
16357 NW 110TH AVE
ALACHUA, FL 32615

04008-005-004
JOHNS TIMOTHY CALVIN & SHANNON
16333 NW 110TH AVE
ALACHUA, FL 32615

04008-005-005
CLARK PAUL N
16341 NW 110TH AVE
ALACHUA, FL 32615

92060-517-900
CSX TRANSPORTATION INC
500 WATER ST TAX DEPARTMENT J-910
JACKSONVILLE, FL 32202

AFFIDAVIT FOR POSTED LAND USE SIGN

I Debbie Wallen, POSTED THE LAND USE
SIGN ON 2/17/22 FOR THE NW 188th Street LSCPA/Rezoning - PZB & CCOM1
(name) (date) (state type of action and project name)
LAND USE ACTION.

AS PER ARTICLE 2.2.9 D OF THE LAND DEVELOPMENT REGULATIONS.

THIS WILL BE INCLUDED IN THE STAFF REPORT.

Debbie Wallen
(signature)

8 (eight)
(number of signs)