

pedestrian was hit while walking along a road in Road 25) approaching northbound on U.S. scene until law enforcement

Alachua man arrested for child molestation

By C.M. WALKER
Today Reporter

ALACHUA — An Alachua man has been charged with lewd and lascivious molestation on a child. Ricky Rodriguez, 48, of Alachua, was served

a warrant on Sept. 8 and was subsequently charged with lewd and lascivious molestation on a child between the ages of 12 and 16.

Rodriguez was originally charged with

three counts of lewd and lascivious molestation, but he was only formally charged with one count. The alleged offense occurred in January 2022. A sworn complaint was filed in July and a warrant for his arrest

was issued on Aug. 30.

Rodriguez has been released on \$250,000 bond.

#

Email cwalker@
alachuatoday.com



City of
ALACHUA

PUBLIC NOTICE OF ENACTMENT OF AN ORDINANCE OF THE CITY OF ALACHUA, FLORIDA

Notice is hereby given that the City Commission of the City of Alachua will hold a public hearing on a proposed ordinance. The hearing will be held on September 26, 2022 at 6:00 p.m., in the James A. Lewis Commission Chambers in City Hall, located at 15100 NW 142nd Terrace, Alachua, Florida.

The ordinance title is as follows:

ORDINANCE 22-19

AN ORDINANCE OF THE CITY OF ALACHUA, FLORIDA, RELATING TO THE AMENDMENT OF THE OFFICIAL ZONING ATLAS; AMENDING THE OFFICIAL ZONING ATLAS FROM AGRICULTURAL ("A") AND AGRICULTURAL ("A") (ALACHUA COUNTY) TO PLANNED DEVELOPMENT - RESIDENTIAL ("PD-R") ON APPROXIMATELY 51.7 ACRES; LOCATED SOUTH OF PEGGY ROAD AND LEGACY PARK, EAST OF INTERSTATE - 75, NORTH OF THE CSX RAILWAY RIGHT-OF-WAY; TAX PARCEL NUMBERS 03924-000-000, 03865-000-000, AND 03917-200-002; REPEALING ALL ORDINANCES IN CONFLICT; PROVIDING SEVERABILITY; AND PROVIDING AN EFFECTIVE DATE.

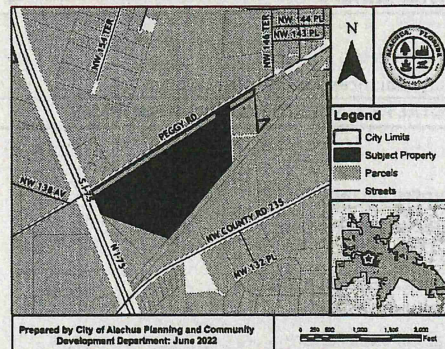

At the public hearing, all interested parties may appear and be heard with respect to the application. Copies of the application are available for public inspection at the Planning and Community Development Department, 15100 NW 142nd Terrace, Alachua, Florida, on any regular business day between the hours of 7:30 a.m. to 6:00 p.m. Written comments on the application may be sent to the following address: City of Alachua, Planning and Community Development, P.O. Box 9, Alachua, FL 32616. Notice is given pursuant to Section 286.0105, Florida Statutes, that, in order to appeal any decision made at the public hearing, you will need a record of the proceedings, and that, for such purpose, you may need to ensure that a verbatim record of the proceedings is made, which includes the testimony and evidence upon which the appeal is to be based. In accordance with the Americans with Disabilities Act, any persons with a disability requiring reasonable accommodation in order to participate in this meeting should call the City Clerk at (386) 418-6100 x 1501 at least 48 hours prior to the public hearing.

(Published: Alachua County Today - September 15, 2022)



HORIZON

REALTY OF ALACHUA, INC.

info@HorizonRealtyFL.com

**SERVING THE COMMUNITY
SINCE 1979**

YOUR HOME TOWN REALTOR WITH GLOBAL CONNECTIONS

RESIDENTIAL

Own your own perfect spot on the beautiful Suwannee River!! This move-in ready home is perfect for full time living, vacationing, or an investment for vacation rentals. Enjoy the gorgeous river views from the large back porch of the very, well maintained, 3 bedroom, 2 bath home. Plenty of space for the whole family to play and enjoy time together that includes a full kitchen & 1/2 bath downstairs. Plenty of parking for either vehicles, boats, and or buggy under the house. Spacious work shop area, new drain field, Aerobic sewer system with new air compressor and new field lines. Newer appliances, water filter system, and metal roof! MLS GC447302

MUST SEE this absolutely gorgeous property to appreciate the almost 11 beautiful acres in historic High Springs. If you're looking for

privacy and seclusion, this is the perfect location. Private driveway off county maintained road that opens up to property. Two mobile homes on the property. First (1975) is used as living quarters with front and back decks to enjoy your morning coffee or an evening libation while watching the deer and turkey wander about. The second (1993) is used for storage. Well and two septic tanks. Multitude of trees and wild life throughout the entire property. This home works for hunting lodge, building your dream home, or barn-dominium as it has plenty of cleared open area to build with woods around the property. Its worth the short drive to check out the scenery! MLS GC500812

VACANT LAND

Looking for a place to escape the hustle and bustle of life? Come take a look at this gorgeous 1.73 acre on

the Suwannee River. Over 220 feet of river frontage. You will enjoy relaxing with the peace and quiet of Florida's natural habitat. Serene area with Peacock Springs Conservation Area across the river. This lot has an abundance of wildlife, oak trees and lush vegetation just what you imagine "Old Florida" to be like. Build your dream vacation getaway or a permanent home with builder of your choice. Great recreational river with so much to offer! Whether you like power boating, canoeing or just like sitting on a dock gazing at the sunsets you will love owning this property on the historic Suwannee river! MLS #: GC501456

Ready for your new home! This 5 acres is cleared and ready - located just off SR 47 on a paved road that is a dead end street so no through traffic! Come take a look today - site built-homes only. MLS GC500866

THINKING ABOUT A CAREER IN REAL ESTATE? CALL US TODAY!

386-462-4020 OR 1-866-455-2092

Motorcyclist killed in crash on Archer Road near Clark Butler Blvd.

Special to Gainesville Sun | USA TODAY NETWORK

A 23-year-old man is dead following a Tuesday morning crash involving an SUV

and motorcycle in the area of Southwest Archer Road and Clarke Butler Boulevard, the Gainesville Police Department reported.

After several calls received by the

Combined Communication Center at 6:31 a.m., police located the driver of the motorcycle, the victim, in the roadway with obvious signs of head trauma, ac-

cording to the report.

The cause of the crash is still under investigation. Charges, if any, have not been determined.

Hearing

Continued from Page 1A

Lawmakers say there is more to come. The nine-member panel – seven Democrats and two Republicans – interviewed witnesses through all of August, and panelists are hoping to have at least one hearing by the end of the month. Members met Tuesday to discuss the panel’s next steps.

Because the Jan. 6 panel is a temporary, or “select,” committee, it expires at the end of the current Congress. If Republicans take the majority in November’s elections, as they are favored to do, they are expected to dissolve the committee in January. So the panel is planning to issue a final report by the end of December.

What’s left for the committee in 2022:

Hearings

The panel’s Democratic chairman, Mississippi Rep. Bennie Thompson, said after the private members’ meeting Tuesday in the Capitol that the committee’s goal is to hold a hearing Sept. 28, but that members were still discussing whether it would happen at all.

“We’re still in the process of talking,” Thompson said. “If it happens, it will be that date. We’re not sure at this point.”

Members of the committee had promised more hearings in September as they wrapped up the series of summer hearings. Wyoming Rep. Liz Cheney, the Republican vice chairwoman, said the committee “has far more evidence to share with the American people and more to gather.”

“Doors have opened, new subpoenas have been issued, and the dam has begun to break,” Cheney said at a July 21 hearing that was held in prime time and watched by 17.7 million people. “We have considerably more to do.”

It’s unclear if the hearing would provide a general overview of what the panel has learned or if members would be focused on new information and evidence. The committee conducted several interviews at the end of July and into August with Trump’s Cabinet secretaries, some of whom had discussed invoking the constitutional process in the 25th Amendment to remove Trump from office after the insurrection.

Witnesses

The panel has already interviewed more than 1,000 people, but lawmakers and staff are still pursuing new threads. The committee recently spoke to several of the Cabinet secretaries, including former Treasury Secretary Steven Mnuchin in July and former Secretary of State Mike Pompeo and former Transportation Secretary Elaine Chao in August.

The committee also wants to get to the bottom of missing Secret Service texts from Jan. 5-6, 2021, which could shed further light on Trump’s actions during the insurrection, particularly after earlier testimony about his confrontation with security as he tried to join supporters at the Capitol. Thompson said Tuesday that the committee has recently obtained “thousands” of documents from the Secret Service.

The committee has also pursued an interview with conservative activist Virginia “Ginni” Thomas, who’s married to Supreme Court Justice Clarence Thomas. Lawmakers want to know more about her role in trying to help Trump overturn the election. She contacted lawmakers in Arizona and Wisconsin as part of that effort.

Trump and Pence

Members of the committee are still debating how aggressively to pursue testimony from Trump and former Vice President Mike Pence.

Some have questioned whether the committee needs to call Pence, who resisted Trump’s pressure to try and block Biden’s certification on Jan. 6. Many of his closest aides have already testified, including Greg Jacob, his top lawyer at the White House who was with him during the insurrection as they hid from rioters who were threatening the vice president’s life. Jacobs characterized much of Pence’s thought process during the time when Trump was pressuring him.

The panel has been in discussions with Pence’s lawyers for months, without any discernible progress. Still, the committee could invite Pence for closed-door testimony or ask him to answer written questions.

The calculation is different for the former president. Members have debated whether they should call Trump, who is the focus of their probe but also a witness who has fought against the investigation in court, denied much of the evidence and floated the idea of presidential pardons for Jan. 6 rioters. Trump is also facing scrutiny in several other investigations, including at the Justice Department and over the classified documents he took to his private club.

House Republicans

Another bit of unfinished business is the committee’s subpoenas to five House Republicans, including Minority Leader Kevin McCarthy.

In May the panel subpoenaed McCarthy, R-Calif., and Reps. Jim Jordan of Ohio, Scott Perry of Pennsylvania, Andy Biggs of Arizona and Mo Brooks of Alabama. The panel has investigated McCarthy’s conversations with Trump the day of the attack and meetings the four other lawmakers had with the White House beforehand as Trump and some of his allies worked to overturn his election defeat.

The five Republicans, all of whom

have repeatedly downplayed the investigation’s legitimacy, have simply ignored the request to testify. But the Jan. 6 committee seems unlikely to meet their defiance with contempt charges, as it has with other witnesses, in the weeks before the November elections. Not only would it be a politically risky move, but it is unclear what eventual recourse the panel would have against its own colleagues.

Final report

The committee must shut down within a month after issuing a final report, per its rules. But lawmakers could issue some smaller reports before then, perhaps even before the November elections. Thompson said earlier this summer that there may be an interim report in the fall.

The release of the final report will likely come close to the end of the year so the panel can maximize its time. While much of the findings will already be known, the report is expected to thread the story together in a definitive way that lays out the committee’s conclusions for history.

Legislative recommendations

The committee is expected to weigh in on possible legislative changes to the Electoral Count Act, which governs how a presidential election is certified by Congress.

A bipartisan group of senators released proposed changes over the summer that would clarify the way states submit electors and the vice president tallies the votes. Trump and his allies tried to find loopholes in that law ahead of Jan. 6 as the former president worked to overturn his defeat to Biden and unsuccessfully pressured Pence to go along.

The Jan. 6 panel’s final report is expected to include a larger swath of legislative recommendations.

PUBLIC NOTICE OF ENACTMENT OF AN ORDINANCE OF THE CITY OF ALACHUA, FLORIDA

Notice is hereby given that the City Commission of the City of Alachua will hold a public hearing on a proposed ordinance. The hearing will be held on September 26, 2022 at 6:00 p.m., in the James A. Lewis Commission Chambers in City Hall, located at 15100 NW 142nd Terrace, Alachua, Florida.

The ordinance title is as follows:

ORDINANCE 22-18
AN ORDINANCE OF THE CITY OF ALACHUA, FLORIDA, RELATING TO THE LARGE SCALE AMENDMENT OF THE CITY OF ALACHUA COMPREHENSIVE PLAN FUTURE LAND USE MAP; AMENDING THE FUTURE LAND USE MAP CLASSIFICATION ON ±51.7 ACRES FROM AGRICULTURE AND RURAL/AGRICULTURE (ALACHUA COUNTY) TO MODERATE DENSITY RESIDENTIAL ON A PARCEL OF LAND GENERALLY LOCATED SOUTH OF PEGGY ROAD AND LEGACY PARK, EAST OF INTERSTATE – 75, NORTH OF THE CSX RAILWAY RIGHT-OF-WAY; TAX PARCEL NUMBERS 03924-000-000, 03865-000-000, AND 03917-200-002; REPEALING ALL ORDINANCES IN CONFLICT; PROVIDING SEVERABILITY; AND PROVIDING AN EFFECTIVE DATE.

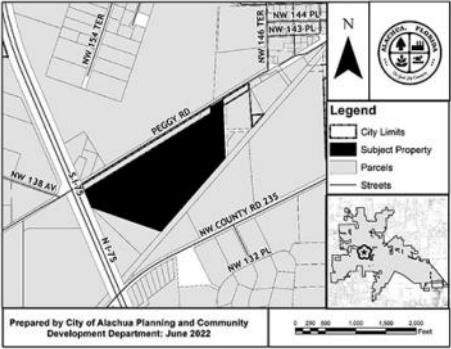

At the public hearing, all interested parties may appear and be heard with respect to the application. Copies of the application are available for public inspection at the Planning and Community Development Department, 15100 NW 142nd Terrace, Alachua, Florida, on any regular business day between the hours of 7:30 a.m. to 6:00 p.m. Written comments on the application may be sent to the following address: City of Alachua, Planning and Community Development, P.O. Box 9, Alachua, FL 32616. Notice is given pursuant to Section 286.0105, Florida Statutes, that, in order to appeal any decision made at the public hearing, you will need a record of the proceedings, and that, for such purpose, you may need to ensure that a verbatim record of the proceedings is made, which includes the testimony and evidence upon which the appeal is to be based. In accordance with the Americans with Disabilities Act, any persons with a disability requiring reasonable accommodation in order to participate in this meeting should call the City Clerk at (386) 418-6100 x 1501 at least 48 hours prior to the public hearing.

GF-32101712

PUBLIC NOTICE OF ENACTMENT OF AN ORDINANCE OF THE CITY OF ALACHUA, FLORIDA

Notice is hereby given that the City Commission of the City of Alachua will hold a public hearing on a proposed ordinance. The hearing will be held on September 26, 2022 at 6:00 p.m., in the James A. Lewis Commission Chambers in City Hall, located at 15100 NW 142nd Terrace, Alachua, Florida.

The ordinance title is as follows:

ORDINANCE 22-19
AN ORDINANCE OF THE CITY OF ALACHUA, FLORIDA, RELATING TO THE AMENDMENT OF THE OFFICIAL ZONING ATLAS; AMENDING THE OFFICIAL ZONING ATLAS FROM AGRICULTURAL (“A”) AND AGRICULTURAL (“A”)(ALACHUA COUNTY) TO PLANNED DEVELOPMENT – RESIDENTIAL (“PD-R”) ON APPROXIMATELY 51.7 ACRES; LOCATED SOUTH OF PEGGY ROAD AND LEGACY PARK, EAST OF INTERSTATE – 75, NORTH OF THE CSX RAILWAY RIGHT-OF-WAY; TAX PARCEL NUMBERS 03924-000-000, 03865-000-000, AND 03917-200-002; REPEALING ALL ORDINANCES IN CONFLICT; PROVIDING SEVERABILITY; AND PROVIDING AN EFFECTIVE DATE.

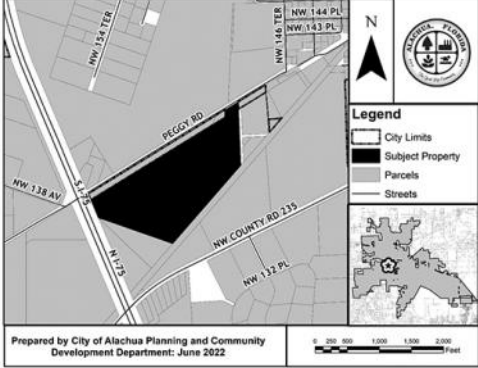

At the public hearing, all interested parties may appear and be heard with respect to the application. Copies of the application are available for public inspection at the Planning and Community Development Department, 15100 NW 142nd Terrace, Alachua, Florida, on any regular business day between the hours of 7:30 a.m. to 6:00 p.m. Written comments on the application may be sent to the following address: City of Alachua, Planning and Community Development, P.O. Box 9, Alachua, FL 32616. Notice is given pursuant to Section 286.0105, Florida Statutes, that, in order to appeal any decision made at the public hearing, you will need a record of the proceedings, and that, for such purpose, you may need to ensure that a verbatim record of the proceedings is made, which includes the testimony and evidence upon which the appeal is to be based. In accordance with the Americans with Disabilities Act, any persons with a disability requiring reasonable accommodation in order to participate in this meeting should call the City Clerk at (386) 418-6100 x 1501 at least 48 hours prior to the public hearing.

GF-32101858

PUBLIC NOTICE OF ENACTMENT OF AN ORDINANCE OF THE CITY OF ALACHUA, FLORIDA

Notice is hereby given that the City Commission of the City of Alachua will hold a public hearing on a proposed ordinance. The hearing will be held on September 26, 2022 at 6:00 p.m., in the James A. Lewis Commission Chambers in City Hall, located at 15100 NW 142nd Terrace, Alachua, Florida.

The ordinance title is as follows:

ORDINANCE 23-01
AN ORDINANCE OF THE CITY OF ALACHUA, FLORIDA, RELATING TO THE AMENDMENT OF THE CITY’S LAND DEVELOPMENT REGULATIONS; AMENDING THE CITY’S LAND DEVELOPMENT REGULATIONS BY AMENDING ARTICLE 4, TABLE 4.1-1, TABLE OF ALLOWED USES, TO ALLOW SELF-SERVICE STORAGE AS A PERMITTED USE IN THE LIGHT AND WAREHOUSE INDUSTRIAL (ILW) ZONING DISTRICT; PROVIDING A REPEALING CLAUSE; PROVIDING SEVERABILITY; AND PROVIDING AN EFFECTIVE DATE.

At the public hearing, all interested parties may appear and be heard with respect to the application. Copies of the application are available for public inspection at the Planning and Community Development Department, 15100 NW 142nd Terrace, Alachua, Florida, on any regular business day between the hours of 7:30 a.m. to 6:00 p.m. Written comments on the application may be sent to the following address: City of Alachua, Planning and Community Development, P.O. Box 9, Alachua, FL 32616. Notice is given pursuant to Section 286.0105, Florida Statutes, that, in order to appeal any decision made at the public hearing, you will need a record of the proceedings, and that, for such purpose, you may need to ensure that a verbatim record of the proceedings is made, which includes the testimony and evidence upon which the appeal is to be based. In accordance with the Americans with Disabilities Act, any persons with a disability requiring reasonable accommodation in order to participate in this meeting should call the City Clerk at (386) 418-6100 x 1501 at least 48 hours prior to the public hearing.

GF-32134109

mailed 9/12/22
KC

PUBLIC NOTICE OF ENACTMENT OF AN ORDINANCE OF THE CITY OF ALACHUA, FLORIDA

Notice is hereby given that the City Commission of the City of Alachua will hold a public hearing on a proposed ordinance. The hearing will be held on September 26, 2022 at 6:00 p.m., in the James A. Lewis Commission Chambers in City Hall, located at 15100 NW 142nd Terrace, Alachua, Florida.

The ordinance title is as follows:

ORDINANCE 22-19

AN ORDINANCE OF THE CITY OF ALACHUA, FLORIDA, RELATING TO THE AMENDMENT OF THE OFFICIAL ZONING ATLAS; AMENDING THE OFFICIAL ZONING ATLAS FROM AGRICULTURAL ("A") AND AGRICULTURAL ("A")(ALACHUA COUNTY) TO PLANNED DEVELOPMENT – RESIDENTIAL ("PD-R") ON APPROXIMATELY 51.7 ACRES; LOCATED SOUTH OF PEGGY ROAD AND LEGACY PARK, EAST OF INTERSTATE – 75, NORTH OF THE CSX RAILWAY RIGHT-OF-WAY; TAX PARCEL NUMBERS 03924-000-000, 03865-000-000, AND 03917-200-002; REPEALING ALL ORDINANCES IN CONFLICT; PROVIDING SEVERABILITY; AND PROVIDING AN EFFECTIVE DATE.

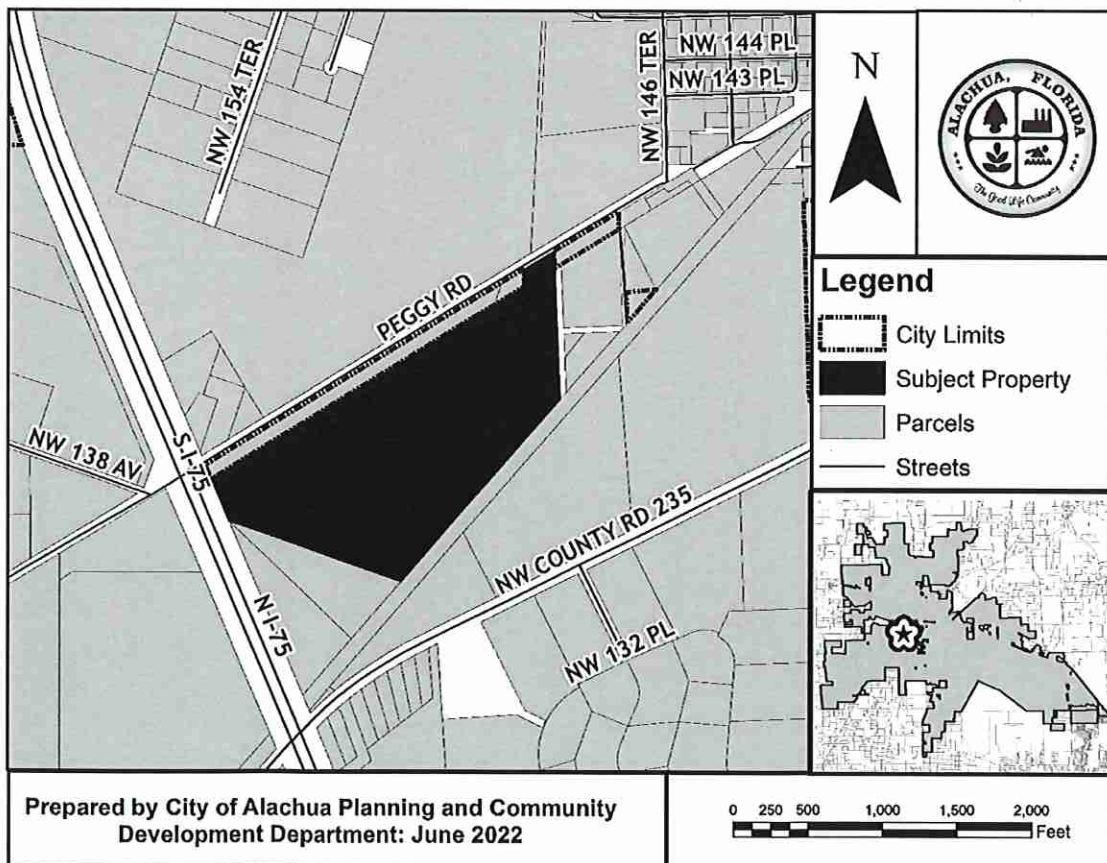

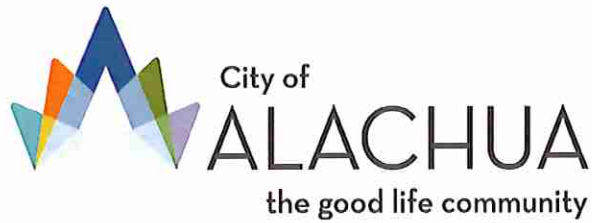

At the public hearing, all interested parties may appear and be heard with respect to the application. Copies of the application are available for public inspection at the Planning and Community Development Department, 15100 NW 142nd Terrace, Alachua, Florida, on any regular business day between the hours of 7:30 a.m. to 6:00 p.m. Written comments on the application may be sent to the following address: City of Alachua, Planning and Community Development, P.O. Box 9, Alachua, FL 32616. Notice is given pursuant to Section 286.0105, Florida Statutes, that, in order to appeal any decision made at the public hearing, you will need a record of the proceedings, and that, for such purpose, you may need to ensure that a verbatim record of the proceedings is made, which includes the testimony and evidence upon which the appeal is to be based. In accordance with the Americans with Disabilities Act, any persons with a disability requiring reasonable accommodation in order to participate in this meeting should call the City Clerk at (386) 418-6100 x 1501 at least 48 hours prior to the public hearing.

03916-001-000
 ROSARIO HECTOR & VERONICA
 13116 NW COUNTY RD 235
 ALACHUA, FL 32615

03918-000-000
 CITIZENS & SOUTHERN NATIONAL BANK TR
 13500 NW COUNTY RD 235
 ALACHUA, FL 32615-6150

03925-002-000
 Sandvik Mining & Construction USA LLC
 13500 NW COUNTY RD 235
 ALACHUA, FL 32615

03919-000-000
 HUNTER B R & CHRISTINE
 14905 PEGGY RD
 ALACHUA, FL 32615-5451

03917-200-001
 HUNTER CHRISTINE A
 14905 PEGGY RD
 ALACHUA, FL 32615-5451

03866-001-000
 MILLER MARTHA L LIFE ESTATE
 15708 PEGGY RD
 ALACHUA, FL 32615-5455

03866-000-000
 LUMPKIN O A JR & JOYCE
 15716 PEGGY RD
 ALACHUA, FL 32615-5455

03866-003-000
 LUMPKIN O A JR & JOYCE
 15716 PEGGY RD
 ALACHUA, FL 32615

03865-200-000
 CSX TRANSPORTATION INC
 500 WATER ST TAX DEPT J-910
 JACKSONVILLE, FL 32202-4423

03917-200-000
 CSX TRANSPORTATION INC
 500 WATER ST TAX DEPT J-910
 JACKSONVILLE, FL 32202-4423

92060-517-900
 CSX TRANSPORTATION INC
 500 WATER ST TAX DEPT J-910
 JACKSONVILLE, FL 32202-4423

03916-002-000
 SMITH STEPHEN F & RENEE
 503 SW 3RD ST
 GAINESVILLE, FL 32601

03905-002-000
 WACO PROPERTIES INC
 569 EDGEWOOD AVE SOUTH
 JACKSONVILLE, FL 32205

03905-003-000
 WACO PROPERTIES INC
 569 EDGEWOOD AVE SOUTH
 JACKSONVILLE, FL 32205

03918-003-000
 BLACK FLAG METALSMITH LLC
 9744 NW 27TH PL
 GAINESVILLE, FL 32606

03923-000-000
 GARRISON & ROBINSON
 PO BOX 1084
 ALACHUA, FL 32616-1084

03865-000-000
 KIRKLAND W & MARGARET
 PO BOX 1360
 ALACHUA, FL 32616-1360

03924-000-000
 KIRKLAND W & MARGARET
 PO BOX 1360
 ALACHUA, FL 32616-1360

03917-200-002
 KIRKLAND WILLIAM & MARGARET
 PO BOX 1360
 ALACHUA, FL 32616

03923-001-000
 JACKSON ROBERT HEIRS
 PO BOX 657
 ALACHUA, FL 32616-0657

03870-000-000
 CITY OF ALACHUA
 PO BOX 9
 ALACHUA, FL 32616

03870-001-000
 CITY OF ALACHUA
 PO BOX 9
 ALACHUA, FL 32616-0009

Printing Tips

- 1 | Go to avery.com/templates.
- 2 | Design using the template number for this product.
- 3 | Test print on plain paper.
- 4 | Change printer settings to "Labels" and print.

Need help?
Visit avery.com/help

Conseils d'impression

- 1 | Aller à avery.ca/gabarits.
- 2 | Créez en utilisant le numéro de gabarit pour ce produit.
- 3 | Faites un test d'impression sur du papier ordinaire.
- 4 | Modifier le réglage de l'imprimante à "Étiquettes" et imprimez.

Besoin d'aide?
Visitez avery.ca/aide

Consejos de Impresión

- 1 | Visita avery.mx/plantillas.
- 2 | Diseña la plantilla utilizando el código del producto.
- 3 | Prueba la impresión en un papel normal.
- 4 | Cambia la configuración de la impresora a "Labels" o etiquetas e imprime.

¿Necesitas ayuda?
Visita avery.com/ayuda

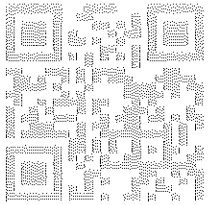

Visit Avery® Now

Scan for access to printing tips, product information, help and more using your smartphone or tablet.

Scannez pour avoir accès aux conseils d'impression, l'information produit de l'aide et plus à l'aide de votre smartphone ou tablette.

Escanee para acceder a sugerencias de impresión, información de productos, ayuda y mucho más utilizando tu teléfono móvil o tablet.



GENUINE / AUTHENTIQUE / GENUINO

Antoinette Endelicato
5562 NW 93rd Avenue
Gainesville, FL 32653

Dan Rhine
288 Turkey Creek
Alachua, FL 32615

Tom Gorman
9210 NW 59th Street
Alachua, FL 32653

Richard Gorman
5716 NW 93rd Avenue
Alachua, FL 32653

Peggy Arnold
410 Turkey Creek
Alachua, FL 32615

David Forest
23 Turkey Creek
Alachua, FL 32615

President of TCMOA
1000 Turkey Creek
Alachua, FL 32615

Linda Dixon, AICP
Assistant Director of Planning
PO Box 115050
Gainesville, FL 32611

Craig Parenteau
FL Dept. of Environmental Protection
4801 Camp Ranch Road
Gainesville, FL 32641

Jeannette Hinsdale
P.O. Box 1156
Alachua, FL 32616

Lynn Coullias
7406 NW 126th Ave
Alachua, FL 32615

Lynda Coon
7216 NW 126 Avenue
Alachua, FL 32615

Tamara Robbins
PO Box 2317
Alachua, FL 32616

Michele L. Lieberman
County Manager
12 SE 1st Street
Gainesville, FL 32601

Bonnie Flynn
16801 NW 166th Drive
Alachua, FL 32615

Hugh & Jean Calderwood
P.O. Box 2307
Alachua, FL 32616

Lisia Jenkins
P.O. Box 1071
Alachua, FL 32616

Shasta Schoellhorn
15907 NW 188th St.
Alachua, FL 32615

Carrie Luke
16611 NW 138th Ave.
Alachua, FL 32615

Dena Courtney
PO Box 1215
High Springs, FL 32655

Hugh & Jean Calderwood
14095 NW 174th Ave
Alachua, FL 32615

1. 2. 3. 4. 5. 6. 7. 8. 9. 10. 11. 12. 13. 14. 15. 16. 17. 18. 19. 20. 21. 22. 23. 24. 25. 26. 27. 28. 29. 30. 31. 32. 33. 34. 35. 36. 37. 38. 39. 40. 41. 42. 43. 44. 45. 46. 47. 48. 49. 50. 51. 52. 53. 54. 55. 56. 57. 58. 59. 60. 61. 62. 63. 64. 65. 66. 67. 68. 69. 70. 71. 72. 73. 74. 75. 76. 77. 78. 79. 80. 81. 82. 83. 84. 85. 86. 87. 88. 89. 90. 91. 92. 93. 94. 95. 96. 97. 98. 99. 100. 101. 102. 103. 104. 105. 106. 107. 108. 109. 110. 111. 112. 113. 114. 115. 116. 117. 118. 119. 120. 121. 122. 123. 124. 125. 126. 127. 128. 129. 130. 131. 132. 133. 134. 135. 136. 137. 138. 139. 140. 141. 142. 143. 144. 145. 146. 147. 148. 149. 150. 151. 152. 153. 154. 155. 156. 157. 158. 159. 160. 161. 162. 163. 164. 165. 166. 167. 168. 169. 170. 171. 172. 173. 174. 175. 176. 177. 178. 179. 180. 181. 182. 183. 184. 185. 186. 187. 188. 189. 190. 191. 192. 193. 194. 195. 196. 197. 198. 199. 200. 201. 202. 203. 204. 205. 206. 207. 208. 209. 210. 211. 212. 213. 214. 215. 216. 217. 218. 219. 220. 221. 222. 223. 224. 225. 226. 227. 228. 229. 230. 231. 232. 233. 234. 235. 236. 237. 238. 239. 240. 241. 242. 243. 244. 245. 246. 247. 248. 249. 250. 251. 252. 253. 254. 255. 256. 257. 258. 259. 260. 261. 262. 263. 264. 265. 266. 267. 268. 269. 270. 271. 272. 273. 274. 275. 276. 277. 278. 279. 280. 281. 282. 283. 284. 285. 286. 287. 288. 289. 290. 291. 292. 293. 294. 295. 296. 297. 298. 299. 300. 301. 302. 303. 304. 305. 306. 307. 308. 309. 310. 311. 312. 313. 314. 315. 316. 317. 318. 319. 320. 321. 322. 323. 324. 325. 326. 327. 328. 329. 330. 331. 332. 333. 334. 335. 336. 337. 338. 339. 340. 341. 342. 343. 344. 345. 346. 347. 348. 349. 350. 351. 352. 353. 354. 355. 356. 357. 358. 359. 360. 361. 362. 363. 364. 365. 366. 367. 368. 369. 370. 371. 372. 373. 374. 375. 376. 377. 378. 379. 380. 381. 382. 383. 384. 385. 386. 387. 388. 389. 390. 391. 392. 393. 394. 395. 396. 397. 398. 399. 400. 401. 402. 403. 404. 405. 406. 407. 408. 409. 410. 411. 412. 413. 414. 415. 416. 417. 418. 419. 420. 421. 422. 423. 424. 425. 426. 427. 428. 429. 430. 431. 432. 433. 434. 435. 436. 437. 438. 439. 440. 441. 442. 443. 444. 445. 446. 447. 448. 449. 450. 451. 452. 453. 454. 455. 456. 457. 458. 459. 460. 461. 462. 463. 464. 465. 466. 467. 468. 469. 470. 471. 472. 473. 474. 475. 476. 477. 478. 479. 480. 481. 482. 483. 484. 485. 486. 487. 488. 489. 490. 491. 492. 493. 494. 495. 496. 497. 498. 499. 500. 501. 502. 503. 504. 505. 506. 507. 508. 509. 510. 511. 512. 513. 514. 515. 516. 517. 518. 519. 520. 521. 522. 523. 524. 525. 526. 527. 528. 529. 530. 531. 532. 533. 534. 535. 536. 537. 538. 539. 540. 541. 542. 543. 544. 545. 546. 547. 548. 549. 550. 551. 552. 553. 554. 555. 556. 557. 558. 559. 560. 561. 562. 563. 564. 565. 566. 567. 568. 569. 570. 571. 572. 573. 574. 575. 576. 577. 578. 579. 580. 581. 582. 583. 584. 585. 586. 587. 588. 589. 590. 591. 592. 593. 594. 595. 596. 597. 598. 599. 600. 601. 602. 603. 604. 605. 606. 607. 608. 609. 610. 611. 612. 613. 614. 615. 616. 617. 618. 619. 620. 621. 622. 623. 624. 625. 626. 627. 628. 629. 630. 631. 632. 633. 634. 635. 636. 637. 638. 639. 640. 641. 642. 643. 644. 645. 646. 647. 648. 649. 650. 651. 652. 653. 654. 655. 656. 657. 658. 659. 660. 661. 662. 663. 664. 665. 666. 667. 668. 669. 670. 671. 672. 673. 674. 675. 676. 677. 678. 679. 680. 681. 682. 683. 684. 685. 686. 687. 688. 689. 690. 691. 692. 693. 694. 695. 696. 697. 698. 699. 700. 701. 702. 703. 704. 705. 706. 707. 708. 709. 710. 711. 712. 713. 714. 715. 716. 717. 718. 719. 720. 721. 722. 723. 724. 725. 726. 727. 728. 729. 730. 731. 732. 733. 734. 735. 736. 737. 738. 739. 740. 741. 742. 743. 744. 745. 746. 747. 748. 749. 750. 751. 752. 753. 754. 755. 756. 757. 758. 759. 760. 761. 762. 763. 764. 765. 766. 767. 768. 769. 770. 771. 772. 773. 774. 775. 776. 777. 778. 779. 780. 781. 782. 783. 784. 785. 786. 787. 788. 789. 790. 791. 792. 793. 794. 795. 796. 797. 798. 799. 800. 801. 802. 803. 804. 805. 806. 807. 808. 809. 810. 811. 812. 813. 814. 815. 816. 817. 818. 819. 820. 821. 822. 823. 824. 825. 826. 827. 828. 829. 830. 831. 832. 833. 834. 835. 836. 837. 838. 839. 840.

- 1 Go to every.com/templates
- 2 Design using the template number for this product.
- 3 Test print on plain paper.
- 4 Change printer settings to "Labels" and print.

Need help?
Visit avery.com/help

Comments or Impression

1. Allez à everywa/gabaritis
2. Créez en utilisant le numéro de gabarit pour ce produit.
3. Faites un test d'impression sur du papier ordinaire.
4. Modifiez le réglage de l'imprimante à "Étiquettes" et imprimez.

Becom a'ide?
 Visitor avery.ca/aide

Consejos de representación

1. **Visita avery.mx/planillas**
2. **Diseña la planilla utilizando el código del producto.**
3. **Prueba la impresión en un papel normal.**
4. **Cambia la configuración de la impresora a "labels" o etiquetas e imprime.**

Visit every.com/avuda

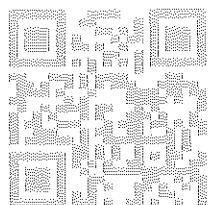
Visit Avery.com

Scan for access to printing files, product information, help and more using your smartphone or tablet.

Scannez pour avoir accès aux conseils d'impression, l'informations produit de l'aide et plus à l'aide de votre smartphone ou tablette.

Escanea para acceder a sugerencias de impresión, información de productos, ayuda y mucho más.
utilizando tu teléfono móvil o tablet.



$\frac{d}{dt} \left(\frac{\partial L}{\partial \dot{x}} \right) = \frac{\partial L}{\partial x}$

AFFIDAVIT FOR POSTED LAND USE SIGN

I MELISSA WATSON, POSTED THE LAND USE
(Name)
SIGN ON 9/8/2022 FOR THE Peggy Rd Planned Development LSCPA/RZ
(Date) (State type of action and project name)
LAND USE ACTION.

AS PER ARTICLE 2.2.9 D OF THE LAND DEVELOPMENT REGULATIONS.

THIS WILL BE INCLUDED IN THE STAFF REPORT.

Melissa Watson
(Signature)

One (1)
(Number of signs)