

HEROIN EPIDEMIC

Activist comes to Ocala

Pfaff travels the US through Heroin Is Killing My Town

By Nicki Gorny
Staff Writer

When Billy Pfaff hits the road — and that's often for Pfaff, who has cultivated a nationwide support network for heroin addicts — he brings with him a dire message: "This heroin epidemic is going to wipe out this beautiful community."

On Wednesday, when he had gathered 15 or so people at the downtown square, he was referring to Ocala. Other days he takes that warning to communities in Connecticut, Maryland, Massachusetts, New Jersey or Rhode Island. His next stop is Pennsylvania, where he said he plans to meet a young woman who reached out to him for help.

As the force behind Heroin Is Killing My Town, a Massachusetts-based nonprofit he founded two years ago after losing his best friend to a heroin addiction, Pfaff is often on the road. He estimates his reach, through Facebook, already stretches to 1.7 million people. And that network swells greater through stops like the one this week in Ocala, where he asked the small crowd to further his mission in Central Florida.

"I need all the help I can get out here," he told them.

The activist came to Ocala at the invitation of Jonathan Duffany, who knows firsthand the power of Pfaff's network.



Billy Pfaff, the founder of the nonprofit, "Heroin Is Killing My Town," right, speaks to people gathered on the Ocala Downtown Square on Wednesday. Pfaff, a native of Boston who travels across the country, is known for his interventions and helping heroin addicts into treatment. BRUCE ACKERMAN/STAFF PHOTOGRAPHER

He drew on it the day after Christmas, he said, when he first reached out to Pfaff on Facebook.

"I didn't want to live the way I was living," Duffany said.

As someone who had never even smoked marijuana, Duffany said he never thought he would see himself addicted to heroin. He fell onto that path after a shoulder surgery left him dependent on pain medication. That he had lost a brother and a cousin in a car accident around the same time complicated his situation.

Duffany said he had been using heroin for about three months when he came to Florida to visit family for Christmas. He decided to stay rather than return to his habit in Massachusetts, where he had been running his own carpentry business. When he finally reached out to Pfaff on Facebook, he said, Pfaff was on the phone with him almost immediately.

Pfaff connected him with a local woman who helped him into an inpatient facility in Leesburg, where Duffany, who now

lives in Ocala, said he got clean over nearly four months.

On Wednesday, Pfaff called on the small crowd to act as his local network for people, like Duffany, who reached out to him from Central Florida. He also called on them to "wake up" the city, suggesting they connect with hospitals, law enforcement and school systems to address the problem

comprehensively.

Of particular concern to Pfaff is the rise of fentanyl, a synthetic drug he said is significantly more powerful — and more dangerous — than heroin. "You don't go back to a lesser high," he said. "It controls your life."

Pfaff himself said he had never been a drug addict; what he knows about addiction and overcoming it comes from his years supporting others. He had been working as a tattoo artist in Boston before turning to Heroin Is Killing My Town full-time in 2014.

The gathering wrapped up in just under an hour on Wednesday afternoon. Especially considering it was organized with little notice, Pfaff said he was happy with the turnout.

"Even if I reach just two people," he said, "I'll be happy."

—Contact Nicki Gorny at 352-867-4065, nicki.gorny@ocala.com or @Nicki_Gorny.

MARTIN COUNTY

Commission wants disaster declared over blue-green algae

The Associated Press

STUART — County officials on Florida's Atlantic coast want the U.S. Army Corps of Engineers to close the locks between Lake Okeechobee and the St. Lucie River.

The Palm Beach Post reports the Martin County Commission decided at an emergency meeting Tuesday to ask state and federal authorities to declare a disaster where blue-green algae has closed beaches.

"This is our Deepwater Horizon. It's time the federal and state government understand how God-awful the problem is here," Commissioner Doug Smith said.

To keep water levels in the lake between 12.5 feet and 15.5 feet above sea level and relieve pressure on its aging earthen dike, the corps releases water east and west of the lake into the Caloosahatchee and St. Lucie rivers.

Coastal communities have said the discharges pollute local ecosystems, harming wildlife and the economy. Martin County commissioners heard complaints from local residents and business owners for three hours on Tuesday.

"We've had rashes on our hands. We're losing thousands of dollars. I want this fixed," Bruce Hrobak, owner of Billy Bones Bait & Tackle, one of about 250 people who crowded into the commission chambers.

The algae closed beaches this week along the Treasure Coast shoreline, the St. Lucie River and other bodies of water in the county. High temperatures, heavy rainfall and the high water levels in Lake Okeechobee contributed to the algae's growth, said Deborah Drum, the county's manager of ecosystem restoration and management engineering.

NOTICE OF PUBLIC HEARING BEFORE THE PLANNING AND ZONING BOARD OF THE CITY OF ALACHUA, FLORIDA

Notice is hereby given that the Planning and Zoning Board of the City of Alachua will hold a public hearing on July 12, 2016, at 6:30 p.m. The hearing will be held in the James A. Lewis Commission Chambers in City Hall, located at 15100 NW 142nd Terrace, Alachua, Florida, to consider the following: A request by Clay Sweger, AICP, LEED AP, of eda engineers – surveyors – planners, inc., applicant and agent for the AMES/Detrick Truck Company, property owner, for consideration of a Small Scale Comprehensive Plan Amendment (SSCPA) to the City of Alachua Future Land Use Map (FLUM,) to amend the FLUM from Industrial to Commercial on a ±9.32 acre subject property, located south of NW US Highway 441 and the Polaris of Gainesville dealership, southwest of Smyder Motor Sales and Equipment, and west of the Turkey Creek Subdivision; consisting of a portion of Tax Parcel Number 05920-001-002; Existing FLUM Designation: Industrial; Zoning: Light and Warehouse Industrial (ILW.)

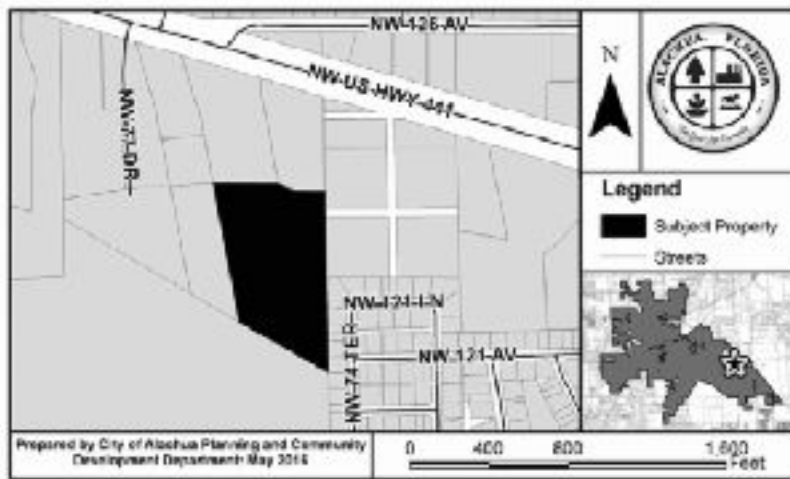

At the public hearing, all interested parties may appear and be heard with respect to the application. Copies of the application are available for public inspection at the Planning and Community Development Department, 15100 NW 142nd Terrace, Alachua, Florida, on any regular business day between the hours of 7:30 a.m. to 6:00 p.m. Written comments on the application may be sent to the following address: City of Alachua, Planning and Community Development, P.O. Box 9, Alachua, FL 32616. Notice is given pursuant to Section 286.0105, Florida Statutes, that, in order to appeal any decision made at the public hearing, you will need a record of the proceedings, and that, for such purpose, you may need to ensure that a verbatim record of the proceedings is made, which includes the testimony and evidence upon which the appeal is to be based. In accordance with the Americans with Disabilities Act, any persons with a disability requiring reasonable accommodation in order to participate in this meeting should call the City Clerk at (386) 418-6100 x 101 at least 48 hours prior to the public hearing.

NOTICE OF PUBLIC HEARING BEFORE THE PLANNING AND ZONING BOARD OF THE CITY OF ALACHUA, FLORIDA

Notice is hereby given that the Planning and Zoning Board of the City of Alachua will hold a public hearing on July 12, 2016, at 6:30 p.m. The hearing will be held in the James A. Lewis Commission Chambers in City Hall, located at 15100 NW 142nd Terrace, Alachua, Florida, to consider the following: A request by Clay Sweger, AICP, LEED AP, of eda engineers – surveyors – planners, inc., applicant and agent for the AMES/Detrick Truck Company, property owner, for consideration of a Site-Specific Amendment to the Official Zoning Atlas (Rezoning) to amend the Official Zoning Atlas from Light and Warehouse Industrial (ILW) to Commercial Intensive (CI) on a ±9.32 acre subject property, located south of NW US Highway 441 and the Polaris of Gainesville dealership, southwest of Smyder Motor Sales and Equipment, and west of the Turkey Creek Subdivision; consisting of a portion of Tax Parcel Number 05920-001-002; Existing Future Land Use Map (FLUM) Designation: Industrial; Proposed FLUM Designation: Commercial; Existing Zoning: Light and Warehouse Industrial (ILW.)

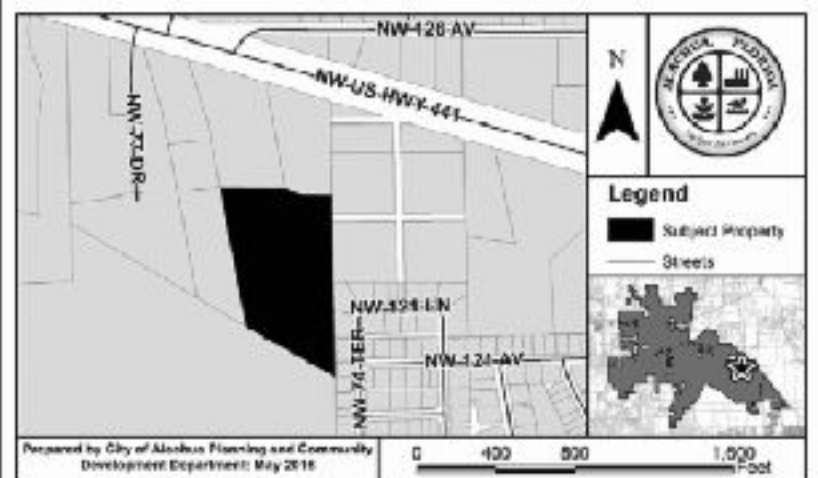

At the public hearing, all interested parties may appear and be heard with respect to the application. Copies of the application are available for public inspection at the Planning and Community Development Department, 15100 NW 142nd Terrace, Alachua, Florida, on any regular business day between the hours of 7:30 a.m. to 6:00 p.m. Written comments on the application may be sent to the following address: City of Alachua, Planning and Community Development, P.O. Box 9, Alachua, FL 32616. Notice is given pursuant to Section 286.0105, Florida Statutes, that, in order to appeal any decision made at the public hearing, you will need a record of the proceedings, and that, for such purpose, you may need to ensure that a verbatim record of the proceedings is made, which includes the testimony and evidence upon which the appeal is to be based. In accordance with the Americans with Disabilities Act, any persons with a disability requiring reasonable accommodation in order to participate in this meeting should call the City Clerk at (386) 418-6100 x 101 at least 48 hours prior to the public hearing.

NOTICE OF PUBLIC HEARING BEFORE THE CITY COMMISSION OF THE CITY OF ALACHUA, FLORIDA

The City of Alachua City Commission will hold a public hearing on a proposed ordinance on July 11 2016, at 6:30 p.m. The hearing will be held at the City Hall in the James A. Lewis City Commission chambers, located at 15100 N.W. 142nd Terrace, Alachua, Florida.

The ordinance title is as follows:

ORDINANCE 16-07

AN ORDINANCE OF THE CITY OF ALACHUA, FLORIDA, RELATING TO THE AMENDMENT OF THE CITY'S LAND DEVELOPMENT REGULATIONS; AMENDING TABLE 7.2-1, RELATING TO THE ESTABLISHMENT OF CUL-DE-SAC STREET LENGTH STANDARDS FOR THE PD-R ZONING DISTRICT; PROVIDING A REPEALING CLAUSE; PROVIDING SEVERABILITY; AND PROVIDING AN EFFECTIVE DATE.

At the public hearing, all interested parties may appear and be heard with respect to the application. Copies of the application are available for public inspection at the Planning & Community Development Department, 15100 NW 142nd Terrace, Alachua, Florida, on any regular business day between the hours of 7:30 a.m. to 6:00 p.m. Written comments on the application may be sent to the following address: City of Alachua, Planning and Community Development, P.O. Box 9, Alachua, FL 32616. Notice is given pursuant to Section 286.0105, Florida Statutes, that, in order to appeal any decision made at the public hearing, you will need a record of the proceedings, and that, for such purpose, you may need to ensure that a verbatim record of the proceedings is made, which includes the testimony and evidence upon which the appeal is to be based. In accordance with the Americans with Disabilities Act, any persons with a disability requiring reasonable accommodation in order to participate in this meeting should call the City Clerk at (386) 418-6100 x 101 at least 48 hours prior to the public hearing.



City of ALACHUA

NOTICE OF PUBLIC HEARING BEFORE THE PLANNING AND ZONING BOARD OF THE CITY OF ALACHUA, FLORIDA

Notice is hereby given that the Planning and Zoning Board of the City of Alachua will hold a public hearing on July 12, 2016, at 6:30 p.m. The hearing will be held in the James A. Lewis Commission Chambers in City Hall, located at 15100 NW 142nd Terrace, Alachua, Florida, to consider the following: A request by Clay Sweger, AICP, LEED AP, of eda engineers – surveyors – planners, inc., applicant and agent for the AMES/Detrick Truck Company, property owner, for consideration of a Site-Specific Amendment to the Official Zoning Atlas (Rezoning) to amend the Official Zoning Atlas from Light and Warehouse Industrial (ILW) to Commercial Intensive (CI) on a ±9.32 acre subject property, located south of NW US Highway 441 and the Polaris of Gainesville dealership, southwest of Smyder Motor Sales and Equipment, and west of the Turkey Creek Subdivision; consisting of a portion of Tax Parcel Number 05920-001-002; Existing Future Land Use Map (FLUM) Designation: Industrial; Proposed FLUM Designation: Commercial; Existing Zoning: Light and Warehouse Industrial (ILW.)

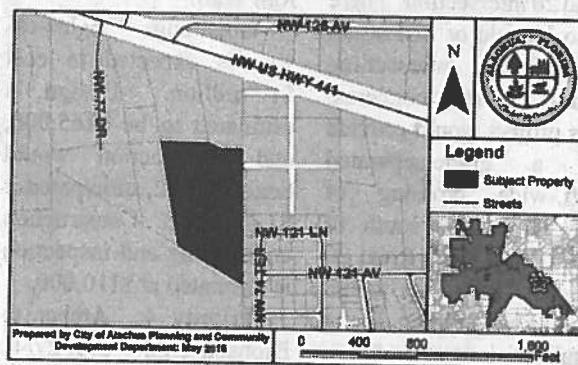

At the public hearing, all interested parties may appear and be heard with respect to the application. Copies of the application are available for public inspection at the Planning and Community Development Department, 15100 NW 142nd Terrace, Alachua, Florida, on any regular business day between the hours of 7:30 a.m. to 6:00 p.m. Written comments on the application may be sent to the following address: City of Alachua, Planning and Community Development, P.O. Box 9, Alachua, FL 32616. Notice is given pursuant to Section 286.0105, Florida Statutes, that, in order to appeal any decision made at the public hearing, you will need a record of the proceedings, and that, for such purpose, you may need to ensure that a verbatim record of the proceedings is made, which includes the testimony and evidence upon which the appeal is to be based. In accordance with the Americans with Disabilities Act, any persons with a disability requiring reasonable accommodation in order to participate in this meeting should call the City Clerk at (386) 418-6100 x 101 at least 48 hours prior to the public hearing.

(Published: Alachua County Today - June 30, 2016)



*Polaris Rezoning mailed
6/27/16 cmx*

THE GOOD LIFE COMMUNITY

NOTICE OF PUBLIC HEARING BEFORE THE PLANNING AND ZONING BOARD OF THE CITY OF ALACHUA, FLORIDA

Notice is hereby given that the Planning and Zoning Board of the City of Alachua will hold a public hearing on July 12, 2016, at 6:30 p.m. The hearing will be held in the James A. Lewis Commission Chambers in City Hall, located at 15100 NW 142nd Terrace, Alachua, Florida, to consider the following: A request by Clay Sweger, AICP, LEED AP, of eda engineers – surveyors – planners, inc., applicant and agent for the AMES/Detrick Truck Company, property owner, for consideration of a Site-Specific Amendment to the Official Zoning Atlas (Rezoning) to amend the Official Zoning Atlas from Light and Warehouse Industrial (ILW) to Commercial Intensive (CI) on a ±9.32 acre subject property, located south of NW US Highway 441 and the Polaris of Gainesville dealership, southwest of Smyder Motor Sales and Equipment, and west of the Turkey Creek Subdivision; consisting of a portion of Tax Parcel Number 05920-001-002; Existing Future Land Use Map (FLUM) Designation: Industrial; Proposed FLUM Designation: Commercial; Existing Zoning: Light and Warehouse Industrial (ILW.)

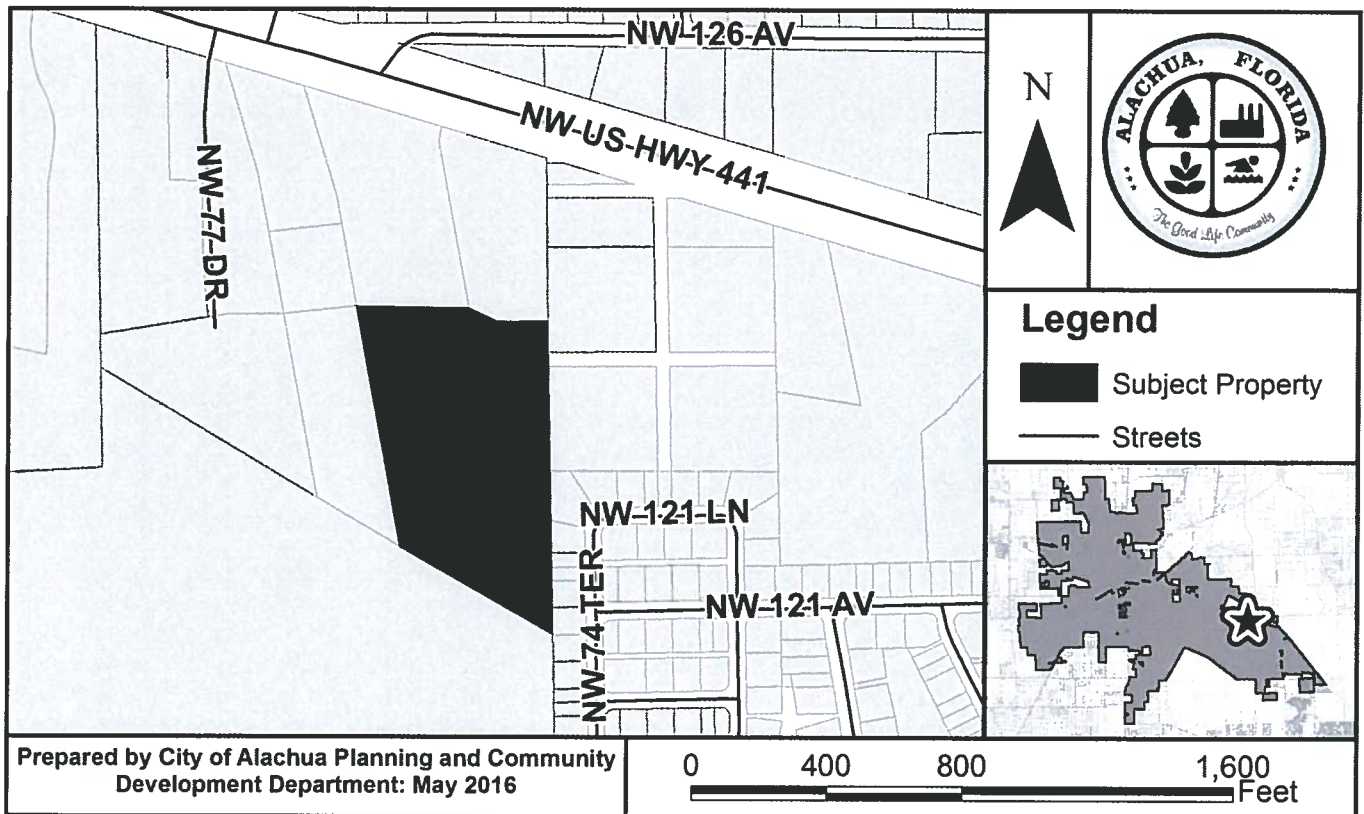

At the public hearing, all interested parties may appear and be heard with respect to the application. Copies of the application are available for public inspection at the Planning and Community Development Department, 15100 NW 142nd Terrace, Alachua, Florida, on any regular business day between the hours of 7:30 a.m. to 6:00 p.m. Written comments on the application may be sent to the following address: City of Alachua, Planning and Community Development, P.O. Box 9, Alachua, FL 32616. Notice is given pursuant to Section 286.0105, Florida Statutes, that, in order to appeal any decision made at the public hearing, you will need a record of the proceedings, and that, for such purpose, you may need to ensure that a verbatim record of the proceedings is made, which includes the testimony and evidence upon which the appeal is to be based. In accordance with the Americans with Disabilities Act, any persons with a disability requiring reasonable accommodation in order to participate in this meeting should call the City Clerk at (386) 418-6100 x 101 at least 48 hours prior to the public hearing.

P.O. Box 9 ♦ Alachua, Florida 32616-0009
Phone: (386) 418-6121 ♦ Fax: (386) 418-6130

05900-903-022

05900-903-030

05920-001-000

JARED SNYDER
12122 NW 74TH TER
Alachua, FL 32615

CROCKER & RODGERS
12310 NW 77TH DR
ALACHUA, FL 32615

05895-001-001

FREELAND & TANNER
12528 NW US HIGHWAY 441
ALACHUA, FL 32615

05955-000-000

FREELAND & TANNER
12528 NW US HIGHWAY 441
ALACHUA, FL 32615

05920-001-002

AMES/DETRICK TRUCK CO
12556 US HIGHWAY 441
ALACHUA, FL 32615-8506

05920-001-003

JOHN A DAVIS
12580 US HIGHWAY 441
ALACHUA, FL 32615

05920-001-007

JOHN A DAVIS
12580 US HIGHWAY 441
ALACHUA, FL 32615-8505

05900-912-007

ALICE P ROARK
14822 NW STATE ROAD 45
HIGH SPRINGS, FL 32643-3315

05900-913-009

THOMAS L POURCHOT
17881 NW 105TH TER
ALACHUA, FL 32615-5614

05860-000-000

MARLENE LEDDICK
22 S ADAMS ST APT 305
DENVER, CO 80209-2913

05859-003-000

HELENA CHEMICAL CO
225 SCHILLING BLVD STE 300
COLLIERVILLE, TN 38017

05900-903-026

SUSAN JANE WIGGLESWORTH
231 TURKEY CREEK
ALACHUA, FL 32615

05920-001-006

HAMMOCK GROUP VENTURE LLC
2406 NW 43RD ST
GAINESVILLE, FL 32606

05894-000-000

STEPHANIE TRUSTEE HARRINGTON
24113 NW OLD BELLAMY RD
HIGH SPRINGS, FL 32643

05920-000-000

RAJAE LLC
2573 NW 140TH TER
GAINESVILLE, FL 32606-9303

05900-903-040

TED WESEMAN BUILDER INC
2705 NW 27TH PL
GAINESVILLE, FL 32605-2854

05900-903-041

TED WESEMAN BUILDER INC
2705 NW 27TH PL
GAINESVILLE, FL 32605-2854

05900-904-004

BOEHLER & RIESER
292 TURKEY CREEK
ALACHUA, FL 32615

05920-002-000

DONALD WESLEY TRUSTEE
MCBRIDE
327 TURKEY CREEK
ALACHUA, FL 32615

05920-001-004

MCB OIL COMPANY
327 TURKEY CREEK
ALACHUA, FL 32615

05900-903-044

THAD W BEAVERS
348 TURKEY CRK
ALACHUA, FL 32615-9367

05859-004-000

GEORGE A MCDAVID
3722 NW 33RD TER
GAINESVILLE, FL 32605-2182

05900-913-005

CHOONG H KIM
409 TURKEY CREEK
ALACHUA, FL 32615

05900-903-032

JAMES M WEIST
413 TURKEY CREEK
ALACHUA, FL 32615

05900-903-038

GARLAND & KELLER
416 TURKEY CREEK
ALACHUA, FL 32615

05900-904-012

GLEN A BLANCHARD
418 TURKEY CREEK
ALACHUA, FL 32615

05900-903-042

DEMPSEY & SANTOS
419 TURKEY CREEK
ALACHUA, FL 32615

05900-903-036

ADAM DAUBE
426 TURKEY CREEK
ALACHUA, FL 32615

05900-912-005

LYDIA MARIE ROMIG
434 TURKEY CREEK
ALACHUA, FL 32615

05900-913-010
JASON DAVIS
4350 SW WACHOOTA RD
MICANOPY, FL 32667-5260

05900-903-047
THOMAS G CROW
464 TURKEY CREEK
ALACHUA, FL 32615

05859-007-000
DOUGLAS JR & KIRKPATRICK JR
4710 SW 103RD WAY
GAINESVILLE, FL 32608-7180

05900-913-007
ALBA R VALLE
472 TUREKY CREEK
ALACHUA, FL 32615

05900-903-018
JAMES B GLASS
500 TURKEY CREEK
ALACHUA, FL 32615

05900-904-006
SUSAN J ANDREWS
501 TURKEY CREEK
ALACHUA, FL 32615

05900-903-024
AMANDA L CUMMINGS
502 TURKEY CREEK
ALACHUA, FL 32615

05900-913-015
JAIME TANG
517 TURKEY CREEK
ALACHUA, FL 32615

05900-904-015
LINDA A MCKNEW
540 TURKEY CREEK
ALACHUA, FL 32615

05920-001-005
LARRY D JONES
5402 NW 166TH AVE
GAINESVILLE, FL 32653-7625

05900-904-008
CHARLES MATTHEW PINKOSON
575 TURKEY CREEK
ALACHUA, FL 32615

05900-912-009
SUSAN D LITTELL
625 TURKEY CREEK
ALACHUA, FL 32615

05900-903-028
ERIK WORTHMANN
630 TURKEY CREEK
ALACHUA, FL 32615-9308

05900-904-013
NOEL A DELGADO
641 TURKEY CREEK
ALACHUA, FL 32615

05900-903-034
SHANE DEREK PONTZ
645 TURKEY CREEK
Alachua, FL 32615

05900-912-010
JOHN P MILLER
73 TURKEY CREEK
ALACHUA, FL 32615

05900-913-003
JASON CHAN
744 OAKWOOD CT
WESTMONT, IL 60559-1221

05900-903-020
SORIN FRATILA
7448 NW 121ST LN
ALACHUA, FL 32615

05900-903-021
SORIN FRATILA
7448 NW 121ST LN
ALACHUA, FL 32615

05861-000-000
JUDITH HARRELL
7518 NW 126TH AVE
ALACHUA, FL 32615-6310

05861-003-000
GLENN A HARRELL
7518 NW 126TH AVE
ALACHUA, FL 32615-6310

05859-001-000
JOSHUA Q MYERS
7614 NW 126TH AVE
ALACHUA, FL 32615

05900-904-010
STEFANI NIXON
888 TURKEY CREEK
ALACHUA, FL 32615

05900-913-013
VICKI LEE TRUSTEE CARNEY
91 TURKEY CREEK
ALACHUA, FL 32615

05894-001-000
C R SMYDER
PO BOX 842
ALACHUA, FL 32616-0842

Easy Peel® Labels
Use Avery® Template 5160®

▲
Feed Paper

Bend along line to
expose Pop-Up Edge™

 **AVERY® 8460™**

Dr. Lee A. Niblock
Alachua County Manager
12 SE 1st Street
Gainesville, FL 32601

Tamara Robbins
PO Box 2317
Alachua, FL 32616

Antoinette Endelicato
5562 NW 93rd Avenue
Gainesville, FL 32653

Dan Rhine
288 Turkey Creek
Alachua, FL 32615

Tom Gorman
9210 NW 59th Street
Alachua, FL 32653

Richard Gorman
5716 NW 93rd Avenue Alachua, FL
32653

Peggy Arnold
410 Turkey Creek
Alachua, FL 32615

David Forest
23 Turkey Creek
Alachua, FL 32615

John Tingue
333 Turkey Creek
Alachua, FL 32615

President TCMOA
1000 Turkey Creek
Alachua, FL 32615

Linda Dixon, AICP
Assistant Director Planning
PO Box 115050
Gainesville, FL 32611

Craig Parenteau
FL Depart. of Environmental Protection
4801 Camp Ranch Road
Gainesville, FL 32641

Jeannette Hinsdale
P.O. Box 1156
Alachua, FL 32616

Lynn Coullias
7406 NW 126th Ave
Alachua, FL 32615

Lynda Coon
7216 NW 126 Avenue
Alachua, FL 32615

AFFIDAVIT FOR POSTED LAND USE SIGN

I Melissa Watson, POSTED THE LAND USE
(name)
SIGN ON 6.23.16 FOR THE Polaris Rezoning
(date) (state type of action and project name)
LAND USE ACTION.

AS PER ARTICLE 2.2.9 D OF THE LAND DEVELOPMENT REGULATIONS.

THIS WILL BE INCLUDED IN THE STAFF REPORT.

Melissa Watson
(signature)

2
(number of signs)