

CAMPAIGN 2016

Trump's primary playbook leading him out of bounds

By Jill Colvin, Steve Peoples and Josh Lederman
The Associated Press



Republican presidential candidate Donald Trump speaks during a campaign rally Wednesday in Abingdon, Va. EVAN VUCCI/THE ASSOCIATED PRESS

ABINGDON, Va. — In the 2016 presidential campaign, it's long been an article of faith: The rules of political gravity don't apply to Donald Trump.

Maybe now they do. After winning state after state while bouncing between controversies in the GOP primaries, Trump is still stumbling on the stump. His latest unforced mishap: an off-hand remark that critics quickly slammed as a suggestion that gun-rights backers should take a literal shot at Hillary Clinton should she win the White House.

But rather than continuing to float above the criticism, Trump is losing ground in preference polls and alienating prominent Republicans by the day. Even some of his supporters worry Trump's lack of a filter is hurting his White House chances, a concern they say has only grown in recent weeks.

"You'd think it would be pretty simple for a grown man to keep his mouth shut sometimes," said Seth Walls, 18, a landscaper from Whitetop, Virginia, who attended his first Trump rally on Wednesday. "These Twitter rants and things he does in the media, I definitely think it's hurting him."

With early voting set to begin next month in several states, time is running short for Trump to make a major change in his approach. As he did in the primaries, the billionaire continues to

dismiss guidance from senior Republicans, in and out of his campaign. He has yet to return to running television ads even as Clinton fills the airwaves, and leads a campaign team that remains badly understaffed.

But it's not a surprise the latest flap springs from a Trump rally, the centerpiece of his campaign. Trump revels in the energy provided by the crowd, made up mostly of white, working-class voters, as he delivers hour-long speeches largely without notes — and never with a teleprompter.

Trump rode such events to great success in the primaries, when each of Trump's eyebrow-raising statements — including a moment when he appeared to mock a disabled journalist and his repeated retelling of a debunked story about U.S. soldiers dipping bullets in

"You'd think it would be pretty simple for a grown man to keep his mouth shut sometimes. These Twitter rants and things he does in the media, I definitely think it's hurting him."

—Seth Walls, 18, a landscaper from Whitetop, Virginia

pig's blood — earned him a tremendous amount of attention and carried little electoral consequence.

"He tries to amp up the crowd, which he's very good at," said former Trump adviser Barry Bennett, who said the rallies may be large, but don't represent the broader coalition of voters who typically decide general elections. "The problem is there's a television audience watching at home as well. They have a hard time understanding what he's doing."

Among that more diverse and moderate general electorate, polls find Trump trailing Clinton nationally and in most battleground states. The

Democratic nominee's emerging advantage comes at a key moment after both political conventions are over, when the state of a presidential race tends to stabilize and leads are difficult to surmount.

"He can't seem to put himself in a general election mindset," said Stephan Thompson, an aide to Republican Gov. Scott Walker in Wisconsin, where a poll released Wednesday puts Trump 15 points behind.

After the Democratic convention, Trump sparked days of outrage across the political spectrum by repeatedly criticizing a Muslim family whose son died

fighting the war in Iraq. He further alarmed Republican leaders when he declared he wasn't ready to endorse House Speaker Paul Ryan — a stance he later reversed.

Frustrated GOP officials responded by calling financier Carl Icahn to help persuade Trump to shift his approach. Some were pleased with the results, pointing to Trump's economic address on Monday in Detroit and the restraint he showed in the face of repeated interruptions by protesters.

The next day, however, Trump inflamed matters anew — and overshadowed a negative report about Clinton's use of a private email account as secretary of state — by going off script at a rally in North Carolina. Trump said that if Clinton were elected president, there would be "nothing you can do" to stop her from stacking the Supreme Court with anti-gun justices.

He added ambiguously: "Although, the Second Amendment people, maybe there is, I don't know. But I'll tell you what: that will be a horrible day."

Democrats pounced, immediately slamming Trump for seeming to suggest Clinton should be shot. Trump was quick to blame the media for that reaction, responding with a blunt "Give me a break!" At an Iowa rally Wednesday, Clinton said Trump's remark was a "casual inciting of violence" that shows he's unfit to be president.

Former House Speaker

Newt Gingrich denounced the reaction to Trump's comment as "absurdity."

"He's better than he was a week ago — I think he's learned some very painful lessons," Gingrich said, predicting Trump will "continue to grow" as a candidate.

Trump and his supporters have pointed to positive signs, including a significant boost in his at-first-tepid fundraising, bringing in nearly as much last month as Clinton. And while he is now lagging in polling, he remains competitive, despite having spent nothing on television ads.

And on Wednesday, Trump didn't mention the Second Amendment flare-up. He was back on message in a speech largely focused on the his safer talking points, like boosting the coal industry. Lisa Bolling, an elementary school teacher from Abingdon, Virginia, who attended Trump's event, said his many stumbles can only help him.

"I really don't think it will affect his chances, because I think what America's looking for now is honesty and straight-forwardness," Bolling said. "It's a refreshing way to speak and do things that he's bringing to this campaign, and I believe in the long run, it will be beneficial to him."

—Colvin reported from Jersey City, New Jersey. Associated Press writers Thomas Beaumont, Julie Bykovicz, Lisa Lerer, Emily Swanson and Catherine Lucey contributed to this report.

Everything Gainesville
gainesville.com

PUBLIC NOTICE OF ENACTMENT OF AN ORDINANCE OF THE CITY OF ALACHUA, FLORIDA

Notice is hereby given that the City Commission of the City of Alachua will hold a public hearing on a proposed ordinance. The hearing will be held on August 22, 2016, at 6:30 p.m., in the James A. Lewis Commission Chambers in City Hall, located at 15100 NW 142nd Terrace, Alachua, Florida.

The ordinance title is as follows:

ORDINANCE 16-14

AN ORDINANCE OF THE CITY OF ALACHUA, FLORIDA, RELATING TO THE AMENDMENT OF THE OFFICIAL ZONING ATLAS; AMENDING THE OFFICIAL ZONING ATLAS FROM LIGHT AND WAREHOUSE INDUSTRIAL (ILW) TO COMMERCIAL INTENSIVE (CI) ON APPROXIMATELY 9.32 ACRES; SOUTH OF NORTHWEST US HIGHWAY 441 AND POLARIS OF GAINESVILLE, AND WEST OF THE TURKEY CREEK SUBDIVISION; A PORTION OF TAX PARCEL NUMBER 05920-001-002; REPEALING ALL ORDINANCES IN CONFLICT; PROVIDING SEVERABILITY; AND PROVIDING AN EFFECTIVE DATE.

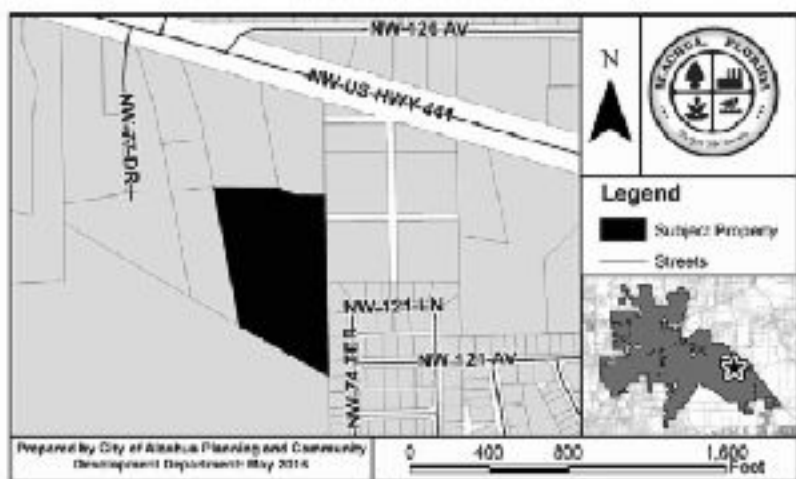

At the public hearing, all interested parties may appear and be heard with respect to the proposed ordinance. Copies of the proposed ordinance and related materials are available for public inspection at the Planning and Community Development Department, 15100 NW 142nd Terrace, on any regular business day between the hours of 7:30 a.m. to 6:00 p.m. Written comments on the proposed ordinance may be sent to the following address: City of Alachua, Planning and Community Development, P.O. Box 9, Alachua, FL 32616. Notice is given pursuant to Section 286.0105, Florida Statutes, that, in order to appeal any decision made at the public hearing, you will need a record of the proceedings, and that, for such purpose, you may need to ensure that a verbatim record of the proceedings is made, which includes the testimony and evidence upon which the appeal is to be based. In accordance with the Americans with Disabilities Act, any persons with a disability requiring reasonable accommodation in order to participate in this meeting should call the City Clerk at (386) 418-6100 x 101 at least 48 hours prior to the public hearing.

PUBLIC NOTICE OF ENACTMENT OF AN ORDINANCE OF THE CITY OF ALACHUA, FLORIDA

Notice is hereby given that the City Commission of the City of Alachua will hold a public hearing on a proposed ordinance. The hearing will be held on August 22, 2016 at 6:30 PM in the James A. Lewis Commission Chambers in City Hall, located at 15100 NW 142nd Terrace, Alachua, Florida.

The ordinance title is as follows:

ORDINANCE 16-10

AN ORDINANCE OF THE CITY OF ALACHUA, FLORIDA, RELATING TO THE SMALL SCALE AMENDMENT OF THE CITY OF ALACHUA COMPREHENSIVE PLAN FUTURE LAND USE MAP; AMENDING THE FUTURE LAND USE MAP FROM HIGH DENSITY RESIDENTIAL AND COMMUNITY COMMERCIAL TO COMMUNITY COMMERCIAL AND HIGH DENSITY RESIDENTIAL ON APPROXIMATELY 5.3 ACRES, LOCATED NORTH OF ONE 51 PLACE APARTMENTS AND WYNDSWEEP HILLS SUBDIVISION, SOUTH OF PARK VEGETARIANA, WEST OF THE ALACHUA PROFESSIONAL PLAZA, AND NEAR THE WESTERN TERMINUS OF NW 151 BOULEVARD; TAX PARCEL NUMBER 03869-006-000, AND PORTIONS OF 03869-007-000 AND 03869-009-000; REPEALING ALL ORDINANCES IN CONFLICT; PROVIDING SEVERABILITY; AND PROVIDING AN EFFECTIVE DATE.

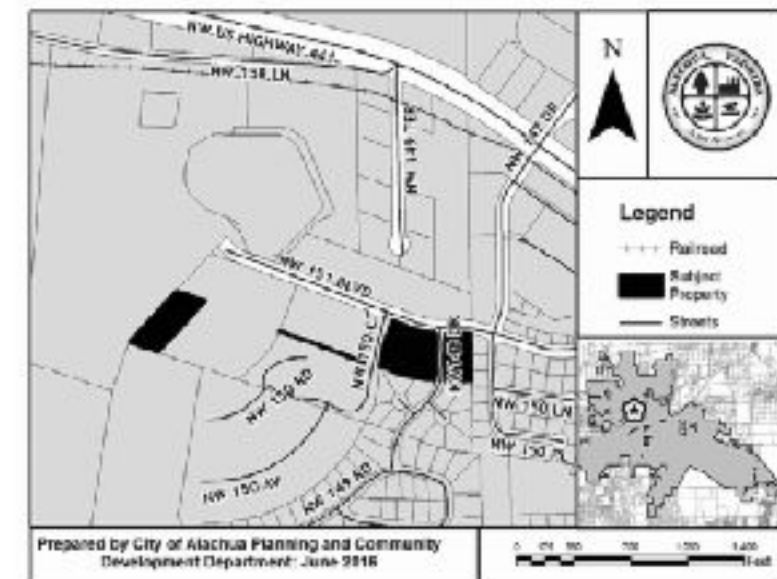

At the public hearing, all interested parties may appear and be heard with respect to the application. Copies of the application are available for public inspection at the Planning and Community Development Department, 15100 NW 142nd Terrace, Alachua, Florida, on any regular business day between the hours of 7:30 a.m. to 6:00 p.m. Written comments on the application may be sent to the following address: City of Alachua, Planning and Community Development, P.O. Box 9, Alachua, FL 32616. Notice is given pursuant to Section 286.0105, Florida Statutes, that, in order to appeal any decision made at the public hearing, you will need a record of the proceedings, and that, for such purpose, you may need to ensure that a verbatim record of the proceedings is made, which includes the testimony and evidence upon which the appeal is to be based. In accordance with the Americans with Disabilities Act, any persons with a disability requiring reasonable accommodation in order to participate in this meeting should call the City Clerk at (386) 418-6100 x 101 at least 48 hours prior to the public hearing.

PUBLIC NOTICE OF ENACTMENT OF AN ORDINANCE OF THE CITY OF ALACHUA, FLORIDA

Notice is hereby given that the City Commission of the City of Alachua will hold a public hearing on a proposed ordinance. The hearing will be held on August 22, 2016 at 6:30 PM in the James A. Lewis Commission Chambers in City Hall, located at 15100 NW 142nd Terrace, Alachua, Florida.

The ordinance title is as follows:

ORDINANCE 16-11

AN ORDINANCE OF THE CITY OF ALACHUA, FLORIDA, RELATING TO THE AMENDMENT OF THE OFFICIAL ZONING ATLAS; AMENDING THE OFFICIAL ZONING ATLAS FROM PLANNED DEVELOPMENT-COMMERCIAL (PD-COMM) TO COMMUNITY COMMERCIAL (CC) AND RESIDENTIAL MULTIPLE FAMILY-15 (RMF-15) ON APPROXIMATELY 18 ACRES; NORTH OF ONE 51 PLACE APARTMENTS AND WYNDSWEEP HILLS SUBDIVISION, SOUTH OF PARK VEGETARIANA, WEST OF THE ALACHUA PROFESSIONAL PLAZA, AND NEAR THE WESTERN TERMINUS OF NW 151 BOULEVARD; TAX PARCEL NUMBERS 03869-006-000, 03869-007-000 AND 03869-009-000; REPEALING ALL ORDINANCES IN CONFLICT; PROVIDING SEVERABILITY; AND PROVIDING AN EFFECTIVE DATE.

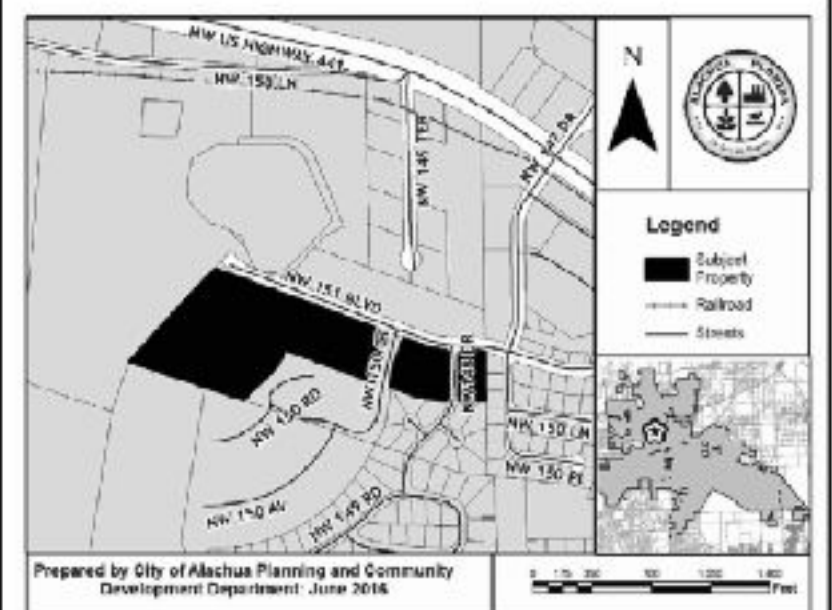

At the public hearing, all interested parties may appear and be heard with respect to the application. Copies of the application are available for public inspection at the Planning and Community Development Department, 15100 NW 142nd Terrace, Alachua, Florida, on any regular business day between the hours of 7:30 a.m. to 6:00 p.m. Written comments on the application may be sent to the following address: City of Alachua, Planning and Community Development, P.O. Box 9, Alachua, FL 32616. Notice is given pursuant to Section 286.0105, Florida Statutes, that, in order to appeal any decision made at the public hearing, you will need a record of the proceedings, and that, for such purpose, you may need to ensure that a verbatim record of the proceedings is made, which includes the testimony and evidence upon which the appeal is to be based. In accordance with the Americans with Disabilities Act, any persons with a disability requiring reasonable accommodation in order to participate in this meeting should call the City Clerk at (386) 418-6100 x 101 at least 48 hours prior to the public hearing.



City of ALACHUA

PUBLIC NOTICE OF ENACTMENT OF AN ORDINANCE OF THE CITY OF ALACHUA, FLORIDA

Notice is hereby given that the City Commission of the City of Alachua will hold a public hearing on a proposed ordinance. The hearing will be held on August 22, 2016, at 6:30 p.m., in the James A. Lewis Commission Chambers in City Hall, located at 15100 NW 142nd Terrace, Alachua, Florida.

The ordinance title is as follows:

ORDINANCE 16-14

AN ORDINANCE OF THE CITY OF ALACHUA, FLORIDA, RELATING TO THE AMENDMENT OF THE OFFICIAL ZONING ATLAS; AMENDING THE OFFICIAL ZONING ATLAS FROM LIGHT AND WAREHOUSE INDUSTRIAL (ILW) TO COMMERCIAL INTENSIVE (CI) ON APPROXIMATELY 9.32 ACRES; SOUTH OF NORTHWEST US HIGHWAY 441 AND POLARIS OF GAINESVILLE, AND WEST OF THE TURKEY CREEK SUBDIVISION; A PORTION OF TAX PARCEL NUMBER 05920-001-002; REPEALING ALL ORDINANCES IN CONFLICT; PROVIDING SEVERABILITY; AND PROVIDING AN EFFECTIVE DATE.

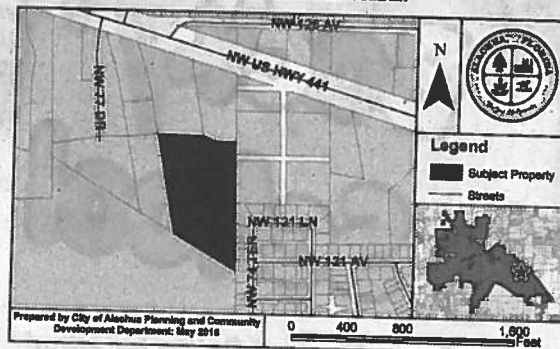

At the public hearing, all interested parties may appear and be heard with respect to the proposed ordinance. Copies of the proposed ordinance and related materials are available for public inspection at the Planning and Community Development Department, 15100 NW 142nd Terrace, on any regular business day between the hours of 7:30 a.m. to 6:00 p.m. Written comments on the proposed ordinance may be sent to the following address: City of Alachua, Planning and Community Development, P.O. Box 9, Alachua, FL 32616. Notice is given pursuant to Section 286.0105, Florida Statutes, that, in order to appeal any decision made at the public hearing, you will need a record of the proceedings, and that, for such purpose, you may need to ensure that a verbatim record of the proceedings is made, which includes the testimony and evidence upon which the appeal is to be based. In accordance with the Americans with Disabilities Act, any persons with a disability requiring reasonable accommodation in order to participate in this meeting should call the City Clerk at (386) 418-6100 x 101 at least 48 hours prior to the public hearing.

(Published: Alachua County Today - August 11, 2016)

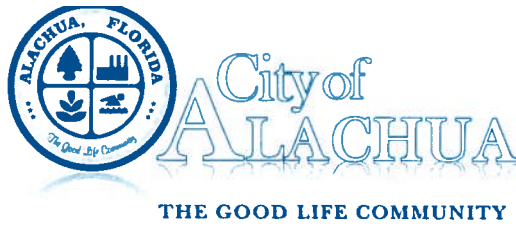

Mailed 8/9/16 CMJ

PUBLIC NOTICE OF ENACTMENT OF AN ORDINANCE OF THE CITY OF ALACHUA, FLORIDA

Notice is hereby given that the City Commission of the City of Alachua will hold a public hearing on a proposed ordinance. The hearing will be held on August 22, 2016, at 6:30 p.m., in the James A. Lewis Commission Chambers in City Hall, located at 15100 NW 142nd Terrace, Alachua, Florida.

The ordinance title is as follows:

ORDINANCE 16-14

AN ORDINANCE OF THE CITY OF ALACHUA, FLORIDA, RELATING TO THE AMENDMENT OF THE OFFICIAL ZONING ATLAS; AMENDING THE OFFICIAL ZONING ATLAS FROM LIGHT AND WAREHOUSE INDUSTRIAL (ILW) TO COMMERCIAL INTENSIVE (CI) ON APPROXIMATELY 9.32 ACRES; SOUTH OF NORTHWEST US HIGHWAY 441 AND POLARIS OF GAINESVILLE, AND WEST OF THE TURKEY CREEK SUBDIVISION; A PORTION OF TAX PARCEL NUMBER 05920-001-002; REPEALING ALL ORDINANCES IN CONFLICT; PROVIDING SEVERABILITY; AND PROVIDING AN EFFECTIVE DATE.

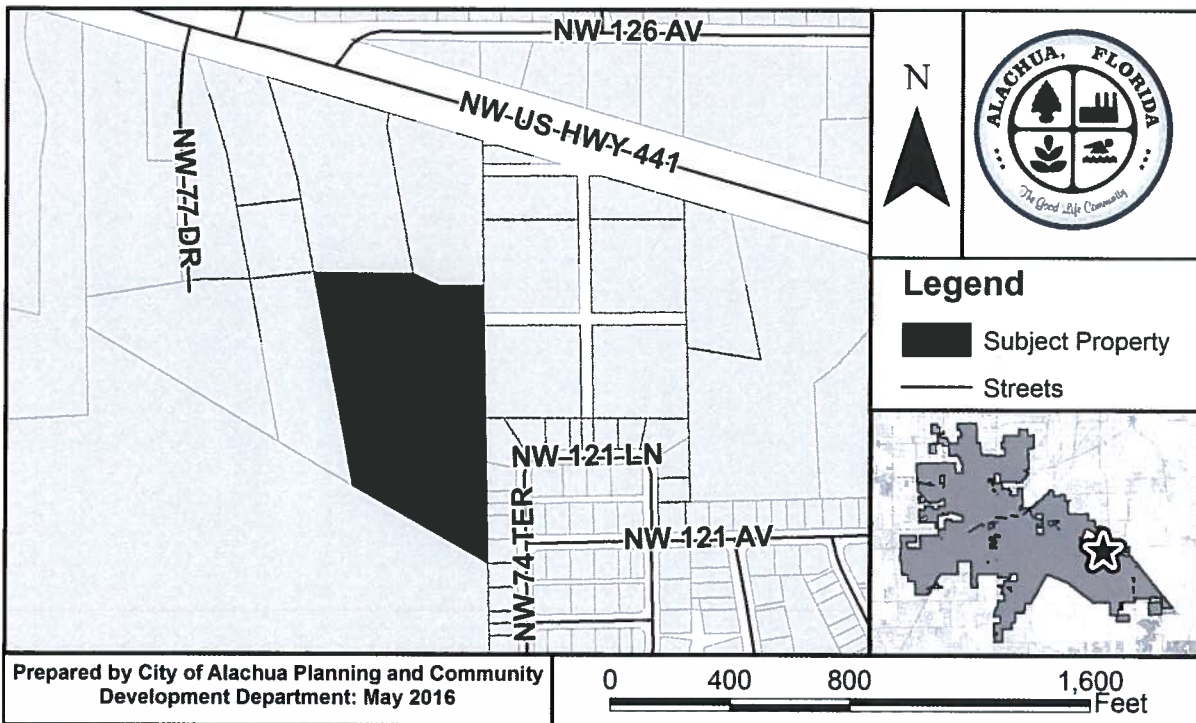

At the public hearing, all interested parties may appear and be heard with respect to the proposed ordinance. Copies of the proposed ordinance and related materials are available for public inspection at the Planning and Community Development Department, 15100 NW 142nd Terrace, on any regular business day between the hours of 7:30 a.m. to 6:00 p.m. Written comments on the proposed ordinance may be sent to the following address: City of Alachua, Planning and Community Development, P.O. Box 9, Alachua, FL 32616. Notice is given pursuant to Section 286.0105, Florida Statutes, that, in order to appeal any decision made at the public hearing, you will need a record of the proceedings, and that, for such purpose, you may need to ensure that a verbatim record of the proceedings is made, which includes the testimony and evidence upon which the appeal is to be based. In accordance with the Americans with Disabilities Act, any persons with a disability requiring reasonable accommodation in order to participate in this meeting should call the City Clerk at (386) 418-6100 x 101 at least 48 hours prior to the public hearing.

P.O. Box 9 ♦ Alachua, Florida 32616-0009
Phone: (386) 418-6121 ♦ Fax: (386) 418-6130

05900-903-022

05900-903-030
JARED SNYDER
12122 NW 74TH TER
ALACHUA, FL 32615

05920-001-000
CROCKER & RODGERS
12310 NW 77TH DR
ALACHUA, FL 32615

05895-001-001
FREELAND & TANNER
12528 NW US HIGHWAY 441
ALACHUA, FL 32615

05955-000-000
FREELAND & TANNER
12528 NW US HIGHWAY 441
ALACHUA, FL 32615

05920-001-002
AMES/DETRICK TRUCK CO
12556 US HIGHWAY 441
ALACHUA, FL 32615-8506

05920-001-003
JOHN A DAVIS
12580 US HIGHWAY 441
ALACHUA, FL 32615

05920-001-007
JOHN A DAVIS
12580 US HIGHWAY 441
ALACHUA, FL 32615-8505

05900-912-007
ALICE P ROARK
14822 NW STATE ROAD 45
HIGH SPRINGS, FL 32643-3315

05900-913-009
THOMAS L POURCHOT
17881 NW 105TH TER
ALACHUA, FL 32615-5614

05860-000-000
MARLENE LEDDICK
22 S ADAMS ST APT 305
DENVER, CO 80209-2913

05859-003-000
HELENA CHEMICAL CO
225 SCHILLING BLVD STE 300
COLLIERVILLE, TN 38017

05900-903-026
SUSAN JANE WIGGLESWORTH
231 TURKEY CREEK
ALACHUA, FL 32615

05920-001-006
HAMMOCK GROUP VENTURE LLC
2406 NW 43RD ST
GAINESVILLE, FL 32606

05894-000-000
STEPHANIE TRUSTEE HARRINGTON
24113 NW OLD BELLAMY RD
HIGH SPRINGS, FL 32643

05920-000-000
RAJAE LLC
2573 NW 140TH TER
GAINESVILLE, FL 32606-9303

05900-903-040
TED WESEMAN BUILDER INC
2705 NW 27TH PL
GAINESVILLE, FL 32605-2854

05900-903-041
TED WESEMAN BUILDER INC
2705 NW 27TH PL
GAINESVILLE, FL 32605-2854

05900-904-004
BOEHLER & RIESER
292 TURKEY CREEK
ALACHUA, FL 32615

05920-002-000
DONALD WESLEY TRUSTEE
MCBRIDE
327 TURKEY CREEK
ALACHUA, FL 32615

05920-001-004
MCB OIL COMPANY
327 TURKEY CREEK
ALACHUA, FL 32615

05900-903-044
THAD W BEAVERS
348 TURKEY CRK
ALACHUA, FL 32615-9367

05859-004-000
GEORGE A MCDAVID
3722 NW 33RD TER
GAINESVILLE, FL 32605-2182

05900-913-005
CHOONG H KIM
409 TURKEY CREEK
ALACHUA, FL 32615

05900-903-032
JAMES M WEIST
413 TURKEY CREEK
ALACHUA, FL 32615

05900-903-038
GARLAND & KELLER
416 TURKEY CREEK
ALACHUA, FL 32615

05900-904-012
GLEN A BLANCHARD
418 TURKEY CREEK
ALACHUA, FL 32615

05900-903-042
DEMPSEY & SANTOS
419 TURKEY CREEK
ALACHUA, FL 32615

05900-903-036
ADAM DAUBE
426 TURKEY CREEK
ALACHUA, FL 32615

05900-912-005
LYDIA MARIE ROMIG
434 TURKEY CREEK
ALACHUA, FL 32615

05900-913-010
JASON DAVIS
4350 SW WACHOOTA RD
MICANOPY, FL 32667-5260

05900-903-047
THOMAS G CROW
464 TURKEY CREEK
ALACHUA, FL 32615

05859-007-000
DOUGLAS JR & KIRKPATRICK JR
4710 SW 103RD WAY
GAINESVILLE, FL 32608-7180

05900-913-007
ALBA R VALLE
472 TUREKY CREEK
ALACHUA, FL 32615

05900-903-018
JAMES B GLASS
500 TURKEY CREEK
ALACHUA, FL 32615

05900-904-006
SUSAN J ANDREWS
501 TURKEY CREEK
ALACHUA, FL 32615

05900-903-024
AMANDA L CUMMINGS
502 TURKEY CREEK
ALACHUA, FL 32615

05900-913-015
JAIME TANG
517 TURKEY CREEK
ALACHUA, FL 32615

05900-904-015
LINDA A MCKNEW
540 TURKEY CREEK
ALACHUA, FL 32615

05920-001-005
LARRY D JONES
5402 NW 166TH AVE
GAINESVILLE, FL 32653-7625

05900-904-008
CHARLES MATTHEW PINKOSON
575 TURKEY CREEK
ALACHUA, FL 32615

05900-912-009
SUSAN D LITTELL
625 TURKEY CREEK
ALACHUA, FL 32615

05900-903-028
ERIK WORTHMANN
630 TURKEY CREEK
ALACHUA, FL 32615-9308

05900-904-013
NOEL A DELGADO
641 TURKEY CREEK
ALACHUA, FL 32615

05900-903-034
SHANE DEREK PONTZ
645 TURKEY CREEK
Alachua, FL 32615

05900-912-010
JOHN P MILLER
73 TURKEY CREEK
ALACHUA, FL 32615

05900-913-003
JASON CHAN
744 OAKWOOD CT
WESTMONT, IL 60559-1221

05900-903-020
SORIN FRATILA
7448 NW 121ST LN
ALACHUA, FL 32615

05900-903-021
SORIN FRATILA
7448 NW 121ST LN
ALACHUA, FL 32615

05861-000-000
JUDITH HARRELL
7518 NW 126TH AVE
ALACHUA, FL 32615-6310

05861-003-000
GLENN A HARRELL
7518 NW 126TH AVE
ALACHUA, FL 32615-6310

05859-001-000
JOSHUA Q MYERS
7614 NW 126TH AVE
ALACHUA, FL 32615

05900-904-010
STEFANI NIXON
888 TURKEY CREEK
ALACHUA, FL 32615

05900-913-013
VICKI LEE TRUSTEE CARNEY
91 TURKEY CREEK
ALACHUA, FL 32615

05894-001-000
C R SMYDER
PO BOX 842
ALACHUA, FL 32616-0842

Alachua County Manager
12 SE 1st Street
Gainesville, FL 32601

PO Box 2317
Alachua, FL 32616

5562 NW 93rd Avenue
Gainesville, FL 32653

Dan Rhine
288 Turkey Creek
Alachua, FL 32615

Tom Gorman
9210 NW 59th Street
Alachua, FL 32653

Richard Gorman
5716 NW 93rd Avenue Alachua, FL
32653

Peggy Arnold
410 Turkey Creek
Alachua, FL 32615

David Forest
23 Turkey Creek
Alachua, FL 32615

John Tingue
333 Turkey Creek
Alachua, FL 32615

President TCMOA
1000 Turkey Creek
Alachua, FL 32615

Linda Dixon, AICP
Assistant Director Planning
PO Box 115050
Gainesville, FL 32611

Craig Parenteau
FL Depart. of Environmental Protection
4801 Camp Ranch Road
Gainesville, FL 32641

Jeannette Hinsdale
P.O. Box 1156
Alachua, FL 32616

Lynn Coullias
7406 NW 126th Ave
Alachua, FL 32615

Lynda Coon
7216 NW 126 Avenue
Alachua, FL 32615

Étiquettes faciles à peler
Utilisez le gabarit AVERY® 5160®

▲
Sens de
chargement

Repliez à la hachure afin de
révéler le rebord Pop-Up™

www.avery.com
1-800-GO-AVERY

AFFIDAVIT FOR POSTED LAND USE SIGN

I Melissa Watson, POSTED THE LAND USE
(name)
SIGN ON 8-9-16 FOR THE Polaris Rezoning-ORD 16-14-8/22/16
(date) (state type of action and project name) City Commission
LAND USE ACTION.

AS PER ARTICLE 2.2.9 D OF THE LAND DEVELOPMENT REGULATIONS.

THIS WILL BE INCLUDED IN THE STAFF REPORT.

Melissa Watson
(signature)

2
(number of signs)