

Regulators to look at need for two power plants

Bu Jim Saunders
The News Service of Florida

TALLAHASSEE — State regulators will hear arguments in March on proposals for two new power plants in Putnam and Pasco counties that would supply electricity to customers of electric cooperatives throughout Florida.

Filings last week with the state Public Service Commission show a two-pronged strategy by Seminole Electric Cooperative, Inc., to help meet future power needs. Seminole, which provides wholesale power to cooperatives throughout the state, wants to build a 1,050-megawatt plant at its already-existing site in Putnam County and contract for electricity generated at a 573-megawatt plant in Pasco County that would be owned by a subsidiary of General Electric Co.

The Public Service Commission has scheduled a hearing March 21 on key regulatory approvals — known as seeking determinations of need — for the projects.

Tampa-based Seminole Electric Cooperative also has a proposal pending in the Florida Division of Administrative Hearings as it seeks a separate regulatory approval for the Putnam County project under a state power-plant siting law. Both new plants would be fueled with natural gas, and the strategy also includes shutting down a smaller coal-fired plant at the Putnam site north of Palatka.

In the petitions filed with the Public Service Commission, Seminole said it has a “significant need” for additional power in the 2021 and 2022 timeframe. At least in part, that stems from the expiration of agreements to purchase electricity from other sources.

The new Pasco County plant, which would be adjacent to the existing Shady Hills power plant, would start operating

Dec. 1, 2021, according to the filings. Seminole would have a 30-year contract to buy electricity produced at the plant.

Seminole, meanwhile, would start operating the Putnam County plant on Dec. 1, 2022, the filings show.

If the determinations of need are denied, Seminole said it would have to continue operating the coal-fired plant in Putnam County and would need to buy power at a higher cost.

“Non-approval would mean that Seminole’s members (electric cooperatives throughout the state) and the members’ retail member-consumers would be denied the most cost-effective, risk managed power supply solution,” the petitions said.

Seminole’s members are Central Florida Electric Cooperative, Inc.; Clay Electric Cooperative, Inc.; Glades Electric Cooperative, Inc.; Peace River Electric Cooperative, Inc.; SECO Energy; Suwannee Valley Electric Cooperative, Inc.; Talquin Electric Cooperative, Inc.; Tri-County Electric Cooperative, Inc.; and Withlacoochee River Electric Cooperative, Inc.

The Seminole proposals are part of a broader move in the state’s utility industry to build natural-gas plants and shut down older facilities. Florida Power & Light, for example, is seeking approvals for a new Dania Beach plant and has undertaken projects in recent years at Cape Canaveral, Riviera Beach, Port Everglades and in Okeechobee County. Also, Duke Energy is building a natural-gas plant at Crystal River.

Police: ‘Housewives’ star tried to flee from patrol car

By Meryl Kornfield
The Palm Beach Post (TNS)

PALM BEACH — A star of the “Real Housewives of New York” reality TV show managed to slip out of her handcuffs and tried to flee from a patrol car following her arrest early Sunday, Palm Beach police said.

“I’m going to (expletive) kill you,” Luann de Lesseps told town officers as they tried to put her back in the car, according to the report.

The 52-year-old de Lesseps is facing a total of five charges following the incident at The Colony Hotel. She was released from the Palm Beach County Jail on Sunday and is due back in

county court Jan. 25.

De Lesseps stayed in Room 327 at The Colony, an 89-room hotel a block from the beach, during her visit to Palm Beach. A security guard told police he found her and a man in bed in Room 407, which the housekeeping staff was turning down for the night, according to an arrest report. After five minutes of trying to get de Lesseps and the man to leave, the guard called police at about 9:30 p.m.

But when officers arrived, they found de Lesseps and a female friend in Room 407, and both appeared to be intoxicated, police said. The women slurred their words and

smelled of alcohol, according to the report.

When both were told to leave, the other woman did so but de Lesseps refused and locked herself in the bathroom, police said. The report does not state either when the female friend arrived in the room or what happened to the man.

Officers tried to open the bathroom door, and de Lesseps shoved one of them in the chest, according to the report.

She slammed the door on another officer, hitting that officer in the face, police said.

After being handcuffed and placed in a patrol car, the reality star removed the cuffs and tried to leave the car. As an officer tried to put her handcuffs back on, she threatened him. She also threatened to kill other officers while in a holding cell at the police department, according to the report.



2017 MONEY MARKET SPECIAL

1.25% APY*

\$50,000 - \$4.9mil in deposits**

Gainesville Locations:

2831 NW 43rd Street | 3720 NW 13th Street
2785 SW 91st Street | 2803 SW 42 St., Suite 10

LIMITED TIME OFFER!



Florida Credit Union

flcu.org
352-377-4141

*Annual Percentage Yield (APY) is accurate as of 12/1/17. You must ask for this offer. Terms, restrictions and conditions apply. See account agreement for current rates, terms and account requirements. Open to both personal and commercial members. New money market account must be opened during the time period of 12/1/17 - 12/31/17 and must be funded with money currently not on deposit at Florida Credit Union. **Minimum balance to open account is \$50,000.00. Introductory APY will apply from account opening until 12/31/17 regardless of account opening date. Balances \$10,000.00-\$24,999.99 will earn 0.15% APY. 0.15% rate: \$25,000.00-\$49,999.99 will earn 0.20% APY. 0.20% rate: \$50,000.00 - \$499,999.99 will earn 1.25% APY. 1.25% rate: \$500,000.00+ will earn 0.15% APY. 0.15% rate. On 1/1/18, all introductory rates/APYs will adjust to the then current money market rate/APY as stated on www.flcu.org at that time. Dividends are compounded and credited monthly. You may not make more than a combined six transfers and/or withdrawals per month from this account. Withdrawals may reduce APY and fees may reduce earnings. Limited time offer subject to change or cancellation at any time without notice. Rates are subject to change at any time including after the account has been opened. Visit www.flcu.org for membership eligibility requirements. Federal insured by NCUA.

CF-GH040363



Helping you is what we love to do.

Don't see the fish you want? We'd love to help you get it. Our Reel Variety program gives us quick access to up to 80 varieties of fish you can special order—always fresh, never frozen. And if you want your selection steamed, we can do that, too!

See how we serve you at publix.com/service.



Berman: Smoking-age bill to continue in Hahnfeldt’s honor

The News Service of Florida

Rep. Lori Berman, a Lantana Democrat, intends to move forward with a bill seeking to raise the legal age for smoking in honor of the measure’s co-sponsor, Rep. Don Hahnfeldt, a Republican from The Villages who died of cancer on Sunday.

“I was saddened to learn of Rep. Don Hahnfeldt’s passing,” Berman tweeted on Tuesday. “I was honored to have worked with him on raising the tobacco purchase age to 21 and will pursue this important issue in his legacy.”

Last week, Hahnfeldt and Berman filed a proposal (HB 1029) that would raise the legal age for smoking from 18 to 21. In a press release issued with Berman, and Senate sponsor David Simmons, R-Altamonte Springs, Hahnfeldt said raising the legal age “will save a projected early loss of life of 270,000 young lives and \$8.6 billion in health care costs, as well as \$8.3 billion in productivity losses.”

Hahnfeldt, 73, was a first-term member of the House whose district includes Sumter and parts of Lake and Marion counties.

Honor Your Best Friend



Only \$70
Includes full color, one photo and message.

GOLDIE JONES

In loving memory of the most loyal dog in the world, Goldie. She lived a long, happy life and loved to chase squirrels, eat Milkbones. She was the best friend a person could have, she was family.

We love you!
Love,
Mike & Jessica

Pets are not just animals, they are a part of the family. Send your pet over the Rainbow Bridge with a touching tribute in The Gainesville Sun’s Pet Obituary Page.

PUBLISHES: Saturday, January 27th, 2018
DEADLINE: Tuesday, January 23rd, 2018

PLEASE FILL OUT FORM COMPLETELY

Name: _____

Address: _____

City: _____ State: _____ Zip: _____

Daytime Phone: _____

Pet Name: _____

Personal Message*: _____

***FITS APPROXIMATELY 30-40 WORDS • ALL INFO IS REQUIRED**

PLEASE MAIL OR BRING IN THIS FORM TO:
The Gainesville Sun Classifieds Pet Obituary
2700 SW 13th Street, Gainesville, FL 32608

For more information, please call 352-372-4222.

PUBLIC NOTICE OF ENACTMENT OF AN ORDINANCE OF THE CITY OF ALACHUA, FLORIDA

Notice is hereby given that the City Commission of the City of Alachua will hold a public hearing on a proposed ordinance. The hearing will be held on January 8, 2018 at 6:00 PM in the James A. Lewis Commission Chambers in City Hall, located at 15100 NW 142nd Terrace, Alachua, Florida.

The ordinance title is as follows:

ORDINANCE 18-03

AN ORDINANCE OF THE CITY OF ALACHUA, FLORIDA, RELATING TO THE AMENDMENT OF THE OFFICIAL ZONING ATLAS; AMENDING THE OFFICIAL ZONING ATLAS FROM AGRICULTURAL (A) TO COMMERCIAL INTENSIVE (CI) ON APPROXIMATELY 9.99 ACRES; LOCATED AT 9900 NW US HIGHWAY 441; NORTHWEST OF THE INTERSECTION OF US HIGHWAY 441 AND NW 43RD STREET, SOUTHEAST OF THE BROOKE POINTE SUBDIVISION, SOUTH OF THE STAGHORN SUBDIVISION, AND WEST OF US HIGHWAY 441; A PORTION OF TAX PARCEL NUMBER 05936-001-000; REPEALING ALL ORDINANCES IN CONFLICT; PROVIDING SEVERABILITY; AND PROVIDING AN EFFECTIVE DATE.

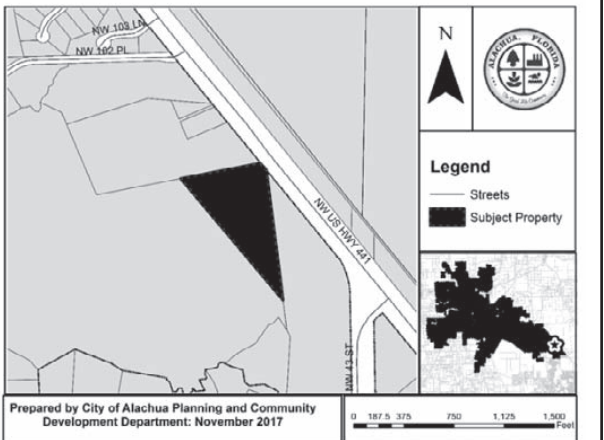

At the public hearing, all interested parties may appear and be heard with respect to the application. Copies of the application are available for public inspection at the Planning and Community Development Department, 15100 NW 142nd Terrace, Alachua, Florida, on any regular business day between the hours of 7:30 a.m. to 6:00 p.m. Written comments on the application may be sent to the following address: City of Alachua, Planning and Community Development, P.O. Box 9, Alachua, FL 32616. Notice is given pursuant to Section 286.0105, Florida Statutes, that, in order to appeal any decision made at the public hearing, you will need a record of the proceedings, and that, for such purpose, you may need to ensure that a verbatim record of the proceedings is made, which includes the testimony and evidence upon which the appeal is to be based. In accordance with the Americans with Disabilities Act, any persons with a disability requiring reasonable accommodation in order to participate in this meeting should call the City Clerk at (386) 418-6100 x 101 at least 48 hours prior to the public hearing.



City of ALACHUA

PUBLIC NOTICE OF ENACTMENT OF AN ORDINANCE OF THE CITY OF ALACHUA, FLORIDA

Notice is hereby given that the City Commission of the City of Alachua will hold a public hearing on a proposed ordinance. The hearing will be held on January 8, 2018 at 6:00 PM in the James A. Lewis Commission Chambers in City Hall, located at 15100 NW 142nd Terrace, Alachua, Florida.

The ordinance title is as follows:

ORDINANCE 18-03

AN ORDINANCE OF THE CITY OF ALACHUA, FLORIDA, RELATING TO THE AMENDMENT OF THE OFFICIAL ZONING ATLAS; AMENDING THE OFFICIAL ZONING ATLAS FROM AGRICULTURAL (A) TO COMMERCIAL INTENSIVE (CI) ON APPROXIMATELY 9.99 ACRES; LOCATED AT 9900 NW US HIGHWAY 441; NORTHWEST OF THE INTERSECTION OF US HIGHWAY 441 AND NW 43RD STREET, SOUTHEAST OF THE BROOKE POINTE SUBDIVISION, SOUTH OF THE STAGHORN SUBDIVISION, AND WEST OF US HIGHWAY 441; A PORTION OF TAX PARCEL NUMBER 05936-001-000; REPEALING ALL ORDINANCES IN CONFLICT; PROVIDING SEVERABILITY; AND PROVIDING AN EFFECTIVE DATE.

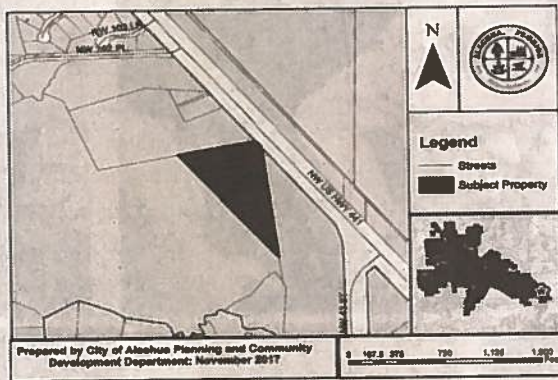

At the public hearing, all interested parties may appear and be heard with respect to the application. Copies of the application are available for public inspection at the Planning and Community Development Department, 15100 NW 142nd Terrace, Alachua, Florida, on any regular business day between the hours of 7:30 a.m. to 6:00 p.m. Written comments on the application may be sent to the following address: City of Alachua, Planning and Community Development; P.O. Box 9, Alachua, FL 32616. Notice is given pursuant to Section 286.0105, Florida Statutes, that, in order to appeal any decision made at the public hearing, you will need a record of the proceedings, and that, for such purpose, you may need to ensure that a verbatim record of the proceedings is made, which includes the testimony and evidence upon which the appeal is to be based. In accordance with the Americans with Disabilities Act, any persons with a disability requiring reasonable accommodation in order to participate in this meeting should call the City Clerk at (386) 418-6100 x 101 at least 48 hours prior to the public hearing.

(Published: Alachua County Today - December 28, 2017)

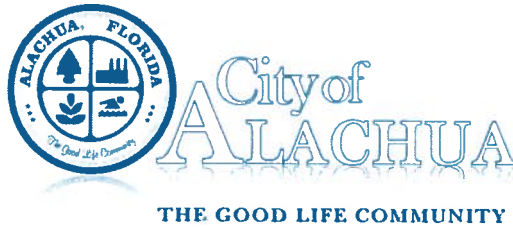

Mailed
12/19/2017
RC

PUBLIC NOTICE OF ENACTMENT OF AN ORDINANCE OF THE CITY OF ALACHUA, FLORIDA

Notice is hereby given that the City Commission of the City of Alachua will hold a public hearing on a proposed ordinance. The hearing will be held on January 8, 2018 at 6:00 PM in the James A. Lewis Commission Chambers in City Hall, located at 15100 NW 142nd Terrace, Alachua, Florida.

The ordinance title is as follows:

ORDINANCE 18-03

AN ORDINANCE OF THE CITY OF ALACHUA, FLORIDA, RELATING TO THE AMENDMENT OF THE OFFICIAL ZONING ATLAS; AMENDING THE OFFICIAL ZONING ATLAS FROM AGRICULTURAL (A) TO COMMERCIAL INTENSIVE (CI) ON APPROXIMATELY 9.99 ACRES; LOCATED AT 9900 NW US HIGHWAY 441; NORTHWEST OF THE INTERSECTION OF US HIGHWAY 441 AND NW 43RD STREET, SOUTHEAST OF THE BROOKE POINTE SUBDIVISION, SOUTH OF THE STAGHORN SUBDIVISION, AND WEST OF US HIGHWAY 441; A PORTION OF TAX PARCEL NUMBER 05936-001-000; REPEALING ALL ORDINANCES IN CONFLICT; PROVIDING SEVERABILITY; AND PROVIDING AN EFFECTIVE DATE.

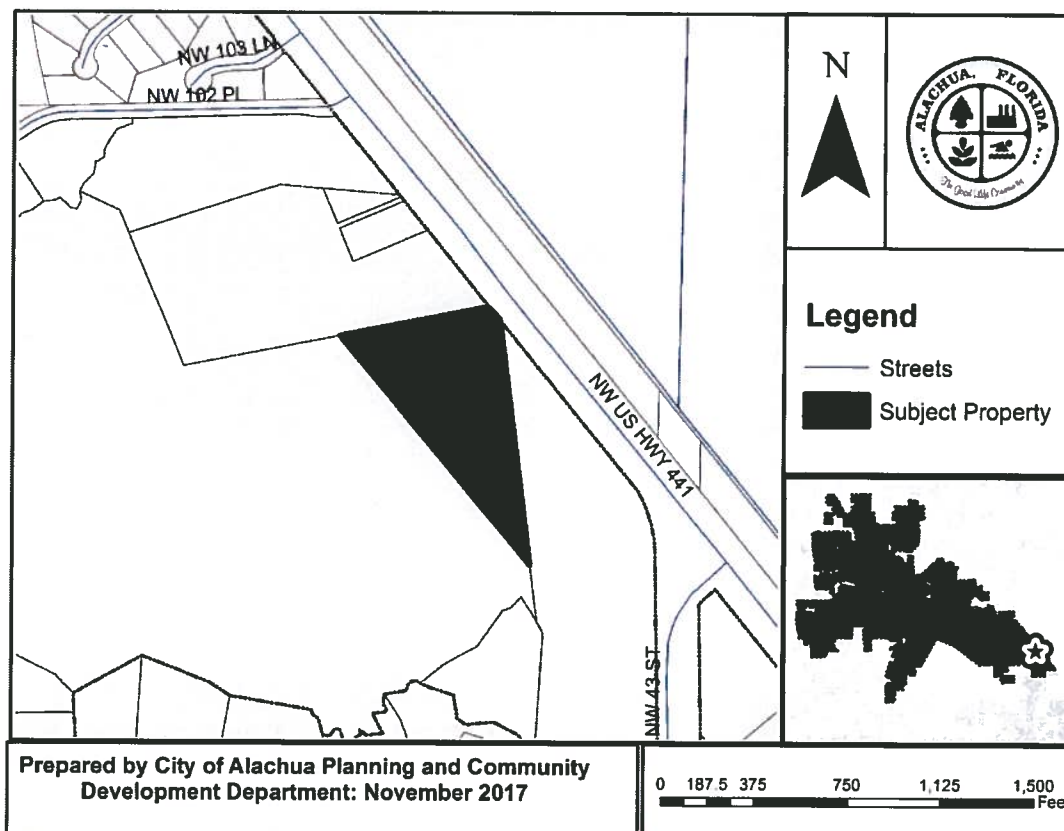

At the public hearing, all interested parties may appear and be heard with respect to the application. Copies of the application are available for public inspection at the Planning and Community Development Department, 15100 NW 142nd Terrace, Alachua, Florida, on any regular business day between the hours of 7:30 a.m. to 6:00

P.O. Box 9 ♦ Alachua, Florida 32616-0009
Phone: (386) 418-6121 ♦ Fax: (386) 418-6130



THE GOOD LIFE COMMUNITY

p.m. Written comments on the application may be sent to the following address: City of Alachua, Planning and Community Development, P.O. Box 9, Alachua, FL 32616. Notice is given pursuant to Section 286.0105, Florida Statutes, that, in order to appeal any decision made at the public hearing, you will need a record of the proceedings, and that, for such purpose, you may need to ensure that a verbatim record of the proceedings is made, which includes the testimony and evidence upon which the appeal is to be based. In accordance with the Americans with Disabilities Act, any persons with a disability requiring reasonable accommodation in order to participate in this meeting should call the City Clerk at (386) 418-6100 x 101 at least 48 hours prior to the public hearing.

JOHNSON, C L TRUSTEE
PO BOX 357133
GAINESVILLE FL 32635

CITY OF GAINESVILLE
PO BOX 490 MS 58
GAINESVILLE FL 32627

HURST, J V & MARCIA
4604 NW 93RD AVE
GAINESVILLE FL 32653-7803

DM ALACHUA INVESTMENTS LLC
PO BOX 171
SUWANNEE FL 32692

ROGALSKI ROY
PO BOX 46
LACROSSE FL 32658-0046

TORO JUAN & RITA
5208 NW 93RD AVE
GAINESVILLE FL 32653

MATILSKY HERBERT TRUSTEE
15505 NW 202ND ST
ALACHUA FL 32615-8041

RASNICK KENNETH M JR & CLAUDIA E
10016 NW 52ND TER
GAINESVILLE FL 32653

SCHMIDT, JULE E TRUSTEE
7305 MYSTIC WAY
PORT ST LUCIE FL 34986

TORO, JUAN & RITA
5208 NW 93RD AVE
GAINESVILLE FL 32653

G L D LLC
1901 NW 67TH PL STE E
GAINESVILLE FL 32653

GASTON WILLIAM G & MARGARET F
9691 NW 53RD DR
GAINESVILLE FL 32653

YESH JANET A LIFE ESTATE
4420 NW 93RD AVE
GAINESVILLE FL 32653

BROCK J OWEN JR & JANDA
10022 NW 52ND TER
GAINESVILLE FL 32653

DM ALACHUA INVESTMENTS LLC
PO BOX 171
SUWANNEE FL 32692

CUMBAA DAVID L & VETA CLEMENTS
4916 NW 93RD AVE
GAINESVILLE FL 32653-7806

HURST J V & MARCIA
4604 NW 93RD AVE
GAINESVILLE FL 32653-7803

HURST & HURST
4604 NW 93RD AVE
GAINESVILLE FL 32653-7803

POPE H D & TEIKO
4622 NW 93RD AVE
GAINESVILLE FL 32653-7803

ROWE MICHAEL A & CARON P
4502 NW 93RD AVE
GAINESVILLE FL 32653

CONNOLLY JAMES B & PAMELA
4412 NW 93RD AVE
GAINESVILLE FL 32653-7801

BEARDSLEY R T & GENE
4416 NW 93RD AVE
GAINESVILLE FL 32653-7801

TORO, JUAN & RITA
5208 NW 93RD AVE
GAINESVILLE FL 32653

GRABLE STEPHEN R
4240 NW 17TH TER
GAINESVILLE FL 32605

SCHMIDT, ANN HEIRS
7305 MYSTIC WAY
PORT ST LUCIE FL 34986

G L D LLC
1901 NW 67TH PL STE E
GAINESVILLE FL 32653

BASALYGA & RAGAN W/H
4820 NW 102ND PL
GAINESVILLE FL 32653

KOCHERT DAVID W & MARGARET J
4928 NW 102ND PL
GAINESVILLE FL 32653-9716

MESA-SAND REALTY LLC
10689 N PENNSYLVANIA ST STE 100
INDIANAPOLIS IN 46280-1099

SCHMIDT, ANN HEIRS
7305 MYSTIC WAY
PORT ST LUCIE FL 34986



JONES CASEY & NEKIA
5014 NW 102ND PL
GAINESVILLE FL 32653

BLAGAY & BRUCE
5219 NW 102ND PL
GAINESVILLE FL 32653

FOX & GRIGGS W/H
10028 NW 52ND TER
GAINESVILLE FL 32653

CURINGTON JAMES E JR & CHERYL W
10015 NW 52ND TER
GAINESVILLE FL 32653-9707

FENNELL CHAKA A
10014 NW 52ND TER
GAINESVILLE FL 32653

COBURN JIMMY A & GIULIANA G
5211 NW 102ND PL
GAINESVILLE FL 32653-9703

HOUSTON MARK & LORNA M
5107 NW 102ND PL
GAINESVILLE FL 32653

BURGER BRYCE A & TRACY A
5001 NW 102ND PL
GAINESVILLE FL 32653

BURGER WILLIAM H & CELIA R
10008 NW 50TH TER
GAINESVILLE FL 32653

FRAZER THOMAS K & CHARLENE M
10009 NW 50TH TER
GAINESVILLE FL 32653

HOPKINS JOHN S & CAROLYN M
10011 NW 50TH TER
GAINESVILLE FL 32653-9715

LUPI ROCKY
7860 PROCTOR RD
PAINESVILLE OH 44077

G L D LLC
1901 NW 67TH PL STE E
GAINESVILLE FL 32653

G L D LLC
1901 NW 67TH PL STE E
GAINESVILLE FL 32653

MEYER CONSTANCE L LIFE ESTATE
4720 NW 104TH LN
GAINESVILLE FL 32653-7836

MILLER TERRELL R & ADELITA T
4721 NW 104TH LN
GAINESVILLE FL 32653

EGGERKING LINDA D TRUSTEE
4713 NW 104TH LN
GAINESVILLE FL 32653

FRUGOLI, FRITZ LEE HEIRS
4609 NW 103RD
GAINESVILLE FL 32653



Antoinette Endelicato
5562 NW 93rd Avenue
Gainesville, FL 32653

Dan Rhine
288 Turkey Creek
Alachua, FL 32615

Tom Gorman
9210 NW 59th Street
Alachua, FL 32653

Richard Gorman
5716 NW 93rd Avenue
Alachua, FL 32653

Peggy Arnold
410 Turkey Creek
Alachua, FL 32615

David Forest
23 Turkey Creek
Alachua, FL 32615

Michele L. Lieberman
Interim County Manager
12 SE 1st Street
Gainesville, FL 32601

President
TCMOA
1000 Turkey Creek
Alachua, FL 32615

Linda Dixon, AICP
Assistant Director Planning
PO Box 115050
Gainesville, FL 32611

Craig Parenteau
FDEP
4801 Camp Ranch Road
Gainesville, FL 32641

Jeannette Hinsdale
PO Box 1156
Alachua, FL 32616

Lynn Coullias
7406 NW 126th Avenue
Alachua, FL 32615

Lynda Coon
7216 NW 126 Avenue
Alachua, FL 32615

Tamara Robbins
PO Box 2317
Alachua, FL 32616



AFFIDAVIT FOR POSTED LAND USE SIGN

I Jackie Curry, POSTED THE LAND USE
(Name)
SIGN ON 11-22-17 FOR THE Rezoning – Meeks Rezoning
(Date) (State type of action and project name)
LAND USE ACTION.

AS PER ARTICLE 2.2.9 D OF THE LAND DEVELOPMENT REGULATIONS.

THIS WILL BE INCLUDED IN THE STAFF REPORT.

Jackie Curry
(Signature)

1
(Number of signs)