

## NOTICE OF ELECTION CITY OF ARCHER

Notice is hereby given that a regular Election for the City of Archer, Alachua County, Florida will be held Tuesday, April 10th, 2018. The purpose of the election will be to fill City Commission seats;

To elect a Commissioner for seat #4,  
for a term of four years

To elect a Commissioner for seat #5,  
for a term of four years

Qualifying for these seats will occur from noon (12pm), February 9th, 2018 through noon (12pm), February 23rd, 2018.

If no candidate receives a majority of the votes cast for the Seat in the regular election, a run-off election shall be held April 24th, 2018 between the two (2) candidates for that seat who receive the highest number of votes cast in the regular election.

Polling site will be the Archer Community Center located at 16671 SW 137th Ave, Archer, Florida. Polls will be open from 7:00a.m. to 7:00p.m.

For more information call Archer City Hall at 352-495-2880.

Zeriah K. Folston, City Manager

(Published: Alachua County Today - February 01 & 08, 2017)



# City of ALACHUA

## NOTICE OF PUBLIC HEARING BEFORE THE PLANNING AND ZONING BOARD OF THE CITY OF ALACHUA, FLORIDA

Notice is hereby given that the Planning & Zoning Board of the City of Alachua will hold a public hearing on February 13, 2018, at 6:00 p.m. The hearing will be held in the James A. Lewis Commission Chambers in City Hall, located at 15100 NW 142nd Terrace, Alachua, Florida, to consider the following: A request by Clay Sweager, AICP, of EDA Engineers - Surveyors - Planners, Inc., applicant and agent, for Guru Kuli Holding, LLC, and Govinda Carol and Mahendra Kumar Sharma, property owners, for consideration of the Replat of Lots 1 and 4, Block 14, of Alachua Realty Co.'s Addition to the City of Alachua, Fla, as per the plat thereof, recorded in Plat Book "A", Page 100, of the Public Records of Alachua County, Florida. The replat proposes to subdivide the two (2) existing lots into a total of four (4) lots, consisting of a  $\pm 1.34$  acre subject property; located west of NW 141st Street and one block south of the intersection of NW 165th Place and NW 141st Street; consisting of a portion of Tax Parcel No. 03095-000-000 and Tax Parcel No. 03095-001-000. Future Land Use Map (FLUM) Designation: Moderate Density Residential; Zoning: Residential Single Family - 3 (RSF-3).

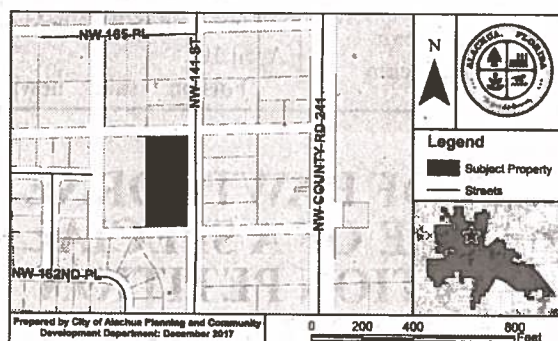

## AFFIDAVIT FOR POSTED LAND USE SIGN

I Melissa Watson, POSTED THE LAND USE  
(name)  
SIGN ON 1-25-18 FOR THE Syer Minor Subdivision - PZB & CCOM Hearings  
(date) (state type of action and project name)  
LAND USE ACTION.

AS PER ARTICLE 2.2.9 D OF THE LAND DEVELOPMENT REGULATIONS.

THIS WILL BE INCLUDED IN THE STAFF REPORT.

Melissa Watson  
(signature)

2  
(number of signs)

*mailed  
1/29/2018  
(KC)*

## NOTICE OF PUBLIC HEARING BEFORE THE PLANNING AND ZONING BOARD OF THE CITY OF ALACHUA, FLORIDA

Notice is hereby given that the Planning & Zoning Board of the City of Alachua will hold a public hearing on February 13, 2018, at 6:00 p.m. The hearing will be held in the James A. Lewis Commission Chambers in City Hall, located at 15100 NW 142<sup>nd</sup> Terrace, Alachua, Florida, to consider the following: A request by Clay Sweger, AICP, of EDA Engineers – Surveyors – Planners, Inc., applicant and agent, for Guru Kuli Holding, LLC, and Govinda Carol and Mahendra Kumar Sharma, property owners, for consideration of the Replat of Lots 1 and 4, Block 14, of Alachua Realty Co.'s Addition to the City of Alachua, Fla, as per the plat thereof, recorded in Plat Book "A", Page 100, of the Public Records of Alachua County, Florida. The replat proposes to subdivide the two (2) existing lots into a total of four (4) lots, consisting of a  $\pm 1.34$  acre subject property; located west of NW 141<sup>st</sup> Street and one block south of the intersection of NW 165<sup>th</sup> Place and NW 141<sup>st</sup> Street; consisting of a portion of Tax Parcel No. 03095-000-000 and Tax Parcel No. 03095-001-000. Future Land Use Map (FLUM) Designation: Moderate Density Residential; Zoning: Residential Single Family – 3 (RSF-3).

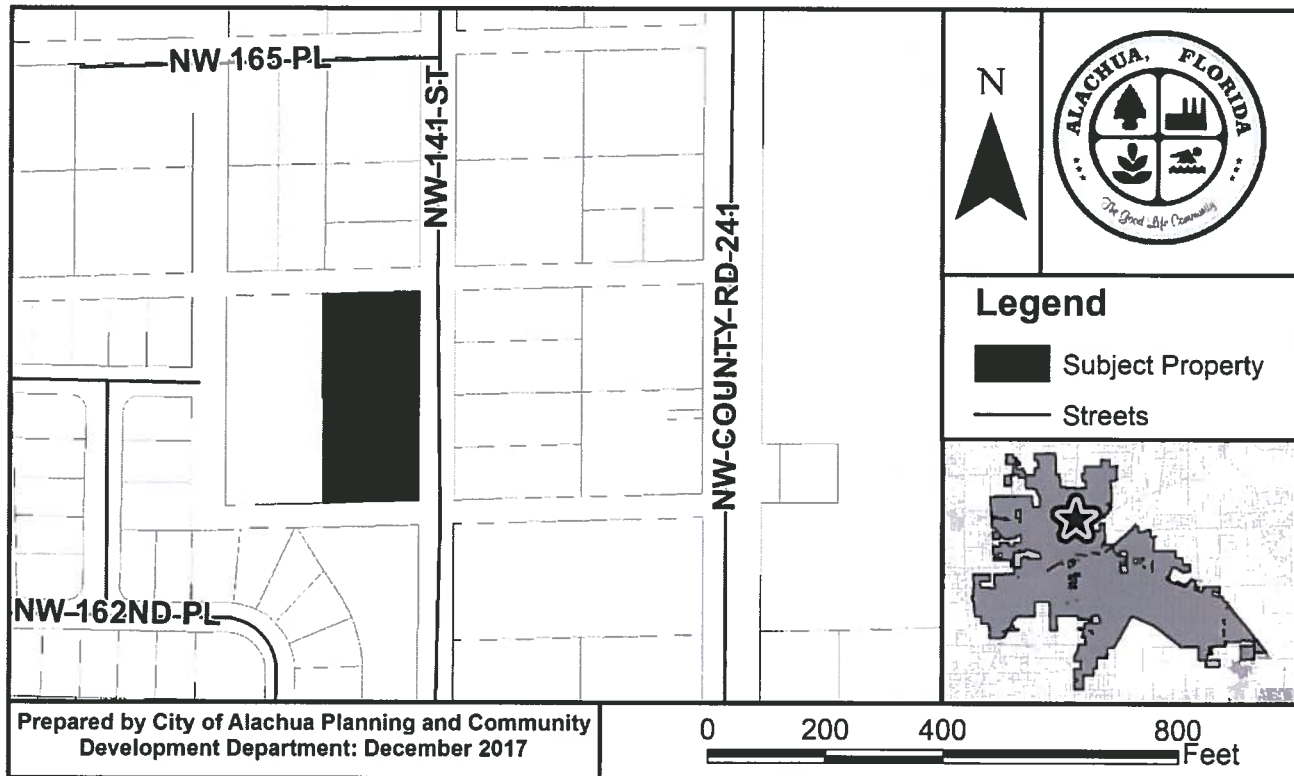

At the public hearing, all interested parties may appear and be heard with respect to the application. Copies of the application are available for public inspection at the Planning and Community Development Department, 15100 NW 142<sup>nd</sup> Terrace, Alachua, Florida, on any regular business day between the hours of 7:30 a.m. to 6:00 p.m. Written comments on the application may be sent to the following address: City of Alachua, Planning and Community Development, P.O. Box 9, Alachua, FL 32616. Notice is given pursuant to Section 286.0105, Florida Statutes, that, in order to appeal any decision made at the public hearing, you will need a record of the proceedings, and that, for such purpose, you may need to ensure that a verbatim record of the proceedings is made, which includes the testimony and evidence upon which the appeal is to be based. In accordance with the Americans with Disabilities Act, any persons with a disability requiring reasonable accommodation in order to participate in this meeting should call the City Clerk at (386) 418-6100 x 101 at least 48 hours prior to the public hearing.

03095-001-000  
CAROL & SHARMA  
7200 SW 8TH AVE UNIT T130  
GAINESVILLE, FL 32607

03067-061-000  
BAYWOOD HILLS OWNERS  
ASSOCIATION INC  
7475 SW 70TH LN  
Gainesville, FL 32608

03067-061-047  
AMA GAINESVILLE INVESTMENTS  
7475 SW 70TH LN  
Gainesville, FL 32608

03067-062-071  
AMA GAINESVILLE INVESTMENTS  
7475 SW 70TH LN  
Gainesville, FL 32608

03067-062-072  
AMA GAINESVILLE INVESTMENTS  
7475 SW 70TH LN  
Gainesville, FL 32608

03067-062-073  
AMA GAINESVILLE INVESTMENTS  
7475 SW 70TH LN  
Gainesville, FL 32608

03067-062-074  
AMA GAINESVILLE INVESTMENTS  
7475 SW 70TH LN  
Gainesville, FL 32608

03067-062-075  
AMA GAINESVILLE INVESTMENTS  
7475 SW 70TH LN  
Gainesville, FL 32608

03067-062-076  
AMA GAINESVILLE INVESTMENTS  
7475 SW 70TH LN  
Gainesville, FL 32608

03067-062-077  
AMA GAINESVILLE INVESTMENTS  
7475 SW 70TH LN  
Gainesville, FL 32608

03067-062-078  
AMA GAINESVILLE INVESTMENTS  
7475 SW 70TH LN  
Gainesville, FL 32608

03067-062-079  
AMA GAINESVILLE INVESTMENTS  
7475 SW 70TH LN  
Gainesville, FL 32608

03067-062-080  
AMA GAINESVILLE INVESTMENTS  
7475 SW 70TH LN  
Gainesville, FL 32608

03067-062-081  
AMA GAINESVILLE INVESTMENTS  
7475 SW 70TH LN  
Gainesville, FL 32608

03067-062-082  
AMA GAINESVILLE INVESTMENTS  
7475 SW 70TH LN  
Gainesville, FL 32608

03067-062-083  
AMA GAINESVILLE INVESTMENTS  
7475 SW 70TH LN  
Gainesville, FL 32608

03067-062-084  
AMA GAINESVILLE INVESTMENTS  
7475 SW 70TH LN  
Gainesville, FL 32608

03067-062-091  
AMA GAINESVILLE INVESTMENTS  
7475 SW 70TH LN  
Gainesville, FL 32608

03067-062-092  
AMA GAINESVILLE INVESTMENTS  
7475 SW 70TH LN  
Gainesville, FL 32608

03067-062-093  
AMA GAINESVILLE INVESTMENTS  
7475 SW 70TH LN  
Gainesville, FL 32608

03067-062-094  
AMA GAINESVILLE INVESTMENTS  
THREE LLC  
7475 SW 70TH LN  
Gainesville, FL 32608

03067-062-095  
AMA GAINESVILLE INVESTMENTS  
THREE LLC  
7475 SW 70TH LN  
GAINESVILLE, FL 32608

03067-062-096  
AMA GAINESVILLE INVESTMENTS  
7475 SW 70TH LN  
Gainesville, FL 32608

03067-062-097  
AMA GAINESVILLE INVESTMENTS  
7475 SW 70TH LN  
Gainesville, FL 32608

03067-062-098  
AMA GAINESVILLE INVESTMENTS  
7475 SW 70TH LN  
Gainesville, FL 32608

03067-062-099  
AMA GAINESVILLE INVESTMENTS  
7475 SW 70TH LN  
Gainesville, FL 32608

03085-000-000  
TILLMAN, MARGARET M  
8265 TIVERTON DR  
PORT TOBACCO, MD 20677-3421

03087-002-000  
RIVERA, EDWIN B  
PO BOX 1904  
ALACHUA, FL 32616-1904

03090-001-000  
PASCUAL FRANCISCO JUAN  
PO BOX 1962  
ALACHUA, FL 32616

03081-003-000  
CALHOUN, JOHNNY B & MARIE  
PO BOX 434  
ALACHUA, FL 32616

03081-002-000  
KIRKLAND, MARY L  
1275 NE 136TH TER #1  
NORTH MIAMI, FL 33161

03081-000-000  
SOUTHEAST MISSION INC TRUSTEE  
1411 NW 2ND ST  
GAINESVILLE, FL 32601-4231

03067-061-062  
LAING, BRETT J  
14276 NW 161ST AVE  
Alachua, FL 32615

03067-062-087  
ODUM RONNIE & LEEANNE J  
14282 NW 163RD PL  
Alachua, FL 32615

03067-061-063  
LISTZWAN LORI JORDAN  
14296 NW 161ST AVE  
ALACHUA, FL 32615

03067-062-089  
SORRELL, ALBERT L & PAMELA E  
14304 NW 163RD PL  
Alachua, FL 32615

03067-061-064  
SANDERS BRYAN & AMANDA  
14308 NW 161ST AVE  
Alachua, FL 32615

03067-062-090  
CRISWELL JOHNATHAN  
14324 NW 163RD PL  
ALACHUA, FL 32615

03067-061-065  
HEWITT THOMAS C  
14328 NW 161ST AVE  
ALACHUA, FL 32615

03067-062-070  
AKRIDGE MICHAEL D & SHATEKA  
14365 NW 162ND PL  
Alachua, FL 32615

03092-000-000  
ROSS, FRANK  
1460 16TH ST  
SARASOTA, FL 34236-2520

03101-000-000  
FRAZIER SHIRLEY D HEIRS  
16102 NW COUNTY RD 241  
ALACHUA, FL 32615

03067-062-085  
COON-WHITE, PRISCA S  
16273 NW 143RD WAY  
Alachua, FL 32615

03067-062-086  
WILLIAMS RAYMOND A & SHARON  
16293 NW 143RD WAY  
ALACHUA, FL 32615

03082-001-002  
JOHNSON, TODD M & MANDY E  
16316 NW 141ST ST  
ALACHUA, FL 32615

03083-001-000  
LEE, LEWIS VONN  
16316 NW 141ST ST  
ALACHUA, FL 32615

03084-000-000  
LEE, LEWIS VONN  
16316 NW 141ST ST  
ALACHUA, FL 32615

03084-001-000  
JOHNSON TODD M & MANDY E  
16316 NW 141ST ST  
ALACHUA, FL 32615

03087-000-000  
SANCHEZ JAVIER A & LUZ M  
16402 NW 140TH ST  
ALACHUA, FL 32615

03087-003-000  
BUSH & BUSH  
16408 NW 140TH ST  
ALACHUA, FL 32615

03086-000-000  
MILLER LETHA  
16473 NW 141ST ST  
ALACHUA, FL 32615-4807

03083-000-000  
JONES, BOBBY & CYNTHIA  
17750 SW 105TH AVE  
MIAMI, FL 33157-5106

03081-001-000  
SMITH, H E  
18125 NW 42ND PL  
OPA LOCKA, FL 33055-3311

03100-000-000  
SRI JAGANNATH CHAITANYA  
SANGHA  
2441 NW 43RD ST UNIT 24-A  
Gainesville, FL 32606

03102-000-000  
SRI JAGANNATH CHAITANYA  
SANGHA  
2441 NW 43RD ST UNIT 24-A  
Gainesville, FL 32606

03082-000-000  
OWENS, LINDA L  
2930 NW 62ND AVE  
GAINESVILLE, FL 32653-1460

03067-062-088  
DEJESUS BERMAN  
3301 SW 13TH ST APT Q246  
GAINESVILLE, FL 32608-3059

03082-001-001  
QUINONES, MIGUEL & CAROLYN  
3705 NW 186TH ST  
NEWBERRY, FL 32669

03091-000-000  
FREEMAN, STERLING  
4040 N COLUMBIA AVE  
TULSA, OK 74110-1211

03093-000-000  
FREEMAN, STERLING  
4040 N COLUMBIA AVE  
TULSA, OK 74110-1211

03087-001-000  
CALHOUN JOHNNY B & MARIE  
PO BOX 434  
ALACHUA, FL 32616-0434

03090-000-000  
NOBLE, JERALDINE  
PO BOX 5506  
GAINESVILLE, FL 32627

03095-000-000  
GURU KULI HOLDING COMPANY  
PO BOX 571  
ALACHUA, FL 32616

03089-000-000  
WEST BARBARA B  
PO BOX 684  
ALACHUA, FL 32616

ANTOINETTE ENDELICATO  
5562 NW 93RD AVENUE  
GAINESVILLE, FL 32653

DAN RHINE  
288 TURKEY CREEK  
ALACHUA, FL 32615

TOM GORMAN  
9210 NW 59TH STREET  
ALACHUA, FL 32653

RICHARD GORMAN  
5716 NW 93RD AVENUE  
ALACHUA, FL 32653

PEGGY ARNOLD  
410 TURKEY CREEK  
ALACHUA, FL 32615

DAVID FOREST  
23 TURKEY CREEK  
ALACHUA, FL 32615

PRESIDENT, TCMOA  
1000 TURKEY CREEK  
ALACHUA, FL 32615

LINDA DIXON, AICP  
ASSISTANT DIRECTOR OF PLANNING  
PO BOX 115050  
GAINESVILLE, FL 32611

CRAIG PARENTEAU  
FL DEPT. ENVIRONMENTAL  
PROTECTION  
4801 CAMP RANCH ROAD  
GAINESVILLE, FL 32641

JEANNETTE HINSDALE  
P.O. BOX 1156  
ALACHUA, FL 32616

LYNN COULLIAS  
7406 NW 126TH AVE  
ALACHUA, FL 32615

LYNDA COON  
7216 NW 126 AVENUE  
ALACHUA, FL 32615

TAMARA ROBBINS  
PO BOX 2317  
ALACHUA, FL 32616

MICHELE L. LIEBERMAN  
INTERIM COUNTY MANAGER  
12 SE 1ST STREET  
GAINESVILLE, FL 32601

