

CALL NOW & SAVE UP TO 84% ON YOUR NEXT PRESCRIPTION

Drug Name	Qty (pills)	Price*
Viagra 100mg	16	\$109.99
Viagra 50mg	16	\$89.99
Cialis 5mg	90	\$139.99
Cialis 20mg	16	\$109.99
Levitra 20mg	30	\$119.99
Stendra 200mg	16	\$249.99
Zetia 10mg	100	\$119.99
Spiriva 18mcg	90	\$179.99
Advair 250/50mcg	180 ds	\$194.99
Vagifem 10mcg	24	\$104.99
Premarin 0.625mg	84	\$84.99
Combivent 18/103mcg	600 ds	\$129.99

All pricing in U.S. dollars and subject to change without notice. *We accept Amex, Electronic Checking, Personal Check or International Money Order. **Prices shown are for the equivalent generic drug if available.*

1-800-267-2688 TotalCareMart.com
www.TotalCareMart.com Savings made easy GF-GH045155

Mailing Address:
ORDER PROCESSING CENTER, PO BOX 121 STN L,
WINNIPEG, MANITOBA, R3H 0Z4, CANADA CODE GH52

NOTICE OF PUBLIC HEARING BEFORE THE PLANNING AND ZONING BOARD OF THE CITY OF ALACHUA, FLORIDA

Notice is hereby given that the Planning & Zoning Board of the City of Alachua will hold a public hearing on June 12, 2018 at 6:00 p.m. The hearing will be held in the James A. Lewis Commission Chambers in City Hall, located at 15100 NW 142nd Terrace, Alachua, Florida, to consider the following: A request by Ryan Thompson, AICP, of CHW, Inc., applicant and agent, for Lillie Belle Jeffords Life Estate and Trustees, Barbara Ann Lemley, Janet Schenck, Monaghan and Schenck Trustees, MP and Martha Monaghan, and Diane White, property owners, for consideration of a Large Scale Comprehensive Plan Amendment (LSCPA) to the City of Alachua Future Land Use Map (FLUM) to amend the FLUM from Rural/ Agriculture (County) to Moderate Density Residential on a ±161.14 acre portion of the subject property and from Rural/Agriculture (County) to Community Commercial on a ± 76.44 acre portion of the subject property. The ±237.58 acre property subject to the proposed amendment is located northeast of the intersection US Highway 441 and NW 188th Street, west of the Meadowglen Subdivision, consisting of Tax Parcel Numbers 03024-000-000, 03024-001-000, 03024-002-000, 03024-003-000, 03024-004-000, 03045-000-000, 03046-000-000, 03046-005-000, 03047-000-000, 03047-001-000, 03047-001-001, 03047-001-002, 03047-001-003, 03047-001-004, 03047-001-005 and 03048-002-000; Existing FLUM: Rural/Agriculture (County); Existing Zoning: Agricultural (A) (County).

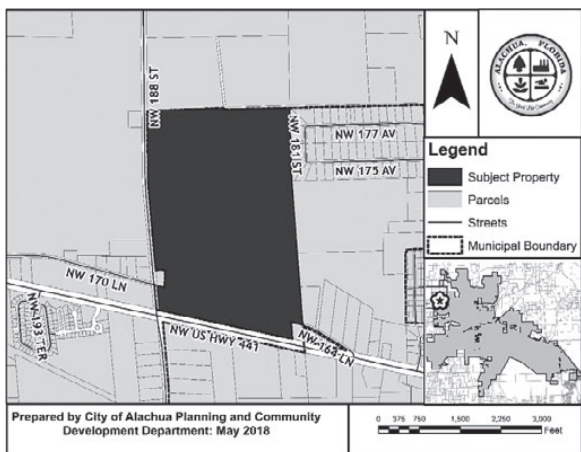

At the public hearing, all interested parties may appear and be heard with respect to the application. Copies of the application are available for public inspection at the Planning and Community Development Department, 15100 NW 142nd Terrace, Alachua, Florida, on any regular business day between the hours of 7:30 a.m. to 6:00 p.m. Written comments on the application may be sent to the following address: City of Alachua, Planning and Community Development, P.O. Box 9, Alachua, FL 32616. Notice is given pursuant to Section 286.0105, Florida Statutes, that, in order to appeal any decision made at the public hearing, you will need a record of the proceedings, and that, for such purpose, you may need to ensure that a verbatim record of the proceedings is made, which includes the testimony and evidence upon which the appeal is to be based. In accordance with the Americans with Disabilities Act, any persons with a disability requiring reasonable accommodation in order to participate in this meeting should call the City Clerk at (386) 418-6100 x 101 at least 48 hours prior to the public hearing.

GF-GH039871

Court weighs judge's Facebook friendship

By Jim Turner
The News Service of Florida

TALLAHASSEE — The Florida Supreme Court is poised next week to take up a case that poses a question for the age of social media: What does it mean to be a Facebook friend?

Justices will hear arguments about whether a Miami-Dade County circuit judge should be disqualified from a case because she is a Facebook friend with a lawyer for one of the parties. The outcome could have reverberations in

courthouses across the state, as justices weigh whether a Facebook friendship poses the potential for bias.

The underlying case stems from a dispute between the Herssein Law Group and a former client, United States Automobile Association, about attorney fees and alleged fraud and breach of contract. The law firm sought the disqualification of Circuit Judge Beatrice Butchko because she was a Facebook friend with attorney Israel Reyes, who was hired to represent a company official in the case.

Butchko refused to step aside, leading the Herssein Law Group to take the issue to the 3rd District Court of Appeal. That court rejected the request to disqualify the circuit judge, concluding that "a 'friend' on a social networking website is not necessarily a friend in the traditional sense of the word."

"To be sure, some of a member's Facebook 'friends' are undoubtedly friends in the classic sense of person for whom the member feels particular affection and loyalty," the appeals-court decision

said. "The point is, however, many are not. A random name drawn from a list of Facebook 'friends' probably belongs to casual friend; an acquaintance; an old classmate; a person with whom the member shares a common hobby; a 'friend of a friend;' or even a local celebrity like a coach.

An assumption that all Facebook 'friends' rise to the level of a close relationship that warrants disqualification simply does not reflect the current nature of this type of electronic social networking."

RAIN

From Page B1

So all in all, the region withstood a pre-season storm that brought inches of rain to areas that are

still saturated from Hurricane Irma in September. Hurricane season officially starts Saturday.

The Florida Department of Transportation has been monitoring U.S. 441, which fully opened earlier this month after complete and partial lane

closures since September due to Irma.

As it stands now, the water level at the monitoring point is 19 inches below the level when it was closed last year, said district spokesman Troy Roberts.

"We've been following

it because we were curious to see what was happening there, so we've been checking it every single day since last Thursday," Roberts said. "With all of the rain we've gotten in the last six days, (the level) hasn't changed at all. I don't know how that is, but we do check it every day."

On Sunday the Santa Fe River at Worthington Springs was at 54.31 feet above mean sea level. It rose to 56.20 feet Wednesday afternoon. The Suwannee River at Nobles Ferry Road was at 34.06 feet Sunday and 37.77 feet Wednesday.

The readings for both rivers are well below flood stage, according to data from the Suwannee River Water Management District.

Rainfall over the past few days varied by location. Official readings at the Gainesville Regional Airport showed that nearly an inch of rain had fallen on Wednesday by mid-afternoon.

For May, 6.54 inches have fallen — 4.30 inches more than normal.

Phil Peterson, a meteorologist with the National Weather Service in Jacksonville, said Wednesday the typical summer pattern of morning sun and afternoon showers should kick in within a few days.

"For Northeast Florida including Gainesville we are going to have one more day like today but then the chances of rain will decrease Friday," Peterson said. "It looks to me like the normal pattern is going to start of the weekend."

For a limited time, when you refinance a non-VyStar certificate of deposit (CD) or bring new funds from another financial institution and open a new VyStar CD, you'll not only get a great rate, we'll give you an added bonus. You can lock in your earning power and enjoy high yields for the term of your choice — from twelve months to five years. And all it takes to get started is a minimum deposit of \$5,000. We also provide tiered rates for higher balances. For more information and to see the full bonus structure, call or visit any branch or visit vystarcu.org.

Bonus Table					
"New Money" Deposit Amount					
TERM	\$5,000 - \$9,999.99	\$10,000 - \$24,999.99	\$25,000 - \$49,999.99	\$50,000 - \$99,999.99	\$100,000+
12 Months	\$10	\$20	\$50	\$100	\$200
18 Months	\$15	\$30	\$75	\$150	\$300
24 Months	\$20	\$40	\$100	\$200	\$400
30 Months	\$25	\$50	\$125	\$250	\$500
36 Months	\$30	\$60	\$150	\$300	\$600
48 Months	\$40	\$80	\$200	\$400	\$800
60 Months	\$50	\$100	\$250	\$500	\$1,000

352-224-6000 or 1-800-445-6289

FEDERALLY REGULATED BY NCUA. *In order to receive the bonus amount, CD must be funded with funds from a financial institution other than VyStar Credit Union. Bonus will be credited on the next business day after CD is opened and funded. Early withdrawal penalty applies and bonus amount will be deducted from CD if closed prior to maturity date. Fee incurred could reduce earnings. Limited-time offer. All new accounts are subject to approval. Programs, services, rates, terms and conditions are subject to change at any time without notice. ©2018 VyStar Credit Union.

HUNT

From Page B1

a shallow grave on 41st Road. The body was taken to the Tallahassee medical examiner's office to be identified and to determine the cause of death.

Fuentes is a registered sex offender, on probation for a sexual battery in 2004 in Marion County. He was released from prison in December 2017 after serving 10 years for attempted murder, sheriff's deputies said in a news release Wednesday.

GET YOUR MEDICAL MARIJUANA CARD TODAY FOR ANY OF THE FOLLOWING CONDITIONS:

HIV/AIDS, Crohn's Disease, Cancer, Parkinson's Disease, Multiple Sclerosis, Epilepsy, PTSD, Glaucoma, and any medical conditions of the comparable to those listed above.



Walk-ins welcome anytime from 10 am until 6 pm, Monday-Friday!

NO RECURRING MEMBERSHIP FEES

NO 3 MONTH WAITING PERIOD

Get the help you deserve, and get it now!

Call now for a **FREE EVALUATION** of your needs and condition **NO APPOINTMENT NECESSARY!**

Florida's Medical Marijuana Experts • Fast, Friendly Service Guaranteed

STOP BY OR CALL NOW!

2407 SW 13th St, Gainesville, FL • Next to High Tides

352-306-0220 • CertifiedMarijuanaDoctors.com



City of ALACHUA

NOTICE OF PUBLIC HEARING BEFORE THE CITY COMMISSION OF THE CITY OF ALACHUA, FLORIDA

Notice is hereby given that the Planning & Zoning Board of the City of Alachua will hold a public hearing on June 12, 2018 at 6:00 p.m. The hearing will be held in the James A. Lewis Commission Chambers in City Hall, located at 15100 NW 142nd Terrace, Alachua, Florida, to consider the following: A request by Ryan Thompson, AICP, of CHW, Inc., applicant and agent, for Lillie Belle Jeffords Life Estate and Trustees, Barbara Ann Lemley, Janet Schenck, Monaghan and Schenck Trustees, MP and Martha Monaghan, and Diane White, property owners, for consideration of a Large Scale Comprehensive Plan Amendment (LSCPA) to the City of Alachua Future Land Use Map (FLUM) to amend the FLUM from Rural/ Agriculture (County) to Moderate Density Residential on a ± 161.14 acre portion of the subject property and from Rural/Agriculture (County) to Community Commercial on a ± 76.44 acre portion of the subject property. The ± 237.58 acre property subject to the proposed amendment is located northeast of the intersection US Highway 441 and NW 188th Street, west of the Meadowglen Subdivision, consisting of Tax Parcel Numbers 03024-000-000, 03024-001-000, 03024-002-000, 03024-003-000, 03024-004-000, 03045-000-000, 03046-000-000, 03046-005-000, 03047-000-000, 03047-001-000, 03047-001-001, 03047-001-002, 03047-001-003, 03047-001-004, 03047-001-005 and 03048-002-000; Existing FLUM: Rural/Agriculture (County); Existing Zoning: Agricultural (A) (County).

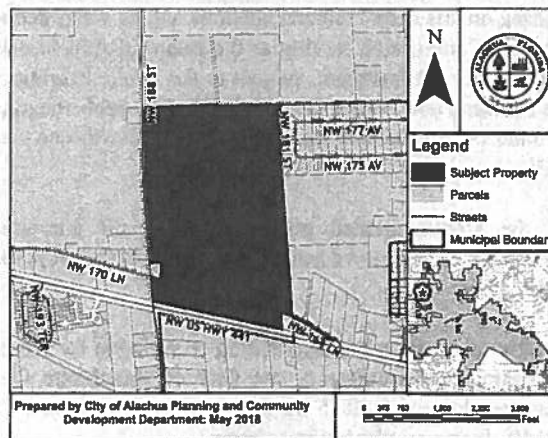

At the public hearing, all interested parties may appear and be heard with respect to the application. Copies of the application are available for public inspection at the Planning and Community Development Department, 15100 NW 142nd Terrace, Alachua, Florida, on any regular business day between the hours of 7:30 a.m. to 6:00 p.m. Written comments on the application may be sent to the following address: City of Alachua, Planning and Community Development, P.O. Box 9, Alachua, FL 32616. Notice is given pursuant to Section 286.0105, Florida Statutes, that, in order to appeal any decision made at the public hearing, you will need a record of the proceedings, and that, for such purpose, you may need to ensure that a verbatim record of the proceedings is made, which includes the testimony and evidence upon which the appeal is to be based. In accordance with the Americans with Disabilities Act, any persons with a disability requiring reasonable accommodation in order to participate in this meeting should call the City Clerk at (386) 418-6100 x 101 at least 48 hours prior to the public hearing.



City of
ALACHUA

THE GOOD LIFE COMMUNITY

Mailed 6/25/2018

(Kc)

NOTICE OF PUBLIC HEARING BEFORE THE PLANNING AND ZONING BOARD OF THE CITY OF ALACHUA, FLORIDA

Notice is hereby given that the Planning & Zoning Board of the City of Alachua will hold a public hearing on July 10, 2018 at 6:00 p.m. The hearing will be held in the James A. Lewis Commission Chambers in City Hall, located at 15100 NW 142nd Terrace, Alachua, Florida, to consider the following: A request by Ryan Thompson, AICP, of CHW, Inc., applicant and agent, for Lillie Belle Jeffords Life Estate and Trustees, Barbara Ann Lemley, Janet Schenck, Monaghan and Schenck Trustees, MP and Martha Monaghan, and Diane White, property owners, for consideration of a Large Scale Comprehensive Plan Amendment (LSCPA) to the City of Alachua Future Land Use Map (FLUM) to amend the FLUM from Rural/ Agriculture (County) to Moderate Density Residential on a ±161.14 acre portion of the subject property and from Rural/Agriculture (County) to Community Commercial on a ± 76.44 acre portion of the subject property. The ±237.58 acre property subject to the proposed amendment is located northeast of the intersection US Highway 441 and NW 188th Street, west of the Meadowglen Subdivision, consisting of Tax Parcel Numbers 03024-000-000, 03024-001-000, 03024-002-000, 03024-003-000, 03024-004-000, 03045-000-000, 03046-000-000, 03046-005-000, 03047-000-000, 03047-001-000, 03047-001-001, 03047-001-002, 03047-001-003, 03047-001-004, 03047-001-005 and 03048-002-000; Existing FLUM: Rural/Agriculture (County); Existing Zoning: Agricultural (A) (County).

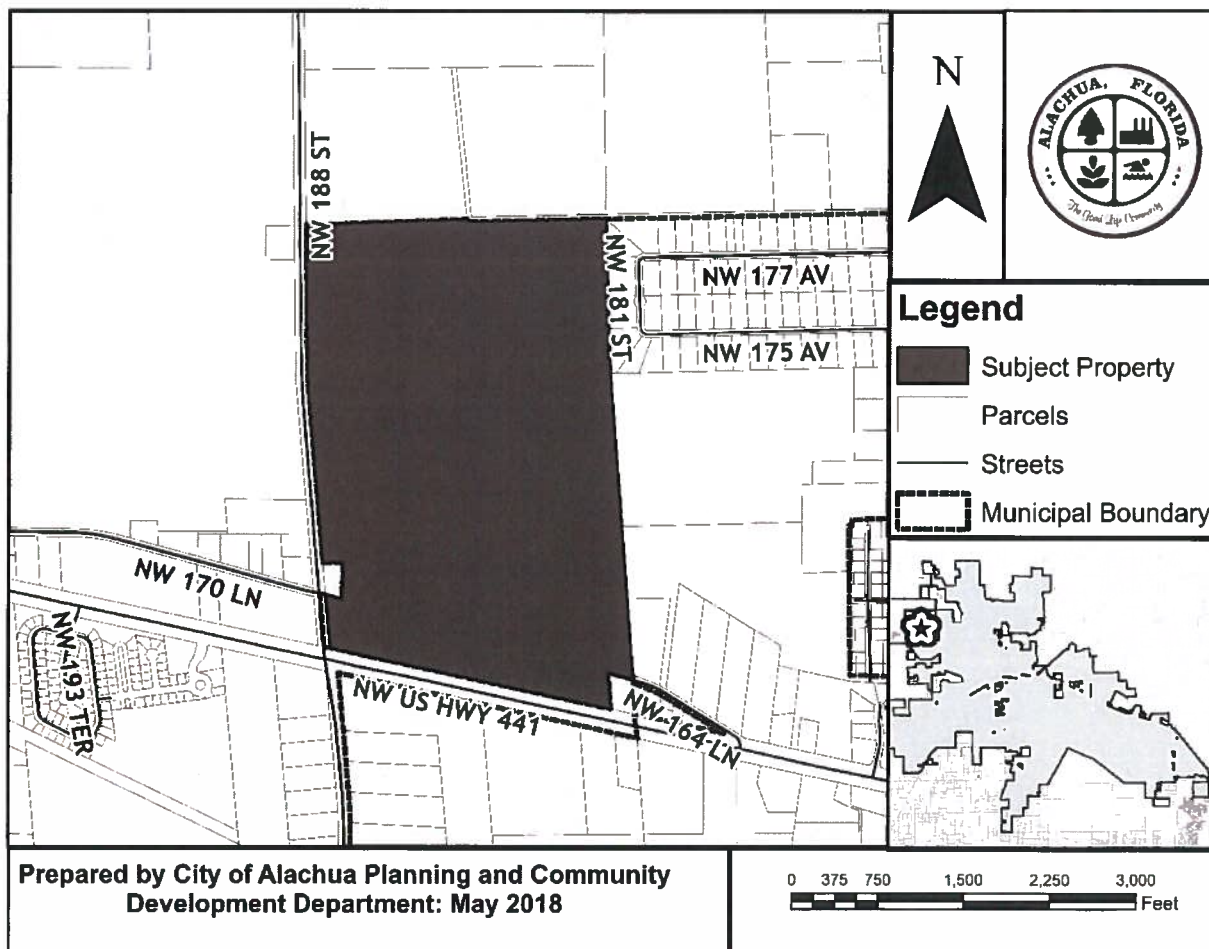

(Notice continues on next page)

P.O. Box 9 ♦ Alachua, Florida 32616-0009
Phone: (386) 418-6121 ♦ Fax: (386) 418-6130

03024-000-000
JEFFORDS, LILLIE BELLE TRUSTEE
2910 LASSITER MANOR DR
MARIETTA GA 30062

03024-001-000
LEMLEY, BARBARA ANN
393 NW FAIRWAY DR
LAKE CITY FL 32055

03024-002-000
SCHENCK, JANET M
2910 LASSITER MANOR DR
MARIETTA GA 30062-8725

03024-003-000
LEMLEY, BARBARA ANN
393 NW FAIRWAY DR
LAKE CITY FL 32055

03024-004-000
SCHENCK, JANET M
2910 LASSITER MANOR DR
MARIETTA GA 30062-8725

03024-010-013
CARMICHAEL LAMAR & J
MARILYN
17579 NW 181ST ST
ALACHUA FL 32615

03024-020-013
BOYLE NEIL ANTHONY & SUSAN
ANNE
17994 NW 177TH AVE
ALACHUA FL 32615-4769

03024-020-015
DEPAOLA JOHN VINCENT &
LAUREN WHITEHEAD
17698 NW 181ST ST
ALACHUA FL 32615

03024-020-016
TAYLOR KENNETH T & BEVERLY A
17983 NW 177TH AVE
ALACHUA FL 32615-4770

03024-020-032
WOODLAND III LTD
PO BOX 357845
GAINESVILLE FL 32635-7845

03025-000-000
SPENCER, ARTHUR PRESCOTT JR
TR
4145 STATE RD 11
DELAND FL 32724

03026-000-000
MCGEHEE, CAROLYN S
26317 NW 78TH AVE
HIGH SPRINGS FL 32643-9768

03033-000-000
WHITE, I L & JOAN
115 COUNTRY CLUB RD
ARDMORE OK 73401

03035-003-001
LEVOCZ JOSEPH RUDOLPH
137 HIGHLANDS LAKE DR
LAKE PLACID FL 33852-9022

03035-003-003
CASON BART E
18832 NW 170TH LN
HIGH SPRINGS FL 32643

03035-003-004
BANK OF AMERICA
PO BOX 31785
TAMPA FL 33631-3785

03042-006-001
GONZALES, P S & ROSA LEE
16806 NW 175TH TER
ALACHUA FL 32615

03042-008-000
BRYAN, TAMMY D
5560 EMERALD RIDGE BLVD
LAKELAND FL 33813-5211

03042-050-003
ALACHUA FARM & LUMBER INC
PO BOX 2290
ALACHUA FL 32616

03042-050-004
CARTER, KEVIN L & SHIMA
7853 GUNN HIGHWAY
TAMPA FL 33626

03042-050-010
GERARD, GREGORY S
440 JEFF CLEMENTS RD
MARION KY 42064-7512

03042-051-001
GOLDEN POND FARMS INC
PO BOX 357133
GAINESVILLE FL 32635

03044-010-002
FLORIDA TIMBER CO
PO BOX 357133
GAINESVILLE FL 32635-7133

03044-010-003
GOLDEN POND FARMS INC
PO BOX 357133
GAINESVILLE FL 32635

03044-012-004
FLORIDA TIMBER CO
PO BOX 357133
GAINESVILLE FL 32635-7133

03044-012-005
FLORIDA TIMBER CO
PO BOX 357133
GAINESVILLE FL 32635-7133

03045-000-000
MONAGHAN & SCHENCK
TRUSTEES
2910 LASSITER MANOR DR
MARIETTA GA 30062

03046-000-000
JEFFORDS, LILLIE BELLE TRUSTEE
2910 LASSITER MANOR DR
MARIETTA GA 30062

03046-003-000
CARTER, KEVIN L & SHIMA
7853 GUNN HIGHWAY
TAMPA FL 33626

03046-004-000
NORTH FLA WATER SYSTEM INC
11814 NW 202ND ST
ALACHUA FL 32615-5924

03046-005-000
JEFFORDS, LILLIE BELLE LIFE ES
2910 LASSITER MANOR DR
MARIETTA GA 30062

03047-000-000
MONAGHAN, M P & MARTHA
10102 CHERRY HILLS AVENUE CIR
BRADENTON FL 34202-4064

03047-001-000
JEFFORDS, LILLIE BELLE TRUSTEE
2910 LASSITER MANOR DR
MARIETTA GA 30062

03047-001-001
WHITE, DIANE
375 TIMBERWOOD TRAIL
OVIEDO FL 32765-8999

03047-001-002
MONAGHAN, MARTHA K
10102 CHERRY HILLS AVENUE CIR
BRADENTON FL 34202-4064

03047-001-003
JEFFORDS, LILLIE BELLE LIFE ES
2910 LASSITER MANOR DR
MARIETTA GA 30062

03047-001-004
MONAGHAN, MARTHA KAY
10102 CHERRY HILLS AVE CIR
BRADENTON FL 34202

03047-001-005
WHITE, DIANE
375 TIMBERWOOD TRAIL
OVIEDO FL 32765

03047-002-000
BRAMLETT STEPHEN G
16825 NW 188TH ST
HIGH SPRINGS FL 32643

03048-002-000
JEFFORDS, LILLIE BELLE TRUSTEE
2910 LASSITER MANOR DR
MARIETTA GA 30062

03024-010-014
DOUGLAS JASON D
17598 NW 181ST ST
ALACHUA FL 32615

03024-010-016
LOFTHOUSE CARLA RAE
17502 NW 181ST ST
ALACHUA FL 32615

03024-010-017
KUNKEL, HARRY R
14416 NW 148TH PL
ALACHUA FL 32616

03024-010-018
RICH, C H & SANDRA
13704 55TH RD N
ROYAL PALM BEACH FL 33411-8354

03024-020-014
BECKER JOHN M
18028 NW 177TH AVE
ALACHUA FL 32615

03030-000-000
SUWANNEE RIVER WATER
MANAGEMENT
9225 COUNTY RD 49
LIVE OAK FL 32060

03030-001-001
CROY MICHAEL W & GENENE
RENE
17758 NW 188TH ST
HIGH SPRINGS FL 32643

03031-001-001
DADANT AND SON INC
PO BOX 888
HIGH SPRINGS FL 32655-0888

03038-001-000
LANG, VICTORIA S TRUSTEE
242 SE ST JOHNS ST
LAKE CITY FL 32025

03042-004-000
FELLOWS, BARBARA L
12330 NW 206TH TER
ALACHUA FL 32615

03042-005-000
WADFORD BETTY
4985 NW 39TH AVE
GAINESVILLE FL 32606-5947

03042-006-000
PULLIAM R L
18021 NW 164TH LN
ALACHUA FL 32615-4753

03042-007-000
ROBINSON & ROBINSON
16527 NW US HIGHWAY 441
ALACHUA FL 32615

03042-009-000
Howard & Howard Trustees
Po Box 20263
Tampa, FL 33622

Antoinette Endelicato
5562 NW 93rd Avenue
Gainesville, FL 32653

Dan Rhine
288 Turkey Creek
Alachua, FL 32615

Tom Gorman
9210 NW 59th Street
Alachua, FL 32653

Richard Gorman
5716 NW 93rd Avenue
Alachua, FL 32653

Peggy Arnold
410 Turkey Creek
Alachua, FL 32615

David Forest
23 Turkey Creek
Alachua, FL 32615

President of TCMOA
1000 Turkey Creek
Alachua, FL 32615

Linda Dixon, AICP
PO Box 115050
Gainesville, FL 32611

Craig Parenteau
4801 Camp Ranch Road
Gainesville, FL 32641

Jeannette Hinsdale
P.O. Box 1156
Alachua, FL 32616

Lynn Coullias
7406 NW 126th Ave
Alachua, FL 32615

Lynda Coon
7216 NW 126 Avenue
Alachua, FL 32615

Tamara Robbins
PO Box 2317
Alachua, FL 32616

Michele L. Lieberman
12 SE 1st Street
Gainesville, FL 32601

AFFIDAVIT FOR POSTED LAND USE SIGN

I Adam Hall, POSTED THE LAND USE
(Name)
SIGN ON 06/05/18 FOR THE LSCPA- Jeffords Farm
(Date) (State type of action and project name)
LAND USE ACTION.

AS PER ARTICLE 2.2.9 D OF THE LAND DEVELOPMENT REGULATIONS.

THIS WILL BE INCLUDED IN THE STAFF REPORT.

CU 2/11
(Signature)

6
(Number of signs)