

Ocala area society hosts regional daylily meeting



Barbara Wachter, Ocala Area Daylily Society Vice President, is shown visiting a daylily garden.
[SUBMITTED PHOTO]

By Annabelle Leitner
Correspondent

OCALA — The members of the Ocala Area Daylily Society have been busy since May 2017 preparing for the American Hemerocallis Society Region 12 Fall meeting in Ocala on Saturday.

Region 12, which includes all of Florida, has two regional meetings a year, in the spring and fall. The event being held in Ocala will begin at 9 a.m. Saturday at VFW Post 4209, at 4805 NE 36th Ave. It will include the meeting and workshops, for which participants must pre-register, and which includes lunch, for a fee of \$30.

The keynote speaker will be Tim Bell, of Bell's Daylily Garden in Sycamore, Georgia, which is home to more than 900 varieties of daylilies.

The regional meeting event will include clinics, silent and live auctions, raffles and door prizes.

In conjunction, members of the public can purchase daylilies beginning at 9 a.m. Saturday, at \$5 a plant, in different varieties and colors, until they are sold out.

"The Ocala Area Daylily Society formed about four years ago," said president Pat Hawk of Reddick. "This is the first time the society has hosted anything like this regional meeting. It is a small group, with only a dozen or so working to pull together the meeting."

Hawk described the upcoming event as educational, but said it also is a social event during which those who are interested in learning about daylilies can exchange ideas and methods.

According to Gene Perry of Castleberry, a member of the Ocala group, who arranged for Bell to speak, he is excited for the presentation as "Bell has one of the finest gardens in the country."

The scientific name for daylily is *hemerocallis*. The genus *hemerocallis*

If you go

What: Daylily plant sale hosted by Ocala Area Daylily Society
When: Beginning at 9 a.m. Saturday; \$5 per plant until sold out
Where: VFW Post 4209, 4805 NE 36th Ave., Ocala
Contact: 591-3120
Extra: American Hemerocallis Society Region 12 meeting, \$30, must pre-register

is native to Asia. The American Daylily Society, also known as the American Hemerocallis Society, Inc., is a nonprofit service organization established in 1946, whose membership includes more than 5,000 members worldwide.

According to Taglilien am Niederrhein, a daylily garden in Niederrhein, Germany, the words "hemera" and "kallos" mean "day" and "beauty." Each flower blooms only for a day. One mature flower stalk can produce dozens of flower buds. An older plant, for example, can produce up to 500 flowers. This extends the flowering period up to four weeks. Through a combination of early and late flowering varieties, that makes a flowering period of several months possible.

The garden's information online states that by the mid-1920s, Americans became involved in daylily breeding and have taken the lead. Among the reasons for success are excellent climatic conditions, especially in Florida, during which a newly planted seedling will usually bloom in the first year. In Germany you must wait, usually two or more years, until a seedling gets to bloom.

By 2011, there were more than 70,000 registered daylily varieties throughout the world.

According to the American Daylily Society's website, "Originally, the only colors were yellow,

See DAYLILY, B7

Building Relationships, One Family At A Time

Phillip Wilely
MORTUARY INC.

310 STATE ROAD 26, MELROSE, FL 32666
WWW.PHILLIPWILEY.COM | PHONE 352-475-2000 | FAX 352-475-2004
Service Beyond Expectation

ELDER OPTIONS

**Do you provide care for a loved one or friend?
Can you spare 1 1/2 hours?**

To learn more about participating in a focus group on the needs of caregivers, please call Kathy Dorminey at Elder Options (352) 692-5214 or send email to dormineyk@agingresources.org
Respond by October 5, 2018.
Not all who express interest will be selected.
Food will be provided.

NOTICE OF PUBLIC HEARING BEFORE THE PLANNING AND ZONING BOARD OF THE CITY OF ALACHUA, FLORIDA

Notice is hereby given that the Planning and Zoning Board of the City of Alachua will hold a public hearing on October 9, 2018 at 6:00 p.m. The hearing will be held in the James A. Lewis Commission Chambers in City Hall, located at 15100 NW 142nd Terrace, Alachua, Florida, to consider the following: A request by Christopher Gmuer, P.E., of Gmuer Engineering, LLC, applicant and agent, for Wallace Cain, property owner, for consideration of a Site-Specific Amendment to the Official Zoning Atlas (Rezoning) to amend the Official Zoning Atlas from Community Commercial (CC) to Residential Single Family - 3 (RSF-3) on a ±20.0 acre subject property, located at 17002 NW County Road 241, south and west of the intersection of NW County Road 241 and NW 172nd Avenue, consisting of a portion of Tax Parcel Number 03067-005-000; Future Land Use Map (FLUM) Designation: Moderate Density Residential; Existing Zoning: Community Commercial (CC).

At the public hearing, all interested parties may appear and be heard with respect to the application. Copies of the application are available for public inspection at the Planning and Community Development Department, 15100 NW 142nd Terrace, Alachua, Florida, on any regular business day between the hours of 7:30 a.m. to 6:00 p.m. Written comments on the application may be sent to the following address: City of Alachua, Planning and Community Development, P.O. Box 9, Alachua, FL 32616. Notice is given pursuant to Section 286.0105, Florida Statutes, that, in order to appeal any decision made at the public hearing, you will need a record of the proceedings, and that, for such purpose, you may need to ensure that a verbatim record of the proceedings is made, which includes the testimony and evidence upon which the appeal is to be based. In accordance with the Americans with Disabilities Act, any persons with a disability requiring reasonable accommodation in order to participate in this meeting should call the City Clerk at (386) 418-6100 x 101 at least 48 hours prior to the public hearing.

The Gainesville Community Playhouse presents

ONE THE MUSICAL

SEPT. 14-OCT. 7

Get tickets at www.gcplayhouse.org/

Visit **GAINESVILLE** Alachua County, FL
Gainesville. Citizen centered. People empowered.
CULTURE BUILDS FLORIDA

The Gainesville Community Playhouse at the Vam York Theater
4039 NW 16th Blvd. 352.376.4949
www.gcplayhouse.org
Find us on **f**

NOTICE OF PUBLIC HEARING BEFORE THE PLANNING AND ZONING BOARD OF THE CITY OF ALACHUA, FLORIDA

Notice is hereby given that the Planning and Zoning Board of the City of Alachua will hold a public hearing on October 9, 2018 at 6:00 p.m. The hearing will be held in the James A. Lewis Commission Chambers in City Hall, located at 15100 NW 142nd Terrace, Alachua, Florida, to consider the following: A request by Ryan Thompson, AICP, of CHW, Inc., applicant and agent, for Alachua A One, LLC, property owner, for consideration of a Site Specific Amendment to the Official Zoning Atlas (Rezoning) from Commercial Intensive (CI) (±21.2 acres), Residential Multiple Family - 8 (RMF-8) (±36 acres), and Residential Single Family - 4 (RSF-4) (±40 acres) to Commercial Intensive (CI) (±2.11 acres), Corporate Park (27.88 acres), Residential Multiple Family - 15 (RMF-15) (±27.88 acres), and Residential Single Family - 4 (RSF-4) (±39.36 acres) on a ±97.23 acre subject property; located west of Interstate 75, east of the Heritage Oaks subdivision, and north of US Highway 441 and the HighPoint Crossing subdivision; consisting of a portion of Tax Parcel Number 03049-000-000; Existing FLUM Designations: Moderate Density Residential, Medium Density Residential, Commercial; Existing Zoning: Commercial Intensive (CI), Residential Multiple Family - 8 (RMF-8), Residential Single Family - 4 (RSF-4); Overlay District: Gateway Overlay District.

At the public hearing, all interested parties may appear and be heard with respect to the application. Copies of the application are available for public inspection at the Planning and Community Development Department, 15100 NW 142nd Terrace, Alachua, Florida, on any regular business day between the hours of 7:30 a.m. to 6:00 p.m. Written comments on the application may be sent to the following address: City of Alachua, Planning and Community Development, P.O. Box 9, Alachua, FL 32616. Notice is given pursuant to Section 286.0105, Florida Statutes, that, in order to appeal any decision made at the public hearing, you will need a record of the proceedings, and that, for such purpose, you may need to ensure that a verbatim record of the proceedings is made, which includes the testimony and evidence upon which the appeal is to be based. In accordance with the Americans with Disabilities Act, any persons with a disability requiring reasonable accommodation in order to participate in this meeting should call the City Clerk at (386) 418-6100 x 101 at least 48 hours prior to the public hearing.



This is a daylily cultivar produced by Ocala Area Daylily Society President Pat Hawk of Reddick. The group is hosting a regional meeting and plant sale on Saturday in Ocala. [SUBMITTED PHOTO]

This is a daylily hybridized by Ocala Area Daylily Society President Pat Hawk of Reddick. [SUBMITTED PHOTO]



LITERACY:

Continued from page A1

Library districts, Dudley Farms State Park and Gentle Carousel Miniature Therapy Horses all helped with event



Photos special to Alachua County Today

ABOVE LEFT: Ranger Scout helped with the Gentle Carousel program, then took walks with individual children who waited in line after the event. **ABOVE RIGHT:** Columbia County Library District had craft activities for children.

children and a river walk led by a park ranger. Food and drink was available for purchase.

Both the Alachua County Library District and the Columbia County Library District sponsored booths offering activities for children. Dudley Farms State Park also sponsored a booth with educational games and activities for children. Gentle Carousel Miniature Therapy Horses presented a book lovers program in the main

Pavilion. The real life characters from the book, Mercury and Sirius, participated. Gentle Therapy Horse Ranger Scout helped with the Gentle Carousel program, and then took walks with individual children who waited in line after the event.

Email editor@
alachuatoday.com

UTILITY RATES:

Continued from page A1

expenses. Although the City's millage rate for 2019 stayed the same as the prior year, State law requires it to be advertised as a "tax increase."

In public hearings and second readings of Ordinances 2018-15, 2018-16 and 2018-17, proposed utility rates were presented and discussed.

Water and wastewater

Electric rates increased for first time in nine years

rate changes were proposed at the Aug. 2 Budget Workshop and were approved at the Sept. 24 meeting.

Water rates were adjusted by 2.9 percent in the consumption charges and \$1 on the customer charge, for an average residential impact of \$1.41 per month. The City of Newberry, even with these

changes, has some of the lowest utility rates in the area.

Wastewater rates were adjusted by one percent in the consumption charges with no change in the customer charge, for an average residential impact of \$0.48 per month.

Electric rates were increased, for the first time in nine years, by 1.80

percent for an average bill impact of \$2 and solid waste rates were increased by \$1 from \$14.75 to \$15.75. In 2017, the City reduced its Solid Waste rates by \$5 per month per customer.

Email cwalker@
alachuatoday.com

LIONS:

Continued from page A1

Local president credits entire club for efforts

The award is based on the number of total participants trained by each club and the largest net membership growth. There were only four such honors awarded this year out of over 4,600 clubs worldwide.

Although the award is presented to the club president, Smith credits the entire club. "The important thing is that although the award is addressed to me, this could not have happened without the dedication and hard work of the other members. Without them this would never have happened" Smith said. "I maybe directing the club as president, but it took

the members of the club to get the new inductees and bring it all together. It was not something I did alone, it was a group effort, so this medal is for the whole club," he said.

"The best part is the recognition of our efforts at the international level. It puts the High Springs Lions Club on the map and brings more awareness to the humanitarian services and charities Lions Clubs are providing. The goal is to help those that need it," Smith said.

Email rcarson@
alachuatoday.com

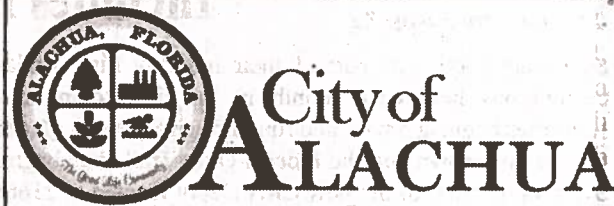

NOTICE OF PUBLIC HEARING BEFORE THE PLANNING AND ZONING BOARD OF THE CITY OF ALACHUA, FLORIDA

Notice is hereby given that the Planning and Zoning Board of the City of Alachua will hold a public hearing on October 9, 2018 at 6:00 p.m. The hearing will be held in the James A. Lewis Commission Chambers in City Hall, located at 15100 NW 142nd Terrace, Alachua, Florida, to consider the following: A request by Ryan Thompson, AICP, of CHW, Inc., applicant and agent, for Alachua A One, LLC, property owner, for consideration of a Site Specific Amendment to the Official Zoning Atlas (Rezoning) from Commercial Intensive (CI) (±21.2 acres), Residential Multiple Family - 8 (RMF-8) (±36 acres), and Residential Single Family - 4 (RSF-4) (±40 acres) to Commercial Intensive (CI) (±2.11 acres), Corporate Park (27.88 acres), Residential Multiple Family - 15 (RMF-15) (±27.88 acres), and Residential Single Family - 4 (RSF-4) (±39.36 acres) on a ±97.23 acre subject property; located west of Interstate 75, east of the Heritage Oaks subdivision, and north of US Highway 441 and the HighPoint Crossing subdivision; consisting of a portion of Tax Parcel Number 03049-000-000; Existing FLUM Designations: Moderate Density Residential, Medium Density Residential, Commercial; Existing Zoning: Commercial Intensive (CI), Residential Multiple Family - 8 (RMF-8), Residential Single Family - 4 (RSF-4); Overlay District: Gateway Overlay District.

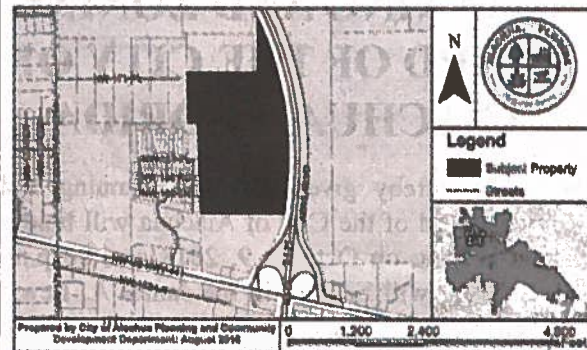

At the public hearing, all interested parties may appear and be heard with respect to the application. Copies of the application are available for public inspection at the Planning and Community Development Department, 15100 NW 142nd Terrace, Alachua, Florida, on any regular business day between the hours of 7:30 a.m. to 6:00 p.m. Written comments on the application may be sent to the following address: City of Alachua, Planning and Community Development, P.O. Box 9, Alachua, FL 32616. Notice is given pursuant to Section 286.0105, Florida Statutes, that, in order to appeal any decision made at the public hearing, you will need a record of the proceedings, and that, for such purpose, you may need to ensure that a verbatim record of the proceedings is made, which includes the testimony and evidence upon which the appeal is to be based. In accordance with the Americans with Disabilities Act, any persons with a disability requiring reasonable accommodation in order to participate in this meeting should call the City Clerk at (386) 418-6100 x 101 at least 48 hours prior to the public hearing.

(Published: Alachua County Today - September 27, 2018)

DEADLINE TO REGISTER TO VOTE



Verify your registration status at VoteAlachua.com
2018 General Election
November 6



office: 352-374-5252
fax: 352-374-5264
Josiah T. Walls Building
515 N. Main Street, Suite 300
Gainesville, FL 32601-3348
VoteAlachua.com



City of
ALACHUA

THE GOOD LIFE COMMUNITY

Mailed 9/24/2018

KC

NOTICE OF PUBLIC HEARING BEFORE THE PLANNING AND ZONING BOARD OF THE CITY OF ALACHUA, FLORIDA

Notice is hereby given that the Planning and Zoning Board of the City of Alachua will hold a public hearing on October 9, 2018 at 6:00 p.m. The hearing will be held in the James A. Lewis Commission Chambers in City Hall, located at 15100 NW 142nd Terrace, Alachua, Florida, to consider the following: A request by Ryan Thompson, AICP, of CHW, Inc., applicant and agent, for Alachua A One, LLC, property owner, for consideration of a Site Specific Amendment to the Official Zoning Atlas (Rezoning) from Commercial Intensive (CI) (±21.2 acres), Residential Multiple Family – 8 (RMF-8) (±36 acres), and Residential Single Family – 4 (RSF-4) (±40 acres) to Commercial Intensive (CI) (±2.11 acres), Corporate Park (27.88 acres), Residential Multiple Family – 15 (RMF-15) (±27.88 acres), and Residential Single Family – 4 (RSF-4) (±39.36 acres) on a ±97.23 acre subject property; located west of Interstate 75, east of the Heritage Oaks subdivision, and north of US Highway 441 and the HighPoint Crossing subdivision; consisting of a portion of Tax Parcel Number 03049-000-000; Existing FLUM Designations: Moderate Density Residential, Medium Density Residential, Commercial; Existing Zoning: Commercial Intensive (CI), Residential Multiple Family – 8 (RMF-8), Residential Single Family – 4 (RSF-4); Overlay District: Gateway Overlay.

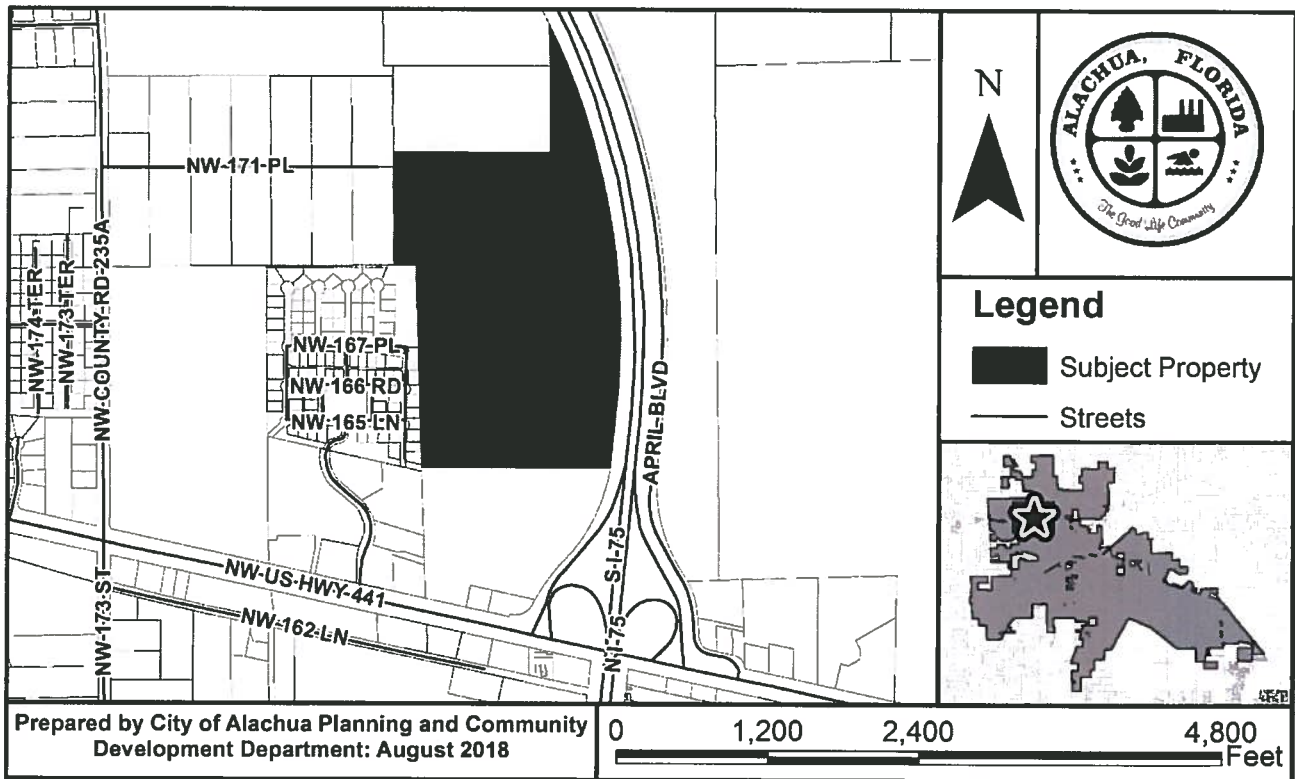

District.

At the public hearing, all interested parties may appear and be heard with respect to the application. Copies of the application are available for public inspection at the Planning and Community Development Department, 15100 NW 142nd Terrace, Alachua, Florida, on any regular business day between the hours of 7:30 a.m. to 6:00 p.m. Written comments on the application may be sent to the following address: City of Alachua, Planning and Community Development, P.O. Box 9, Alachua, FL 32616. Notice is given pursuant to Section 286.0105, Florida Statutes, that, in order to appeal any decision made at the public hearing, you will need a record of the proceedings, and that, for such purpose, you may need to ensure that a verbatim record of the proceedings is made, which includes the testimony and evidence upon which the appeal is to be based. In accordance with the Americans with Disabilities Act, any persons with a disability requiring reasonable accommodation in order to participate in this meeting should call the City Clerk at (386) 418-6100 x 101 at least 48 hours prior to the public hearing.

P.O. Box 9 ♦ Alachua, Florida 32616-0009
Phone: (386) 418-6121 ♦ Fax: (386) 418-6130

03053-010-053
DAVIS MAUREEN
16624 NW 165TH TER
ALACHUA FL 32615

03049-003-000
ALACHUA A ONE LLC
15260 NW 147TH DR STE 100
ALACHUA FL 32615

03050-000-000
SPENCER, ARTHUR PRESCOTT
JR TR
4145 STATE RD 11
DELAND FL 32724

03049-001-002
BURGETTO GAETANO &
STELLA M
16615 NW 171ST PL
ALACHUA FL 32615

03053-020-056
DURATION BUILDERS INC
527 TURKEY CREEK
ALACHUA FL 32615

03053-020-058
WEALING RITA L & GENE A
16831 NW 166TH DR
ALACHUA FL 32615

03053-020-063
RICHMAN & RICHMAN-
SANFORD H/W
16778 NW 166TH DR
ALACHUA FL 32615

03053-020-059
DURATION BUILDERS INC
527 TURKEY CREEK
ALACHUA FL 32615

03053-020-062
VISION CONSTRUCTION INC
3201 NW 202ND ST
NEWBERRY FL 32669

03053-020-069
GALLMAN BRITTANY F &
MATTHEW C
16879 NW 167TH ST
ALACHUA FL 32615

03053-020-055
DURATION BUILDERS INC
527 TURKEY CREEK
ALACHUA FL 32615

03049-001-011
KENNA VICKY ANN
16609 NW 171ST PL
ALACHUA FL 32615-4863

03053-020-060
DURATION BUILDERS INC
527 TURKEY CREEK
ALACHUA FL 32615

03053-020-070
DURATION BUILDERS INC
527 TURKEY CREEK
ALACHUA FL 32615

03053-020-057
DURATION BUILDERS INC
527 TURKEY CREEK
ALACHUA FL 32615

03053-020-061
KARA BOLTON HOMES INC
9145 SW 49TH PL STE A
Gainesville FL 32608

03053-020-068
BODNER JENNIFER
16857 NW 167TH ST
ALACHUA FL 32615

03053-010-000
HERITAGE OAKS PROPERTY,
OWNERS
PO BOX 969
Alachua FL 32615

03053-020-000
HERITAGE OAKS PROPERTY
OWNERS ASSOCIATION INC
15010 NW 173RD ST
ALACHUA FL 32615

03053-001-008
ALACHUA COUNTY FARM
BUREAU INC
14435 NW US HIGHWAY 441 STE
20

03049-000-000
ALACHUA A ONE LLC
15260 NW 147TH DR STE 100
ALACHUA FL 32615

03053-001-002
TALAL PROPERTIES LTD &
TAREK PROPERTIES LTD
1326 E LUMSDEN RD
BRANDON FL 33511

03053-001-010
THE CITY OF ALACHUA
PO BOX 9
ALACHUA FL 32616

03053-001-007
ALACHUA FL 0716 LLC
100 2ND AVE SOUTH STE 1103-S
PETERSBURG FL 33701

03053-001-005
A MASON GRACE RENTALS LLC
13929 NW 166TH TER
ALACHUA FL 32615

03053-001-009
ALACHUA A ONE LLC
15260 NW 147TH DR STE 100
ALACHUA FL 32615

03053-001-001
HIPPI INVESTMENTS LLC
14610 NW 129TH TER
ALACHUA FL 32615

03053-010-052
CAMPBELL MICHAEL PATRICK
& ADRIENEE MARIE
16644 NW 165TH TER
Alachua FL 32615

03053-010-050

03053-010-012
FROMHOLT DAVID B & SUSAN E
16575 NW 165TH TER
ALACHUA FL 32615

03053-010-036
HARBACH WENDY
16539 NW 167TH PL
ALACHUA FL 32615

03053-010-037
FLOYD & RUTTENBER
16518 NW 166TH RD
ALACHUA FL 32615

03053-010-016
CARTER DIANE S
8502 NW 35TH RD
GAINESVILLE FL 32606

03053-010-051
HARRIS AARON A
16609 NW 166TH DR
ALACHUA FL 32615

03049-002-000
MILLIKEN, ROBERT P
16091 NW US HIGHWAY 441
ALACHUA FL 32615

03049-001-010
BULLARD DONALD E & GLENDA
M
PO BOX 417
ALACHUA FL 32616

03053-010-018
WALLACE CHARLES E &
PATRICIA A
16621 NW 165TH LN
ALACHUA FL 32615

03061-000-000
CHASING CHICKEN 2 INC
2591 CENTERVILLE RD STE 202
TALLAHASSEE FL 32308

03053-010-054
SCHULTZ, RICHARD B &
CECILIA
1171 APPIAN WAY
SANTA ANA CA 92705

03061-004-000
DWARKADHISH INVESTMENTS
INC
1800 S ATLANTIC AVE
DAYTONA BEACH FL 32118

03061-004-001
T & H PROPERTY GROUP LLC
300 SW 143RD ST
NEWBERRY FL 32669

03049-001-000
DONOFRIO, JACQULYN MARIE
5810 SW 164TH TER
SOUTHWEST RANCHES FL
33331-1397

03053-002-000
PATEL, INDIRA K
8706 SADDLEHORN DR
IRVING TX 75063

03053-010-017
NYGAARD & STRATTAN
16567 NW 165TH LN
ALACHUA FL 32615

03053-010-010
BOUTON MATTHEW J & AMBER
M
16631 NW 165TH TER
ALACHUA FL 32615

03017-002-000
SPENCER, ARTHUR PRESCOTT
JR TR
4145 STATE RD 11
DELAND FL 32724

03053-010-009
OSEJO RAMON J & JANICE F
16681 NW 165TH TER
ALACHUA FL 32615-4992

03053-010-011
GRAY BRIAN S & MISTY D
16611 NW 165TH TER
ALACHUA FL 32615

03053-010-013
JELMBERG MICHAEL & MARY
16545 NW 165TH TER
ALACHUA FL 32615

03053-010-014
FORD NATHANIEL M III &
TIROSHSA T
16515 NW 165TH TER
ALACHUA FL 32615

03053-010-015
MITCHELL CHARLES E &
NANCY E
16530 NW 165TH TER
ALACHUA FL 32615

03053-010-034

03053-010-035

03053-010-038
HANCOCK TROY DANIEL
16548 NW 166TH RD
ALACHUA FL 32615

03053-010-039
RIEHLE DANIEL R
16578 NW 166TH RD
ALACHUA FL 32615

03053-010-040
HYDEN & HYDEN
16622 NW 166TH RD
Alachua FL 32615

03053-010-049
MEADOWS & MEADOWS
16649 NW 166TH DR
ALACHUA FL 32615-4996



ANTOINETTE ENDELICATO
5562 NW 93RD AVENUE
GAINESVILLE, FL 32653

DAN RHINE
288 TURKEY CREEK
ALACHUA, FL 32615

TOM GORMAN
9210 NW 59TH STREET
ALACHUA, FL 32653

RICHARD GORMAN
5716 NW 93RD AVENUE
ALACHUA, FL 32653

PEGGY ARNOLD
410 TURKEY CREEK
ALACHUA, FL 32615

DAVID FOREST
23 TURKEY CREEK
ALACHUA, FL 32615

PRESIDENT OF TCMOA
1000 TURKEY CREEK
ALACHUA, FL 32615

LINDA DIXON, AICP
PO BOX 115050
GAINESVILLE, FL 32611

CRAIG PARENTEAU
4801 CAMP RANCH ROAD
GAINESVILLE, FL 32641

JEANNETTE HINSDALE
P.O. BOX 1156
ALACHUA, FL 32616

LYNN COULLIAS
7406 NW 126TH AVE
ALACHUA, FL 32615

LYNDA COON
7216 NW 126 AVENUE
ALACHUA, FL 32615

TAMARA ROBBINS
PO BOX 2317
ALACHUA, FL 32616

MICHELE L. LIEBERMAN
12 SE 1ST STREET
GAINESVILLE, FL 32601

03053-020-064

**VISION CONSTRUCTION INC
3201 NW 202ND ST
NEWBERRY FL 32669**

03053-020-067

**LILKENDEY JAMES H &
FRANCES C
16819 NW 167TH ST
ALACHUA FL 32615**

03053-020-069

**GALLMAN BRITTANY F &
MATTHEW C
16879 NW 167TH ST
ALACHUA FL 32615**

AFFIDAVIT FOR POSTED LAND USE SIGN

I Sandra B. Thomas, POSTED THE LAND USE
SIGN ON 9/20/18 FOR THE HighPoint Crossing Rezoning - PZB
(name) (date) (state type of action and project name)
LAND USE ACTION.

AS PER ARTICLE 2.2.9 D OF THE LAND DEVELOPMENT REGULATIONS.

THIS WILL BE INCLUDED IN THE STAFF REPORT.

Sandra B. Thomas
(signature)

7
(number of signs)