

WEATHER

TODAY'S UV INDEX

10 a.m. noon 2 p.m. 4 p.m.

3 7 7 3

The higher the AccuWeather.com UV Index® number, the greater the need for eye and skin protection. 0-2: Low, 3-5: Moderate, 6-7: High, 8-10: Very High, 11+: Extreme.

FIVE-DAY FORECAST FOR GAINESVILLE

Today

84°
67°

Thunderstorms

Chance of rain: 65%

Winds: E 7-14 mph

Friday

85°
66°

Thunderstorms

Chance of rain: 65%

Winds: E 6-12 mph

Saturday

89°
68°

A t-storm in spots

Chance of rain: 40%

Winds: WSW 6-12 mph

Sunday

86°
67°

Cloudy, a t-storm

Chance of rain: 55%

Winds: WSW 7-14 mph

Monday

90°
66°

A thunderstorm

Chance of rain: 55%

Winds: WSW 3-6 mph

SUN AND MOON

Sunrise today 6:46 a.m.

Sunset tonight 8:06 p.m.

Moonrise today 5:41 a.m.

Moonset today 6:08 p.m.

New

First

Full

Last

May 4

May 11

May 18

May 26

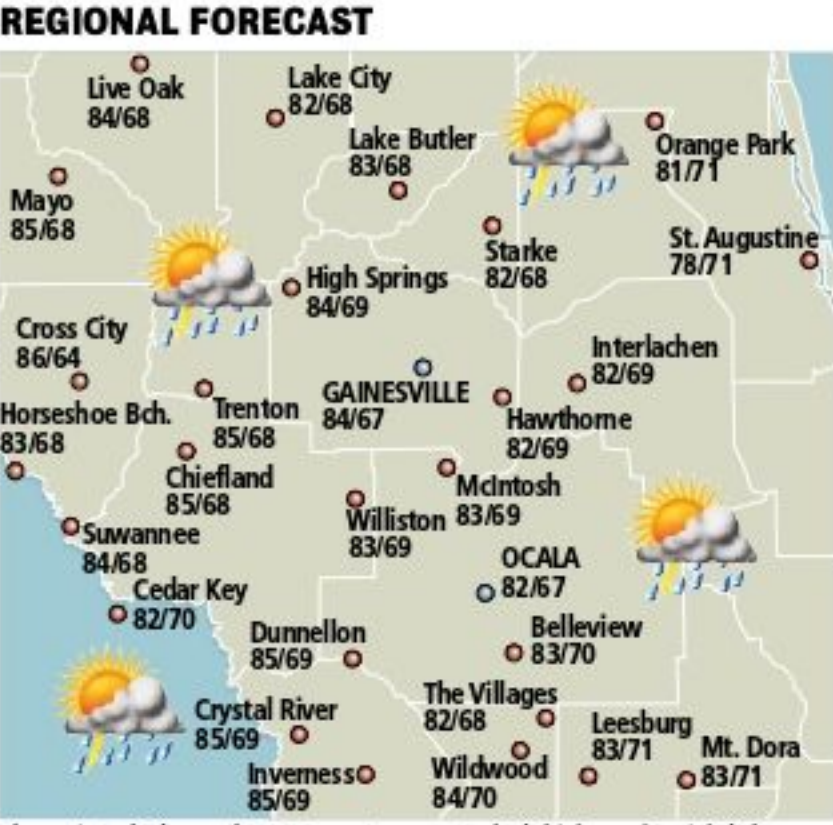

POLLEN INDEX

ABSENT LOW MODERATE HIGH VERY HIGH

SOURCE: AccuWeather.com

WEATHER TRIVIA™

Q: What change in weather will alter the length of your hair?

A: Any sunny day.

TODAY'S TIDES

	High	Low
Boca Grande	12:08 a.m. 5:42 a.m.	12:05 p.m. 6:18 p.m.
Cedar Key	1:08 a.m. 7:15 a.m.	1:16 p.m. 7:46 p.m.
Crystal River	3:41 a.m. 10:14 a.m.	3:50 p.m. 10:38 p.m.
Daytona Beach	6:59 a.m. 12:53 a.m.	7:19 p.m. 1:06 p.m.
Homosassa Bay	5:14 a.m. 11:33 a.m.	5:06 p.m. none
Ponce Inlet	7:47 a.m. 1:51 a.m.	8:17 p.m. 2:08 p.m.
St. Augustine	7:35 a.m. 1:36 a.m.	7:55 p.m. 1:49 p.m.
Withlacoochee	1:15 a.m. 8:10 a.m.	1:23 p.m. 8:41 p.m.

COASTAL CONDITIONS

Savannah to St. Augustine: Wind east 7-14 knots today. Seas 3-6 feet. Inland waterways a light chop. Visibility under 2 miles in a thunderstorm.

St. Augustine to Jupiter Inlet: Wind east at 8-16 knots today. Seas 4-8 feet. Inland waterways a light chop. Visibility under a mile in showers and thunderstorms.

Tarpon Springs to Apalachicola: Wind east 4-8 knots today. Seas 1-2 feet. Inland waterways mostly smooth. Visibility under 2 miles in a thunderstorm.

SOLUNAR TABLES

The solunar period indicates peak feeding times for fish and game.

Day	Major A.M.	Minor P.M.	Major P.M.	Minor
Today	10:30	4:20	10:52	4:41
Fri.	11:10	4:59	11:32	5:21
Sat.	11:53	5:41	---	6:04

AIRPORT REPORT

ATLANTA: Partly sunny. High 85, Low 67

CHARLOTTE: Very warm with clouds and sun. High 85, Low 62

JACKSONVILLE: An afternoon thunderstorm. High 81, Low 67

MIAMI: Showers and a heavier t-storm. High 83, Low 75

ORLANDO: Showers and a heavier t-storm. High 83, Low 70

TAMPA: Showers and a heavier t-storm. High 86, Low 72

TODAY'S FIRE RISK

LOW MODERATE HIGH EXTREME

SOURCE: U.S. Forest Service

NATION & WORLD

	Today	Tomorrow
U.S. CITIES	Hi/Lo/W	Hi/Lo/W
Albany	67/49/c	64/51/r
Albuquerque	75/49/s	74/49/s
Allentown	82/54/t	71/57/t
Anchorage	51/40/r	49/38/c
Asheville	81/57/c	81/57/c
Atlanta	85/67/c	85/68/c
Bismarck	60/37/c	67/39/c
Boise	65/41/s	71/46/s
Boston	49/44/r	53/49/sh
Buffalo	60/49/c	60/45/r
Burlington, VT	54/45/r	59/47/r
Casper	54/27/s	59/32/s
Charleston, SC	84/65/c	82/65/t
Charleston, WV	83/60/t	79/58/t
Charlotte	85/62/c	83/64/c
Chicago	52/42/r	58/41/c
Cincinnati	78/61/t	74/54/t
Cleveland	71/58/sh	61/47/sh
Columbia	87/64/c	84/64/t
Columbus, OH	79/60/t	71/51/t
Concord	49/38/r	53/44/r
Dallas	79/65/t	75/61/r
Dayton	79/60/t	68/52/sh
Denver	60/37/c	66/38/s
Des Moines	64/42/c	61/42/c
Detroit	67/53/r	61/44/c
Duluth	52/34/c	56/39/c
El Paso	86/64/s	88/61/s
Evansville	77/62/t	76/59/r
Fairbanks	56/33/s	42/28/sn
Fargo	56/41/c	63/43/c
Flagstaff	64/31/s	67/32/s
Grand Rapids	62/46/r	62/43/c
Great Falls	53/35/c	64/33/c
Greensboro	84/61/c	82/63/c
Hartford	65/46/r	59/52/r
Helena	57/35/c	67/41/c
Honolulu	84/66/sh	82/70/sh
Houston	86/72/c	84/70/t
Indianapolis	72/55/t	67/53/sh
Jackson, MS	87/65/c	85/67/c
Kansas City	61/47/c	59/44/c
Las Vegas	83/62/s	87/65/s
Little Rock	74/62/t	76/63/t
Los Angeles	73/55/c	74/55/c
Louisville	81/65/t	79/61/t
Lubbock	67/52/c	68/51/r
Madison	58/42/r	59/37/c
Memphis	83/66/t	80/66/t
Midland	81/60/c	81/58/r
Milwaukee	48/41/r	53/39/c
Minneapolis	57/41/c	64/48/c
Nashville	85/65/c	83/62/c
New Orleans	85/70/c	85/72/c
New York	73/50/c	59/56/t
Norfolk	87/64/c	85/66/c
Oklahoma City	64/54/t	65/54/c
Omaha	64/45/c	66/45/c

IN THE SKIES

An hour after sunset, Leo the Lion is high overhead, formed by a backward question mark followed by a small triangle. With binoculars, look about 15 degrees east of Leo for a delicate splash of faint stars called the Coma star cluster. Best on moonless nights like tonight!

SOURCE: Morrison Planetarium, California Academy of Sciences

THURSDAY, May 2

YESTERDAY'S U.S. EXTREMES FOR THE 48 CONTIGUOUS STATES

High: Zapata, TX at 99° Low: Lake Yellowstone, WY at 3°

KEY: W-weather, s-sunny, pc-partly cloudy, c-cloudy, sh-showers, t-thunderstorms, r-rain, sf-snow flurries, sn-snow, i-ice.

FORECASTS AND GRAPHICS PROVIDED BY ACCUWEATHER, INC. ©2019

SHOWERS T-STORMS RAIN FLURRIES SNOW ICE COLD FRONT WARM FRONT STATIONARY

	Today	Tomorrow
Philadelphia	84/58/t	79/61/c
Phoenix	90/67/s	93/68/s
Pittsburgh	78/61/t	73/54/t
Portland, ME	45/39/r	48/42/r
Portland, OR	66/45/c	70/48/s
Providence	57/44/r	55/51/sh
Raleigh	85/61/c	82/64/c
Rapid City	61/34/s	63/38/c
Reno	73/43/s	77/46/s
Richmond	89/64/c	87/66/c
Sacramento	81/50/s	83/49/c
St. Louis	69/54/t	68/53/c
Salt Lake City	63/44/c	68/47/s
San Antonio	85/69/t	80/64/t
San Diego	69/58/c	70/58/c
San Francisco	68/48/c	68/49/c
Santa Fe	70/40/s	70/42/s
St. Ste. Marie	43/33/sh	49/32/c
Seattle	60/46/c	63/47/c
Shreveport	80/66/t	79/64/t
Sioux Falls	59/40/c	66/43/c
Spokane	61/39/c	65/44/c
Syracuse	62/49/c	68/47/r
Topeka	63/48/c	61/44/c
Tucson	88/60/s	89/60/s
Tulsa	67/57/t	69/55/r
Wash., DC	87/68/c	85/67/c
Wichita	64/51/c	66/47/c
Wilkes-Barre	78/57/t	70/55/t
Wilmington, NC	82/67/c	81/66/c

CANADA

	Today	Tomorrow
Calgary	48/34/c	46/30/c
Edmonton	48/30/c	42/25/c
Halifax	52/35/c	52/37/c
Ottawa	50/41/c	51/38/r
Quebec	50/37/c	49/42/r
Regina	58/28/c	54/26/c
Toronto	53/43/c	56/42/sh
Vancouver	59/44/c	58/43/c
Winnipeg	56/38/c	59/36/sh

CARIBBEAN

	Today	Tomorrow
Barbados	87/79/s	87/79/c
Bridgetown	87/79/s	87/79/c
Curacao	88/79/c	88/80/c
Freeport	83/73/t	86/72/c
Havana	91/65/c	92/68/c
Kingston	88/78/c	88/77/c
St. Thomas	86/76/s	87/77/s
San Juan	86/75/s	86/76/s

WORLD

	Today	Tomorrow
Acapulco	88/75/c	87/74/c
Asuncion	90/72/s	86/72/c
Bahgdad	98/72/s	97/67/c
Bangkok	102/82/s	101/82/c
Beijing	87/56/c	85/61/c
Berlin	61/43/c	55/38/c
Buenos Aires	77/57/c	75/55/s
Cairo	94/65/c	86/61/s
Cape Town	67/55/c	65/53/c
Caracas	86/76/c	84/76/c
Dublin	56/40/sh	51/36/c
Jerusalem	80/60/c	72/52/s
Kabul	72/46/c	75/47/c
Lima	74/66/c	74/66/c
London	61/43/sh	57/38/sh
Madrid	75/48/s	73/45/s
Manila	95/82/s	96/82/s
Mexico City	81/57/c	82/58/c
Moscow	54/48/r	55/40/c
Nairobi	80/59/c	79/63/c
New Delhi	101/78/c	100/77/c
Paris	58/45/c	61/43/c
Quito	72/54/c	70/51/sh
Rio de Janeiro	89/77/c	91/77/c
Rome	66/52/c	65/52/c
Seoul	74/46/c	75/47/s
Singapore	90/81/t	91/79/t
Sydney	80/68/c	74/59/r
Tokyo	68/58/sh	71/59/c

NOTICE OF PUBLIC HEARING BEFORE THE PLANNING AND ZONING BOARD OF THE CITY OF ALACHUA, FLORIDA

Notice is hereby given that the Planning and Zoning Board of the City of Alachua will hold a public hearing on May 14, 2019 at 6:00 p.m. The hearing will be held in the James A. Lewis Commission Chambers in City Hall, located at 15100 NW 142nd Terrace, Alachua, Florida, to consider the following: A request by Clay Sweger, AICP, LEED AP, of eda engineers-surveyors-planners, inc., applicant and agent, for The Laser Investment Group, LLC, property owner, for consideration of a Site Specific Amendment to the Official Zoning Atlas (Rezoning) from Commercial Intensive (CI) (±10.00 acres), Light and Warehouse Industrial (ILW) (±45.42 acres), and Industrial Services and Manufacturing (MP)(Alachua County) (±26.98 acres) to Corporate Park (CP) on a ±82.40 acre subject property; located at 13025 NW US Highway 441; consisting of Tax Parcel Numbers 05962-002-000, 05855-005-000 and a portion of 05855-004-000.

At the public hearing, all interested parties may appear and be heard with respect to the application. Copies of the application are available for public inspection at the Planning and Community Development Department, 15100 NW 142nd Terrace, Alachua, Florida, on any regular business day between the hours of 7:30 a.m. to 6:00 p.m. Written comments on the application may be sent to the following address: City of Alachua, Planning and Community Development, P.O. Box 9, Alachua, FL 32616. Notice is given pursuant to Section 286.0105, Florida Statutes, that, in order to appeal any decision made at the public hearing, you will need a record of the proceedings, and that, for such purpose, you may need to ensure that a verbatim record of the proceedings is made, which includes the testimony and evidence upon which the appeal is to be based. In accordance with the Americans with Disabilities Act, any persons with a disability requiring reasonable accommodation in order to participate in this meeting should call the City Clerk at (386) 418-6100 x 101 at least 48 hours prior to the public hearing.

Everything Gainesville

gainesville.com

May 4 - 5 • 9:30 AM - 5:00 PM

CEDAR LAKES WOODS AND GARDENS

ADULTS: \$9

CHILDREN AGE 6-13: \$4

CHILDREN AGE 6 AND UNDER FREE!

WILLISTON, FL

WWW.CEDARLAKESWOODSANDGARDEN.COM

(352) 529 0055

FIND A CAR

The Gainesville Sun

CLASSIFIED

352-372-4222 gainesville.com

CROSSWORD

Every day in The Gainesville Sun

Exercise your mind daily

GAINESVILLE MAGAZINE

www.gainesvillemagazine.com

Portable Oxygen For The Way You Want to Live

INOGEN ONE

JUST 2.8 LBS.

TRY RISK FREE FOR 30 DAYS

CALL TODAY! 844-244-0346

GET YOUR MEDICAL MARIJUANA CARD

WE ARE THE ONLY MARIJUANA CLINIC OFFERING:

- FREE 210 DAY MARIJUANA ORDER

- NO DOSING OR PRESCRIPTION FEES

- NO MONTHLY DOCTOR VISIT FEES

SMOKING OK! DRY BUDS AVAILABLE

18 LOCATIONS STATEWIDE

GAINESVILLE (352) 306-0220 2727 NW 6TH STREET, GAINESVILLE, FL 32609

OCALA (352) 414-4545 1713 E. SILVER SPRINGS BLVD SUITE, OCALA, FL 34470

WWW.CMMDR.COM LICENSE NUMBER OS8874

Although medical marijuana is legal in Florida it remains illegal under federal law. Medical marijuana is not available to individuals under the age of 18.



City of ALACHUA

NOTICE OF PUBLIC HEARING BEFORE THE PLANNING AND ZONING BOARD OF THE CITY OF ALACHUA, FLORIDA

Notice is hereby given that the Planning and Zoning Board of the City of Alachua will hold a public hearing on May 14, 2019 at 6:00 p.m. The hearing will be held in the James A. Lewis Commission Chambers in City Hall, located at 15100 NW 142nd Terrace, Alachua, Florida, to consider the following: A request by Clay Sweger, AICP, LEED AP, of eda engineers-surveyors-planners, inc., applicant and agent, for The Laser Investment Group, LLC, property owner, for consideration of a Site Specific Amendment to the Official Zoning Atlas (Rezoning) from Commercial Intensive (CI) (± 10.00 acres), Light and Warehouse Industrial (ILW) (± 45.42 acres), and Industrial Services and Manufacturing (MP)(Alachua County) (± 26.98 acres) to Corporate Park (CP) on a ± 82.40 acre subject property; located at 13025 NW US Highway 441; consisting of Tax Parcel Numbers 05962-002-000, 05855-005-000 and a portion of 05855-004-000.

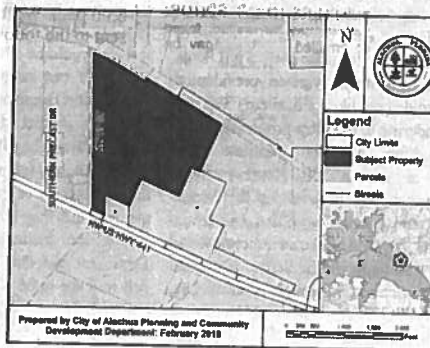

At the public hearing, all interested parties may appear and be heard with respect to the application. Copies of the application are available for public inspection at the Planning and Community Development Department, 15100 NW 142nd Terrace, Alachua, Florida, on any regular business day between the hours of 7:30 a.m. to 6:00 p.m. Written comments on the application may be sent to the following address: City of Alachua, Planning and Community Development, P.O. Box 9, Alachua, FL 32616. Notice is given pursuant to Section 286.0105, Florida Statutes, that, in order to appeal any decision made at the public hearing, you will need a record of the proceedings, and that, for such purpose, you may need to ensure that a verbatim record of the proceedings is made, which includes the testimony and evidence upon which the appeal is to be based. In accordance with the Americans with Disabilities Act, any persons with a disability requiring reasonable accommodation in order to participate in this meeting should call the City Clerk at (386) 418-6100 x 101 at least 48 hours prior to the public hearing.

(Published: Alachua County Today - May 02, 2019)



City of
ALACHUA

THE GOOD LIFE COMMUNITY

Mailed 4/29/2019
(KC)

NOTICE OF PUBLIC HEARING BEFORE THE PLANNING AND ZONING BOARD OF THE CITY OF ALACHUA, FLORIDA

Notice is hereby given that the Planning and Zoning Board of the City of Alachua will hold a public hearing on May 14, 2019 at 6:00 p.m. The hearing will be held in the James A. Lewis Commission Chambers in City Hall, located at 15100 NW 142nd Terrace, Alachua, Florida, to consider the following: A request by Clay Sweger, AICP, LEED AP, of eda engineers-surveyors-planners, inc., applicant and agent, for The Laser Investment Group, LLC, property owner, for consideration of a Site Specific Amendment to the Official Zoning Atlas (Rezoning) from Commercial Intensive (CI) (±10.00 acres), Light and Warehouse Industrial (ILW) (±45.42 acres), and Industrial Services and Manufacturing (MP)(Alachua County) (±26.98 acres) to Corporate Park (CP) on a ±82.40 acre subject property; located at 13025 NW US Highway 441; consisting of Tax Parcel Numbers 05962-002-000, 05855-005-000 and a portion of 05855-004-000.

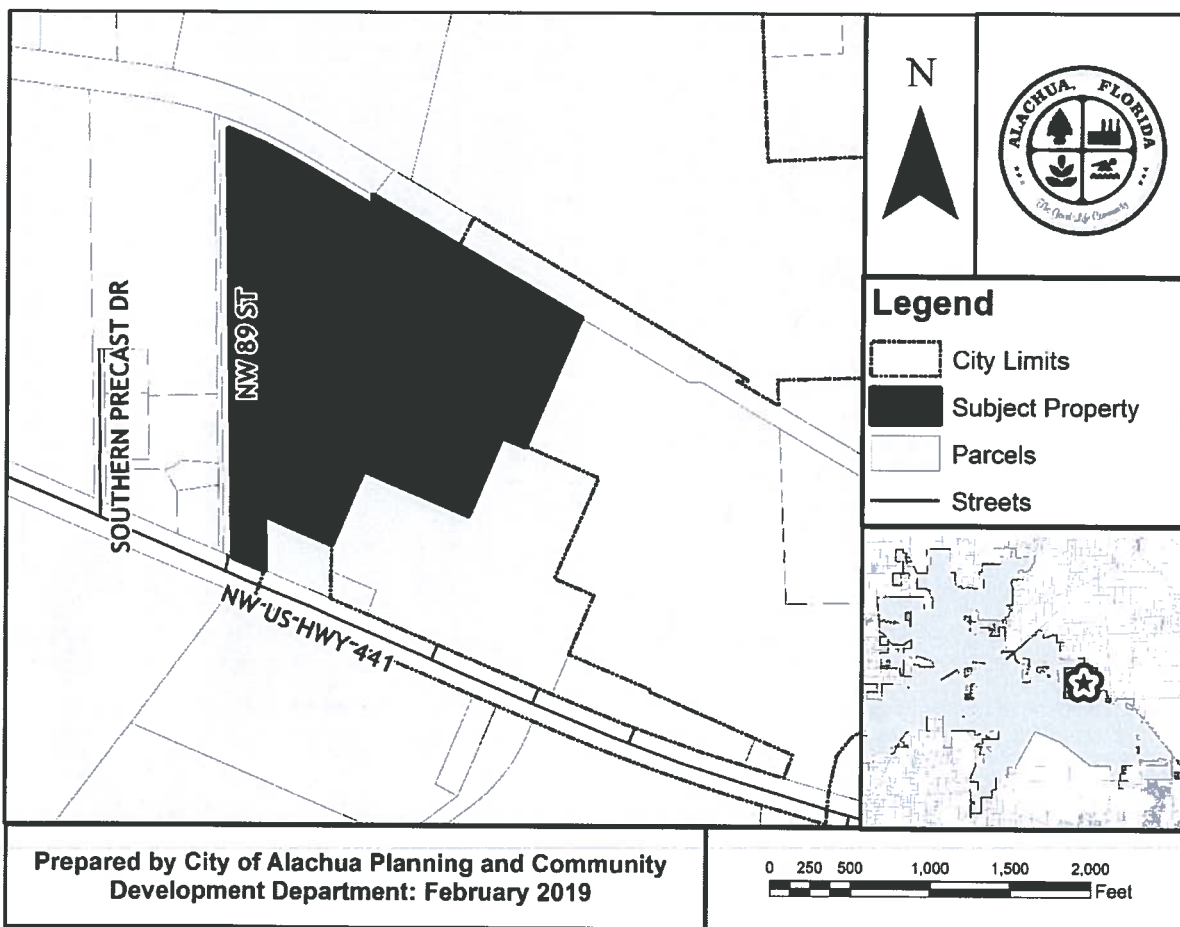

At the public hearing, all interested parties may appear and be heard with respect to the application. Copies of the application are available for public inspection at the Planning and Community Development Department, 15100 NW 142nd Terrace, Alachua, Florida, on any regular business day between the hours of 7:30 a.m. to 6:00 p.m. Written comments on the application may be sent to the following address: City of Alachua, Planning and Community Development, P.O. Box 9, Alachua, FL 32616. Notice is given pursuant to Section 286.0105, Florida Statutes, that, in order to appeal any decision made at the public hearing, you will need a record of the proceedings, and that, for such purpose, you may need to ensure that a verbatim record of the proceedings is made, which includes the testimony and evidence upon which the appeal is to be based. In accordance with the Americans with Disabilities Act, any persons with a disability requiring reasonable accommodation in order to participate in this meeting should call the City Clerk at (386) 418-6100 x 101 at least 48 hours prior to the public hearing.

P.O. Box 9 ♦ Alachua, Florida 32616-0009
Phone: (386) 418-6121 ♦ Fax: (386) 418-6130



5160®

Easy Peel® Address Labels
Bend along line to expose Pop-up Edge®Go to avery.com/templates
Use Avery Template 5160

92060-503-901

05961-000-000
HIGHWAY 441 HOLDINGS LLC
100 AMBERWOOD COURT
LONGWOOD, FL 3277905855-002-000
TOM R & ASSOCIATES LLC
11 SE 2ND AVE
GAINESVILLE, FL 3260105961-002-003
DESIGN CABINET & FURNITURE INC
13313 SOUTHERN PRECAST DR
ALACHUA, FL 32615-0854805961-002-004
DESIGN CABINETS & FURNITURE
13313 SOUTHERN PRECAST DR
ALACHUA, FL 32615-854805961-002-006
DESIGN CABINETS & FURNITURE
13313 SOUTHERN PRECAST DR
ALACHUA, FL 3261505857-001-001
LOWE MICHAEL S TRUSTEE
13929 NW 89TH ST
ALACHUA, FL 3261505857-002-000
F & R HOLDINGS OF GAINESVILLE
13929 NW 89TH ST
ALACHUA, FL 3261505949-005-002
HIPP INVESTMENTS LLC
14610 NW 129TH TER
ALACHUA, FL 3261505963-000-000
WERSHOW, J F
204 SE 1ST ST
GAINESVILLE, FL 3260105857-002-001
F & R HOLDINGS OF GAINESVILLE
220 NW 122ND ST
GAINESVILLE, FL 32607-110705949-005-000
PINKOSON & PINKOSON & UPSHAW
2820 NW 38TH DR
GAINESVILLE, FL 32605-268005949-005-001
PINKOSON & PINKOSON & UPSHAW
2820 NW 38TH DR
GAINESVILLE, FL 32605-268005962-001-000
SPERRING & SPERRING SR, TRUSTE
2928 NW 22ND ST
GAINESVILLE, FL 3260505855-000-000
LITHIUM NICKEL ASSET HOLDING
3 EXPRESSWAY PLAZA
ROSLYN HEIGHTS, NY 1157705962-002-000
LAER INVESTMENT GROUP LLC (THE)
3201 SW 42ND ST STE 2
GAINESVILLE, FL 3260805857-001-000
F & R HOLDINGS OF GAINESVILLE
50 PARTRIDGE WAY
SHELburne, VT 0548292060-517-900
CSX TRANSPORTATION INC
500 WATER ST TAX DEPT. J-910
JACKSONVILLE, FL 32202-442305949-001-000
DUKE ENERGY FLORIDA INC
550 S TRYON ST TAX DEPT – DEC41B
CHARLOTTE, NC 2820205855-004-000
PHOENIX COMMERCIAL PARK LLP
PO BOX 1000
ALACHUA, FL 3261605855-005-000
PHOENIX COMMERCIAL PARK LLLP
PO BOX 1000
ALACHUA, FL 3261605949-000-000
U OF F FOUNDATION INC
PO BOX 14425
GAINESVILLE, FL 32604-242505961-002-000
TRIPLE L LLC
PO BOX 641
CANAL FULTON, OH 44164

Antoinette Endelicato
 5562 NW 93rd Avenue
 Gainesville, FL 32653

Dan Rhine
 288 Turkey Creek
 Alachua, FL 32615

Tom Gorman
 9210 NW 59th Street
 Alachua, FL 32653

Richard Gorman
 5716 NW 93rd Avenue
 Alachua, FL 32653

Peggy Arnold
 410 Turkey Creek
 Alachua, FL 32615

David Forest
 23 Turkey Creek
 Alachua, FL 32615

President
 TCMOA
 1000 Turkey Creek
 Alachua, FL 32615

Linda Dixon, AICP
 Assistant Director Planning
 PO Box 115050
 Gainesville, FL 32611

Craig Parenteau
 FL Department of Environmental
 Protection
 4801 Camp Ranch Road

Jeannette Hinsdale
 P.O. Box 1156
 Alachua, FL 32616

Lynn Coullias
 7406 NW 126th Ave
 Alachua, FL 32615

Lynda Coon
 7216 NW 126 Avenue
 Alachua, FL 32615

Tamara Robbins
 PO Box 2317
 Alachua, FL 32616

Michele L. Lieberman
 Interim County Manager
 12 SE 1st Street
 Gainesville, FL 32601

Bonnie Flynn
 16801 NW 166th Drive
 Alachua, FL 32615

AFFIDAVIT FOR POSTED LAND USE SIGN

I Melissa Watson, POSTED THE LAND USE
SIGN ON 4/24/19 FOR THE San Felasco Tech City RZ
(Name) (Date) (State type of action and project name)
LAND USE ACTION.

AS PER ARTICLE 2.2.9 D OF THE LAND DEVELOPMENT REGULATIONS.

THIS WILL BE INCLUDED IN THE STAFF REPORT.

Melissa Watson
(Signature)

3
(Number of signs)