

WEATHER

TODAY'S UV INDEX
10 a.m. noon 2 p.m. 4 p.m.
3 7 7 4
The higher the **AccuWeather.com UV Index** number, the greater the need for eye and skin protection. 0-2: Low, 3-5: Moderate, 6-7: High, 8-10: Very High, 11+: Extreme

FIVE-DAY FORECAST FOR GAINESVILLE

Today	Friday	Saturday	Sunday	Monday
87° 71°	91° 71°	90° 71°	90° 73°	90° 73°
Partly sunny Chance of rain: 25% Winds: SW 6-12 mph	Clouds and sun Chance of rain: 25% Winds: NE 6-12 mph	A thunderstorm Chance of rain: 55% Winds: E 6-12 mph	A stray t-storm Chance of rain: 45% Winds: SE 4-8 mph	A p.m. t-storm Chance of rain: 60% Winds: SSE 4-8 mph

AccuWeather DOWNLOAD THE FREE APP

SUN AND MOON			
Sunrise today	6:28 a.m.		
Sunset tonight	8:30 p.m.		
Moonrise today	5:01 p.m.		
Moonset today	3:53 a.m.		
Full	Last	New	First
June 17	June 25	July 2	July 9

REGIONAL FORECAST

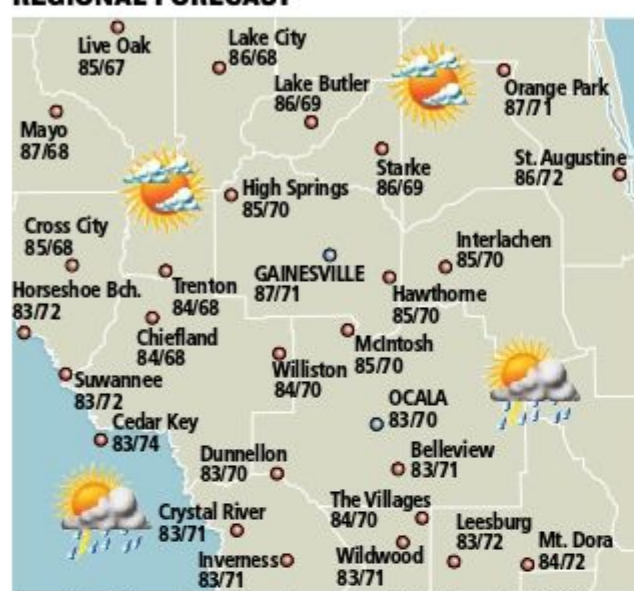

Shown is today's weather. Temperatures are today's highs and tonight's lows.

FLORIDA FORECAST

City	Today	Tomorrow	Lakeland	85/72/t	86/72/t
Apalachicola	86/71/pc	86/71/s	Melbourne	88/72/t	85/75/t
Cape Canaveral	86/74/t	85/76/t	Miami	91/78/t	88/79/t
Crescent Beach	83/73/pc	83/75/pc	Orlando	86/70/t	88/70/t
Crystal River	83/71/pc	88/69/pc	Panama City	87/71/s	87/72/s
Daytona Beach	86/72/t	86/73/pc	Pensacola	90/68/s	87/73/s
Fernandina Bch.	86/72/pc	84/73/pc	Perry	87/67/pc	90/68/pc
Ft. Lauderdale	88/78/t	87/79/t	St. Petersburg	85/75/pc	88/75/t
Fort Myers	88/75/t	88/75/t	Sarasota	90/76/c	90/74/t
Ft. Walton Bch.	87/67/s	85/71/s	Tallahassee	89/66/pc	90/68/s
Jacksonville	87/69/pc	85/70/pc	Tampa	85/77/t	89/77/t
Key West	88/80/pc	89/79/t	Vero Beach	88/70/t	86/71/t
			W. Palm Beach	91/75/t	87/76/t

YESTERDAY'S ALMANAC

GAINESVILLE						OCALA							
Measured at Gainesville Regional Airport through 5 p.m. yesterday.						Measured at Ocala through 5 p.m. yesterday.							
Temperature						Temperature							
High/low temperature			86°/76°			High/low temperature			86°/73°				
Normal high/low			90°/69°			Normal high/low			92°/70°				
Record high			99° in 1998			Record high			100° in 1952				
Record low			52° in 1960			Record low			61° in 1988				
Precipitation						Precipitation							
24 hours through 5 p.m. yest.			0.32"			24 hours through 5 p.m. yest.			0.60"				
Record rainfall			3.23" in 1965			Record rainfall			2.35" in 2005				
Monthly rainfall						Monthly rainfall							
2019		2018		2017		NmI		Rcd		Year			
Jan.	5.42	4.32	1.45	3.33	11.79	1904	Jan.	4.49	4.19	4.95	3.20	9.12	1994
Feb.	1.01	1.58	0.39	3.20	11.58	1998	Feb.	1.67	1.18	1.51	3.26	11.31	1998
March	1.87	2.41	0.67	4.33	11.13	1996	March	0.48	3.69	1.35	4.56	11.86	1959
April	2.42	7.49	2.74	2.67	8.95	1949	April	3.74	4.83	2.23	2.40	16.37	1982
May	2.65	8.38	4.45	2.48	9.25	1959	May	5.56	12.40	2.84	2.92	13.05	1976
June	2.19	5.55	16.86	7.12	16.86	2017	June	4.71	6.62	9.82	7.42	15.98	1974
July	6.69	16.70	6.07	16.70	2017		July	9.25	8.52	6.92	13.57	1964	
Aug.	8.69	5.79	6.39	15.84	1985		Aug.	6.14	6.81	6.32	15.17	1949	
Sept.	2.84	15.28	4.42	19.91	1894		Sept.	2.91	12.92	6.08	20.70	2004	
Oct.	0.61	1.57	2.88	10.00	1994		Oct.	1.05	3.43	3.03	9.53	1958	
Nov.	2.81	2.76	2.06	7.27	1972		Nov.	1.39	5.39	2.12	7.01	1980	
Dec.	8.68	2.65	2.38	9.60	1997		Dec.	11.47	1.14	2.57	11.47	2018	
Year	15.56	60.05	71.31	47.33	73.30	1953	Year	20.65	65.12	60.91	50.80	74.71	1982

POLLEN INDEX

ABSENT LOW MODERATE HIGH VERY HIGH
SOURCE: AccuWeather.com

WEATHER TRIVIA™

Q: Tomato plants do better when overnight readings remain above what?

A: 55 f. degrees

TODAY'S TIDES

	High	Low
Boca Grande	10:21 a.m.	3:25 a.m.
Cedar Key	11:26 a.m.	5:24 a.m.
Crystal River	1:51 a.m.	8:17 a.m.
Daytona Beach	5:13 a.m.	11:23 a.m.
Homosassa Bay	2:55 a.m.	8:58 a.m.
Ponce Inlet	6:05 a.m.	12:06 a.m.
St. Augustine	5:49 a.m.	12:06 p.m.
Withlacoochee	11:33 a.m.	6:19 a.m.

COASTAL CONDITIONS

Savannah to St. Augustine: Wind from the southwest at 6-12 knots today. Seas 1-3 feet. Inland waterways a light chop. Visibility generally unrestricted.

St. Augustine to Jupiter Inlet: Wind southwest 6-12 knots today. Seas 1-3 feet. Inland waterways mostly smooth. Visibility under 2 miles in a thunderstorm.

Tarpon Springs to Apalachicola: Wind from the southwest at 6-12 knots today. Seas 1-3 feet. Inland waterways mostly smooth. Visibility less than 3 miles in showers.

SOLUNAR TABLES

The solunar period indicates peak feeding times for fish and game.					
A.M.		P.M.			
Day	Major	Minor	Major	Minor	
Today	9:09	2:57	9:34	3:22	
Fri.	9:53	3:40	10:18	4:05	
Sat.	10:38	4:25	11:04	4:51	

AIRPORT REPORT

ATLANTA: Sunshine, pleasant and warmer. High 80, Low 59
CHARLOTTE: Mostly sunny and warmer. High 82, Low 56
JACKSONVILLE: Times of clouds and sun. High 87, Low 69
MIAMI: A shower or heavy t-storm. High 91, Low 78
ORLANDO: A stray afternoon t-storm. High 86, Low 70
TAMPA: Some sun with a thunderstorm. High 85, Low 77

TODAY'S FIRE RISK

LOW MODERATE HIGH EXTREME
SOURCE: U.S. Forest Service

NATION & WORLD

U.S. CITIES	Today	Tomorrow
Albany	61/53/r	67/52/sh
Albuquerque	92/63/pc	92/59/s
Allentown	67/56/t	73/54/pc
Anchorage	66/52/c	67/53/pc
Asheville	76/51/pc	77/52/s
Atlanta	80/59/s	81/62/s
Atlantic City	77/60/t	77/58/s
Austin	91/69/s	95/77/s
Baltimore	75/58/t	77/57/s
Birmingham	80/58/s	83/64/s
Bismarck	82/57/pc	86/60/pc
Boise	87/60/t	88/57/pc
Boston	63/59/r	74/58/pc
Buffalo	66/50/t	67/58/sh
Burlington, VT	66/53/t	68/54/r
Casper	79/50/t	74/45/t
Charleston, SC	87/60/t	83/61/s
Charleston, WV	66/49/t	73/54/s
Charlotte	82/56/s	80/56/s
Chicago	67/54/pc	76/63/pc
Cincinnati	63/48/sh	74/56/s
Cleveland	68/51/t	74/59/s
Columbia, SC	86/58/s	83/57/s
Columbus, OH	65/48/sh	74/55/s
Concord	62/50/r	71/50/pc
Dallas	84/67/s	89/74/s
Dayton	61/49/sh	74/57/s
Denver	83/57/t	82/52/t
Des Moines	73/58/s	74/65/pc
Detroit	65/49/sh	75/59/pc
Duluth	72/49/pc	71/47/t
El Paso	100/74/c	100/74/pc
Evansville	71/49/pc	78/60/pc
Fairbanks	74/54/pc	74/52/s
Fargo	77/58/pc	85/58/t
Flagstaff	82/45/s	77/43/s
Grand Rapids	62/48/sh	73/61/c
Great Falls	84/56/t	78/50/t
Greensboro	78/55/pc	76/56/s
Hartford	61/55/r	73/55/sh
Helena	83/59/t	83/54/pc
Honolulu	89/75/s	89/75/pc
Houston	91/69/s	92/77/pc
Indianapolis	65/49/sh	74/60/pc
Jackson, MS	82/57/t	87/66/s
Kansas City	75/59/s	76/65/s
Las Vegas	106/76/s	98/77/s
Little Rock	81/58/s	84/69/pc
Los Angeles	76/61/pc	74/60/pc
Louisville	70/52/sh	77/62/pc
Lubbock	87/68/t	95/71/t
Madison	69/48/s	75/58/pc
Memphis	78/59/s	82/69/c
Midland	89/72/pc	97/74/t
Minneapolis	68/53/s	76/62/pc
Minneapolis	73/58/s	82/64/t
Nashville	76/53/s	81/62/pc
New Orleans	90/74/s	91/77/s
New York	66/59/r	72/60/pc
Norfolk	86/64/c	78/61/s
Oklahoma City	79/61/pc	85/72/t
Omaha	77/63/pc	79/68/pc

IN THE SKIES

An hour before dawn, you can still see the two largest planets in our solar system-Jupiter and Saturn-low in the southwest, on either side of the "teapot" asterism in Sagittarius the Archer (Jupiter to the right and Saturn higher and to the left).

SOURCE: Morrison Planetarium, California Academy of Sciences

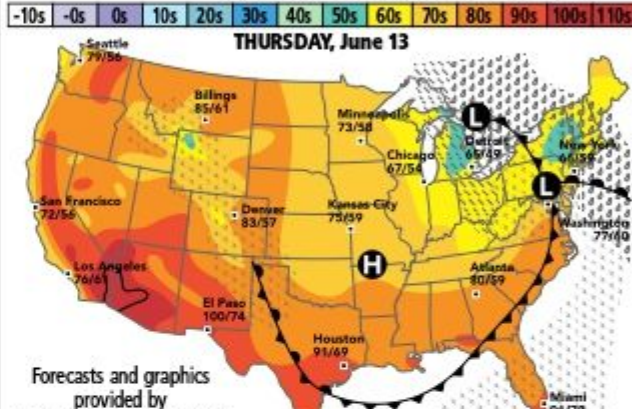

Forecasts and graphics provided by AccuWeather, Inc. ©2019

YESTERDAY'S U.S. EXTREMES FOR THE 48 CONTIGUOUS STATES

High: Thermal, CA at 118° **Low:** Yellowstone Nat'l Park, WY at 27°
KEY: W-weather, S-sunny, PC-partly cloudy, C-cloudy, SH-showers, T-thunderstorms, R-rain, SF-snow flurries, SN-snow, I-ice.

Philadelphia	71/59/t	75/58/s		Today	Tomorrow
Phoenix	112/79/s	104/77/s	CARIBBEAN	Hi/Low/W	Hi/Low/W
Pittsburgh	67/48/t	71/54/s	Barbados	87/80/pc	87/80/pc
Portland, ME	62/51/r	70/53/r	Bridgetown	87/80/pc	87/80/pc
Portland, OR	85/57/s	76/55/s	Curacao	88/78/pc	88/80/pc
Providence	66/60/t	74/56/pc	Freeport	90/76/pc	88/75/pc
Raleigh	81/57/pc	78/56/s	Havana	89/73/pc	90/75/pc
Rapid City	78/53/pc	77/54/pc	Kingston	89/77/pc	90/78/pc
Reno	89/60/pc	90/60/s	St. Thomas	88/79/pc	87/79/pc
Richmond	80/58/t	77/56/s	San Juan	87/77/pc	87/77/pc
Sacramento	91/55/s	88/54/s		Today	Tomorrow
St. Louis	73/56/s	80/63/pc	WORLD	Hi/Low/W	Hi/Low/W
Salt Lake City	86/60/pc	81/60/pc	Acapulco	88/79/t	89/80/t
San Antonio	90/72/s	93/76/s	Asuncion	86/70/pc	86/71/pc
San Diego	71/61/pc	69/61/pc	Baghdad	109/79/s	111/80/s
San Francisco	72/56/pc	68/55/pc	Bangkok	91/79/t	91/79/t
Santa Fe	88/56/t	88/51/s	Beijing	84/65/t	93/66/s
St. Ste. Marie	58/44/r	65/47/r	Berlin	79/58/pc	86/67/pc
Seattle	79/56/s	73/55/pc	Buenos Aires	66/53/r	64/50/pc
Shreveport	85/63/s	88/71/pc	Cairo	93/71/s	93/74/pc
Sioux Falls	78/60/pc	80/62/pc	Cape Town	60/43/s	65/43/s
Spokane	88/59/pc	82/57/s	Caracas	85/75/pc	84/74/t
Syracuse	62/54/t	66/57/sh	Dublin	56/43/sh	58/49/sh
Topeka	78/60/s	79/67/c	Jerusalem	77/63/s	78/62/pc
Tucson	108/71/pc	102/67/s	Kabul	88/56/s	90/60/s
Tulsa	79/63/pc	84/74/t	Lima	67/61/pc	67/61/pc
Wash., DC	77/60/t	77/60/s	London	60/53/sh	65/52/pc
Wichita	78/61/pc	85/70/t	Madrid	84/55/pc	80/51/s
Wilkes-Barre	65/55/r	69/53/pc	Manila	92/82/t	91/82/t
Wilmington, NC	86/64/pc	82/59/s	Mexico City	74/55/t	75/57/t
	Today	Tomorrow	Moscow	68/48/pc	74/58/pc
CANADA	Hi/Low/W	Hi/Low/W	Nairobi	72/56/c	73/57/c
Calgary	75/52/t	67/49/t	New Delhi	109/86/pc	113/88/pc
Edmonton	72/47/pc	72/50/t	Paris	69/53/pc	76/57/pc
Halifax	65/51/c	60/50/t	Quito	71/53/pc	72/54/c
Ottawa	66/49/c	64/50/r	Rio de Janeiro	83/71/s	84/70/s
Quebec	71/51/c	65/48/r	Rome	83/65/s	88/68/pc
Regina	84/56/pc	77/53/t	Seoul	79/62/pc	79/61/c
Toronto	63/51/r	71/58/pc	Singapore	88/80/t	88/79/t
Vancouver	74/54/pc	70/53/pc	Sydney	72/50/sh	65/50/c
Winnipeg	74/56/pc	77/50/sh	Tokyo	76/64/s	77/65/pc

AUTHOR SERIES

Sponsored by Friends of the Library
Presented at Headquarters Library

MELANIE BENJAMIN
2:30 PM Saturday, June 15

Melanie Benjamin presents her latest novel, *Mistress of the Ritz*, based on the story of the real-life American woman who secretly worked for the French Resistance during World War II- while playing hostess to the invading Germans at the iconic Hôtel Ritz in Paris.

Alachua County LIBRARY District WWW.ACLIB.US

WE'RE HIRING!

Arby's is expanding in Gainesville!
We are opening 2 new stores in the Gainesville Market.

All positions need to be filled.
Full Time - Part Time
Looking for Great Team Members That Are Outgoing, Friendly, and Enjoy Serving Customers With Fast, Friendly Service and Great Food.

Food Service, Cashiers, or Maintenance
\$9.00 to \$12.00
Team Leaders and Shift Managers
\$10.00 to \$15.00
Assistant Managers
\$12.00 to \$18.00

APPLY IN PERSON at
Thornbrook Village Shopping Center
4253 NW 25th Place, Gainesville, FL 32606 at the store next to Brittany's Fine Jewelry, behind the New Arby's on 43rd St.

Monday & Tuesday 9:00 AM - 7:00PM
Thursday & Friday 9:00 AM - 7:00PM
Saturday 9:00 AM - 8:00PM

PUBLIC NOTICE OF ENACTMENT OF AN ORDINANCE OF THE CITY OF ALACHUA, FLORIDA

Notice is hereby given that the City Commission of the City of Alachua will hold a public hearing on a proposed ordinance. The hearing will be held on June 24, 2019, at 6:00 p.m., in the James A. Lewis Commission Chambers in City Hall, located at 15100 NW 142nd Terrace, Alachua, Florida.

The ordinance title is as follows:

ORDINANCE 19-30
AN ORDINANCE OF THE CITY OF ALACHUA, FLORIDA, RELATING TO THE AMENDMENT OF THE OFFICIAL ZONING ATLAS; AMENDING THE OFFICIAL ZONING ATLAS FROM COMMERCIAL INTENSIVE (CI), LIGHT AND WAREHOUSE INDUSTRIAL (ILW), AND INDUSTRIAL SERVICES AND MANUFACTURING (MP) (ALACHUA COUNTY) TO CORPORATE PARK (CP) ON AN APPROXIMATELY ±82.40 ACRE PROPERTY; LOCATED IN THE 13000 BLOCK OF NW US HIGHWAY 441 ; CONSISTING OF TAX PARCEL NUMBERS 05962-002-000, 05855-005-000, AND A PORTION OF 05855-004-000; REPEALING ALL ORDINANCES IN CONFLICT; PROVIDING SEVERABILITY; AND PROVIDING AN EFFECTIVE DATE.

At the public hearing, all interested parties may appear and be heard with respect to the application. Copies of the application are available for public inspection at the Planning and Community Development Department, 15100 NW 142nd Terrace, Alachua, Florida, on any regular business day between the hours of 7:30 a.m. to 6:00 p.m. Written comments on the application may be sent to the following address: City of Alachua, Planning and Community Development, P.O. Box 9, Alachua, FL 32616. Notice is given pursuant to Section 286.0105, Florida Statutes, that, in order to appeal any decision made at the public hearing, you will need a record of the proceedings, and that, for such purpose, you may need to ensure that a verbatim record of the proceedings is made, which includes the testimony and evidence upon which the appeal is to be based. In accordance with the Americans with Disabilities Act, any persons with a disability requiring reasonable accommodation in order to participate in this meeting should call the City Clerk at (386) 418-6100 x 101 at least 48 hours prior to the public hearing.

PUBLIC NOTICE OF ENACTMENT OF AN ORDINANCE OF THE CITY OF ALACHUA, FLORIDA

Notice is hereby given that the City Commission of the City of Alachua will hold a public hearing on a proposed ordinance. The hearing will be held on

Photos by C.M. WALKER/Alachua County Today
Jailen Watson, Archer, sings along with the karaoke machine as Stacey and Mary Gay, LaCrosse, run the equipment during the High Springs Library's Karaoke for the Family event.



City of ALACHUA

PUBLIC NOTICE OF ENACTMENT OF AN ORDINANCE OF THE CITY OF ALACHUA, FLORIDA

Notice is hereby given that the City Commission of the City of Alachua will hold a public hearing on a proposed ordinance. The hearing will be held on June 24, 2019, at 6:00 p.m., in the James A. Lewis Commission Chambers in City Hall, located at 15100 NW 142nd Terrace, Alachua, Florida.

The ordinance title is as follows:

ORDINANCE 19-29

AN ORDINANCE OF THE CITY OF ALACHUA, FLORIDA, RELATING TO THE AMENDMENT OF THE OFFICIAL ZONING ATLAS; AMENDING THE OFFICIAL ZONING ATLAS FROM AGRICULTURAL (A) (ALACHUA COUNTY) TO AGRICULTURAL (A) ON AN APPROXIMATELY ±199 ACRE PROPERTY; LOCATED EAST OF COUNTY ROAD 241 AND SOUTH OF NW 88TH PLACE AND EAST OF COUNTY ROAD 241 AND NORTH OF MILLHOPPER ROAD; CONSISTING OF TAX PARCEL NUMBERS 04043-000-000, 04044-000-000, 04049-000-000, 04049-004-000, 04049-004-001, 04049-004-002, 04049-007-000 AND 04051-000-000; REPEALING ALL ORDINANCES IN CONFLICT; PROVIDING SEVERABILITY; AND PROVIDING AN EFFECTIVE DATE.

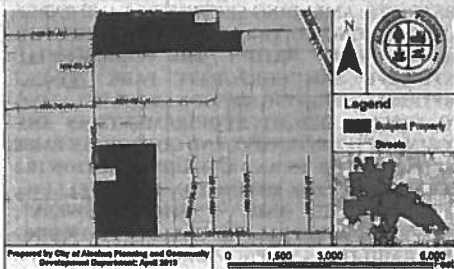

At the public hearing, all interested parties may appear and be heard with respect to the application. Copies of the application are available for public inspection at the Planning and Community Development Department, 15100 NW 142nd Terrace, Alachua, Florida, on any regular business day between the hours of 7:30 a.m. to 6:00 p.m. Written comments on the application may be sent to the following address: City of Alachua, Planning and Community Development, P.O. Box 9, Alachua, FL 32616. Notice is given pursuant to Section 286.0105, Florida Statutes, that, in order to appeal any decision made at the public hearing, you will need a record of the proceedings, and that, for such purpose, you may need to ensure that a verbatim record of the proceedings is made, which includes the testimony and evidence upon which the appeal is to be based. In accordance with the Americans with Disabilities Act, any persons with a disability requiring reasonable accommodation in order to participate in this meeting should call the City Clerk at (386) 418-6100 x 101 at least 48 hours prior to the public hearing.

(Published: Alachua County Today - June 13, 2019)



City of ALACHUA

PUBLIC NOTICE OF ENACTMENT OF AN ORDINANCE OF THE CITY OF ALACHUA, FLORIDA

Notice is hereby given that the City Commission of the City of Alachua will hold a public hearing on a proposed ordinance. The hearing will be held on June 24, 2019, at 6:00 p.m., in the James A. Lewis Commission Chambers in City Hall, located at 15100 NW 142nd Terrace, Alachua, Florida.

The ordinance title is as follows:

ORDINANCE 19-27

AN ORDINANCE OF THE CITY OF ALACHUA, FLORIDA, RELATING TO THE SMALL SCALE AMENDMENT OF THE CITY OF ALACHUA COMPREHENSIVE PLAN FUTURE LAND USE MAP; AMENDING THE FUTURE LAND USE MAP CLASSIFICATION OF A ±0.95 ACRE PROPERTY FROM RURAL / AGRICULTURE (ALACHUA COUNTY) TO MODERATE DENSITY RESIDENTIAL; LOCATED SOUTH OF THE INTERSECTION OF STATE ROAD 235 AND NW 134TH DRIVE; TAX PARCELS NUMBERS 03130-007-001, 03130-008-000, 03130-009-000, AND A PORTION OF 03130-004-000; REPEALING ALL ORDINANCES IN CONFLICT; PROVIDING SEVERABILITY; AND PROVIDING AN EFFECTIVE DATE.

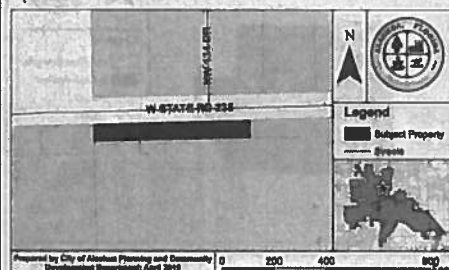

At the public hearing, all interested parties may appear and be heard with respect to the application. Copies of the application are available for public inspection at the Planning and Community Development Department, 15100 NW 142nd Terrace, Alachua, Florida, on any regular business day between the hours of 7:30 a.m. to 6:00 p.m. Written comments on the application may be sent to the following address: City of Alachua, Planning and Community Development, P.O. Box 9, Alachua, FL 32616. Notice is given pursuant to Section 286.0105, Florida Statutes, that, in order to appeal any decision made at the public hearing, you will need a record of the proceedings, and that, for such purpose, you may need to ensure that a verbatim record of the proceedings is made, which includes the testimony and evidence upon which the appeal is to be based. In accordance with the Americans with Disabilities Act, any persons with a disability requiring reasonable accommodation in order to participate in this meeting should call the City Clerk at (386) 418-6100 x 101 at least 48 hours prior to the public hearing.

(Published: Alachua County Today - June 13, 2019)



City of ALACHUA

PUBLIC NOTICE OF ENACTMENT OF AN ORDINANCE OF THE CITY OF ALACHUA, FLORIDA

Notice is hereby given that the City Commission of the City of Alachua will hold a public hearing on a proposed ordinance. The hearing will be held on June 24, 2019, at 6:00 p.m., in the James A. Lewis Commission Chambers in City Hall, located at 15100 NW 142nd Terrace, Alachua, Florida.

The ordinance title is as follows:

ORDINANCE 19-30

AN ORDINANCE OF THE CITY OF ALACHUA, FLORIDA, RELATING TO THE AMENDMENT OF THE OFFICIAL ZONING ATLAS; AMENDING THE OFFICIAL ZONING ATLAS FROM COMMERCIAL INTENSIVE (CI), LIGHT AND WAREHOUSE INDUSTRIAL (LIW), AND INDUSTRIAL SERVICES AND MANUFACTURING (MP) (ALACHUA COUNTY) TO CORPORATE PARK (CP) ON AN APPROXIMATELY ±82.40 ACRE PROPERTY; LOCATED IN THE 13000 BLOCK OF NW US HIGHWAY 441; CONSISTING OF TAX PARCEL NUMBERS 05962-002-000, 05855-005-000, AND A PORTION OF 05855-004-000; REPEALING ALL ORDINANCES IN CONFLICT; PROVIDING SEVERABILITY; AND PROVIDING AN EFFECTIVE DATE.



At the public hearing, all interested parties may appear and be heard with respect to the application. Copies of the application are available for public inspection at the Planning and Community Development Department, 15100 NW 142nd Terrace, Alachua, Florida, on any regular business day between the hours of 7:30 a.m. to 6:00 p.m. Written comments on the application may be sent to the following address: City of Alachua, Planning and Community Development, P.O. Box 9, Alachua, FL 32616. Notice is given pursuant to Section 286.0105, Florida Statutes, that, in order to appeal any decision made at the public hearing, you will need a record of the proceedings, and that, for such purpose, you may need to ensure that a verbatim record of the proceedings is made, which includes the testimony and evidence upon which the appeal is to be based. In accordance with the Americans with Disabilities Act, any persons with a disability requiring reasonable accommodation in order to participate in this meeting should call the City Clerk at (386) 418-6100 x 101 at least 48 hours prior to the public hearing.

(Published: Alachua County Today - June 13, 2019)



City of
ALACHUA

THE GOOD LIFE COMMUNITY

Mailed 6/11/2019

(KC)

PUBLIC NOTICE OF ENACTMENT OF AN ORDINANCE OF THE CITY OF ALACHUA, FLORIDA

Notice is hereby given that the City Commission of the City of Alachua will hold a public hearing on a proposed ordinance. The hearing will be held on June 24, 2019, at 6:00 p.m., in the James A. Lewis Commission Chambers in City Hall, located at 15100 NW 142nd Terrace, Alachua, Florida.

The ordinance title is as follows:

ORDINANCE 19-30

AN ORDINANCE OF THE CITY OF ALACHUA, FLORIDA, RELATING TO THE AMENDMENT OF THE OFFICIAL ZONING ATLAS; AMENDING THE OFFICIAL ZONING ATLAS FROM COMMERCIAL INTENSIVE (CI), LIGHT AND WAREHOUSE INDUSTRIAL (ILW), AND INDUSTRIAL SERVICES AND MANUFACTURING (MP) (ALACHUA COUNTY) TO CORPORATE PARK (CP) ON AN APPROXIMATELY ±82.40 ACRE PROPERTY; LOCATED IN THE 13000 BLOCK OF NW US HIGHWAY 441 ; CONSISTING OF TAX PARCEL NUMBERS 05962-002-000, 05855-005-000, AND A PORTION OF 05855-004-000; REPEALING ALL ORDINANCES IN CONFLICT; PROVIDING SEVERABILITY; AND PROVIDING AN EFFECTIVE DATE.

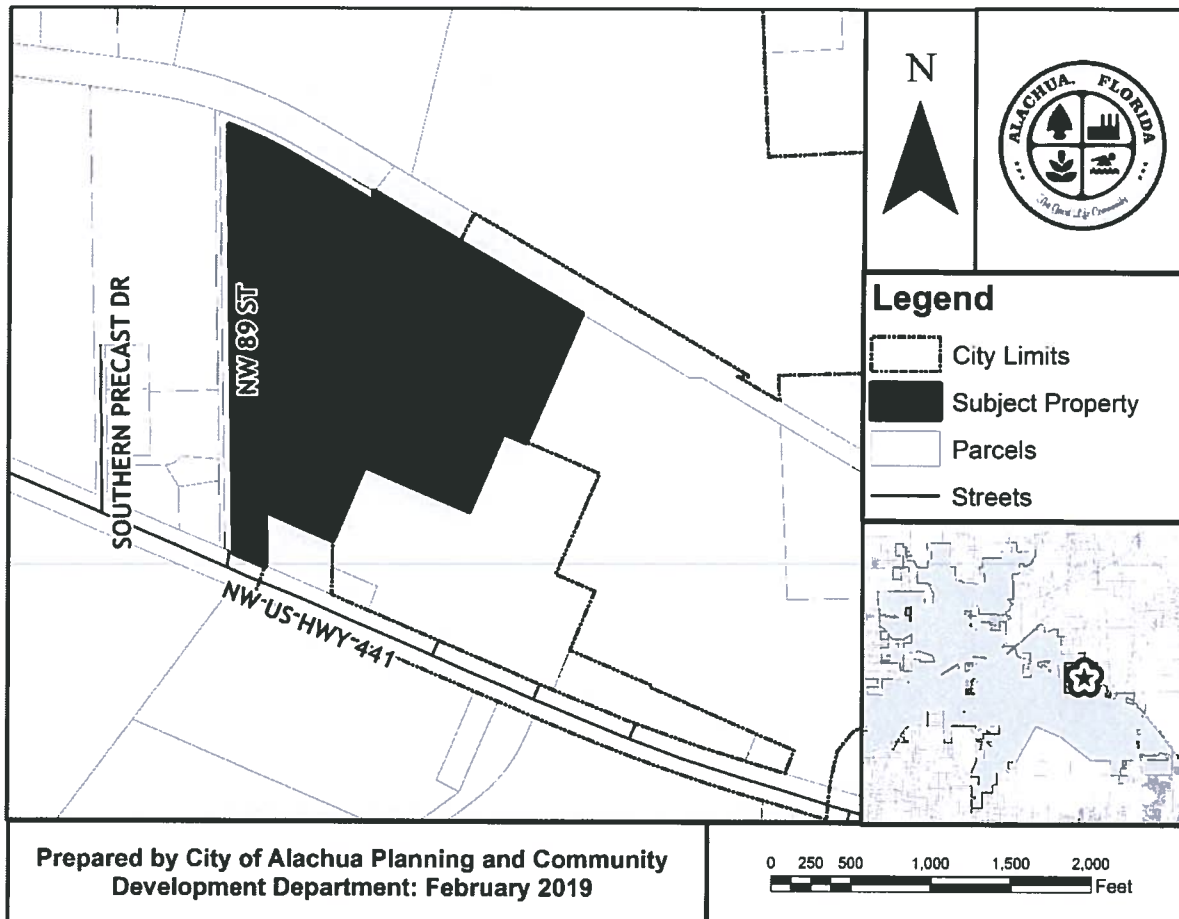

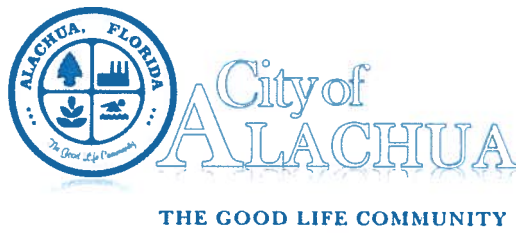

At the public hearing, all interested parties may appear and be heard with respect to the application. Copies of the application are available for public inspection at the Planning and Community Development Department, 15100 NW 142nd Terrace, Alachua, Florida, on any regular business day between the hours of 7:30 a.m. to 6:00 p.m. Written comments on the application may be sent to the following address: City of Alachua, Planning and Community Development, P.O. Box 9, Alachua, FL 32616. Notice is given pursuant to Section 286.0105, Florida Statutes, that, in order to appeal any decision made at the public hearing, you will need a record of the proceedings, and that, for such purpose, you may need to ensure that a verbatim record of the proceedings is made, which includes the testimony and evidence upon which the appeal is to be based. In accordance with the Americans with Disabilities Act, any persons with a disability requiring reasonable accommodation in order to participate in this meeting should call the City Clerk at (386) 418-6100 x 101 at least 48 hours prior to the public hearing.

92060-503-901

05961-000-000
HIGHWAY 441 HOLDINGS LLC
100 AMBERWOOD COURT
LONGWOOD, FL 32779

05855-002-000
TOM R & ASSOCIATES LLC
11 SE 2ND AVE
GAINESVILLE, FL 32601

05961-002-003
DESIGN CABINET & FURNITURE INC
13313 SOUTHERN PRECAST DR
ALACHUA, FL 32615-8548

05961-002-004
DESIGN CABINETS & FURNITURE
13313 SOUTHERN PRECAST DR
ALACHUA, FL 32615-8548

05961-002-006
DESIGN CABINETS & FURNITURE
13313 SOUTHERN PRECAST DR
ALACHUA, FL 32615

05857-001-001
LOWE MICHAEL S TRUSTEE
13929 NW 89TH ST
ALACHUA, FL 32615

05857-002-000
F&R HOLDINGS OF GAINESVILLE
13929 NW 89TH ST
ALACHUA, FL 32615

05949-005-002
HIPPI INVESTMENTS LLC
14610 NW 129TH TER
ALACHUA, FL 32615

05963-000-000
WERSHOW, J F
204 SE 1ST ST
GAINESVILLE, FL 32601

05857-002-001
F&R HOLDINGS OF GAINESVILLE
220 NW 122ND ST
GAINESVILLE, FL 32607-1107

05949-005-000
PINKOSON & PINKOSON & UPSHAW
2820 NW 38TH DR
GAINESVILLE, FL 32605-2680

05949-005-001
PINKOSON & PINKOSON & UPSHAW
2820 NW 38TH DR
GAINESVILLE, FL 32605-2680

05962-001-000
SPERRING & SPERRING SR, TRUSTE
2928 NW 22ND ST
GAINESVILLE, FL 32605

05855-000-000
LITHIUM NICKEL ASSET HOLDING
3 EXPRESSWAY PLAZA
ROSLYN HEIGHTS, NY 11577

05962-002-000
LASER INVESTMENT GROUP LLC
(THE)
3201 SW 42ND ST STE 2
GAINESVILLE, FL 32608

05857-001-000
F&R HOLDINGS OF GAINESVILLE
50 PARTRIDGE WAY
SHELBURNE, VT 05482

92060-517-900
CSX TRANSPORTATION INC
500 WATER ST TAX DEPARTMENT J-
910
JACKSONVILLE, FL 32202-4423

05949-001-000
DUKE ENERGY FLORIDA INC
550 S TRYON ST TAX DEPT - DEC41B
CHARLOTTE, NC 28202

05855-004-000
PHOENIX COMMERCIAL PARK LLP
PO BOX 1000
ALACHUA, FL 32616

05855-005-000
PHOENIX COMMERCIAL PARK LLLP
PO BOX 1000
ALACHUA, FL 32616

05949-000-000
U OF F FOUNDATION INC
PO BOX 14425
GAINESVILLE, FL 32604-2425

05961-002-000
TRIPLE L LLC
PO BOX 641
CANAL FULTON, OH 44164

Antoinette Endelicato
5562 NW 93rd Avenue
Gainesville, FL 32653

Dan Rhine
288 Turkey Creek
Alachua, FL 32615

Tom Gorman
9210 NW 59th Street
Alachua, FL 32653

Richard Gorman
5716 NW 93rd Avenue
Alachua, FL 32653

Peggy Arnold
410 Turkey Creek
Alachua, FL 32615

David Forest
23 Turkey Creek
Alachua, FL 32615

President
TCMOA
1000 Turkey Creek
Alachua, FL 32615

Linda Dixon, AICP
Assistant Director Planning
PO Box 115050
Gainesville, FL 32611

Craig Parenteau
FL Department of Environmental
Protection
4801 Camp Ranch Road

Jeannette Hinsdale
P.O. Box 1156
Alachua, FL 32616

Lynn Coullias
7406 NW 126th Ave
Alachua, FL 32615

Lynda Coon
7216 NW 126 Avenue
Alachua, FL 32615

Tamara Robbins
PO Box 2317
Alachua, FL 32616

Michele L. Lieberman
Interim County Manager
12 SE 1st Street
Gainesville, FL 32601

Bonnie Flynn
16801 NW 166th Drive
Alachua, FL 32615

Craig Parenteau
FDEP
4801 Camp Ranch Rd
Gainesville, FL 32641

AFFIDAVIT FOR POSTED LAND USE SIGN

I Melissa Watson, POSTED THE LAND USE
(Name)
SIGN ON 6/6/19 FOR THE San Felasco Tech City RZ
(Date) (State type of action and project name)
LAND USE ACTION.

AS PER ARTICLE 2.2.9 D OF THE LAND DEVELOPMENT REGULATIONS.

THIS WILL BE INCLUDED IN THE STAFF REPORT.

Melissa Watson
(Signature)

3
(Number of signs)