

## WEATHER

**TODAY'S UV INDEX**  
10 a.m. noon 2 p.m. 4 p.m.  
**3 7 7 4**  
The higher the **AccuWeather.com UV Index** number, the greater the need for eye and skin protection. 0-2: Low, 3-5: Moderate, 6-7: High, 8-10: Very High, 11+: Extreme

## FIVE-DAY FORECAST FOR GAINESVILLE

Today	Friday	Saturday	Sunday	Monday
<b>87°</b> <b>71°</b>	<b>91°</b> <b>71°</b>	<b>90°</b> <b>71°</b>	<b>90°</b> <b>73°</b>	<b>90°</b> <b>73°</b>
Partly sunny Chance of rain: 25% Winds: SW 6-12 mph	Clouds and sun Chance of rain: 25% Winds: NE 6-12 mph	A thunderstorm Chance of rain: 55% Winds: E 6-12 mph	A stray t-storm Chance of rain: 45% Winds: SE 4-8 mph	A p.m. t-storm Chance of rain: 60% Winds: SSE 4-8 mph

AccuWeather DOWNLOAD THE FREE APP

SUN AND MOON			
Sunrise today	6:28 a.m.	Sunset tonight	8:30 p.m.
Moonrise today	5:01 p.m.	Moonset today	3:53 a.m.
Full	Last	New	First
June 17	June 25	July 2	July 9

## REGIONAL FORECAST

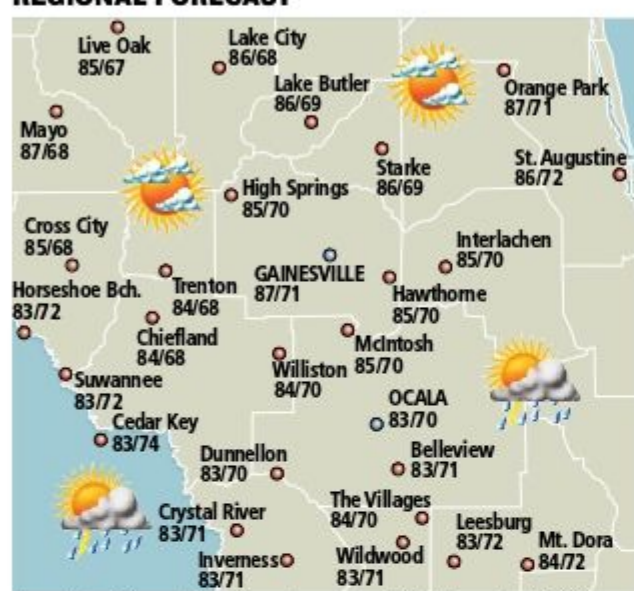

Shown is today's weather. Temperatures are today's highs and tonight's lows.

## FLORIDA FORECAST

City	Today	Tomorrow	Lakeland	85/72/t	86/72/t
Apalachicola	86/71/pc	86/71/s	Melbourne	88/72/t	85/75/t
Cape Canaveral	86/74/t	85/76/t	Miami	91/78/t	88/79/t
Crescent Beach	83/73/pc	83/75/pc	Orlando	86/70/t	88/70/t
Crystal River	83/71/pc	88/69/pc	Panama City	87/71/s	87/72/s
Daytona Beach	86/72/t	86/73/pc	Pensacola	90/68/s	87/73/s
Fernandina Bch.	86/72/pc	84/73/pc	Perry	87/67/pc	90/68/pc
Ft. Lauderdale	88/78/t	87/79/t	St. Petersburg	85/75/pc	88/75/t
Fort Myers	88/75/t	88/75/t	Sarasota	90/76/c	90/74/t
Ft. Walton Bch.	87/67/s	85/71/s	Tallahassee	89/66/pc	90/68/s
Jacksonville	87/69/pc	85/70/pc	Tampa	85/77/t	89/77/t
Key West	88/80/pc	89/79/t	Vero Beach	88/70/t	86/71/t
			W. Palm Beach	91/75/t	87/76/t

## YESTERDAY'S ALMANAC

GAINESVILLE						OCALA																					
Measured at Gainesville Regional Airport through 5 p.m. yesterday.						Measured at Ocala through 5 p.m. yesterday.																					
<b>Temperature</b>						<b>Temperature</b>																					
High/low temperature			86°/76°			High/low temperature			86°/73°																		
Normal high/low			90°/69°			Normal high/low			92°/70°																		
Record high			99° in 1998			Record high			100° in 1952																		
Record low			52° in 1960			Record low			61° in 1988																		
<b>Precipitation</b>						<b>Precipitation</b>																					
24 hours through 5 p.m. yest.			0.32"			24 hours through 5 p.m. yest.			0.60"																		
Record rainfall			3.23" in 1965			Record rainfall			2.35" in 2005																		
<b>Monthly rainfall</b>						<b>Monthly rainfall</b>																					
2019		2018		2017		NmI		Rcd		Year		2019		2018		2017		NmI		Rcd		Year					
Jan.		5.42		4.32		1.45		3.33		11.79		1904		Jan.		4.49		4.19		4.95		3.20		9.12		1994	
Feb.		1.01		1.58		0.39		3.20		11.58		1998		Feb.		1.67		1.18		1.51		3.26		11.31		1998	
March		1.87		2.41		0.67		4.33		11.13		1996		March		0.48		3.69		1.35		4.56		11.86		1959	
April		2.42		7.49		2.74		2.67		8.95		1949		April		3.74		4.83		2.23		2.40		16.37		1982	
May		2.65		8.38		4.45		2.48		9.25		1959		May		5.56		12.40		2.84		2.92		13.05		1976	
June		2.19		5.55		16.86		7.12		16.86		2017		June		4.71		6.62		9.82		7.42		15.98		1974	
July		6.69		16.70		6.07		16.70		2017				July		9.25		8.52		6.92		13.57		1964			
Aug.		8.69		5.79		6.39		15.84		1985				Aug.		6.14		6.81		6.32		15.17		1949			
Sept.		2.84		15.28		4.42		19.91		1894				Sept.		2.91		12.92		6.08		20.70		2004			
Oct.		0.61		1.57		2.88		10.00		1994				Oct.		1.05		3.43		3.03		9.53		1958			
Nov.		2.81		2.76		2.06		7.27		1972				Nov.		1.39		5.39		2.12		7.01		1980			
Dec.		8.68		2.65		2.38		9.60		1997				Dec.		11.47		1.14		2.57		11.47		2018			
Year		15.56		60.05		71.31		47.33		73.30		1953		Year		20.65		65.12		60.91		50.80		74.71		1982	

## POLLEN INDEX

ABSENT LOW MODERATE HIGH VERY HIGH  
SOURCE: AccuWeather.com

## WEATHER TRIVIA™

**Q:** Tomato plants do better when overnight readings remain above what?

**A:** 55 f. degrees

## TODAY'S TIDES

	High	Low
Boca Grande	10:21 a.m.	3:25 a.m.
Cedar Key	11:26 a.m.	5:24 a.m.
Crystal River	1:51 a.m.	8:17 a.m.
Daytona Beach	5:13 a.m.	11:23 a.m.
Homosassa Bay	2:55 a.m.	8:58 a.m.
Ponce Inlet	6:05 a.m.	12:06 a.m.
St. Augustine	5:49 a.m.	12:06 p.m.
Withlacoochee	11:33 a.m.	6:19 a.m.

## COASTAL CONDITIONS

**Savannah to St. Augustine:** Wind from the southwest at 6-12 knots today. Seas 1-3 feet. Inland waterways a light chop. Visibility generally unrestricted.

**St. Augustine to Jupiter Inlet:** Wind southwest 6-12 knots today. Seas 1-3 feet. Inland waterways mostly smooth. Visibility under 2 miles in a thunderstorm.

**Tarpon Springs to Apalachicola:** Wind from the southwest at 6-12 knots today. Seas 1-3 feet. Inland waterways mostly smooth. Visibility less than 3 miles in showers.

## SOLUNAR TABLES

The solunar period indicates peak feeding times for fish and game.				
	A.M.		P.M.	
Day	Major	Minor	Major	Minor
Today	9:09	2:57	9:34	3:22
Fri.	9:53	3:40	10:18	4:05
Sat.	10:38	4:25	11:04	4:51

## AIRPORT REPORT

**ATLANTA:** Sunshine, pleasant and warmer. High 80, Low 59  
**CHARLOTTE:** Mostly sunny and warmer. High 82, Low 56  
**JACKSONVILLE:** Times of clouds and sun. High 87, Low 69  
**MIAMI:** A shower or heavy t-storm. High 91, Low 78  
**ORLANDO:** A stray afternoon t-storm. High 86, Low 70  
**TAMPA:** Some sun with a thunderstorm. High 85, Low 77

## TODAY'S FIRE RISK

LOW MODERATE HIGH EXTREME  
SOURCE: U.S. Forest Service

## NATION & WORLD

U.S. CITIES	Today	Tomorrow
Albany	61/53/r	67/52/sh
Albuquerque	92/63/pc	92/59/s
Allentown	67/56/t	73/54/pc
Anchorage	66/52/c	67/53/pc
Asheville	76/51/pc	77/52/s
Atlanta	80/59/s	81/62/s
Atlantic City	77/60/t	77/58/s
Austin	91/69/s	95/77/s
Baltimore	75/58/t	77/57/s
Birmingham	80/58/s	83/64/s
Bismarck	82/57/pc	86/60/pc
Boise	87/60/t	88/57/pc
Boston	63/59/r	74/58/pc
Buffalo	66/50/t	67/58/sh
Burlington, VT	66/53/t	68/54/r
Casper	79/50/t	74/45/t
Charleston, SC	87/60/t	83/61/s
Charleston, WV	66/49/t	73/54/s
Charlotte	82/56/s	80/56/s
Chicago	67/54/pc	76/63/pc
Cincinnati	63/48/sh	74/56/s
Cleveland	68/51/t	74/59/s
Columbia, SC	86/58/s	83/57/s
Columbus, OH	65/48/sh	74/55/s
Concord	62/50/r	71/50/pc
Dallas	84/67/s	89/74/s
Dayton	61/49/sh	74/57/s
Denver	83/57/t	82/52/t
Des Moines	73/58/s	74/65/pc
Detroit	65/49/sh	75/59/pc
Duluth	72/49/pc	71/47/t
El Paso	100/74/c	100/74/pc
Evansville	71/49/pc	78/60/pc
Fairbanks	74/54/pc	74/52/s
Fargo	77/58/pc	85/58/t
Flagstaff	82/45/s	77/43/s
Grand Rapids	62/48/sh	73/61/c
Great Falls	84/56/t	78/50/t
Greensboro	78/55/pc	76/56/s
Hartford	61/55/r	73/55/sh
Helena	83/59/t	83/54/pc
Honolulu	89/75/s	89/75/pc
Houston	91/69/s	92/77/pc
Indianapolis	65/49/sh	74/60/pc
Jackson, MS	82/57/t	87/66/s
Kansas City	75/59/s	76/65/s
Las Vegas	106/76/s	98/77/s
Little Rock	81/58/s	84/69/pc
Los Angeles	76/61/pc	74/60/pc
Louisville	70/52/sh	77/62/pc
Lubbock	87/68/t	95/71/t
Madison	69/48/s	75/58/pc
Memphis	78/59/s	82/69/c
Midland	89/72/pc	97/74/t
Minneapolis	68/53/s	76/62/pc
Minneapolis	73/58/s	82/64/t
Nashville	76/53/s	81/62/pc
New Orleans	90/74/s	91/77/s
New York	66/59/r	72/60/pc
Norfolk	86/64/c	78/61/s
Oklahoma City	79/61/pc	85/72/t
Omaha	77/63/pc	79/68/pc

## IN THE SKIES

An hour before dawn, you can still see the two largest planets in our solar system-Jupiter and Saturn-low in the southwest, on either side of the "teapot" asterism in Sagittarius the Archer (Jupiter to the right and Saturn higher and to the left).

SOURCE: Morrison Planetarium, California Academy of Sciences

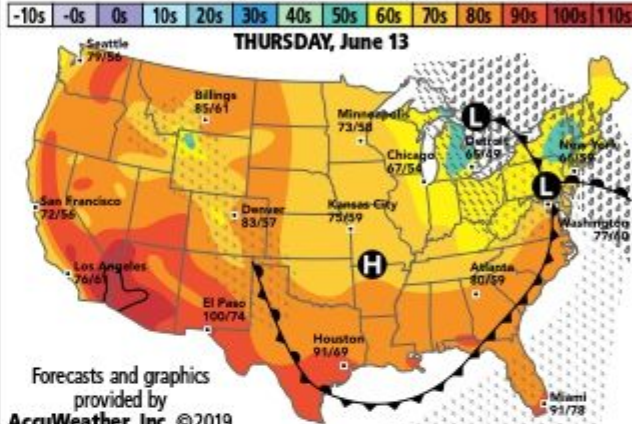

Forecasts and graphics provided by AccuWeather, Inc. ©2019

## YESTERDAY'S U.S. EXTREMES FOR THE 48 CONTIGUOUS STATES

**High:** Thermal, CA at 118° **Low:** Yellowstone Nat'l Park, WY at 27°  
**KEY:** W-weather, S-sunny, PC-partly cloudy, C-cloudy, SH-showers, T-thunderstorms, R-rain, SF-snow flurries, SN-snow, I-ice.

Philadelphia	71/59/t	75/58/s	Today	Tomorrow	
Phoenix	112/79/s	104/77/s	CARIBBEAN	Hi/Low	Hi/Low
Pittsburgh	67/48/t	71/54/s	Barbados	87/80/pc	87/80/pc
Portland, ME	62/51/r	70/53/r	Bridgetown	87/80/pc	87/80/pc
Portland, OR	85/57/s	76/55/s	Curacao	88/78/pc	88/80/pc
Providence	66/60/t	74/56/pc	Freeport	90/76/pc	88/75/pc
Raleigh	81/57/pc	78/56/s	Havana	89/73/pc	90/75/pc
Rapid City	78/53/pc	77/54/pc	Kingston	89/77/pc	90/78/pc
Reno	89/60/pc	90/60/s	St. Thomas	88/79/pc	87/79/pc
Richmond	80/58/t	77/56/s	San Juan	87/77/pc	87/77/pc
Sacramento	91/55/s	88/54/s	Today	Tomorrow	
St. Louis	73/56/s	80/63/pc	WORLD	Hi/Low	Hi/Low
Salt Lake City	86/60/pc	81/60/pc	Acapulco	88/79/t	89/80/t
San Antonio	90/72/s	93/76/s	Asuncion	86/70/pc	86/71/pc
San Diego	71/61/pc	69/61/pc	Baghdad	109/79/s	111/80/s
San Francisco	72/56/pc	68/55/pc	Bangkok	91/79/t	91/79/t
Santa Fe	88/56/t	88/51/s	Beijing	84/65/t	93/66/s
St. Ste. Marie	58/44/r	65/47/r	Berlin	79/58/pc	86/67/pc
Seattle	79/56/s	73/55/pc	Buenos Aires	66/53/r	64/50/pc
Shreveport	85/63/s	88/71/pc	Cairo	93/71/s	93/74/pc
Sioux Falls	78/60/pc	80/62/pc	Cape Town	60/43/s	65/43/s
Spokane	88/59/pc	82/57/s	Caracas	85/75/pc	84/74/t
Syracuse	62/54/t	66/57/sh	Dublin	56/43/sh	58/49/sh
Topeka	78/60/s	79/67/c	Jerusalem	77/63/s	78/62/pc
Tucson	108/71/pc	102/67/s	Kabul	88/56/s	90/60/s
Tulsa	79/63/pc	84/74/t	Lima	67/61/pc	67/61/pc
Wash., DC	77/60/t	77/60/s	London	60/53/sh	65/52/pc
Wichita	78/61/pc	85/70/t	Madrid	84/55/pc	80/51/s
Wilkes-Barre	65/55/r	69/53/pc	Manila	92/82/t	91/82/t
Wilmington, NC	86/64/pc	82/59/s	Mexico City	74/55/t	75/57/t
	Today	Tomorrow	Moscow	68/48/pc	74/58/pc
CANADA	Hi/Low	Hi/Low	Nairobi	72/56/c	73/57/c
Calgary	75/52/t	67/49/t	New Delhi	109/86/pc	113/88/pc
Edmonton	72/47/pc	72/50/t	Paris	69/53/pc	76/57/pc
Halifax	65/51/c	60/50/t	Quito	71/53/pc	72/54/c
Ottawa	66/49/c	64/50/r	Rio de Janeiro	83/71/s	84/70/s
Quebec	71/51/c	65/48/r	Rome	83/65/s	88/68/pc
Regina	84/56/pc	77/53/t	Seoul	79/62/pc	79/61/c
Toronto	63/51/r	71/58/pc	Singapore	88/80/t	88/79/t
Vancouver	74/54/pc	70/53/pc	Sydney	72/50/sh	67/50/c
Winnipeg	74/56/pc	77/50/sh	Tokyo	76/64/s	77/65/pc

## AUTHOR SERIES

Sponsored by Friends of the Library  
Presented at Headquarters Library

**MELANIE BENJAMIN**  
2:30 PM Saturday, June 15

Melanie Benjamin presents her latest novel, *Mistress of the Ritz*, based on the story of the real-life American woman who secretly worked for the French Resistance during World War II- while playing hostess to the invading Germans at the iconic Hôtel Ritz in Paris.

Alachua County LIBRARY District WWW.ACLIB.US

## WE'RE HIRING!

Arby's is expanding in Gainesville!  
We are opening 2 new stores in the Gainesville Market.

All positions need to be filled.  
Full Time - Part Time  
Looking for Great Team Members That Are Outgoing, Friendly, and Enjoy Serving Customers With Fast, Friendly Service and Great Food.

**Food Service, Cashiers, or Maintenance**  
**\$9.00 to \$12.00**  
**Team Leaders and Shift Managers**  
**\$10.00 to \$15.00**  
**Assistant Managers**  
**\$12.00 to \$18.00**

**APPLY IN PERSON at**  
Thornbrook Village Shopping Center  
4253 NW 25th Place, Gainesville, FL 32606 at the store next to Brittany's Fine Jewelry, behind the New Arby's on 43rd St.

Monday & Tuesday 9:00 AM - 7:00PM  
Thursday & Friday 9:00 AM - 7:00PM  
Saturday 9:00 AM - 8:00PM

## PUBLIC NOTICE OF ENACTMENT OF AN ORDINANCE OF THE CITY OF ALACHUA, FLORIDA

Notice is hereby given that the City Commission of the City of Alachua will hold a public hearing on a proposed ordinance. The hearing will be held on June 24, 2019, at 6:00 p.m., in the James A. Lewis Commission Chambers in City Hall, located at 15100 NW 142nd Terrace, Alachua, Florida.

The ordinance title is as follows:

**ORDINANCE 19-30**  
**AN ORDINANCE OF THE CITY OF ALACHUA, FLORIDA, RELATING TO THE AMENDMENT OF THE OFFICIAL ZONING ATLAS; AMENDING THE OFFICIAL ZONING ATLAS FROM COMMERCIAL INTENSIVE (CI), LIGHT AND WAREHOUSE INDUSTRIAL (ILW), AND INDUSTRIAL SERVICES AND MANUFACTURING (MP) (ALACHUA COUNTY) TO CORPORATE PARK (CP) ON AN APPROXIMATELY ±82.40 ACRE PROPERTY; LOCATED IN THE 13000 BLOCK OF NW US HIGHWAY 441 ; CONSISTING OF TAX PARCEL NUMBERS 05962-002-000, 05855-005-000, AND A PORTION OF 05855-004-000; REPEALING ALL ORDINANCES IN CONFLICT; PROVIDING SEVERABILITY; AND PROVIDING AN EFFECTIVE DATE.**

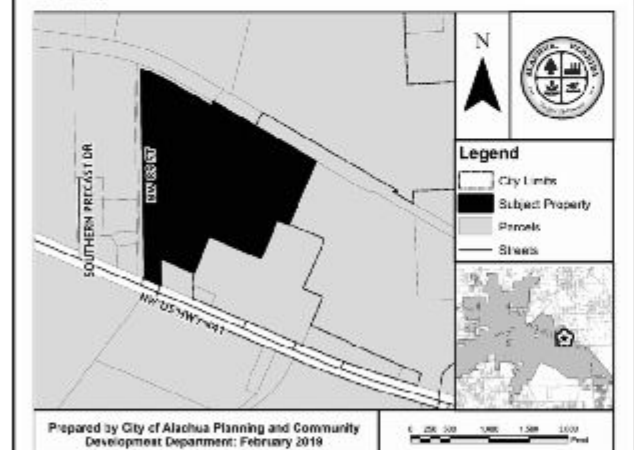

At the public hearing, all interested parties may appear and be heard with respect to the application. Copies of the application are available for public inspection at the Planning and Community Development Department, 15100 NW 142nd Terrace, Alachua, Florida, on any regular business day between the hours of 7:30 a.m. to 6:00 p.m. Written comments on the application may be sent to the following address: City of Alachua, Planning and Community Development, P.O. Box 9, Alachua, FL 32616. Notice is given pursuant to Section 286.0105, Florida Statutes, that, in order to appeal any decision made at the public hearing, you will need a record of the proceedings, and that, for such purpose, you may need to ensure that a verbatim record of the proceedings is made, which includes the testimony and evidence upon which the appeal is to be based. In accordance with the Americans with Disabilities Act, any persons with a disability requiring reasonable accommodation in order to participate in this meeting should call the City Clerk at (386) 418-6100 x 101 at least 48 hours prior to the public hearing.

## PUBLIC NOTICE OF ENACTMENT OF AN ORDINANCE OF THE CITY OF ALACH



TODAY



City of  
**ALACHUA**

THE GOOD LIFE COMMUNITY

*Mailed 6/11/2019*



## PUBLIC NOTICE OF ENACTMENT OF AN ORDINANCE OF THE CITY OF ALACHUA, FLORIDA

Notice is hereby given that the City Commission of the City of Alachua will hold a public hearing on a proposed ordinance. The hearing will be held on June 24, 2019 at 6:00 p.m., in the James A. Lewis Commission Chambers in City Hall, located at 15100 NW 142<sup>nd</sup> Terrace, Alachua, Florida.

The ordinance title is as follows:

### ORDINANCE 19-28

**AN ORDINANCE OF THE CITY OF ALACHUA, FLORIDA, RELATING TO THE AMENDMENT OF THE OFFICIAL ZONING ATLAS; AMENDING THE OFFICIAL ZONING ATLAS FROM PLANNED UNIT DEVELOPMENT ("PUD") AND AGRICULTURAL ("A") (ALACHUA COUNTY) TO PLANNED DEVELOPMENT - RESIDENTIAL ("PD-R") ON APPROXIMATELY 50.45 ACRES; LOCATED NORTH OF COLLEGE HEIGHTS, EAST OF LINCOLN GARDENS, WEST OF NEWNANSVILLE AND SOUTH OF STATE ROAD 235; TAX PARCEL NUMBERS 03135-000-000, 03130-004-000, 03130-007-001, 03130-008-000 AND 03130-009-000; REPEALING ALL ORDINANCES IN CONFLICT; PROVIDING SEVERABILITY; AND PROVIDING AN EFFECTIVE DATE.**

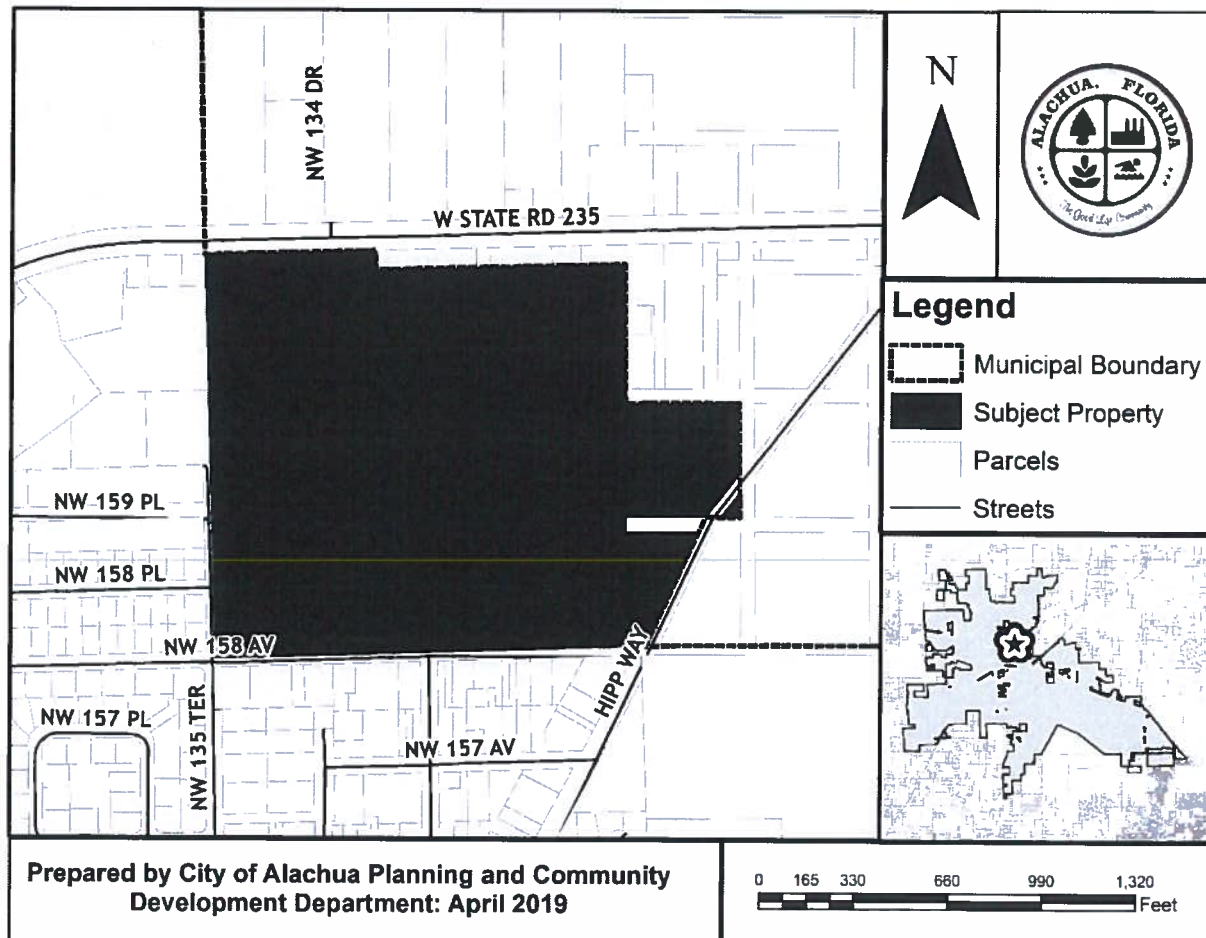

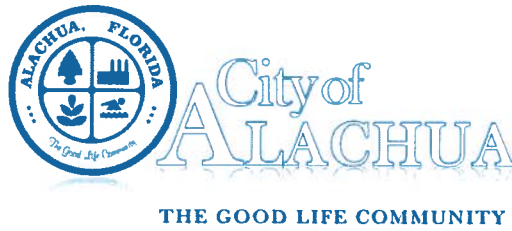

At the public hearing, all interested parties may appear and be heard with respect to the application. Copies of the application are available for public inspection at the Planning and Community Development Department, 15100 NW 142<sup>nd</sup> Terrace, Alachua, Florida, on any regular business day between the hours of 7:30 a.m. to 6:00 p.m. Written comments on the application may be sent to the following address: City of Alachua, Planning and Community Development, P.O. Box 9, Alachua, FL 32616. Notice is given pursuant to Section 286.0105, Florida Statutes, that, in order to appeal any decision made at the public hearing, you will need a record of the proceedings, and that, for such purpose, you may need to ensure that a verbatim record of the proceedings is made, which includes the testimony and evidence upon which the appeal is to be based. In accordance with the Americans with Disabilities Act, any persons with a disability requiring reasonable accommodation in order to participate in this meeting should call the City Clerk at (386) 418-6100 x 101 at least 48 hours prior to the public hearing.

03233-001-000  
BURNS, DAVID  
13301 NW 158TH AVE  
ALACHUA, FL 32615

03233-043-000  
MCCLAIN, NATHANIEL JR  
PO BOX 645  
ALACHUA, FL 32616

03130-009-000  
BENTLEY TIMBER LLC  
16860 SILVER OAK CIRCLE  
DELRAY BEACH, FL 33445

03130-013-000  
HESTER J E & SONDR  
PO BOX 943  
ALACHUA, FL 32616-0943

03130-009-001  
TAMBURINO, DOMINIC & RELO...  
10101 SW 222ND ST  
MIAMI, FL 33190-1566

03131-083-000  
UNDERWOOD, WILLIAM N & SU...  
PO BOX 138  
LA CROSSE, FL 32658

03141-000-000  
TOOMEY KERRY D & MARTHA ...  
12921 W STATE RD 235  
ALACHUA, FL 32615

03233-003-001  
JONES & PELHAM W/H  
PO BOX 2286  
ALACHUA, FL 32616

03216-010-003  
DEGROAT BENJAMIN D  
15665 NW 135TH TER  
ALACHUA, FL 32615

03215-000-000  
KITE, OLLIE HEIRS  
% EUNYTA J SIMMONS  
3216 NW 56TH PL  
GAINESVILLE, FL 32653

03130-001-000  
LEMNAH, EULA W HEIRS  
13220 W STATE ROAD 235  
ALACHUA, FL 32615-6156

03218-020-044  
GARCIA & MARRERO W/H  
13615 NW 157TH PL  
Alachua, FL 32615

03234-015-000  
FAITH HOPE & CHARITY INC  
PO BOX 327  
ALACHUA, FL 32616-0327

03218-020-004  
DOUGLASS HOLDINGS LLC  
PO BOX 143053  
Gainesville, FL 32614

03149-003-000  
HEITZMAN FRANK BENJAMIN  
15855 HIPPO WAY  
ALACHUA, FL 32615

03233-034-000  
COLLINS, MAMIE LEE LIFE EST...  
13208 NW 157TH AVE  
ALACHUA, FL 32616-0345

03131-080-000  
DIXON LULA M  
13609 NW 158TH PL  
ALACHUA, FL 32615

03233-003-000  
YOUNG MOZELLE  
13301 NW 158TH AVE  
ALACHUA, FL 32615

03216-010-002  
LEJA CONSTRUCTION INC  
3845 NW 37TH PL  
GAINESVILLE, FL 32606

03233-032-000  
COLLINS MAMIE L LIFE ESTATE  
13208 NW 157TH AVE  
ALACHUA, FL 32615-8243

03234-005-000  
FAITH HOPE & CHARITY DEV, C...  
PO BOX 327  
ALACHUA, FL 32616-0327

03131-043-000  
RUSHING JOHNNY SR HEIRS  
PO BOX 1354  
ALACHUA, FL 32616-1354

03154-002-001  
CAIN, WALLACE R  
PO BOX 100  
ALACHUA, FL 32616

03218-020-000  
SWICK REALTY INC & OLD TOW...  
% SHERRY S SWICK  
15004 NW BURNETTES LAKE B...  
Alachua, FL 32615

03129-001-000  
KOLOMYIKO IVAN & GALINA  
14317 NW 142ND AVE  
ALACHUA, FL 32615

03215-001-000  
GRANT NUBARICK E  
13433 NW 158TH AVE  
ALACHUA, FL 32615

03130-005-000  
LEMNAH & LEMNAH  
13220 W STATE RD 235  
ALACHUA, FL 32615

03234-000-000  
REED VALENTINE LLC  
321 YACHT CLUB DR  
FT WALTON BEACH, FL 32547

03130-004-000  
BENTLEY TIMBER LLC  
16860 SILVER OAK CIRCLE  
DELRAY BEACH, FL 33445

03218-010-004  
MAUTJANA NARE ALPHEUS & K...  
3310 NW 91ST ST APT 9D  
GAINESVILLE, FL 32606

03131-079-000  
MARKHAM CLAUDINE  
13617 NW 158TH PL  
ALACHUA, FL 32615

03233-028-000  
BRIGGS & FLAGG & FLAGG III &  
PO BOX 746  
ALACHUA, FL 32616

03234-023-002  
BOOKER HATTIE  
PO BOX 954  
ALACHUA, FL 32616-0954

03233-008-001  
REYNOLDS JACKIE & CAROLYN  
PO BOX 1218  
ALACHUA, FL 32616-1218

03131-042-000  
CAPOBIANCO CARL  
13518 NW 158TH PL  
ALACHUA, FL 32615

03131-001-000  
HEVIA, ROBERTO & YVETTE  
5322 WINDMILL PKWY  
EVANS, GA 30809-6648

03143-001-001  
TOOMEY, KERRY & MARTHA S  
12921 W SR-235  
Alachua, FL 32615

03135-000-000  
BENTLEY TIMBER LLC  
16860 SILVER OAK CIRCLE  
DELRAY BEACH, FL 33445

03214-000-000  
SRI JAJANNATH CHAITANYA, SA...  
PO BOX 246  
Alachua, FL 32616

03218-020-003  
DOUGLASS HOLDINGS LLC  
PO BOX 143053  
Gainesville, FL 32614

03131-091-000  
UNDERWOOD, WILLIAM N & SU...  
PO BOX 138  
LA CROSSE, FL 32658

03131-045-000  
GARRISON BERNICE  
PO BOX 75  
ALACHUA, FL 32616-0075

03130-003-000  
NCWT LLC  
14260 W NEWBERRY RD #200  
Newberry, FL 32669

03234-005-001  
WALKER HENRIETTA HEIRS  
PO BOX 1001  
ALACHUA, FL 32616-1001

03233-024-000  
FLAGG BEATRICE M  
PO BOX 326  
ALACHUA, FL 32616-0326

03149-000-000  
HEITZMAN JON F LIFE ESTATE  
16117 HIPPI WAY  
ALACHUA, FL 32615

03131-086-000  
LEWIS, DIANE R  
PO BOX 1421  
ALACHUA, FL 32616-1421

03218-020-026  
OCASIO & VILLAFANE W/H  
15705 NW 136TH TER  
ALACHUA, FL 32615

03233-041-000  
MCCLAIN NATHANIEL JR  
PO BOX 645  
ALACHUA, FL 32616

03131-082-000  
WALLS, WILLIE J  
281 E 143RD ST APT 11A  
BRONX, NY 10451-6265

03141-001-000  
TOOMEY KERRY D & MARTHA ...  
12921 W STATE RD 235  
ALACHUA, FL 32615

03215-001-001  
LOGAN CHRISTIE A  
PO BOX 186  
ALACHUA, FL 32615-0186

03233-002-000  
JONES & PELHAM W/H  
PO BOX 2286  
ALACHUA, FL 32616

03131-048-000  
ATKINS & GREEN & MCLEOD & ...  
13626 NW 158TH PL  
ALACHUA, FL 32615-5894

03130-013-001  
LEMNAH, WAUNITA  
13220 W STATE ROAD 235  
ALACHUA, FL 32615-6156

03216-010-007  
CRUZ JACOB EDWIN  
15133 NW 128TH ST  
ALACHUA, FL 32615

03233-012-000  
ANDERSON WILLIE HEIRS  
PO BOX 898  
ALACHUA, FL 32616-0898

03233-019-000  
MCCRAY, JOHN & MARGARITE  
49 LAKE SHORE BLVD  
PORT WENTWORTH, GA 31407

03149-004-000  
HEITZMAN, JOSEPH PAUL  
16013 HIPPI WAY  
ALACHUA, FL 32615

03218-020-005  
DOUGLASS HOLDINGS LLC  
PO BOX 143053  
Gainesville, FL 32614

03130-000-000  
LVS RENTALS LLC  
4606 NW 166TH AVE  
GAINESVILLE, FL 32653

03130-007-001  
BENTLEY TIMBER LLC  
16860 SILVER OAK CIRCLE  
DELRAY BEACH, FL 33445

03233-042-000  
WHITE, WILMER III  
8612 BRIXTON CT  
JACKSONVILLE, FL 32244

03234-010-000  
MITCHELL ALBERT  
PO BOX 2342  
ALACHUA, FL 32616-2342

03218-020-028  
MOHAMMED CHAD REJAN  
13630 NW 157TH PL  
ALACHUA, FL 32615

03234-014-000  
FAITH HOPE AND CHARITY INC  
PO BOX 327  
ALACHUA, FL 32616-0327

03233-036-000  
COLLINS, MAMIE F LIFE ESTAT...  
13208 NW 157TH AVE  
ALACHUA, FL 32615

03133-000-000  
SCHOOL BD OF ALACHUA CTY  
620 E UNIV AVE MEBANE MIDD...  
GAINESVILLE, FL 32601

03131-047-000  
ALLEN CHESTER JR  
PO BOX 974  
ALACHUA, FL 32616-0974

03234-023-000  
BOOKER HATTIE  
PO BOX 954  
ALACHUA, FL 32616-0954

03233-011-000  
QUINCEY, J S TRUSTEE  
18 NW 33RD CT  
GAINESVILLE, FL 32607

03233-014-000  
JAMES, LEON JEROME HEIRS  
2600 SW 7TH ST  
FORT LAUDERDALE, FL 33312-...

03129-010-000  
FRAZIER RAYLAN LIFE ESTATE  
NELLIE HUNT  
PO BOX 52  
ALACHUA, FL 32616-0052

03149-001-000  
HEITZMAN, THAD S HEIRS  
15311 NW 140TH ST  
ALACHUA, FL 32615

03130-011-000  
RODRIGUEZ FERNANDO & NAN...  
13310 W STATE RD 235  
ALACHUA, FL 32615

03130-007-000  
DORITY WINSTON L & ANGELA  
13508 W STATE ROAD 235  
ALACHUA, FL 32615-6157

03130-013-002  
STOKES-JONES PEGGY  
7204 NW 200TH TER  
ALACHUA, FL 32615

03233-027-000  
FLAGG, HENRY JR & BEATRICE  
PO BOX 326  
ALACHUA, FL 32616-0326

03130-010-000  
DASA & PATEL  
12503 W STATE ROAD 235  
ALACHUA, FL 32615

03234-013-000  
FAITH HOPE & CHARITY DELIV...  
PO BOX 327  
ALACHUA, FL 32616

03131-089-000  
JENKINS, SHELISIA V  
PO BOX 1071  
ALACHUA, FL 32616

03131-084-000  
SHARPER & TUBBS  
PO BOX 351  
ALACHUA, FL 32616-0351

03204-000-000  
JOHN C HIPPO CONST EQUIP C...  
PO BOX 1000  
ALACHUA, FL 32616-1000

03133-001-001  
CAIN, WALLACE R  
PO BOX 100  
ALACHUA, FL 32615

03218-020-001  
DOUGLASS HOLDINGS LLC  
PO BOX 143053  
Gainesville, FL 32614

03131-044-000  
JOINER TONIA Q  
PO BOX 1536  
ALACHUA, FL 32616

03218-020-002  
DOUGLASS HOLDINGS LLC  
PO BOX 143053  
Gainesville, FL 32614

03131-087-000  
DIXON, WILLETTE  
PO BOX 2435  
ALACHUA, FL 32616

03131-085-000  
RUSHING WILLIE & RUTHIE MA...  
PO BOX 985  
Alachua, FL 32616

03131-081-000  
UNDERWOOD, WILLIAM N & SU...  
PO BOX 138  
LA CROSSE, FL 32658

03154-002-000  
HART & WASHINGTON HEIRS  
PO BOX 874  
ALACHUA, FL 32616

03131-090-000  
FREENEY DIANNE  
PO BOX 223  
ALACHUA, FL 32616

03131-078-000  
SHARP ROBERT L LIFE ESTATE...  
PO BOX 235  
ALACHUA, FL 32616-0235

03216-010-008  
LOGAN CHRISTIE A  
PO BOX 186  
ALACHUA, FL 32615-0186

03130-008-000  
BENTLEY TIMBER LLC  
16860 SILVER OAK CIRCLE  
DELRAY BEACH, FL 33445

03154-001-000  
HART & STRICKLAND  
PO BOX 874  
ALACHUA, FL 32616-0874

03133-002-001  
CAIN, WALLACE R  
PO BOX 100  
ALACHUA, FL 32615

03218-020-006  
DOUGLASS HOLDINGS LLC  
PO BOX 143053  
Gainesville, FL 32614

03216-010-001  
LEJA CONSTRUCTION INC  
3845 NW 37TH PL  
GAINESVILLE, FL 32606

03218-020-025  
COLON-RODRIQUEZ & CRUZ-C...  
15659 NW 136TH TER  
Alachua, FL 32615

03215-002-000  
LOGAN CHRISTIE A  
PO BOX 186  
ALACHUA, FL 32615-0186

03218-020-027  
CARROLL, ANDREW II  
13608 NW 157TH PL  
ALACHUA, FL 32615

03233-010-000  
ANDERSON GLENN Z  
PO BOX 898  
ALACHUA, FL 32615

03233-005-001  
JONES & PELHAM W/H  
PO BOX 2286  
ALACHUA, FL 32616

03131-046-000  
COLLINS MARTHA ANN HEIRS  
PO BOX 75  
ALACHUA, FL 32616

03130-006-000  
HARRIS MONICA KAY  
13232 W STATE RD 235  
ALACHUA, FL 32615-6156

03129-004-000  
CSL FLORIDA SYSTEM LLC  
BENTON BLDG STE 300 10802 ...  
LITTLE ROCK, AR 72211

03129-010-002  
PHILPOT, IRA JUDSON  
25323 N COUNTY RD UNIT 1491  
ALACHUA, FL 32615

03216-010-006  
CURTIS & CURTIS  
PO BOX 194  
ALACHUA, FL 32616-0194

03130-008-002  
SHETH VISVAMBHAR  
PO BOX 2668  
ALACHUA, FL 32616

03129-010-001  
PHILPOT, IRA JUDSON  
25323 N COUNTY RD UNIT 1491  
ALACHUA, FL 32615

03133-002-000  
CAIN, WALLACE R  
PO BOX 100  
ALACHUA, FL 32615

03131-088-000  
BENNETT JEROME  
13612 NW 158TH AVE  
Alachua, FL 32615

03233-017-000  
FILER, MAMIE L  
13208 NW 157TH AVE  
ALACHUA, FL 32615

03217-000-000  
LOGAN CHRISTIE A  
PO BOX 186  
ALACHUA, FL 32615-0186

03154-000-000  
TOOMEY KERRY D & MARTHA ...  
12921 WEST STATE RD 235  
ALACHUA, FL 32615

03234-023-001  
BOOKER & HUNTER  
PO BOX 954  
ALACHUA, FL 32616

03233-008-000  
MOSLEY, CASSIE  
GENERAL DELIVERY  
FORT WHITE, FL 32038-9999

03233-045-000  
ANDERSON & WILLIAMS  
PO BOX 187  
HIGH SPRINGS, FL 32655

03130-012-000  
LEMNAH, WAUNITA  
13220 W STATE ROAD 235  
ALACHUA, FL 32615-6156



03149-007-000  
MARTIN & MCNEILL  
15311 NW 140TH ST  
ALACHUA, FL 32615

Antoinette Endelicato  
5562 NW 93<sup>rd</sup> Ave  
Gainesville FL 32653

Richard Gorman  
5716 NW 93<sup>rd</sup> Ave  
Alachua, FL 32653

TCMOA  
President  
1000 Turkey Creek  
Alachua, FL 32615

Jeannette Hinsdale  
PO Box 1156  
Alachua, FL 32616

Tamara Robbins  
PO Box 2317  
Alachua, FL 32616

Dan Rhine  
288 Turkey Creek  
Alachua, FL 32615

Peggy Arnold  
410 Turkey Creek  
Alachua, FL 32615

Linda Dixon, AICP  
Assistant Director Planning  
PO Box 115050  
Gainesville, FL 32611

Lynn Coullias  
7406 NW 126<sup>th</sup> Ave  
Alachua, FL 32615

Michele L. Lieberman  
Interim County Manager  
12 SE 1<sup>st</sup> St  
Gainesville, FL 32601

Tom Gorman  
9210 NW 59<sup>th</sup> St  
Alachua, FL 32653

David Forest  
23 Turkey Creek  
Alachua, FL 32615

FL Dept of Environmental Protection  
Craig Parenteau  
4801 Camp Ranch Road  
Gainesville, FL 32641

Lynda Coon  
7216 NW 126 Ave  
Alachua, FL 32615



## AFFIDAVIT FOR POSTED LAND USE SIGN

I Tim Boehlein, POSTED THE LAND USE  
SIGN ON 5-23-19<sup>(name)</sup> FOR THE Tolosa SSCPA & PD-R Rezoning (CCOM Hearings)  
(date) (state type of action and project name)  
LAND USE ACTION.

AS PER ARTICLE 2.2.9 D OF THE LAND DEVELOPMENT REGULATIONS.

THIS WILL BE INCLUDED IN THE STAFF REPORT.

  
(signature)

7  
(number of signs)

# IMPORTANT INFORMATION REGARDING POSTED NOTICE SIGNS

Pursuant to Section 2.2.9(D) of the City's Land Development Regulations, posted notice signs must be placed on the land that is the subject of the application, along each street which is adjacent to or runs through the land in a manner that makes them clearly visible. Signs shall be posted at intervals of not more than 400 feet when the land subject to the application has less than 1,500 feet of road frontage. When the land subject to the application has 1,500 feet or more of road frontage, signs shall be posted at intervals of not more than 1,320 feet.

Signs shall be inspected by the City subsequent to their posting. The applicant shall be responsible for ensuring that the posted notice is maintained on the land subject to the application until the completion of the final public hearing on the application.

***Signs must be removed by the applicant and returned to the City within ten days after the final decision on the application.***



## Tolosa SSCPA / PD-R Rezoning

