

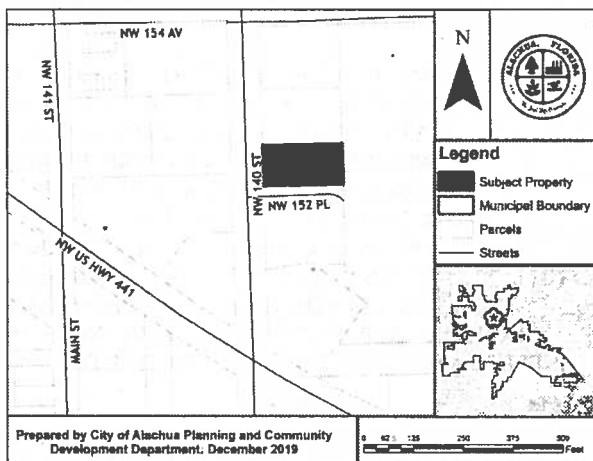

City of ALACHUA

NOTICE OF PUBLIC HEARING BEFORE THE PLANNING AND ZONING BOARD OF THE CITY OF ALACHUA, FLORIDA

Notice is hereby given that the Planning and Zoning Board of the City of Alachua will hold a public hearing on January 14, 2020, at 6:00 p.m. The hearing will be held in the James A. Lewis Commission Chambers in City Hall, located at 15100 NW 142nd Terrace, Alachua, Florida, to consider the following: A request by Craig Hedgecock, P.E., P.S.M. applicant and agent for Subhas and Elaine Sheth, property owners, for consideration of a Site Plan for the construction of a six (6) space parking lot, with associated paving, grading, drainage and landscaping improvements on a ± 0.46 acre subject property, located at 15303 NW 140th Street; Tax Parcel No. 03342-000-000; FLUM: Community Commercial; Zoning: Community Commercial (CC).



At the public hearing, all interested parties may appear and be heard with respect to the application. Copies of the application are available for public inspection at the Planning and Community Development Department, 15100 NW 142nd Terrace, Alachua, Florida, on any regular business day between the hours of 7:30 a.m. to 6:00 p.m. Written comments on the application may be sent to the following address: City of Alachua, Planning and Community Development, P.O. Box 9, Alachua, FL 32616. Notice is given pursuant to Section 286.0105, Florida Statutes, that, in order to appeal any decision made at the public hearing, you will need a record of the proceedings, and that, for such purpose, you may need to ensure that a verbatim record of the proceedings is made, which includes the testimony and evidence upon which the appeal is to be based. In accordance with the Americans with Disabilities Act, any persons with a disability requiring reasonable accommodation in order to participate in this meeting should call the City Clerk at (386) 418-6100 x 101 at least 48 hours prior to the public hearing.



City of
ALACHUA

THE GOOD LIFE COMMUNITY

Mailed 12/19/2019

NOTICE OF PUBLIC HEARING BEFORE THE PLANNING AND ZONING BOARD OF THE CITY OF ALACHUA, FLORIDA

Notice is hereby given that the Planning and Zoning Board of the City of Alachua will hold a public hearing on January 14, 2020, at 6:00 p.m. The hearing will be held in the James A. Lewis Commission Chambers in City Hall, located at 15100 NW 142nd Terrace, Alachua, Florida, to consider the following: A request by Craig Hedgecock, P.E., P.S.M. applicant and agent for Subhas and Elaine Sheth, property owners, for consideration of a Site Plan for the construction of a six (6) space parking lot, with associated paving, grading, drainage and landscaping improvements on a ± 0.46 acre subject property, located at 15303 NW 140th Street; Tax Parcel No. 03342-000-000; FLUM: Community Commercial; Zoning: Community Commercial (CC).

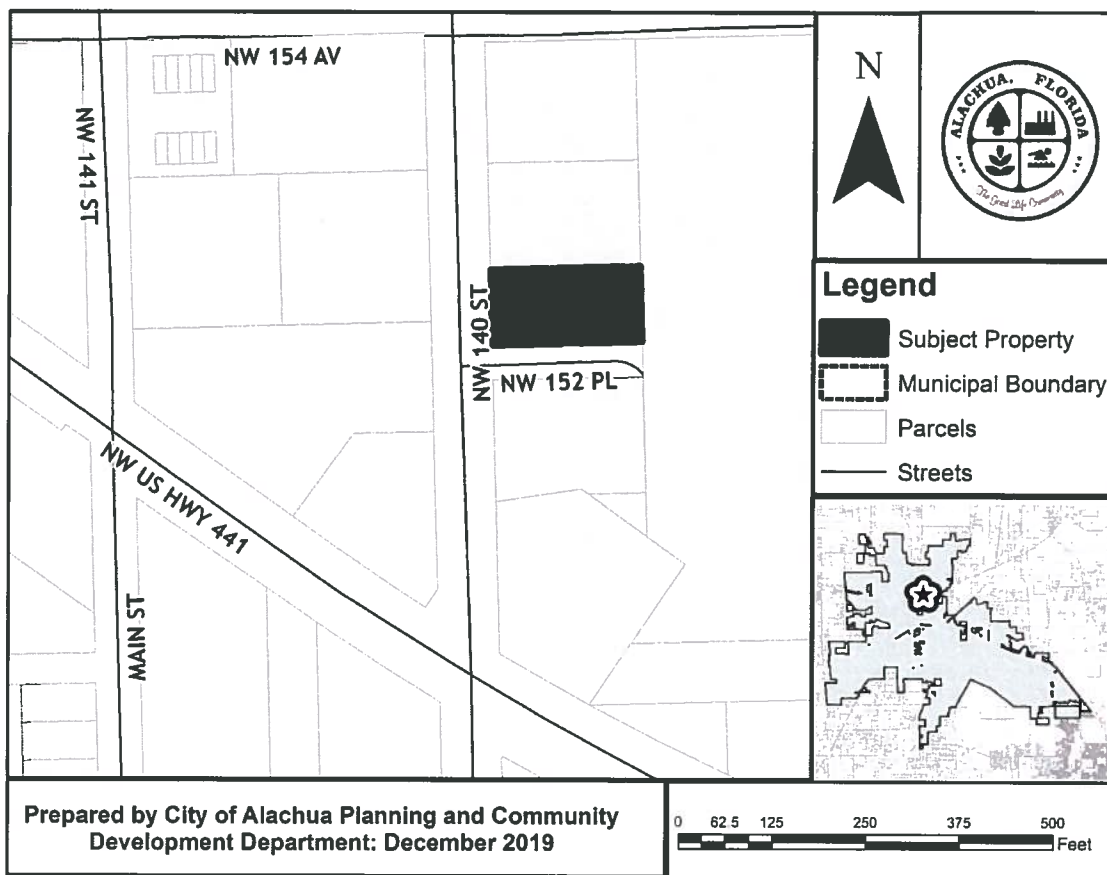

At the public hearing, all interested parties may appear and be heard with respect to the application. Copies of the application are available for public inspection at the Planning and Community Development Department, 15100 NW 142nd Terrace, Alachua, Florida, on any regular business day between the hours of 7:30 a.m. to 6:00 p.m. Written comments on the application may be sent to the following address: City of Alachua, Planning and Community Development, P.O. Box 9, Alachua, FL 32616. Notice is given pursuant to Section 286.0105, Florida Statutes, that, in order to appeal any decision made at the public hearing, you will need a record of the proceedings, and that, for such purpose, you may need to ensure that a verbatim record of the proceedings is made, which includes the testimony and evidence upon which the appeal is to be based. In accordance with the Americans with Disabilities Act, any persons with a disability requiring reasonable accommodation in order to participate in this meeting should call the City Clerk at (386) 418-6100 x 101 at least 48 hours prior to the public hearing.

P.O. Box 9 ♦ Alachua, Florida 32616-0009
Phone: (386) 418-6121 ♦ Fax: (386) 418-6130

Easy Peel Labels
Use Avery® Template 5160®
03337-000-000

School Board of Alachua County
620 East University Avenue
Gainesville, FL 32601

03226-000-000 & 03346-000-000
Huntley Jiffy LGD Trust 9539
PO Box 876
Orange, Park, FL 32067-0876

03341-000-000
Birkholtz & Martin & Martin & McNeill
15311 NW 140th Street
Alachua, FL 32615-6233

03340-000-000
J & A Properties Group LLC
923 SW 98th Street
Gainesville, FL 32607

03221-001-020
Alachua Meadows
11528 W State Road 84
Fort Lauderdale, FL 33355

03221-001-019
James E. Porter
13818 NW 154th Avenue
Alachua, FL 32615

03221-001-018
Penny Jackson
13826 NW 154th Avenue
Alachua, FL 32615

03221-001-017
Charlene Smith
PO Box 634
Alachua, FL 32616-0614

03221-000-000
Rosa McDaniel
25719 State Road 121
Alachua, FL 32615

03534-000-000
D R Funkhouser
PO Box 564
Alachua, FL 32616-0564

Feed Paper  Send along line to
expose Pop-Up Edge™
03591-000-000 & 03588-001-000

Walgreen Company
PO Box 1159
Deerfield, FL 60015

03563-000-000
Alachua Villas LTD
338-L1 Country Club Road
Valdosta, FL 3160

03589-000-000
Marcia Davis
PO Box 1860
Gainesville, FL 32616-1860

03589-010-010
Tamara N. Stone
7613 SW 52nd Place
Gainesville, FL 32608

Antoinette Endelicato
5562 NW 93rd Avenue
Gainesville FL 32653

Dan Rhine
288 Turkey Creek
Alachua FL 32615

Tom Gorman
9210 NW 59th Street
Alachua FL 32653

Richard Gorman
5716 NW 93rd Avenue
Alachua FL 32653

Peggy Arnold
410 Turkey Creek
Alachua FL 32615

David Forest
23 Turkey Creek
Alachua FL 32615

 **AVERY® 5260™**

President TCMOA
1000 Turkey Creek
Alachua FL 32615

Linda Dixon, AICP
Assistant Director Planning
PO Box 115050
Gainesville FL 32611

Craig Parenteau
FL Department of Environmental
4801 Camp Ranch Road
Gainesville FL 32641

Jeannette Hinsdale
P.O. Box 1156
Alachua FL 32616

Lynn Coullias
7406 NW 126th Ave
Alachua FL 32615

Lynda Coon
7216 NW 126 Avenue
Alachua FL 32615

Tamara Robbins
PO Box 2317
Alachua FL 32616

Michele L. Lieberman
County Manager
12 SE 1st Street
Gainesville FL 32601

Bonnie Flynn
16801 NW 166th Drive
Alachua FL 32615

03226-001-000
Louis I. Huntley Enterprises
1890 Kingsley Avenue
Suite 102
Orange Park, FL 32073

AFFIDAVIT FOR POSTED LAND USE SIGN

I Craig Hedgecock, POSTED THE LAND USE
(Name)
SIGN ON 12/19/2019 FOR THE Site Plan – Sheth Parking Lot
(Date) (State type of action and project name)
LAND USE ACTION.

AS PER ARTICLE 2.2.9 D OF THE LAND DEVELOPMENT REGULATIONS.

THIS WILL BE INCLUDED IN THE STAFF REPORT.

(Signature)

TWO (2)
(Number of signs)